

15-101-20484-00-00

STATE OF KANSAS  
STATE CORPORATION COMMISSION

WELL PLUGGING RECORD

Give All Information Completely  
Make Required Affidavit  
Mail or Deliver Report to  
Conservation Division  
State Corporation Comm.  
245 North Water  
Wichita, KS 67202

Lane \_\_\_\_\_ County. Sec. 14 Twp. 16 Rge. 29 E/W  
Location as "NE/CNW $\frac{1}{4}$ SW $\frac{1}{4}$ " or footage from lines \_\_\_\_\_  
SW NE SW

Lease Owner D. G. Hansen Trust  
Lease Name Yates Well No. 1  
Office Address Box 187, Logan, KS 67646  
Character of Well (Completed as Oil, Gas or Dry Hole) \_\_\_\_\_  
Dry Hole

Date Well completed 10/8 1980  
Application for plugging filed 10/8 1980  
Application for plugging approved 10/8 1980  
Plugging commenced 10/8 1980  
Plugging completed 10/8 1980

Reason for abandonment of well or producing formation \_\_\_\_\_  
Too low structurally

If a producing well is abandoned, date of last production \_\_\_\_\_  
19\_\_\_\_

Was permission obtained from the Conservation Division or its agents before plugging was commenced? Yes

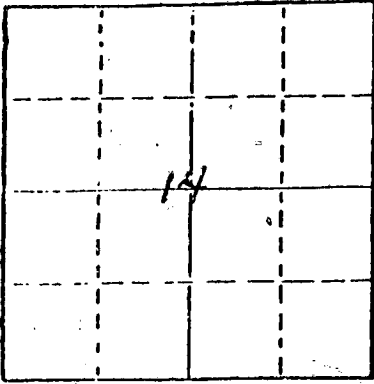

Locate well correctly on above Section Plat

Name of Conservation Agent who supervised plugging of this well Gilbert Balthazor  
Producing formation \_\_\_\_\_ Depth to top \_\_\_\_\_ Bottom \_\_\_\_\_ Total Depth of Well 4545  
Show depth and thickness of all water, oil and gas formations.

OIL, GAS OR WATER RECORDS

CASING RECORD

FORMATION	CONTENT	FROM	TO	SIZE	PUT IN	PULLED OUT
				8 5/8	315.53	None

Describe in detail the manner in which the well was plugged, indicating where the mud fluid was placed and the method or methods used in introducing it into the hold. If cement or other plugs were used, state the character of same and depth placed, from \_\_\_\_\_ feet to \_\_\_\_\_ feet for each plug set.

Filled with heavy mud to 900'. Set plug. Put in 70 sacks cement. Filled with heavy mud to 300'. Set plug. Filled with heavy mud up to 40'. Set plug. Filled to top with 10 sacks cement.

(If additional description is necessary, use BACK of this sheet)

Name of Plugging Contractor C-G Drilling Co., Inc  
1107 Douglas Bldg., Wichita, KS 67202

STATE OF Kansas COUNTY OF Sedgwick  
G. F. Galloway (employee of owner) or (owner or operator)

I, the above-described well, being first duly sworn on oath, says: That I have knowledge of the facts, statements, and matters herein contained and the log of the above-described well is filed and that the same are true and correct. So help me God.

(Signature)

G. F. Galloway 1107 Douglas Bldg.,  
(Address) Wichita, KS 67202

SUBSCRIBED AND SWORN TO before me this 13th day of October, 1980

My commission expires May 18, 1982

Mari Jane Nungesser  
Notary Public.

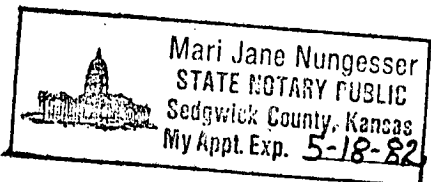

RECEIVED  
STATE CORPORATION COMMISSION  
11-03-1980  
NOV 3 1980  
WICHITA, KANSAS

KANSAS

WELL COMPLETION REPORT AND DRILLER'S LOG

API No. 15 - 101 - 204840000  
County Number

S. 14 T. 16 R. 29 NE W  
Loc. SW NE SW  
County Lane

Operator  
D. G. Hansen Trust

Address  
P O Box 187, Logan, KS 67646

Well No. 1 Lease Name Yates

Footage Location  
1650 feet from N (S) line 1650 feet from E (W) line

Principal Contractor C-G Drilling Co., Inc. Geologist Jerry Jespersen

Spud Date Date Completed Total Depth P.B.T.D.

Directional Deviation Oil and/or Gas Purchaser

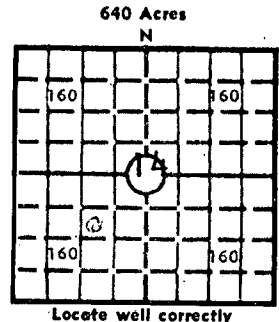

Elev.: Gr. \_\_\_\_\_  
DF \_\_\_\_\_ KB \_\_\_\_\_

CASING RECORD

Report of all strings set - surface, intermediate, production, etc.

Purpose of string	Size hole drilled	Size casing set (in O.D.)	Weight lbs./ft.	Setting depth	Type cement	Sacks	Type and percent additives

LINER RECORD

PERFORATION RECORD

Top, ft.	Bottom, ft.	Sacks cement	Shots per ft.	Size & type	Depth interval

TUBING RECORD

Size	Setting depth	Packer set at

ACID, FRACTURE, SHOT, CEMENT SQUEEZE RECORD

Amount and kind of material used	Depth interval treated

INITIAL PRODUCTION

Date of first production		Producing method (flowing, pumping, gas lift, etc.)			
RATE OF PRODUCTION PER 24 HOURS	Oil bbls.	Gas MCF	Water bbls.	Producing interval (s)	Disposition of gas (vented, used on lease or sold)

RECEIVED  
STATE CORPORATION COMMISSION  
NOV - 3 1980  
11-03-1980  
CONSERVATION DIVISION

INSTRUCTIONS: As provided in KCC Rule 82-2-125, within 90 days after completion of a well, one completed copy of this Driller's Log shall be submitted to the State Geological Survey of Kansas, 4150 Monroe Street, Wichita, Kansas 67209. Copies of this form are available from the Conservation Division, State Corporation Commission, 245 No. Water, Wichita, Kansas 67202. Phone AC 316-522-2206. If confidential custody is desired, please note Rule 82-2-125. Drillers Logs will be on an open file in the Oil and Gas Division, State Geological Survey of Kansas, Lawrence, Kansas 66044.

15-101-20484-00-00

DESIGNATE TYPE OF COMP.: OIL, GAS, DRY HOLE, SWDW, ETC.:

Dry Hole

Operator  
C-G Drilling Co., Inc.

Well No. 1  
Lease Name  
Yates

S 14 T 16 R 29 E  
W

**WELL LOG**

Show all important zones of porosity and contents thereof; cored intervals, and all drill-stem tests, including depth interval tested, cushion used, time tool open, flowing and shut-in pressures, and recoveries.

SHOW GEOLOGICAL MARKERS, LOGS RUN, OR OTHER DESCRIPTIVE INFORMATION.

FORMATION DESCRIPTION, CONTENTS, ETC.	TOP	BOTTOM	NAME	DEPTH
Anhydrite	2193			
Base	2212			
HEEBNER	3890			
LANSING	3929			
STARK	4183			
B/KC	4254			
MARM	4270			
PAWNEE	4404			
FT SCOTT	4434			
CHER	4461			
TD	4545			
<p>DST #1 3880-3955 15-45-45-45 REC 120' MSW, IBHP 1187 FBHP 1125 IFP 142 FFP 367 DST #2 4171-4220 15-45-60-45 REC 330' MSW IBHP 1049 FBHP 977 IFP 72 FFP 236 DST #3 4424-4465 15-45-15-45 REC 10' MUD IBHP 61 FBHP 51 IFP 51 FFP 51</p>				

USE ADDITIONAL SHEETS, IF NECESSARY, TO COMPLETE WELL RECORD.

Date Received

*Kris Knoettgen*  
Kris Knoettgen  
Secretary  
10/8/80  
Date