

ORIGINAL

SIDE ONE

RELEASED 8/23/90

STATE CORPORATION COMMISSION OF KANSAS  
OIL & GAS CONSERVATION DIVISION  
RECOMPLETION FORM  
ACO-2 AMENDMENT TO WELL HISTORY

API NO. 15- 101-20,952 -00-01 JAN 22 1991

County Lane FROM CONFIDENTIAL  
East  
CW/2 NW NE Sec 34 Twp 17S Rge 27 X West

Operator: License # 3680  
Name L.B. Industries, Inc.  
Address 370 17th St., Suite 3200  
City/State/Zip Denver, CO 80202

4620 Ft North from Southeast Corner of Section  
2310 Ft West from Southeast Corner of Section  
(Note: Locate well in section plat below)

Purchaser Fina Oil & Chemical  
Operator Contact Person Layle L. Robb  
Phone (303) 629-1447

Lease Name Whipple Well # 34-2  
Field Name Whipple  
Name of New Formation Cherokee  
Elevation: Ground 2682' KB 2687'  
Section Plat

Designate Type of Original Completion  
 New Well  Re-Entry  Workover  
 Oil  SWD  Temp Abd  
 Gas  Inj  Delayed Comp.  
 Dry  Other (Core, Water Supply etc.)

Date of Original Completion: 5/11/84

DATE OF RECOMPLETION:  
8/2/89 8/5/89  
Commenced Completed

Designate Type of Recompletion/Workover:  
 Deepening  Delayed Completion  
 Plug Back  Re-perforation  
 Conversion to Injection/Disposal

Is recompleted production:  
 Commingled; Docket No. \_\_\_\_\_  
 Dual Completion; Docket No. \_\_\_\_\_  
 Other (Disposal or Injection)?

KANSAS GEOLOGICAL SURVEY  
WICHITA BRANCH  
SEP 07 1989

RECEIVED  
STATE CORPORATION COMMISSION  
AUG 28 1989

CONSERVATION DIVISION  
Wichita, Kansas

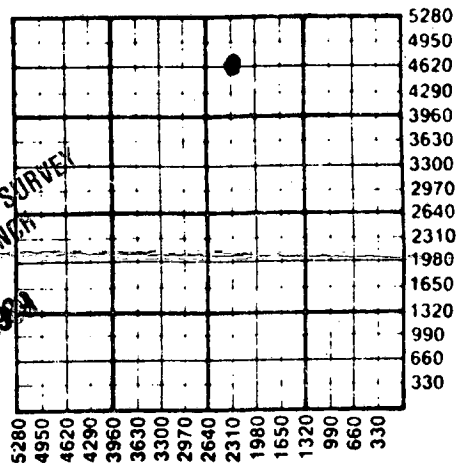

K.C.C. OFFICE USE ONLY  
 Letter of Confidentiality Attached  
 Wireline Log Received  
 Drillers Timelog Received  
- Distribution -  
 KCC  SWD/Rep  NGPA  
 KGS  Plug  Other  
(Specify)  
OO#1

INSTRUCTIONS: This form shall be completed in triplicate and filed with the Kansas Corporation Commission, 200 Colorado Derby Building, Wichita, Kansas 67202, within 120 days of the recompletion of any well. Rules 82-3-107 and 82-3-141 apply. Information on side two of this form will be held confidential for a period of 12 months if requested in writing and submitted with the form. See rule 82-3-107 for confidentiality in excess of 12 months. One copy of any additional wireline logs and driller's time logs (not previously submitted) shall be attached with this form. Submit ACO-4 prior to or with this form for approval of commingling or dual completions. Submit OP-4 with all plugged wells. Submit OP-111 with all temporarily abandoned wells. NOTE: Conversion of wells to either disposal or injection must receive approval before use; submit form U-1.

All requirements of the statutes, rules and regulations promulgated to regulate the oil and gas industry have been fully complied with and the statements herein are complete and correct to the best of my knowledge.

Signature Layle L. Robb Title Operations Manager Date 8/23/89

Subscribed and sworn to before me this 23rd day of August 19 89

Notary Public Peggy Steffen Date Commission Expires 7/27/92

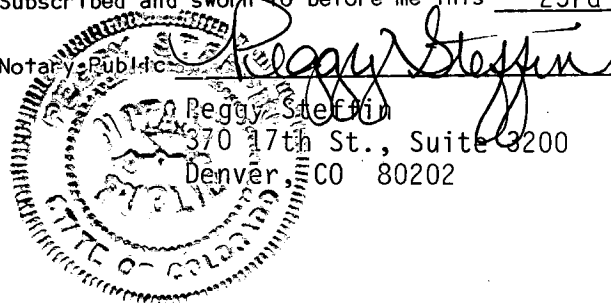

pl

SIDE TWO

Operator Name L.B. Industries, Inc. Lease Name Whipple Well # 34-2

Sec 34 Twp 17S Rge 27  East  West County Lane **RELEASED**

JAN 22 1991

RECOMPLETED FORMATION DESCRIPTION:

FROM CONFIDENTIAL

Log  Sample

Name Top Bottom

Cherokee S.S. 4550' 4606'

ADDITIONAL CEMENTING/SQUEEZE RECORD

Purpose:	Depth		Type of Cement	# Sacks Used	Type & Percent Additives
	Top	Bottom			
Perforate					
Protect Casing					
Plug Back TD					
Plug Off Zone					

Shots Per Foot	PERFORATION RECORD	Acid, Fracture, Shot, Cement Squeeze Record
	Specify Footage of Each Interval Perforated	(Amount and Kind of Material Used)
4	4570'-74'	None
2	4220'-30'	Previously produced interval, currently temporarily abandoned above packer.

PBTD 4657' Plug Type Csg float insert baffle with cement

TUBING RECORD:

Size 2-3/8" OD Set At 4483' KB Packer At 4451' KB Was Liner Run?  Y  N

Date of Resumed Production, Disposal or Injection 8/5/89

Estimated Production Per 24 Hours 32 bbl/oil 0 bbl/water  
TSTM MCF gas -- gas-oil ratio

