

STATE CORPORATION COMMISSION OF KANSAS
OIL & GAS CONSERVATION DIVISION

WELL COMPLETION OR RECOMPLETION FORM
ACO-1 WELL HISTORY

DESCRIPTION OF WELL AND LEASE

Operator: license # 5161
name Palomino Petroleum
address P. O. Box 18610

City/State/Zip Wichita, Kansas 67218

Operator Contact Person Bob Watchous
Phone (316) 683-8152

Contractor: license # 5146 5147
name BEREDCO INC.

Wellsite Geologist Ann Watchous
Phone (316) 683-8152

PURCHASER Clear Creek

Designate Type of Completion
 New Well Re-Entry Workover

Oil SWD Temp Abd
 Gas Inj Delayed Comp.
 Dry Other (Core, Water Supply etc.)

If OWWO: old well info as follows:
Operator
Well Name
Comp. Date Old Total Depth
Conservation Division
Wichita, Kansas

WELL HISTORY

Drilling Method: Mud Rotary Air Rotary Cable
10/3/84 10/11/84 11-2-84
Spud Date Date Reached TD Completion Date
4700' 4695'
Total Depth PBTD

Amount of Surface Pipe Set and Cemented at 288' feet

Multiple Stage Cementing Collar Used? Yes No

If Yes, Show Depth Set feet

If alternate 2 completion, cement circulated
from feet depth to w/ SX cmt

API NO. 15- 101-21,048-00-00

County Lane

NW SE NE Sec 21 Twp 19S Rge 28 K West

3630 Ft North from Southeast Corner of Section
990 Ft West from Southeast Corner of Section
(Note: locate well in section plat below)

Lease Name Mildred Well# 2

Field Name Hinemian East

Producing Formation MISS.

Elevation: Ground 2773 KB 2778

Section Plat

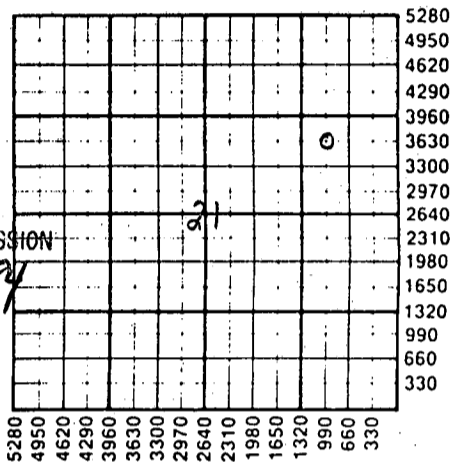

RECEIVED
12-20-1984
DEC 20 1984
STATE CORPORATION COMMISSION
CONSERVATION DIVISION
Wichita, Kansas

WATER SUPPLY INFORMATION

Source of Water:
Division of Water Resources Permit #
 Groundwater Ft North From Southeast Corner and
(Well) Ft. West From Southeast Corner of
Sec Twp Rge East West
 Surface Water Ft North From Southeast Corner and
(Stream, Pond etc.) Ft West From Southeast Corner
Sec Twp Rge East West
 Other (explain) Farmers water-Jerry Erskin
(purchased from city, R.W.D.#)

Disposition of Produced Water: Disposal Repressuring
Docket # CD-18320
C-21,716

INSTRUCTIONS: This form shall be completed in duplicate and filed with the Kansas Corporation Commission, 200 Colorado Derby Building, Wichita, Kansas 67202, within 90 days after completion or recompletion of any well. Rules 82-3-130 and 82-3-107 apply.

Information on side two of this form will be held confidential for a period of 12 months if requested in writing and submitted with the form. See rule 82-3-107 for confidentiality in excess of 12 months.

One copy of all wireline logs and drillers time log shall be attached with this form. Submit CP-4 form with all plugged wells. Submit CP-111 form with all temporarily abandoned wells.

All requirements of the statutes, rules, and regulations promulgated to regulate the oil and gas industry have been fully complied with and the statements herein are complete and correct to the best of my knowledge.

Signature Bob Watchous
Title Owner Date 12-19-84

Subscribed and sworn to before me this 19th day of December 19 84

Notary Public Kathryn L. Frerking
Date Commission Expires August 21, 1985

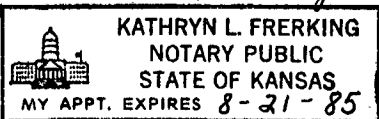

K.C.C. OFFICE USE ONLY
F Letter of Confidentiality Attached
C Wireline Log Received
C Drillers Timelog Received
Distribution
 KCC SWD/Rep NGPA
 KGS Plug Other (Specify)

Sec. 21, Twp. 19, Rge. 28 W

Operator Name Palomino Petroleum Lease Name Mildred Well# 2 SEC. 21 TWP. 19S RGE. 28 East West

WELL LOG

INSTRUCTIONS: Show important tops and base of formations penetrated. Detail all cores. Report all drill stem tests giving interval tested, time tool open and closed, flowing and shut-in pressures, whether shut-in pressure reached static level, hydrostatic pressures, bottom hole temperature, fluid recovery, and flow rates if gas to surface during test. Attach extra sheet if more space is needed. Attach copy of log.

Drill Stem Tests Taken Yes No
 Samples Sent to Geological Survey Yes No
 Cores Taken Yes No

Formation Description
 Log Sample

	Name	Top	Bottom
DST #1	Shale	0'	605'
DST #2	Shale & Sand	605'	2200'
	Lime & Shale	2200'	4085'
DST #3	Lime	4085'	4262'
	Lime & Shale	4262'	4700'
	Mississippi	4646	4700'

PALOMINO PETROLEUM
 BOX 18610 #2 MILDRED 21-19-28W
 WICHITA, KS-67218 NW SE NE
 CONTR BEREDCO, INC. CITY LANE
 GEOL ANN WATCHOUS FIELD HINEMAN EAST
 ELV 2778 KB SPD 10/3/84 CARD ISSUED 11/22/84 IP P 75 BO & 113 BWPD
 MISS 4651-4658

LOG	Tops	Depth/Datum	API 15-101-21,048
ANH	2116+	662	8 5/8 " 288 / 190SX, 5 1/2 " 4696 / 225SX
HEEB	3974-	1196	DST (1) 4190-4262 (LKC) / 30-30-30-30, REC 415'M, 115' OIL, 680' W, SIP 1125-1125#, FP 81-409 / 459-561#
LANS	4013-	1235	DST (2) 4260-4325 (LKC) / 30-30-30-30, REC 186' M & W (2% OIL), 372' MW, SIP 1163-1133#, FP 82-134 / 207-269#
STARK	4292-	1514	DST (3) 4590-4667 (FT SC, MISS) / 30-30-30-30, REC 222' M, 489' OIL, 439' WTR, SIP 1207-1197#, FP 173-387 / 448-540#
FT SC	4551-	1773	MICT - CO, PSTD 4669', PF (MISS) 4651-58, ONFU 2700' FL (1600' OIL & 1100' W), SWB DWN & REC 19 BF (45% OIL) / LAST HR OF 4 HR TST, T&R, POP, P 75 BO & 113 BWPD, 11/2/84
MISS	4646-	1868	
MISS DOL POR	4651-	1873	
RTD<D	4700-	1922	

COPYRIGHT 1984
 INDEPENDENT OIL & GAS SERVICE, INC.
 WICHITA, KANSAS

CASING RECORD <input checked="" type="checkbox"/> new <input type="checkbox"/> used							
Report all strings set - conductor, surface, intermediate, production, etc.							
Purpose of string	size hole drilled	size casing set (in O.D.)	weight lbs/ft.	setting depth	type of cement	# sacks used	type and percent additives
Surface	12-1/4"	8-5/8"	24#	288'	60-40 Poz	190	2% Gel, 3% CC
Production	7-7/8"	5-1/2"	14#	4696'	60-40 Poz	225	2% Gel, 10% Salt 15 bbls Salt Flush
PERFORATION RECORD				Acid, Fracture, Shot, Cement Squeeze Record			
shots per foot	specify footage of each interval perforated			(amount and kind of material used)			Depth
4	4651-58			None			
TUBING RECORD				Liner Run <input type="checkbox"/> Yes <input checked="" type="checkbox"/> No			
Date of First Production		Producing method					
11-2-84		<input type="checkbox"/> flowing <input checked="" type="checkbox"/> pumping <input type="checkbox"/> gas lift <input type="checkbox"/> Other (explain)					
Estimated Production Per 24 Hours	Oil	Gas	Water	Gas-Oil Ratio	Gravity		
	75 Bbls	MCF	113 Bbls	CFPB	36°		

METHOD OF COMPLETION

open hole perforation
 other (specify)

PRODUCTION INTERVAL

4651-4658

Disposition of gas: vented
 sold
 used on lease

Dually Completed.
 Commingled

