

SIDE ONE

STATE CORPORATION COMMISSION OF KANSAS  
OIL & GAS CONSERVATION DIVISION  
WELL COMPLETION OR RECOMPLETION FORM  
ACO-1 WELL HISTORY

API NO. 15-101-21,239-06-00  
County Lane  
E/2 SE NE Sec. 24 Twp. 16S Rge. 27  East  West

DESCRIPTION OF WELL AND LEASE

3300 Ft North from Southeast Corner of Section  
330 Ft West from Southeast Corner of Section  
(Note: Locate well in section plat below)

Operator: License # 6390 and 9067  
Name McDonald-Wallace Petroleum Co., Inc.  
Address and Damar Resources, Inc.  
P. O. Box 70  
City/State/Zip Hays, KS 67601

Lease Name V. McBee Well # 1  
Field Name Prairie Ridge S.W.

Purchaser

Producing Formation  
Elevation: Ground 2666 KB 2674

Operator Contact Person Daniel F. Schjippers  
Phone (913) 625-0020

Contractor: License # 9943  
Name Republic Drilling, Inc.

Wellsite Geologist Ken Wallace  
Phone (316) 265-9444

Designate Type of Completion  
 New Well  Re-Entry  Workover  
 Oil  SWD  Temp Abd  
 Gas  Inj  Delayed Comp.  
 Dry  Other (Core, Water Supply etc.)

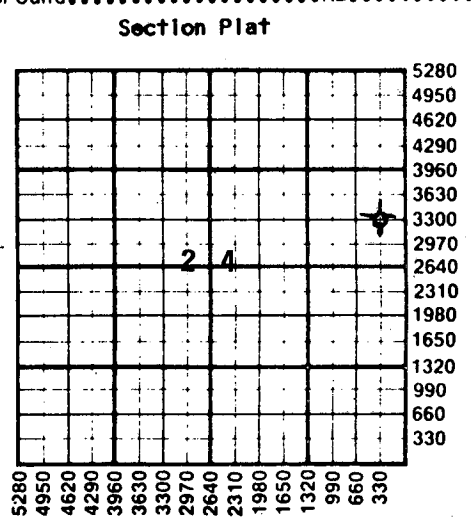

If OWWO: old well info as follows:  
Operator  
Well Name  
Comp. Date Old Total Depth

WATER SUPPLY INFORMATION  
Disposition of Produced Water:  Disposal  Repressuring  
Docket #

WELL HISTORY

Drilling Method:  
 Mud Rotary  Air Rotary  Cable  
10-29-85 11-06-85 11-06-85  
Spud Date Date Reached TD Completion Date  
4577' R.T.D.  
Total Depth PBTD

Questions on this portion of the ACO-1 call:  
Water Resources Board (913) 296-3717  
Source of Water:  
Division of Water Resources Permit # T 85-942  
 Groundwater 3300 Ft North from Southeast Corner (Well) 250 Ft West from Southeast Corner of Sec 24 Twp 16S Rge 27  East  West  
 Surface Water Ft North from Southeast Corner (Stream, pond etc) Ft West from Southeast Corner Sec Twp Rge  East  West  
 Other (explain) (purchased from city, R.W.D. #)

Amount of Surface Pipe Set and Cemented at 296 feet  
Multiple Stage Cementing Collar Used?  Yes  No  
If yes, show depth set feet  
If alternate 2 completion, cement circulated from feet depth to w/ SX cmt

INSTRUCTIONS: This form shall be completed in duplicate and filed with the Kansas Corporation Commission, 200 Colorado Derby Building, Wichita, Kansas 67202, within 90 days after completion or recompletion of any well. Rule 82-3-130 and 82-3-107 apply. Information on side two of this form will be held confidential for a period of 12 months if requested in writing and submitted with the form. See rule 82-3-107 for confidentiality in excess of 12 months. One copy of all wireline logs and drillers time log shall be attached with this form. Submit CP-4 form with all plugged wells. Submit CP-111 form with all temporarily abandoned wells.

All requirements of the statutes, rules and regulations promulgated to regulate the oil and gas industry have been fully complied with and the statements herein are complete and correct to the best of my knowledge.

Signature Daniel F. Schjippers  
Title President Date 12-18-85

K.C.C. OFFICE USE ONLY  
F  Letter of Confidentiality Attached  
C  Wireline Log Received  
C  Drillers Timelog Received  
Distribution  
 KCCON DIVISION SWD/Rep  NGPA  
 WKSsa. Kans.  Plug  Other (Specify)

Subscribed and sworn to before me this 18th day of December 1985  
Notary Public Darlene Pearson

Date Commission Expires 7-10-89



RECEIVED  
STATE CORPORATION COMMISSION  
Form ACO-1 (7-84)

DEC 19 1985

CONSERVATION DIVISION

Sec. 24 Twp. 16S Rge. 27E

Operator Name McDonald-Wallace Petroleum Co., Inc. and DaMar Resources, Inc. Lease Name V. McBee Well # 1

Sec. 24 Twp. 16 S Rge. 27 East West County Lane

WELL LOG

INSTRUCTIONS: Show important tops and base of formations penetrated. Detail all cores. Report all drill stem tests giving interval tested, time tool open and closed, flowing and shut-in pressures, whether shut-in pressure reached static level, hydrostatic pressures, bottom hole temperature, fluid recovery, and flow rates if gas to surface during test. Attach extra sheet if more space is needed. Attach copy of log.

Drill Stem Tests Taken [X] Yes [ ] No
Samples Sent to Geological Survey [ ] Yes [X] No
Cores Taken [ ] Yes [X] No

Formation Description [X] Log [ ] Sample

DST #1 - 4108 - 4170 (H,I)
30-45-60-60
ISIP - 1266 FSIP - 1246
IFP - 50-70 FFP - 80-91
Recovery: 30' SOSpM and 120' WM
DST #2 - 4530-4570 (Miss.)
45-45-60-45
ISIP - 1106 FSIP - 1046
IFP - 40-50 FFP - 50-50
Recovery: 10' HOCM and 60' OCM
DST #3 - 4531 - 4577 (Miss.)
45-45-30-45
ISIP - 1146 FSIP - 1106
IFP - 91-182 FFP - 222-273
Recovery: 240' DM, 60' WM and 300' W

Table with 3 columns: Name, Top, Bottom. Rows include Heebner, Lansing-K.C., Stark Shale, Base Lansing-K.C., Marmaton, Pawnee, Fort Scott, Mississippi, R.T.D., L.T.D.

CASING RECORD [X] New [ ] Used
Report all strings set-conductor, surface, intermediate, production, etc.

Table with 8 columns: Purpose of String, Size Hole Drilled, Size Casing Set (in O.D.), Weight Lbs/Ft., Setting Depth, Type of Cement, #Sacks Used, Type and Percent Additives. Row 1: Surface, 12 1/4", 8 5/8", 23 #, 296', 60/40 pozmix 165, 2% gel, 3% cc

PERFORATION RECORD
Shots Per Foot | Specify Footage of Each Interval Perforated | Acid, Fracture, Shot, Cement Squeeze Record (Amount and Kind of Material Used) | Depth

TUBING RECORD
Size Set At Packer at Liner Run [ ] Yes [ ] No

Date of First Production Producing Method [ ] Flowing [ ] Pumping [ ] Gas Lift [ ] Other (explain)

Table with 5 columns: Oil, Gas, Water, Gas-Oil Ratio, Gravity. Row 1: Estimated Production Per 24 Hours, Bbls, MCF, Bbls, CFPB

METHOD OF COMPLETION Production Interval

Disposition of gas: [ ] Vented [ ] Open Hole [ ] Perforation
[ ] Sold [ ] Other (Specify)
[ ] Used on Lease [ ] Dually Completed [ ] Commingled