

STATE CORPORATION COMMISSION OF KANSAS
OIL & GAS CONSERVATION DIVISION
WELL COMPLETION OR RECOMPLETION FORM
ACO-1 WELL HISTORY
DESCRIPTION OF WELL AND LEASE

Operator: License # 5123
Name Pickrell Drilling Company, Inc.
Address 110 N. Market
Suite 205
City/State/Zip Wichita, KS 67202

Purchaser none

Operator Contact Person Jay McNeil
Phone 262-8427

Contractor: License # 5123
Name Pickrell Drilling Company, Inc.

Wellsite Geologist Billy Klaver
Phone 721-4051

Designate Type of Completion
 New Well Re-Entry Workover
 Oil SWD Temp Abd
 Gas Inj Delayed Comp.
 Dry Other (Core, Water Supply etc.)

If OWNQ: old well info as follows:
Operator
Well Name
Comp. Date Old Total Depth

WELL HISTORY

Drilling Method:
 Mud-Rotary Air Rotary Cable
9-29-88 10-6-88 10-6-88
Spud Date Date Reached TD Completion Date
4290 4293
Total Depth PBD

Amount of Surface Pipe Set and Cemented at 233 feet
Multiple Stage Cementing Collar Used? Yes No
If yes, show depth set feet
If alternate 2 completion, cement circulated from feet depth to w/ SX cmt
Cement Company Name
Invoice #
ALT II DPO

API NO. 15-135-23,293-00-00
County Ness
S/2 S/2 NW 15 16S Rge. 21 East
Sec. Twp. Rge. X West

2970 Ft North from Southeast Corner of Section
3960 Ft West from Southeast Corner of Section
(Note: Locate well in section plat below)

Lease Name Cline Well # 2-B

Field Name Bright South

Producing Formation none

Elevation: Ground 2295 KB 2300

Section Plat

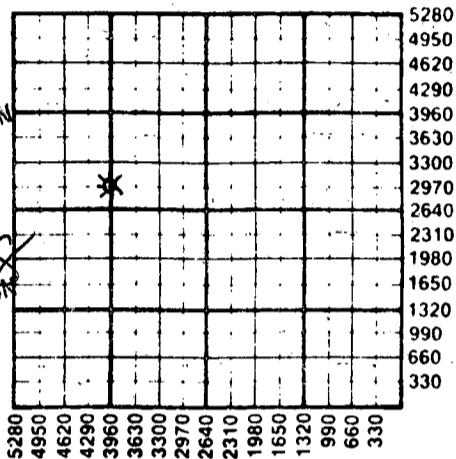

RECEIVED
STATE CORPORATION COMMISSION
OCT 18 1988
10-18-1988
CONSERVATION DIVISION
Wichita, Kansas

WATER SUPPLY INFORMATION

Disposition of Produced Water: Disposal
Docket # Repressuring

Questions on this portion of the ACO-1 call:

Water Resources Board (913) 296-3717

Source of Water:
Division of Water Resources Permit # N/A

Groundwater Ft North from Southeast Corner
(Well) Ft West from Southeast Corner of
Sec Twp Rge East West

X Surface Water Ft North from Southeast Corner
(Stream, pond etc) Ft West from Southeast Corner
Sec 9 Twp 17 Rge 21 East X West

Other (explain)
(purchased from city, R.W.D. #)

INSTRUCTIONS: This form shall be completed in triplicate and filed with the Kansas Corporation Commission, 200 Colorado Derby Building, Wichita, Kansas 67202, within 120 days of the spud date of any well. Rule 82-3-130, 82-3-107 and 82-3-106 apply. Information on side two of this form will be held confidential for a period of 12 months if requested in writing and submitted with the form. See rule 82-3-107 for confidentiality in excess of 12 months. One copy of all wireline logs and drillers time log shall be attached with this form. Submit CP-4 form with all plugged wells. Submit CP-111 form with all temporarily abandoned wells.

All requirements of the statutes, rules and regulations promulgated to regulate the oil and gas industry have been fully complied with and the statements herein are complete and correct to the best of my knowledge.

Signature C.W. Sebitts
Title C.W. Sebitts, President Date 10-10-88

Subscribed and sworn to before me this 10th day of October 1988
Notary Public Katherine J. Rule
Katherine J. Rule

Date Commission Expires June 29, 1992

K.C.C. OFFICE USE ONLY
F Letter of Confidentiality Attached
C Wireline Log Received
C Drillers Timelog Received
Distribution
KCC SWD/Rep NGPA
KGS Plug Other
(Specify)
10-18-88
Form ACO-1 (5-86)



Sec 15 Twp 16 Rge 21 E

SIDE TWO

Operator Name Pickrell Drilling Company, Inc. Lease Name Cline Well # 2-B

Sec. 15 Twp. 16S Rge. 21 East West County Ness

WELL LOG

INSTRUCTIONS: Show important tops and base of formations penetrated. Detail all cores. Report all drill stem tests giving interval tested, time tool open and closed, flowing and shut-in pressures, whether shut-in pressure reached static level, hydrostatic pressures, bottom hole temperature, fluid recovery, and flow rates if gas to surface during test. Attach extra sheet if more space is needed. Attach copy of log.

Drill Stem Tests Taken Yes No
 Samples Sent to Geological Survey Yes No
 Cores Taken Yes No

Formation Description
 Log Sample

DST #1 4115'-4162', 30"-60"-30"-30", Rec. 5' cln oil, 30' OCWM (30%, 15%W, 55%M), 120' SOCMW (5%, 45%M, 50%W), 300' wtr (Chl 30,000 PPM), IFP 111#-152#, FFP 213#-243#, ISIP 801#, FSIP 801#.

DST #2 4199'-4215', 30"-45"-60"-60", Rec. 30 oil, 65' OCM (10%), IFP 81#-81#, FFP 91#-91#, ISIP 528#, FSIP 528#.

DST #3 4197'-4222', 30"-45"-90"-90", Rec. 2' oil, 70' OCM (10%), IFP 81#-81#, FFP 91#-91#, ISIP 528#, FSIP 528#.

Name	Top	Bottom
T/Anhydrite	1594(+706)	
Heebner	3674(-1374)	
Lansing	3718(-1418)	
B/Kansas City	3998(-1698)	
Pawnee	4062(-1762)	
B/Pawnee	4128(-1828)	
Mississippi	4243(-1943)	
LTD	4293'	

CASING RECORD <input checked="" type="checkbox"/> New <input type="checkbox"/> Used							
Report all strings set-conductor, surface, intermediate, production, etc.							
Purpose of String	Size Hole Drilled	Size Casing Set (In O.D.)	Weight Lbs/Ft.	Setting Depth	Type of Cement	#Sacks Used	Type and Percent Additives
Surface	12 1/2"	8 5/8"	20#	233'	60/40poz	150	2%gel 3%cc
PERFORATION RECORD				Acid, Fracture, Shot, Cement Squeeze Record			
Shots Per Foot	Specify Footage of Each Interval Perforated			(Amount and Kind of Material Used)		Depth	
TUBING RECORD				Liner Run <input type="checkbox"/> Yes <input type="checkbox"/> No			
Date of First Production	Producing Method <input type="checkbox"/> Flowing <input type="checkbox"/> Pumping <input type="checkbox"/> Gas Lift <input type="checkbox"/> Other (explain).....						
Estimated Production Per 24 Hours	Oil Bbls	Gas MCF	Water Bbls	Gas-Oil Ratio	Gravity CFPB		

METHOD OF COMPLETION

Production Interval

Disposition of gas: Vented Open Hole Perforation
 Sold Other (Specify)
 Used on Lease Dually Completed
 Commingled

