

15-135-20176-00-00

STATE OF KANSAS
STATE CORPORATION COMMISSION

Form CP-4

Give All Information Completely
Make Required Affidavit
Mail or Deliver Report to:
Conservation Division
State Corporation Commission
212 No. Market
Wichita, Kansas 67202

WELL PLUGGING RECORD

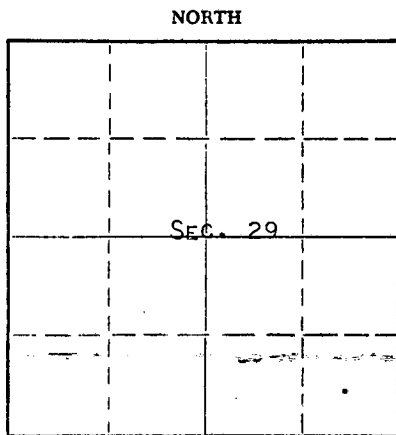

Locate well correctly on above
Section Plat

NESS County. Sec. 29 Twp. 16s Rge. 21 (W)

Location as "NE/CNW/SW" or footage from lines C SE SE
Lease Owner PETROLEUM, INC.,
Lease Name NORTH 'D' Well No. 1
Office Address R.R. #2, GREAT BEND, KANSAS
Character of Well (completed as Oil, Gas or Dry Hole) OIL WELL
Date well completed SEPTEMBER 13 19 68
Application for plugging filed AUGUST 31 19 70
Application for plugging approved SEPTEMBER 1 19 70
Plugging commenced SEPTEMBER 2 19 70
Plugging completed SEPTEMBER 12 19 70
Reason for abandonment of well or producing formation DEPLETION OF PRODUCING ZONE

If a producing well is abandoned, date of last production MAY '1 1969
Was permission obtained from the Conservation Division or its agents before plugging was commenced? YES

Name of Conservation Agent who supervised plugging of this well LEO MASSEY
Producing formation CHEROKEE Depth to top _____ Bottom _____ Total Depth of Well 4280' Feet
Show depth and thickness of all water, oil and gas formations.

OIL, GAS OR WATER RECORDS

CASING RECORD

FORMATION	CONTENT	FROM	TO	SIZE	PUT IN	PULLED OUT
CHEROKEE	SMALL AMOUNT	4132'	4135'	8-5/8"	289'	NONE
	OF WATER & OIL			5-1/2"	4278'	2232'

Describe in detail the manner in which the well was plugged, indicating where the mud fluid was placed and the method or methods used in introducing it into the hole. If cement or other plugs were used, state the character of same and depth placed, from _____ feet to _____ feet for each plug set.

PLUGGED BACK TOTAL DEPTH 4203'. SAND FROM 4203' TO 4100'. GLOBE OILWELL CEMENTING, INC., PUMPED 15 SACKS OF GEL MUD, 2 SACKS OF HULLS, 100 SACKS CEMENT, 5 SACKS OF GEL MUD, 1 SACK OF HULLS AND 20 SACKS OF CEMENT FROM 4100' TO BASE OF WELL CELLAR.

RECEIVED
STATE CORPORATION COMMISSION
SEP 24 1970
CONSERVATION DIVISION
Wichita, Kansas

09-24-1970

(If additional description is necessary, use BACK of this sheet)
Name of Plugging Contractor GLENN & SMITH PIPE PULLING Co.
Address Box 156, ELLINWOOD, KANSAS

STATE OF KANSAS, COUNTY OF BARTON, ss.
MONTE CHADD (employee of owner) or (owner or operator) of the above-described well, being first duly sworn on oath, says: That I have knowledge of the facts, statements and matters herein contained and the log of the above-described well and that the same are true and correct. So help me God. MONTE CHADD, DIST. PROD. SUPT.

(Signature) [Signature]
R.R. #2, GREAT BEND, KANSAS
(Address)

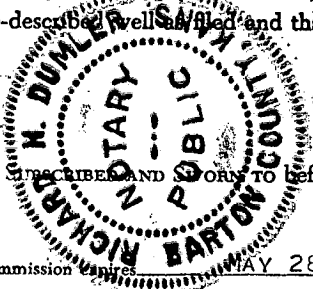

Subscribed and sworn to before me this 22 day of SEPTEMBER, 19 70
Richard H. Dumlauer
Notary Public.

My commission expires MAY 28, 1973

15-135-20176-00-00

WELL LOG

COMPANY Petroleum, Inc.

SEC. 29 T. 16S R. 21W

FARM North

NO. D-1

LOC. SE SE

TOTAL DEPTH 4280'

COUNTY Ness Co., Kansas

COMM. 8-13-68

COMP. 8-25-68

CONTRACTOR Garvey Drilling Company

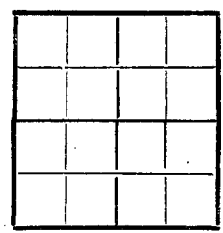

CASING 8 5/8" @ 289' w/190 sx
5 1/2" @ 4278' w/100 sx

ELEVATION 2251' KB

PRODUCTION CHEROKEE

FIGURES INDICATE BOTTOM OF FORMATIONS

- 80' Post Rock
- 470' Shale
- 970' Shale & Shells
- 1190' Sand
- 1540' Red Bed
- 1595' Anhydrite
- 2250' Shale
- 2650' Lime & Shale
- 2723' Lime
- 3795' Lime & Shale
- 4168' Lime
- 4178' Lime, Sand & Chert
- 4245' Lime & Sand
- 4280' Lime
- 4280' RTD

RECEIVED
STATE CORPORATION COMMISSION
SEP 24 1970
CONSERVATION DIVISION
Wichita, Kansas
09-24-1970

State of Kansas
County of Barton

SS

I, Eunice McEachern of Garvey Drilling Company

upon oath state the above and foregoing is a true and correct copy of the log of the North D-1 well.

Eunice McEachern

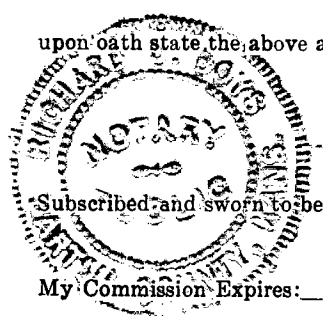

Subscribed and sworn to before me this 28 day of August 19 68

My Commission Expires: November 5th, 1969

Richard A. Days
NOTARY PUBLIC