

15-135-21743-00-00

STATE OF KANSAS  
STATE CORPORATION COMMISSION

WELL PLUGGING RECORD

Give All Information Completely  
Make Required Affidavit  
Mail or Deliver Report to  
Conservation Division  
State Corporation Comm.  
245 North Water  
Wichita, KS 67202

Ness County, Sec. 27 Twp. 16S Rge 21W E/W  
Location as "NE/CNW $\frac{1}{4}$ SW $\frac{1}{4}$ " or footage from lines  
W/2 W/2 SE/4  
Lease Owner Abercrombie Drilling, Inc.  
Lease Name MARTIN Well No. 1  
Office Address 801 Union Center, Wichita, Kansas 67202  
Character of Well (Completed as Oil, Gas or Dry Hole)  
Dry Hole

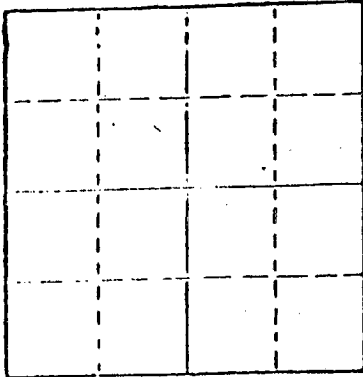

Locate well correctly on above  
Section Plat

Date Well completed March 9 1980  
Application for plugging filed (verbally) March 9 1980  
Application for plugging approved (verbally) March 9 1980  
Plugging commenced March 9 1980  
Plugging completed March 9 1980  
Reason for abandonment of well or producing formation  
No commercial quantity of oil or gas encountered.  
If a producing well is abandoned, date of last production  
19

Was permission obtained from the Conservation Division or  
its agents before plugging was commenced? Yes

Name of Conservation Agent who supervised plugging of this well Marion Schmidt  
Producing formation Depth to top Bottom Total Depth of Well 4180'  
Show depth and thickness of all water, oil and gas formations.

OIL, GAS OR WATER RECORDS

CASING RECORD

FORMATION	CONTENT	FROM	TO	SIZE	PUT IN	PULLED OUT

Describe in detail the manner in which the well was plugged, indicating where the mud fluid  
was placed and the method or methods used in introducing it into the hold. If cement or other  
plugs were used, state the character of same and depth placed, from feet to  
feet for each plug set.

T.D. 4180'.  
Set 1st plug at 660' with 70 sacks  
2nd plug at 240' with 20 sacks  
3rd plug at 40' solid bridge with 10 sacks.  
Cemented with 50/50 posmix, 6% gel.  
Plug was down at 1:00 p.m., 03-09-80.

03-28-1980  
RECEIVED  
STATE CORPORATION COMMISSION  
MAR 28 1980  
CONSERVATION DIVISION  
Wichita, Kansas

(If additional description is necessary, use BACK of this sheet)  
Name of Plugging Contractor Abercrombie Drilling, Inc.

STATE OF Kansas COUNTY OF Sedgwick ss.  
Jack L. Partridge, Asst. Sec.-Treas. (employee of owner) or (owner or operator)  
of the above-described well, being first duly sworn on oath, says: That I have knowledge of  
the facts, statements, and matters herein contained and the log of the above-described well  
as filed and that the same are true and correct. So help me God.

(Signature) Jack L. Partridge  
801 Union Center, Wichita, Kansas 67202  
(Address)

SUBSCRIBED AND SWORN TO before me this 26th day of March, 1980



My commission expires 08-21-82

Sherrie L. Brooks  
Notary Public.

KANSAS

WELL COMPLETION REPORT AND DRILLER'S LOG

API No. 15 - 135 - 21,743 - 00-00  
County Number

S. 27 T. 16S R. 21W E  
Loc. W/2 W/2 SE/4  
County Ness

Operator  
Abercrombie Drilling, Inc.

Address  
801 Union Center, Wichita, Kansas 67202

Well No. 1 Lease Name Martin

Footage Location  
1320 feet from (N) (S) line 2310' feet from (E) (W) line

Principal Contractor Abercrombie Drilling Inc. Geologist Ralph White

Spud Date 02-29-80 Date Completed 03-09-80 Total Depth 4180' P.B.T.D. 4150'

Directional Deviation Oil and/or Gas Purchaser

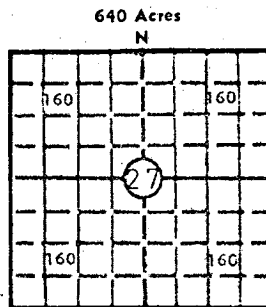

Locate well correctly  
Elev.: Gr. 2247'  
DF 2250' KB 2252'

CASING RECORD

Report of all strings set— surface, intermediate, production, etc.

Purpose of string	Size hole drilled	Size casing set (in O.D.)	Weight lbs/ft.	Setting depth	Type cement	Sacks	Type and percent additives
Surface	12 1/4"	8-5/8"	20#	280.33'	common.	210	3% Ca.Cl. 2% gel.

LINER RECORD

PERFORATION RECORD

Top, ft.	Bottom, ft.	Sacks cement	Shots per ft.	Size & type	Depth interval

Size	Setting depth	Packer set at

ACID, FRACTURE, SHOT, CEMENT SQUEEZE RECORD

Amount and kind of material used

RECEIVED  
STATE CORPORATION COMMISSION  
Depth interval treated  
MAR 28 1980  
03-28-1980  
CONSERVATION DIVISION  
Wichita, Kansas

INITIAL PRODUCTION

Date of first production Producing method (flowing, pumping, gas lift, etc.)

RATE OF PRODUCTION PER 24 HOURS	Oil	Gas	Water	Gas-oil ratio
	bbls.	MCF	bbls.	CFPB

Disposition of gas (vented, used on lease or sold) Producing interval (s)

INSTRUCTIONS: As provided in KCC Rule 82-2-125, within 90 days after completion of a well, one completed copy of this Drillers Log shall be transmitted to the State Geological Survey of Kansas, 4150 Monroe Street, Wichita, Kansas 67209. Copies of this form are available from the Conservation Division, State Corporation Commission, 245 No. Water, Wichita, Kansas 67202. Phone AC 316-522-2206. If confidential custody is desired, please note Rule 82-2-125. Drillers Logs will be on open file in the Oil and Gas Division, State Geological Survey of Kansas, Lawrence, Kansas 66044.

Operator  
Abercrombie Drilling, Inc.

DESIGNATE TYPE OF COMP.: OIL, GAS,  
DRY HOLE, SWDW, ETC.:  
Dry Hole

Well No. 1 Lease Name Martin

S 27 T16S R 21W<sup>E</sup><sub>W</sub>

**WELL LOG**

Show all important zones of porosity and contents thereof; cored intervals, and all drill-stem tests, including depth interval tested, cushion used, time tool open, flowing and shut-in pressures, and recoveries.

SHOW GEOLOGICAL MARKERS, LOGS RUN,  
OR OTHER DESCRIPTIVE INFORMATION.

FORMATION DESCRIPTION, CONTENTS, ETC.	TOP	BOTTOM	NAME	DEPTH
Sand and shale	0	1995	SAMPLE TOPS:	
Shale and red beds	1995	2298		
Sand and shale	2298	2510	Anhydrite	1536'(+ 716)
Shale and lime	2510	2699	B/Anhydrite	1570'(+ 682)
Sand and shale	2699	2886	Heebner	3632'(-1380)
Lime and shale	2886	3791	Lansing	3673'(-1421)
Lime	3791	3913	Cher. Shale	4095'(-1843)
Lime and shale	3913	4008	Ft. Scott	4109'(-1857)
Lime	4008	4114		
Lime and shale	4114	4136		
Lime	4136	4180	ELECTRIC LOG TOPS:	
Rotary Total Depth		4180		
DST #1 (4084-4114') 30", 30", 30" 30"			Anhydrite	1539'(+ 713)
Rec. 10' mud. Weak blow 18".			B/Anhydrite	1573'(+ 679)
IFP 51-40, IBHP 61, FFP 40-40, FBHP 51.			Heebner	3630'(-1378)
DST #2 (4076-4136') 30", 30", 30" 30"			Toronto	3651'(-1399)
Weak blow died 9". Rec. 63' mud.			Lansing	3672'(-1420)
IFP 51-61, IBHP 153, FFP 61-31, FBHP 117.			B/KC	3942'(-1690)
			Pawnee	4024'(-1772)
			B/Pawnee	4096'(-1844)
			Ft. Scott	4110'(-1858)
			Cherokee Sd	4134'(-1882)
			ELTD	4182'
			LTD	4180'

USE ADDITIONAL SHEETS, IF NECESSARY, TO COMPLETE WELL RECORD.

Date Received

Signature: *Jack L. Partridge*

Title: Jack L. Partridge, Asst. Sec.-Treas.

Date: March 26, 1980