

EFFECTIVE DATE: 7-30-91

FORM MUST BE TYPED  
FORM C-1 4/90

State of Kansas

FORM MUST BE SIGNED  
ALL BLANKS MUST BE FILLED

NOTICE OF INTENTION TO DRILL

Must be approved by the K.C.C. five (5) days prior to commencing well

Expected Spud Date July 28 1991 APP. C. NW. NW. Sec 30. Twp 17. S, Rg 30. East West

OPERATOR: License # 3988  
Name: Slawson Exploration Company, Inc.  
Address: 104 South Broadway, Suite 200  
City/State/Zip: Wichita, Kansas 67202-4165  
Contact Person: Steve Slawson  
Phone: (405) 232-0201

CONTRACTOR: License #: 30684  
Name: Abercrombie R.T.D., Inc.

Well Drilled For: Well Class: Type Equipment:  
X Oil Inj Infield X Mud Rotary  
Gas Storage Pool Ext. Air Rotary  
OWWO Disposal X Wildcat Cable  
Seismic; # of Holes

If OWWO: old well information as follows:  
Operator:  
Well Name:  
Comp. Date: Old Total Depth

Directional, Deviated or Horizontal wellbore? yes X no  
If yes, total depth location:

500' feet from South line of Section  
660' feet from East line of Section  
(Note: Locate well on Section Plat on Reverse Side)

County: Lane  
Lease Name: Ramsey "Z" Well #: 2  
Field Name: Wildcat

Is this a Prorated Field? yes X no  
Target Formation(s): Mississippian  
Nearest lease or unit boundary: 500'  
Ground Surface Elevation: 2899' GR (Est) feet MSL  
Domestic well within 330 feet: yes X no  
Municipal well within one mile: yes X no  
Depth to bottom of fresh water: 200' 100'  
Depth to bottom of usable water: 1350' 1550'  
Surface Pipe by Alternate: 1 X 2  
Length of Surface Pipe Planned to be set: 350'  
Length of Conductor pipe required: None  
Projected Total Depth: 4625'

Formation at Total Depth: Mississippian  
Water Source for Drilling Operations:  
unknown will apply well farm pond other  
DWR Permit #: later  
Will Cores Be Taken?: yes X no  
If yes, proposed zone:

AFFIDAVIT

The undersigned hereby affirms that the drilling, completion and eventual plugging of this well will comply with K.S.A. 55-101, et. seq.

It is agreed that the following minimum requirements will be met:

- 1. The appropriate district office shall be notified before setting surface pipe;
- 2. The minimum amount of surface pipe as specified above shall be set by circulating cement to the top; in all cases surface pipe shall be set through all unconsolidated materials plus a minimum of 20 feet into the underlying formation;
- 3. If the well is dry, a plugging proposal shall be submitted to the district office. An agreement between the operator and the district office on plug length and placement is necessary prior to plugging;
- 4. The appropriate district office will be notified before well is either plugged or production casing is cemented in;
- 5. If an Alternate II completion, production pipe shall be cemented from below any usable water to surface within 120 days of spud date. In all cases, notify district office prior to any cementing.

I hereby certify that the statements made herein are true and to the best of my knowledge and belief.

Date: July 23, 1991 Signature of Operator or Agent: W. C. Talbott Title: Kansas Geologist

FOR KCC USE:

API # 15-101-21, 595-00-00  
Conductor pipe required None feet  
Minimum surface pipe required 300 feet per Alt. (2)  
Approved by: M... 7-25-91  
EFFECTIVE DATE: 7-30-91 1-25-92  
This authorization expires:  
(This authorization void if drilling not started within 6 months of effective date.)  
Spud date: Agent:

CONSERVATION DIVISION  
Wichita, Kansas

JUL 25 1991

30 12 30W

REMEMBER TO:

- File Drill Pit Application (form CDP-1) with Intent to Drill;
- File Completion Form ACO-1 within 120 days of spud date;
- File acreage attribution plat according to field proration orders;
- Notify appropriate district office 48 hours prior to workover or re-entry;
- Submit plugging report (CP-4) after plugging is completed;
- Obtain written approval before disposing or injecting salt water.



EFFECTIVE DATE: \_\_\_\_\_

PLAT OF ACREAGE ATTRIBUTABLE TO A WELL

State Corporation Commission, Conservation Division  
200 Colorado Derby Bldg. Wichita, Kansas 67202

OPERATOR Slawson Exploration Co., Inc. LOCATION OF WELL: South NW  
 LEASE Ramsey "Z" 500' feet ~~XXXX~~ of ~~SE~~ corner  
 WELL NUMBER 2 660' feet ~~XXXX~~ of ~~SE~~ corner  
 FIELD Wildcat APP C NW NW Sec. 30 T East 17 R NW 30 ~~N/W~~  
 COUNTY Lane  
 NO. OF ACRES ATTRIBUTABLE TO WELL 40 IS SECTION REGULAR  IRREGULAR?  
 IF IRREGULAR, LOCATE WELL FROM NEAREST  
 DESCRIPTION OF ACREAGE NW/4 CORNER BOUNDARY.

NOTE: If plat depicted is insufficient for your circumstances, you may attach your own scaled or surveyed plat.

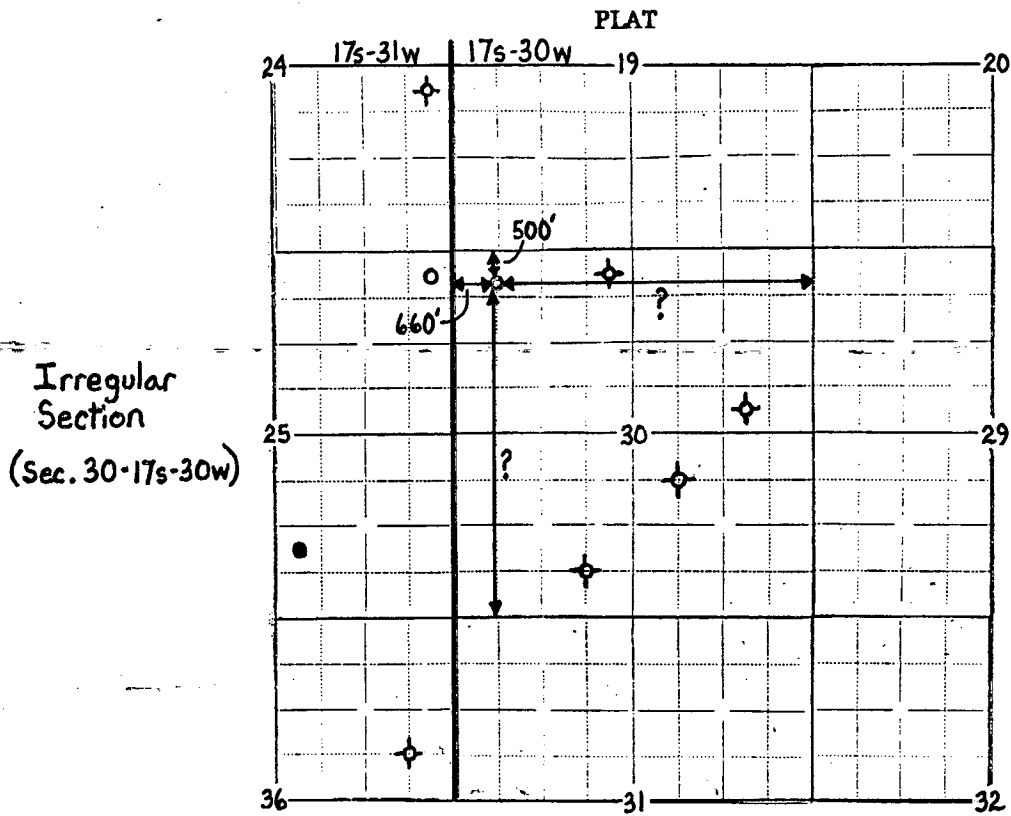

In plotting the proposed location of the well, you must show:

- 1) The manner in which you are using the depicted plat by identifying section lines, i.e. 1 section, 1 section with 8 surrounding partial sections, 4 sections, 16 sections, etc.;
- 2) the well's location relative to the location of other wells producing from the same common source of supply in adjoining drilling units, pursuant to K.A.R. 82-3-108, 82-3-207, 82-3-312, or special orders of the Commission;
- 3) the distance of the proposed drilling location from the section's east and south lines; and
- 4) the distance to the nearest lease or unit boundary line.

I hereby certify that the statements made herein are true and to the best of my knowledge and belief.

Signature of Operator or Agent: W. C. Talbott  
 Date July 23, 1991 title Kansas Geologist

