

FOR KCC USE:

FORM C-1 7/91

FORM MUST BE TYPED

FORM MUST BE SIGNED

ALL BLANKS MUST BE FILLED

EFFECTIVE DATE: 7-7-99

State of Kansas

DISTRICT # 1

NOTICE OF INTENTION TO DRILL

SGA? Yes  No

Must be approved by the K.C.C. five (5) days prior to commencing well.

Expected Spud Date July 5, 1999  
month day year

Spot East  
C.- N/2.- SW/4 Sec .35. Twp .18. S, Rg .28. X West

OPERATOR: License # 30705  
Name: Younger Energy Company  
Address: 453 S. Webb Rd. Suite 100  
City/State/Zip: Wichita, KS 67207  
Contact Person: Gary Younger  
Phone: 316-681-2542

1980 feet from South / North line of Section  
1320 feet from East / West line of Section  
IS SECTION  REGULAR  IRREGULAR?

CONTRACTOR: License #: 30606  
Name: Murfin Drilling Co., Inc.

(NOTE: Locate well on the Section Plat on Reverse Side)  
County: Lane  
Lease Name: Jack Dunne Well #: 1-35  
Field Name: unnamed  
Is this a Prorated/Spaced Field? yes  no   
Target Formation(s): LANSING / KANSAS CITY  
Nearest lease or unit boundary: 1320'  
Ground Surface Elevation: 2691 feet MSL  
Water well within one-quarter mile: yes  no   
Public water supply well within one mile: yes  no   
Depth to bottom of fresh water: 180'  
Depth to bottom of usable water: 1200'  
Surface Pipe by Alternate: 1  2   
Length of Surface Pipe Planned to be set: 250'  
Length of Conductor pipe required: 4700'  
Projected Total Depth: 4700'  
Formation at Total Depth: Lansing/Kansas City  
Water Source for Drilling Operations:  
well  farm pond  other

Well Drilled For: Well Class: Type Equipment:  
 Oil  Enh Rec  Infield  Mud Rotary  
 Gas  Storage  Pool Ext.  Air Rotary  
 OWWO  Disposal  Wildcat  Cable  
 Seismic;  # of Holes  Other  
If OWWO: old well information as follows:  
Operator: \_\_\_\_\_  
Well Name: \_\_\_\_\_  
Comp. Date: \_\_\_\_\_ Old Total Depth \_\_\_\_\_

Directional, Deviated or Horizontal wellbore? yes  no   
If yes, true vertical depth: \_\_\_\_\_  
Bottom Hole Location: \_\_\_\_\_

Will Cores Be Taken? yes  no   
If yes, proposed zone: \_\_\_\_\_

AFFIDAVIT

The undersigned hereby affirms that the drilling, completion and eventual plugging of this well will comply with K.S.A. 55-101, et. seq.  
It is agreed that the following minimum requirements will be met:

1. Notify the appropriate district office prior to spudding of well;
2. A copy of the approved notice of intent to drill shall be posted on each drilling rig;
3. The minimum amount of surface pipe as specified below shall be set by circulating cement to the top; in all cases surface pipe shall be set through all unconsolidated materials plus a minimum of 20 feet into the underlying formation;
4. If the well is dry hole, an agreement between the operator and the district office on plug length and placement is necessary prior to plugging;
5. The appropriate district office will be notified before well is either plugged or production casing is cemented in;
6. IF AN ALTERNATE II COMPLETION, PRODUCTION PIPE SHALL BE CEMENTED FROM BELOW ANY USABLE WATER TO SURFACE WITHIN 120 DAYS OF SPUD DATE. IN ALL CASES, NOTIFY DISTRICT OFFICE PRIOR TO ANY CEMENTING.

I hereby certify that the statements made herein are true and to the best of my knowledge and belief.

Date: 7-2-99 Signature of Operator or Agent: Devin Roberts Title: V.P. Finance

FOR KCC USE:  
API # 15- 101-217680000  
Conductor pipe required NONE feet  
Minimum surface pipe required 200 feet per Alt.  (2)  
Approved by: JK 7-2-99  
This authorization expires: 1-2-2000  
(This authorization void if drilling not started within 6 months of effective date.)  
Spud date: \_\_\_\_\_ Agent: \_\_\_\_\_

RECEIVED  
KANSAS CORPORATION COMMISSION

JUL 02 1999

CONSERVATION DIVISION  
WICHITA, KS

REMEMBER TO:

- File Drill Pit Application (form CDP-1) with Intent to Drill;
- File Completion Form ACO-1 within 120 days of spud date;
- File acreage attribution plat according to field proration orders;
- Notify appropriate district office 48 hours prior to workover or re-entry;
- Submit plugging report (CP-4) after plugging is completed;
- Obtain written approval before disposing or injecting salt water.

Mail to: KCC - Conservation Division, 130 S. Market - Room 2078, Wichita, Kansas 67202.

32  
18  
280

**IN ALL CASES PLOT THE INTENDED WELL ON THE PLAT BELOW**

**PLAT OF ACREAGE ATTRIBUTABLE TO A WELL IN A PRORATED OR SPACED FIELD**

**If the intended well is in a prorated or spaced field, please fully complete this side of the form.** If the intended well is in a prorated or spaced field complete the plat below showing that the well will be properly located in relationship to other wells producing from the common source of supply. Please show all the wells within 1 mile of the boundaries of the proposed acreage attribution unit for gas wells and within 1/2 mile of the boundaries of the proposed acreage attribution unit for oil wells.

API NO. 15- \_\_\_\_\_  
 OPERATOR Younger Energy Company  
 LEASE Jack Dunne  
 WELL NUMBER #1-35  
 FIELD unnamed

LOCATION OF WELL: COUNTY Lane  
1980 feet from south/north line of section  
1320 feet from east/west line of section  
 SECTION 35 TWP 18 RG 28W

NUMBER OF ACRES ATTRIBUTABLE TO WELL \_\_\_\_\_  
 QTR/QTR/QTR OF ACREAGE C - N/2 - SW/4

IS SECTION X REGULAR or \_\_\_\_\_ IRREGULAR  
**IF SECTION IS IRREGULAR, LOCATE WELL FROM NEAREST CORNER BOUNDARY.**

Section corner used: \_\_\_\_\_ NE \_\_\_\_\_ NW \_\_\_\_\_ SE \_\_\_\_\_ SW

**PLAT**

(Show location of the well and shade attributable acreage for prorated or spaced wells.)  
 (Show footage to the nearest lease or unit boundary line.)

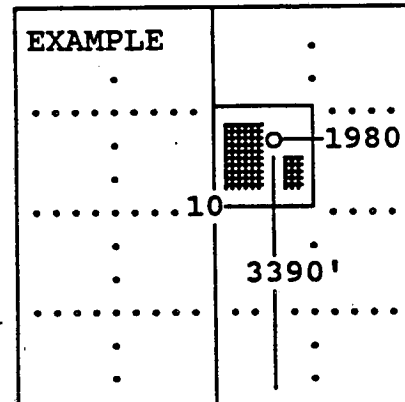
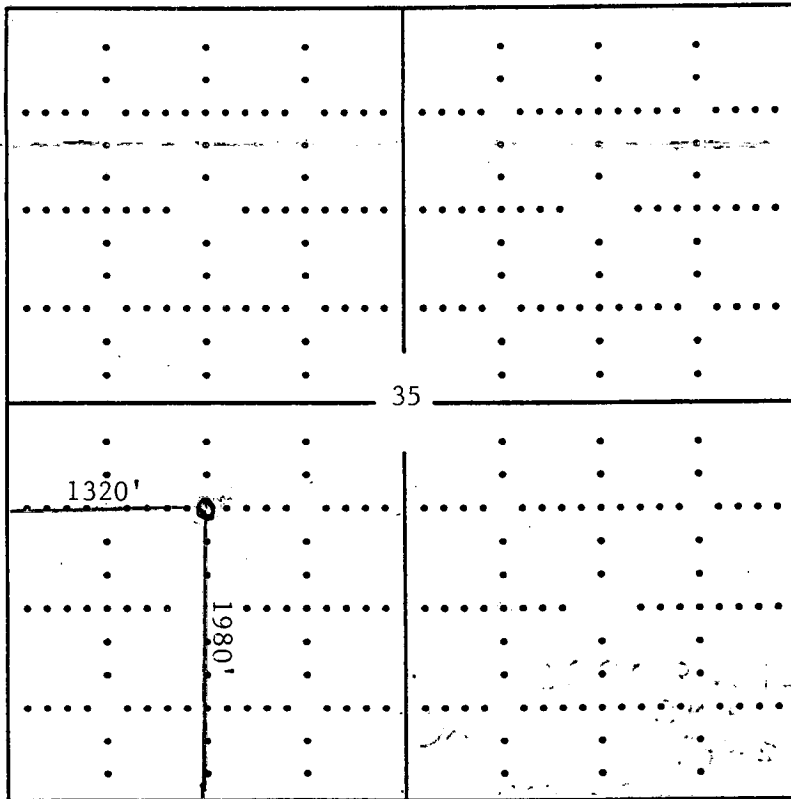

SEWARD CO.

**In plotting the proposed location of the well, you must show:**

- 1) The manner in which you are using the depicted plat by identifying section lines, i.e. 1 section, 1 section with 8 surrounding sections, 4 sections, etc.;
- 2) the distance of the proposed drilling location from the section's south/north and east/west; and
- 3) the distance to the nearest lease or unit boundary line.