

EFFECTIVE DATE: 7-18-94  
DISTRICT # 1/1  
SEA? Yes  No

State of Kansas  
NOTICE OF INTENTION TO DRILL

FORM MUST BE TYPED  
FORM MUST BE SIGNED  
ALL BLANKS MUST BE FILLED

Must be approved by the K.C.C. five (5) days prior to commencing well  
Expected Spud Date August 10th 1994 SW spot SW East  
month day year EN2 W2 SW Sec 17 Twp 16S Rg 27 X West

OPERATOR: License # 6037  
Name: Staab Oil Co.  
Address: 1960 280th Ave  
City/State/Zip: Hays KS 67601  
Contact Person: Francis C. Staab  
Phone: 913-625-5013

1320 330  
330' feet from South / North line of Section  
330' feet from East / West line of Section

IS SECTION X REGULAR IRREGULAR?  
(NOTE: Locate well on the Section Plat on Reverse Side)  
County: Lane  
Lease Name: Albin Well #: 1  
Field Name: W/C

CONTRACTOR: License #: 5655  
Name: Shields Drilling Co.

Is this a Prorated/Spaced Field? yes X no   
Target Formation(s): Lansing-Kansas City  
Nearest lease or unit boundary: 330'

Well Drilled For: Well Class: Type Equipment:  
X Oil ... Enh Rec ... Infield X Mud Rotary  
... Gas ... Storage ... Pool Ext. ... Air Rotary  
... OWWO ... Disposal X Wildcat ... Cable  
... Seismic: ... # of Holes ... Other  
... Other  
If OWWO: old well information as follows:  
Operator:  
Well Name:  
Comp. Date: Old Total Depth

Ground Surface Elevation: N/A feet MSL  
Water well within one-quarter mile: yes X no   
~~Public water supply well within one mile: yes X no~~   
Depth to bottom of fresh water: 400'  
Depth to bottom of usable water: 800' 1300'  
Surface Pipe by Alternate: 1 X 2  
Length of Surface Pipe Planned to be set: 225'  
Length of Conductor pipe required: N/A  
Projected Total Depth: 4400'  
Formation at Total Depth: Lansing-Kansas City  
Water Source for Drilling Operations:  
Running spring water not more X other

Directional, Deviated or Horizontal wellbore? yes X no  
If yes, true vertical depth:  
Bottom Hole Location:

DWR Permit #: than 2' deep  
Will Cores Be Taken?: yes X no  
If yes, proposed zone:

AFFIDAVIT

The undersigned hereby affirms that the drilling, completion and eventual plugging of this well will comply with K.S.A. 55-101, et. seq.  
It is agreed that the following minimum requirements will be met:

1. Notify the appropriate district office prior to spudding of well;
2. A copy of the approved notice of intent to drill shall be posted on each drilling rig;
3. The minimum amount of surface pipe as specified below shall be set by circulating cement to the top of all cases; surface pipe shall be set through all unconsolidated materials plus a minimum of 20 feet into underlying formation;
4. If the well is dry hole, an agreement between the operator and the district office on plug depth and placement is necessary prior to plugging;
5. The appropriate district office will be notified before well is either plugged or production casing is cemented in;
6. IF AN ALTERNATE II COMPLETION, PRODUCTION PIPE SHALL BE CEMENTED FROM BELOW ANY USABLE WATER TO SURFACE WITHIN 120 DAYS OF SPUD DATE. IN ALL CASES, NOTIFY DISTRICT OFFICE PRIOR TO ANY CEMENTING.

I hereby certify that the statements made herein are true and to the best of my knowledge and belief.  
Date: 7-11-94 Signature of Operator or Agent: Francis C. Staab Title: Partner

FOR KCC USE:  
API # 15- 101-21679-00-00  
Conductor pipe required NONE feet  
Minimum surface pipe required 225' feet per Alt. X 2  
Approved by: CS 7-13-94  
This authorization expires: 1-13-95  
(This authorization void if drilling not started within 6 months of effective date.)  
Spud date: \_\_\_\_\_ Agent: \_\_\_\_\_

REMEMBER TO:

- File Drill Pit Application (form CDP-1) with Intent to Drill;
- File Completion Form ACO-1 within 120 days of spud date;
- File acreage attribution plat according to field proration orders;
- Notify appropriate district office 48 hours prior to workover or re-entry;
- Submit plugging report (CP-4) after plugging is completed;
- Obtain written approval before disposing or injecting salt water.

Mail to: Conservation Division, 200 Colorado Derby Building, 202 W. First St., Wichita, Kansas 67202-1286.

RECEIVED  
STATE CORPORATION COMMISSION  
JUL 13 1994  
CONSERVATION DIVISION  
Wichita, Kansas

16  
27

PLAT OF ACREAGE ATTRIBUTABLE TO A WELL IN A PRORATED OR SPACED FIELD

If the intended well is in a prorated or spaced field, please fully complete this side the form. If the intended well is in a prorated or spaced field complete the plat below showing that the well will be properly located in relationship to other wells producing from the common source of supply. Please show all the wells within 1 mile of the boundaries the proposed acreage attribution unit for gas wells and within 1/2 mile of the boundary of the proposed acreage attribution unit for oil wells.

API NO. 15- \_\_\_\_\_  
OPERATOR Staab Oil Co.  
LEASE Albin  
WELL NUMBER 1  
FIELD W/C

LOCATION OF WELL: COUNTY Lane  
1320' feet from south/north line of section  
330 feet from east/west line of section  
SECTION 17 TWP 16S RG 27W

NUMBER OF ACRES ATTRIBUTABLE TO WELL 160  
QTR/QTR/QTR OF ACREAGE CW/2 - W2 - SW

IS SECTION X REGULAR or IRREGULAR  
IF SECTION IS IRREGULAR, LOCATE WELL FROM NEAREST CORNER BOUNDARY.

Section corner used: NE NW SE SW

PLAT

(Show location of the well and shade attributable acreage for prorated or spaced wells. (Show footage to the nearest lease or unit boundary line.)

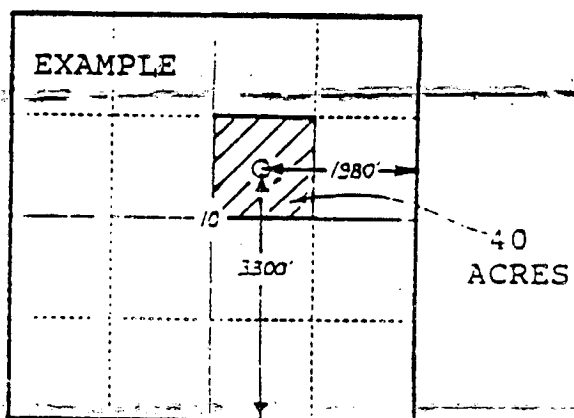
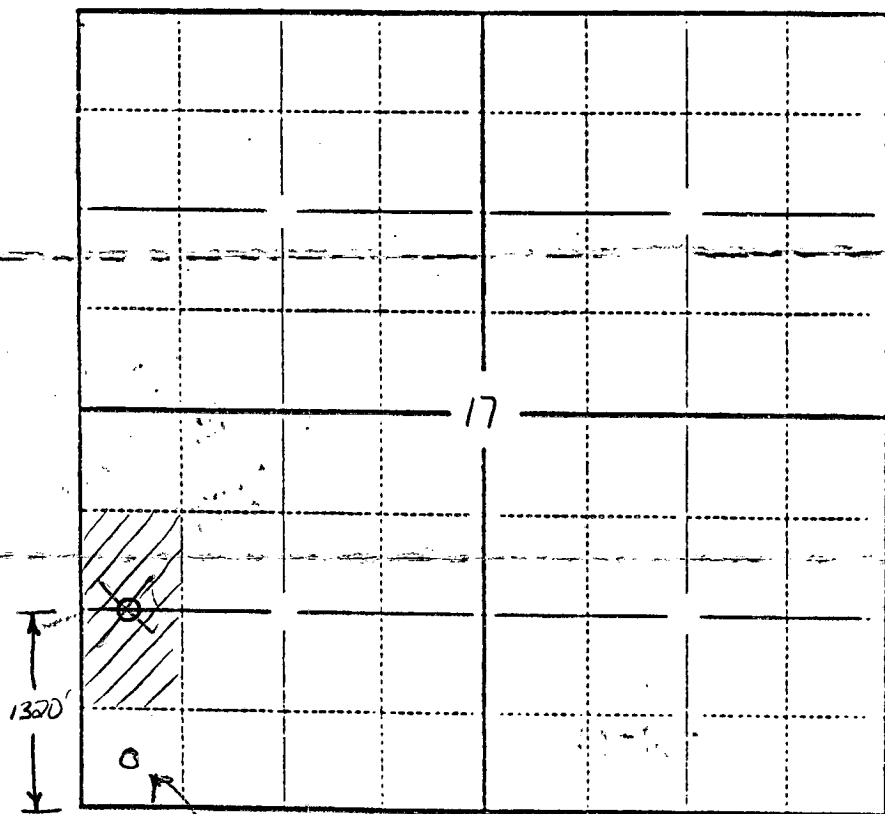

330' as per phone call 7/12/99

In plotting the proposed location of the well, you must show:

- 1) The manner in which you are using the depicted plat by identifying section lines, i. e. 1 section, 1 section with 8 surrounding sections, 4 sections, etc.;
- 2) the distance of the proposed drilling location from the section's south/north and east/west lines; and
- 3) the distance to the nearest lease or unit boundary line.