

FOR KCC USE:

FORM C-1 7/9

EFFECTIVE DATE: 10-19-93

FORM MUST BE TYPE

DISTRICT # 1

State of Kansas
NOTICE OF INTENTION TO DRILL

FORM MUST BE SIGNED

SEAL Yes No

Must be approved by the K.C.C. five (5) days prior to commencing well

ALL BLANKS MUST BE FILLED

Expected Spud Date 10 15 93
month day year

Sec 23 19 28 East
NE SW NW S. Rg West

OPERATOR: License # .09282 ✓
Name: General Atlantic Resources, Inc.
Address: 410 17th Street, Suite 1400
City/State/Zip: Denver, CO 80202
Contact Person: Robert Mowry
Phone: (303) 573-5100

1400 feet from ~~South~~ North line of Section
820 feet from ~~East~~ West line of Section
IS SECTION X REGULAR IRREGULAR?

CONTRACTOR: License #: 8241 ✓
Name: Emphasis Oil Operations

(NOTE: Locate well on the Section Plat on Reverse Side
County: Lane

Well Drilled For: Well Class: Type Equipment:
X Oil ... Enh Rec ... Infield X Mud Rotary
... Gas ... Storage ... Pool Ext. ... Air Rotary
... OWD ... Disposal X Wildcat ... Cable
... Seismic; ... # of Holes ... Other
... Other

Lease Name: Starr Well #: 1
Field Name: Wildcat

If OWD: old well information as follows:
Operator:
Well Name:
Comp. Date: Old Total Depth

Is this a Prorated/Spaced Field? ... yes X no ✓
Target Formation(s): Lansing/Kansas City/Miss...
Nearest lease or unit boundary: .820

Directional, Deviated or Horizontal wellbore? ... yes X no
If yes, true vertical depth:
Bottom Hole Location:

Ground Surface Elevation: .2760 feet MSL
Water well within one-quarter mile: ... yes X no

Public water supply well within one mile: ... yes X no
Depth to bottom of fresh water: .70 ✓
Depth to bottom of usable water: 1220 1200 ✓

Surface Pipe by Alternate: ... 1 XX 2 ✓
Length of Surface Pipe Planned to be set: 220 ✓
Length of Conductor pipe required: 0 ✓

Projected Total Depth: 4700 ✓
Formation at Total Depth: Mississippian ✓

Water Source for Drilling Operations:
X well ... farm pond ... other

DWR Permit #: ...
Will Cores Be Taken?: ... yes X no ✓

If yes, proposed zone: ...

AFFIDAVIT

The undersigned hereby affirms that the drilling, completion and eventual plugging of this well will comply with K.S.A. 55-101, et. seq.
It is agreed that the following minimum requirements will be met:

- 1. Notify the appropriate district office prior to spudding of well;
- 2. A copy of the approved notice of intent to drill shall be posted on each drilling rig;
- 3. The minimum amount of surface pipe as specified below shall be set by circulating cement to the top; in all cases surface pipe shall be set through all unconsolidated materials plus a minimum of 20 feet into the underlying formation;
- 4. If the well is dry hole, an agreement between the operator and the district office on plug length and placement is necessary prior to plugging;
- 5. The appropriate district office will be notified before well is either plugged or production casing is cemented in;
- 6. IF AN ALTERNATE II COMPLETION, PRODUCTION PIPE SHALL BE CEMENTED FROM BELOW ANY USABLE WATER TO SURFACE WITHIN 120 DAYS OF SPUD DATE. IN ALL CASES, NOTIFY DISTRICT OFFICE PRIOR TO ANY CEMENTING.

I hereby certify that the statements made herein are true and to the best of my knowledge and belief.

Date: 10/12/93 Signature of Operator or Agent: Robert D. Mowry Title: Sr. Operations Engineer

FOR KCC USE:
API # 15- 101 -21665-00-00
Conductor pipe required 2100 feet
Minimum surface pipe required 220 feet per Alt. X
Approved by: CR10-14-93
This authorization expires: 4-14-94
(This authorization void if drilling not started within 6 months of effective date.)
Spud date: Agent:

Rec'd
10-14-1993

Stamp: 10/12/93

REMEMBER TO:

- File Drill Pit Application (form CDP-1) with Intent to Drill;
- File Completion Form ACO-1 within 120 days of spud date;
- File acreage attribution plat according to field production orders;
- Notify appropriate district office 48 hours prior to workover or re-entry;
- Submit plugging report (CP-4) after plugging is completed;
- Obtain written approval before disposing or injecting salt water.

Mail to: Conservation Division, 200 Colorado Derby Building, 202 W. First St., Wichita, Kansas 67202-1286.

23
19
28

IN ALL CASES PLOT THE INTENDED WELL ON THE PLAT BELOW

PLAT OF ACREAGE ATTRIBUTABLE TO A WELL IN A PRORATED OR SPACED FIELD

If the intended well is in a prorated or spaced field, please fully complete this side of the form. If the intended well is in a prorated or spaced field complete the plat below showing that the well will be properly located in relationship to other wells producing from the common source of supply. Please show all the wells within 1 mile of the boundaries of the proposed acreage attribution unit for gas wells and within 1/2 mile of the boundaries of the proposed acreage attribution unit for oil wells.

API NO. 15- _____
 OPERATOR General Atlantic Resources, Inc.
 LEASE Starr
 WELL NUMBER #1
 FIELD Wildcat

LOCATION OF WELL: COUNTY Lane
1400 feet from ~~south~~ north line of section
820 feet from ~~east~~ west line of section
 SECTION 23 TWP 19S RG 28W

NUMBER OF ACRES ATTRIBUTABLE TO WELL 40
 QTR/QTR/QTR OF ACREAGE NE - SW - NW

IS SECTION xx REGULAR or IRREGULAR
IF SECTION IS IRREGULAR, LOCATE WELL FROM NEAREST CORNER BOUNDARY.

Section corner used: NE NW SE SW
PLAT

(Show location of the well and shade attributable acreage for prorated or spaced wells.)
 (Show footage to the nearest lease or unit boundary line.)

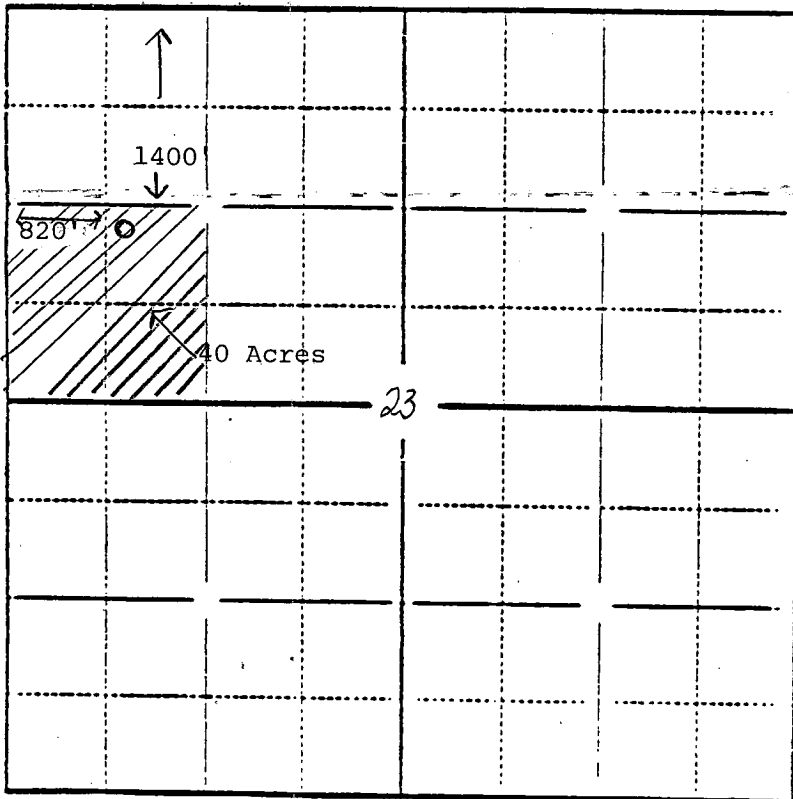

Lane County

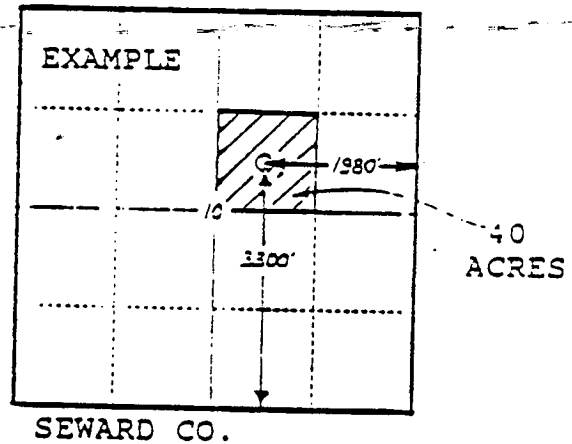

In plotting the proposed location of the well, you must show:

- 1) The manner in which you are using the depicted plat by identifying 1 section, 1 section with 8 surrounding sections, 4 sections, etc.;
- 2) the distance of the proposed drilling location from the section's south/north east/west lines; and
- 3) the distance to the nearest lease or unit boundary line.

RECEIVED
 STATE CORPORATION COMMISSION
 OCT 14 1993
 CONSERVATION DIVISION
 Wichita, Kansas