

FOR KCC USE:

EFFECTIVE DATE: 12-11-91

DISTRICT # 1

SGA7... Yes No

State of Kansas

NOTICE OF INTENTION TO DRILL

FORM C-1 7/91
FORM MUST BE TYPED
FORM MUST BE SIGNED
ALL BLANKS MUST BE FILLED

Must be approved by the K.C.C. five (5) days prior to commencing well

Expected Spud Date 12/01/91
month day year

Spot 110' N of
NW SW SW Sec 25 Twp 19 S. Rg 28 East West

OPERATOR: License # 4767
Name: Ritchie Exploration, Inc.
Address: 125 N. Market, Suite 1000
City/State/Zip: Wichita, KS 67202
Contact Person: Rocky Milford
Phone: 316/267-4375

1100' feet from South/Worth line of Section
4950' feet from East/West line of Section
IS SECTION REGULAR IRREGULAR

(NOTE: Locate well on the Section Plat on Reverse Side)
County: Lane
Lease Name: Schwartz Well #: 6
Field Name: Hackberry Creek South
Is this a Prorated/Spaced Field? ... yes no
Target Formation(s): Lansing-KC
Nearest lease or unit boundary: 330'
Ground Surface Elevation: est. 2732' feet MSL
Water well within one-quarter mile: ... yes no
Public water supply well within one mile: ... yes no
Depth to bottom of fresh water: 75'
Depth to bottom of usable water: 1200' 1150'
Surface Pipe by Alternate: 1 2
Length of Surface Pipe Planned to be set: 200'
Length of Conductor pipe required: none
Projected Total Depth: 4650'
Formation at Total Depth: Mississippian
Water Source for Drilling Operations:
... well ... farm pond other

CONTRACTOR: License #: 5420
Name: White & Ellis Drilling Co.

Well Drilled For: Well Class: Type Equipment:
 Oil ... Enh Rec ... Infield Mud Rotary
 Gas ... Storage Pool Ext. ... Air Rotary
 OWMO ... Disposal ... Wildcat ... Cable
 Seismic: ... # of Holes ... Other
If OWMO: old well information as follows:
Operator: ...
Well Name: ...
Comp. Date: ... Old Total Depth ...

Directional, Deviated or Horizontal wellbore? ... yes no
If yes, true vertical depth: ...
Bottom Hole Location: ...

AFFIDAVIT

The undersigned hereby affirms that the drilling, completion and eventual plugging of this well will comply with K.S.A. 55-101, et. seq.
It is agreed that the following minimum requirements will be met:

- 1. Notify the appropriate district office prior to spudding of well;
- 2. A copy of the approved notice of intent to drill shall be posted on each drilling rig;
- 3. The minimum amount of surface pipe as specified below shall be set by circulating cement to the top; in all cases surface pipe shall be set through all unconsolidated materials plus a minimum of 20 feet into the underlying formation;
- 4. If the well is dry hole, an agreement between the operator and the district office on plug length and placement is necessary prior to plugging;
- 5. The appropriate district office will be notified before well is either plugged or production casing is cemented in;
- 6. IF AN ALTERNATE II COMPLETION, PRODUCTION PIPE SHALL BE CEMENTED FROM BELOW ANY USABLE WATER TO SURFACE WITHIN 120 DAYS OF SPUD DATE. IN ALL CASES, NOTIFY DISTRICT OFFICE PRIOR TO ANY CEMENTING.

I hereby certify that the statements made herein are true and to the best of my knowledge and belief.
Date: 11/21/91 Signature of Operator or Agent: [Signature] Title: Geologist

CONTACT DISTRICT OFFICE PRIOR TO SPUDDING FOR APPROVAL

FOR KCC USE:
API # 15- 101-21,610-00-00
Conductor pipe required none feet
Minimum surface pipe required 200 feet per Alt. (2)
Approved by: [Signature] 12-6-91
This authorization expires: 6-6-92
(This authorization void if drilling not started within 6 months of effective date.)
Spud date: Agent:

RECEIVED STATE CORPORATION COMMISSION

NOV 25 1991
11-25-1991

KCC OFFICE USE ONLY

W 12-6-91 D
OT 2:55 CT
Am

REMEMBER TO:

- File Drill Pit Application (form CDP-1) with Intent to Drill;
- File Completion Form ACO-1 within 120 days of spud date;
- File acreage attribution plat according to field proration orders;
- Notify appropriate district office 48 hours prior to workover or re-entry;
- Submit plugging report (CP-4) after plugging is completed;
- Obtain written approval before disposing or injecting salt water.

Mail to: Conservation Division, 200 Colorado Derby Building, 202 W. First St., Wichita, Kansas 67202-1286.

25
19
2800

IN ALL CASES PLOT THE INTENDED WELL ON THE PLAT BELOW

PLAT OF ACREAGE ATTRIBUTABLE TO A WELL IN A PRORATED OR SPACED FIELD

If the intended well is in a prorated or spaced field, please fully complete this side of the form. If the intended well is in a prorated or spaced field complete the plat below showing that the well will be properly located in relationship to other wells producing from the common source of supply. Please show all the wells within 1 mile of the boundaries of the proposed acreage attribution unit for gas wells and within 1/2 mile of the boundaries of the proposed acreage attribution unit for oil wells.

API NO. 15-
 OPERATOR Ritchie Exploration, Inc.
 LEASE Schwartz
 WELL NUMBER 6
 FIELD Hackberry Creek South

LOCATION OF WELL: COUNTY Lane
1100' feet from south/north line of section
4950' feet from east/west line of section
 SECTION 25 TWP 19S RG 28W

NUMBER OF ACRES ATTRIBUTABLE TO WELL _____
 QTR/QTR/QTR OF ACREAGE NW - SW - SW

IS SECTION X REGULAR or _____ IRREGULAR
IF SECTION IS IRREGULAR, LOCATE WELL FROM NEAREST CORNER BOUNDARY.

Section corner used: NE NW SE SW

PLAT

(Show location of the well and shade attributable acreage for prorated or spaced wells.)
 (Show footage to the nearest lease or unit boundary line.)

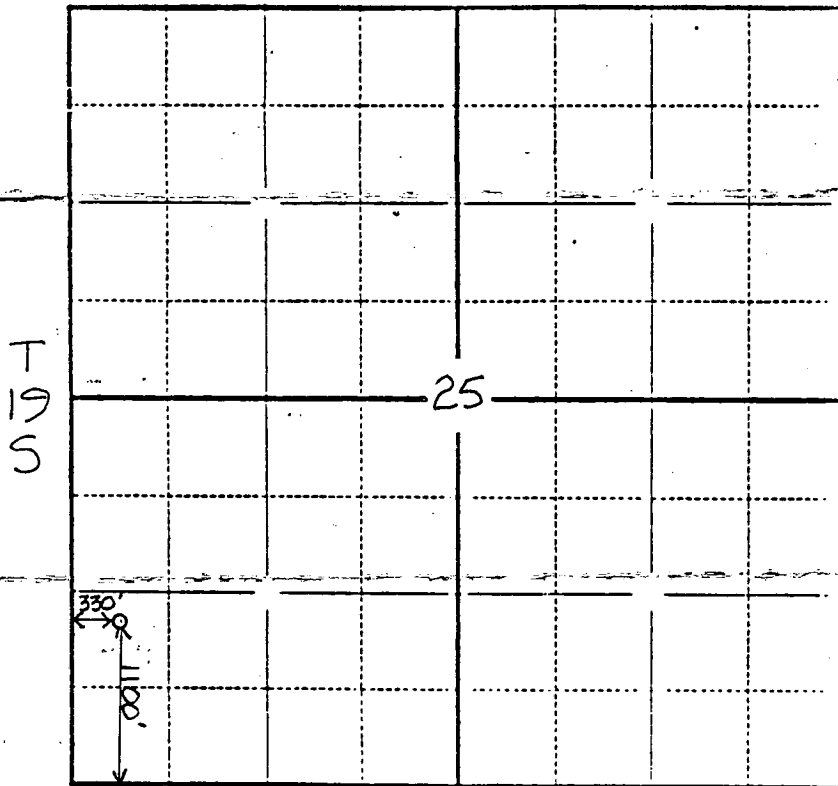

R28W

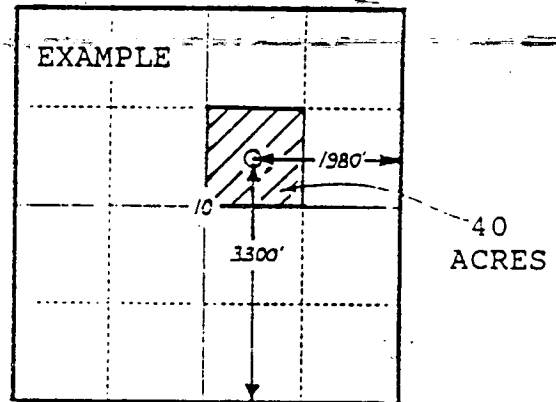

CONTACT DISTRICT
 OFFICE PRIOR
 TO SUBMITTING
 FOR APPROVAL
 THIS OFFICE USE ONLY

In plotting the proposed location of the well, you must show:

- 1) The manner in which you are using the depicted plat by identifying section lines, i.e. 1 section, 1 section with 8 surrounding sections, 4 sections, etc.;
- 2) the distance of the proposed drilling location from the section's south/north and east/west lines; and
- 3) the distance to the nearest lease or unit boundary line.