

EFFECTIVE DATE: 10-17-2000

State of Kansas

FORM MUST BE TYPED

FORM MUST BE SIGNED

DISTRICT # 1

NOTICE OF INTENTION TO DRILL

ALL BLANKS MUST BE FILLED

SGA? YES No

Must be approved by the K.C.C. five (5) days prior to commencing well.

Expected Spud Date: October 28 2000
Month Day Year

Spot SW NW SW Sec 27 Twp 19S Rng 28 East West

OPERATOR: License # 5003
Name: McCoy Petroleum Corporation
Address: P. O. BOX 780208
City/State/Zip: Wichita, KS 67278
Contact Person: Scott Hample
Phone: (316) 636-2737

1650 feet from South / North line of Section
4950 feet from East / West line of Section
IS SECTION REGULAR IRREGULAR?
(NOTE: Locate well on the Section Plat on Reverse Side)

CONTRACTOR: License # 5184
Name: Shields Drilling Co., Inc.

County: Lane
Lease Name: STORMONT "A" Well # 1-27
Field Name: Wildcat

Well Drilled For: Oil Gas OWWO Seismic; Other
Enh Rec Storage Disposal # of Holes
Well Class: Infield Wildcat Other
Type Equipment: Mud Rotary Air Rotary Cable

Is this a Prorated/Spaced Field? yes no
Target Formation(s): LKC
Nearest lease or unit boundary: 330'
Ground Surface Elevation: 2777 feet MSL
Water well within one-quarter mile: yes no
Public water supply well within one mile: yes no
Depth to bottom of fresh water: 180'
Depth to bottom of usable water: 1180'
Surface Pipe by Alternate: 1 2
Length of Surface Pipe Planned to be set: 200'
Length of Conductor Pipe required: none
Projected Total Depth: 4650'
Formation at Total Depth: Mississippian
Water Source for Drilling Operations: well farm pond other

If OWWO: old well information as follows:
Operator: _____
Well Name: _____
Comp. Date: _____ Old Total Depth _____

Farmers own water well
Will Cores Be Taken?: yes no
If yes, proposed zone: _____

Directional, Deviated or Horizontal wellbore? yes no
If yes, true vertical depth _____
Bottom Hole Location _____

AFFIDAVIT

The undersigned hereby affirms that the drilling, completion and eventual plugging of this well will comply with K.S.A. 55-101, et. seq.

It is agreed that the following minimum requirements will be met:

1. Notify the appropriate district office prior to spudding of well;
2. A copy of the approved notice of intent to drill shall be posted on each drilling rig;
3. The minimum amount of surface pipe as specified below shall be set by circulating cement to the top; in all cases surface pipe shall be set through all unconsolidated materials plus a minimum of 20 feet into the underlying formation;
4. If the well is dry hole, an agreement between the operator and the district office on plug length and placement is necessary prior to plugging;
5. The appropriate district office will be notified before well is either plugged or production casing is cemented in;
6. IF AN ALTERNATE II COMPLETION, PRODUCTION PIPE SHALL BE CEMENTED FROM BELOW ANY USABLE WATER TO SURFACE WITHIN 120 DAYS OF SPUD DATE. IN ALL CASES, NOTIFY DISTRICT OFFICE PRIOR TO ANY CEMENTING

I hereby certify that the statements made herein are true and to the best of my knowledge and belief.

Date: 10/11/00 Signature of Operator or Agent: Corey N. Baker Title: Petroleum Geologist
Corey N. Baker

FOR KCC USE:
 API # 15- 101-21784-0000
 Conductor pipe required NONE feet
 Minimum surface pipe required 200 feet per Alt. (2)
 Approved by: JK 10-12-2000
 This authorization expires: 4-12-2001
 (This authorization void if drilling not started within 6 months of effective date.)
 Spud date: _____ Agent: _____

RECEIVED
STATE CORPORATION COMMISSION
OCT 12 2000
10-12-2000
CONSERVATION DIVISION
Wichita, Kansas

REMEMBER TO:

- File Drill Pit Application (form CDP-1) with Intent to Drill;
- File Completion Form ACO-1 within 120 days of spud date;
- File acreage attribution plat according to field proration orders;
- Notify appropriate district office 48 hours prior to workover or re-entry;
- Submit plugging report (CP-4) after plugging is completed;
- Obtain written approval before disposing or injecting salt water.

27
19
28W

IN ALL CASES PLOT THE INTENDED WELL ON THE PLAT BELOW

PLAT OF ACREAGE ATTRIBUTABLE TO A WELL IN A PRORATED OR SPACED FIELD

If the intended well is in a prorated or spaced field, please fully complete this side of the form. If the intended well is in a prorated or spaced field complete the plat below showing that the well will be properly located in relationship to other wells producing from the common source of supply. Please show all the wells within 1 mile of the boundaries of the proposed acreage attribution unit for gas wells and within 1/2 mile of the boundaries of the proposed acreage attribution unit for oil wells.

API NO. 15- _____
 OPERATOR McCoy Petroleum Corporation
 LEASE STORMONT "A"
 WELL NUMBER 1-27
 FIELD Wildcat

LOCATION OF WELL: COUNTY Lane
 1650 feet from south / north line of section
 4950 feet from east / west line of section
 SECTION 27 TWP 19S RG 28W

NUMBER OF ACRES ATTRIBUTABLE TO WELL 40
 QTR/QTR/QTR OF ACREAGE _____ SW _____ SW

IS SECTION X REGULAR or _____ IRREGULAR
 IF SECTION IS IRREGULAR, LOCATE WELL FROM NEAREST
 CORNER BOUNDARY.

Section corner used: _____ NE _____ NW _____ SE _____ SW

PLAT

(Show location of the well and shade attributable acreage for prorated or spaced wells.)
 (Show footage to the nearest lease or unit boundary line.)

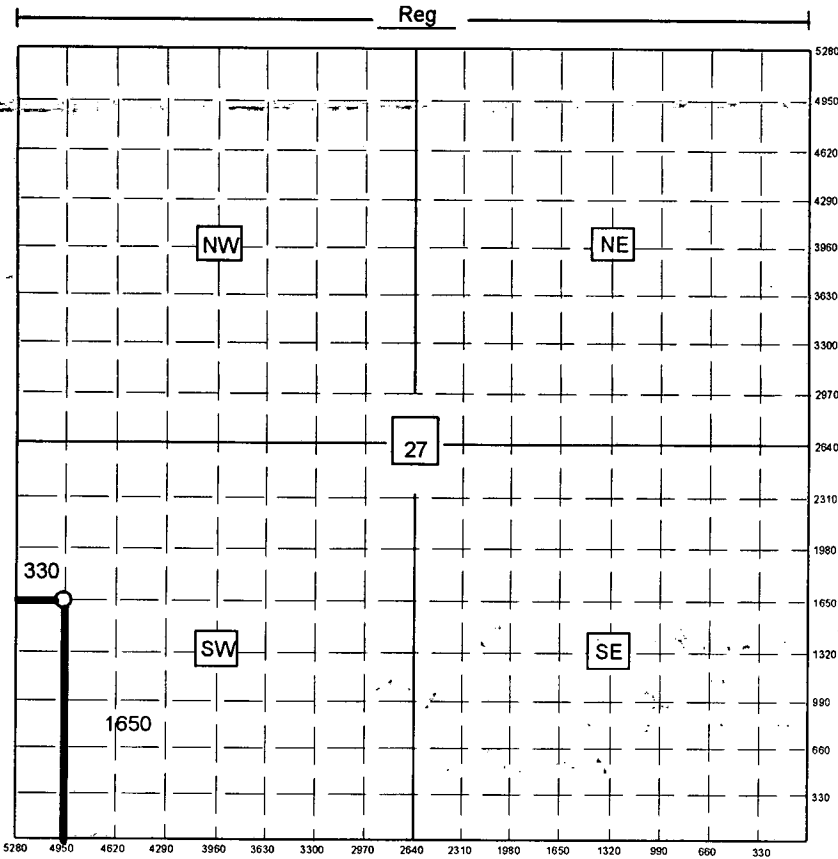

STORMONT "A" #1-27
SW NW SW
Sec 27-19S-28W
Lane County, KS

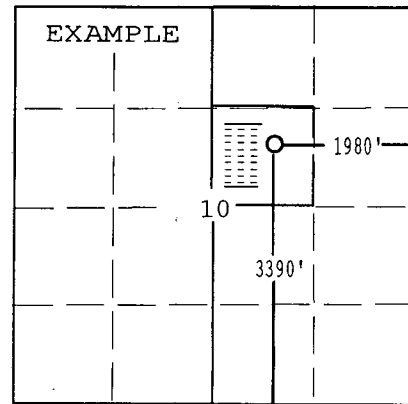

In plotting the proposed location of the well, you must show:

- 1) The manner in which you are using the depicted plat by identifying section, i.e. 1 section, 1 section with 8 surrounding sections, 4 sections, etc.;
- 2) the distance of the proposed drilling location from the section's south/north and east/west; and
- 3) the distance to the nearest lease or unit boundary line.

RECEIVED
 STATE CORPORATION COMMISSION
 OCT 12 2000
 CONSERVATION DIVISION