

CONFIDENTIAL

ORIGINAL

KANSAS CORPORATION COMMISSION
OIL & GAS CONSERVATION DIVISION
WELL COMPLETION FORM
WELL HISTORY - DESCRIPTION OF WELL & LEASE

Form ACO-1
September 1999
Form Must Be Typed

2/9/12

Operator: License # 33476
Name: FIML Natural Resources, LLC
Address: 410 17th Street Ste. 900
City/State/Zip: Denver, CO. 80202
Purchaser: NCRA
Operator Contact Person: Cassandra Parks
Phone: (303) 893-5090
Contractor: Name: Murfin Drilling Company
License: 30606

Wellsite Geologist: _____
Designate Type of Completion:
New Well Re-Entry _____ Workover _____
Oil _____ SWD _____ SLOW _____ Temp. Abd. _____
Gas _____ ENHR _____ SIGW _____
Dry _____ Other (Core, WSW, Expl., Cathodic, etc) _____

If Workover/Re-entry: Old Well Info as follows:
Operator: Edwin C. Schuett

Well Name: Hertel #2
Original Comp. Date: 03/08/1993 Original Total Depth: 3643
Deepening _____ Re-perf. _____ Conv. to Enhr./SWD _____
Plug Back _____ Plug Back Total Depth _____
 Commingled Docket No. TBD CO 021002
Dual Completion _____ Docket No. _____
Other (SWD or Enhr.?) _____ Docket No. _____

11/23/2009 12/14/2009
Spud Date or Date Reached TD Completion Date or Recompletion Date

API No. 15 - 163-23214-0000 01
County: Rooks
NW SE SW Sec. 17 Twp. 8 S. R. 18 [] East [x] West
990 feet from (S) / N (circle one) Line of Section
1650 feet from E (W) (circle one) Line of Section

Footages Calculated from Nearest Outside Section Corner:
(circle one) NE SE NW (SW)
Lease Name: Hertel Well #: 2
Field Name: Sweet
Producing Formation: Lansing and Arbuckle
Elevation: Ground: _____ Kelly Bushing: 2010'
Total Depth: 3463' Plug Back Total Depth: 3463'
Amount of Surface Pipe Set and Cemented at _____ Feet
Multiple Stage Cementing Collar Used? [] Yes [] No
If yes, show depth set _____ Feet
If Alternate II completion, cement circulated from _____
feet depth to _____ w/ _____

Drilling Fluid Management Plan
(Data must be collected from the Reserve Pit)
Chloride content _____ ppm Fluid volume _____ bbls
Dewatering method used _____
Location of fluid disposal if hauled offsite: _____
Operator Name: _____
Lease Name: _____ License No.: _____
Quarter _____ Sec. _____ Twp. _____ S. R. [] East [] West
County: _____ Docket No.: _____

w/o log - 2/12/10
sx cmt.

INSTRUCTIONS: An original and two copies of this form shall be filed with the Kansas Corporation Commission, 130 S. Market - Room 2078, Wichita, Kansas 67202, within 120 days of the spud date, recompletion, workover or conversion of a well. Rule 82-3-130, 82-3-106 and 82-3-107 apply. Information of side two of this form will be held confidential for a period of 12 months if requested in writing and submitted with the form (see rule 82-3-107 for confidentiality in excess of 12 months). One copy of all wireline logs and geologist well report shall be attached with this form. ALL CEMENTING TICKETS MUST BE ATTACHED. Submit CP-4 form with all plugged wells. Submit CP-111 form with all temporarily abandoned wells.

All requirements of the statutes, rules and regulations promulgated to regulate the oil and gas industry have been fully complied with and the statements herein are complete and correct to the best of my knowledge.

Signature: _____
Title: Regulatory Specialist Date: 02/02/2010
Subscribed and sworn to before me this 2nd day of February
20 10
Notary Public: Elizabeth B Lauer
Date Commission Expires: 7-1-2010

KCC Office Use ONLY
Y Letter of Confidentiality Received
If Denied, Yes Date: _____
Wireline Log Received
Geologist Report Received
UIC Distribution
RECEIVED
FEB 11 2010

KCC WICHITA

Operator Name: FIML Natural Resources, LLC Lease Name: Hertel Well #: 2
 Sec. 17 Twp. 8 S. R. 18 East West County: Rooks

INSTRUCTIONS: Show important tops and base of formations penetrated. Detail all cores. Report all final copies of drill stems tests giving interval tested, time tool open and closed, flowing and shut-in pressures, whether shut-in pressure reached static level, hydrostatic pressures, bottom hole temperature, fluid recovery, and flow rates if gas to surface test, along with final chart(s). Attach extra sheet if more space is needed. Attach copy of all Electric Wireline Logs surveyed. Attach final geological well site report.

Drill Stem Tests Taken <input type="checkbox"/> Yes <input type="checkbox"/> No <i>(Attach Additional Sheets)</i> Samples Sent to Geological Survey <input type="checkbox"/> Yes <input type="checkbox"/> No Cores Taken <input type="checkbox"/> Yes <input type="checkbox"/> No Electric Log Run <input type="checkbox"/> Yes <input type="checkbox"/> No <i>(Submit Copy)</i> List All E. Logs Run:	<input type="checkbox"/> Log Formation (Top), Depth and Datum <input type="checkbox"/> Sample Name Top Datum
--	---

CASING RECORD <input type="checkbox"/> New <input type="checkbox"/> Used							
Report all strings set-conductor, surface, intermediate, production, etc.							
Purpose of String	Size Hole Drilled	Size Casing Set (In O.D.)	Weight Lbs./ Ft.	Setting Depth	Type of Cement	# Sacks Used	Type and Percent Additives

ADDITIONAL CEMENTING / SQUEEZE RECORD				
Purpose:	Depth Top Bottom	Type of Cement	#Sacks Used	Type and Percent Additives
<input type="checkbox"/> Perforate				
<input type="checkbox"/> Protect Casing				
<input type="checkbox"/> Plug Back TD				
<input type="checkbox"/> Plug Off Zone				

Shots Per Foot	PERFORATION RECORD - Bridge Plugs Set/Type Specify Footage of Each Interval Perforated	Acid, Fracture, Shot, Cement Squeeze Record (Amount and Kind of Material Used)	Depth
4	3280-3282'	Acidized with 500 gal 15% MCA	3280-82'
4	3338-3340'	Acidized with 500 gal 15% MCA	3338-40'
	3280-3282' & 3338-3340'	Acidized with 1500 gal 28% N-E	
	3448-3463' (existing)	Acidized with 3000 gal 28% INS	
			3448-63'

TUBING RECORD	Size 2-3/8"	Set At 3459'	Packer At	Liner Run <input type="checkbox"/> Yes <input type="checkbox"/> No
Date of First, Resumed Production, SWD or Enhr. 12/19/2009		Producing Method <input type="checkbox"/> Flowing <input checked="" type="checkbox"/> Pumping <input type="checkbox"/> Gas Lift <input type="checkbox"/> Other (Explain)		
Estimated Production Per 24 Hours	Oil Bbls. 17	Gas Mcf	Water Bbls. 18	Gas-Oil Ratio

Disposition of Gas: Vented Sold Used on Lease *(If vented, Submit ACO-18.)*

METHOD OF COMPLETION: Open Hole Perf. Dually Comp. Commingled

Production Interval: Other (Specify) _____

Application for commingling is attached

FIML NATURAL RESOURCES, LLC

February 9, 2010

Kansas Corporation Commission
Conservation Division
130 S. Market, Room 2078
Wichita, KS 67202-3802

RE: Hertel #2
NW/SE/SW Sec 17 T-8S R-18W
Rooks County, Kansas

KCC
FEB 09 2010
CONFIDENTIAL

Dear Sir or Madam:

Enclosed are the following for the above referenced well:

Well Completion Form (ACO-1)
Perf-Tech CBL (1 original)
Application For Commingling of Production
½ Mile Radius Plat
Offset Operator Notification Certification
Proof of Publication-Wichita Eagle
Proof of Publication-Stockton Sentinel

FIML Natural Resources, LLC is requesting that you hold all well logs and side 2 of Form ACO-1 (Well Completion Form) confidential for the maximum length allowed by the Kansas Corporation Commission rules and regulations.

If you should require further information or have any questions, please feel free to contact Cassie Parks at 303-893-5090 or Cassandra.parks@fmr.com.

Sincerely,



Cassandra Parks
Regulatory Specialist

/cp
Enclosures:

RECEIVED
FEB 11 2010
KCC WICHITA

February 25, 2010

Cassie Parks
FIML Natural Resources, LLC
410 17th Street, Suite 900
Denver, CO 80202

RE: Approved Commingling CO021002
Hertel #2, Sec. 17-T8S-R18W, Rooks County
API No. 15-163-23214-00-01

Dear Ms. Parks:

Your Application for Commingling (ACO-4) for the above described well has been reviewed and approved by the Kansas Corporation Commission (KCC) per K.A.R. 82-3-123. Notice was examined and found to be proper per K.A.R. 82-3-135a. No protest had been filed within the 15-day protest period. This application, which was received by the KCC on February 11, 2010 concerns approval to simultaneously produce from the following sources of supply through the same tubing string in the same wellbore:

Source of Supply	Estimated Current Production			Perf Depth
	BOPD	MCFPD	BWPD	
Lansing	25	0	30	3280-3282 & 3338-3340
Arbuckle	5	0	2	3448-3463
Total Estimated Current Production	30	0	32	

Based upon the depth of the Arbuckle formation perforations, total oil production shall not exceed 100 BOPD and total gas production shall not exceed 50% of the absolute open flow (AOF).

Docket Number CO021002 has been assigned to this approved application. Use this number for well completion reports (ACO-1) and other correspondence that may concern this approved commingling.

Sincerely,



Rick Hestermann
Production Department

KANSAS CORPORATION COMMISSION
OIL & GAS CONSERVATION DIVISION

Form ACO-4
Form must be typed
July 2006

APPLICATION FOR COMMINGLING OF
PRODUCTION (K.A.R. 82-3-123) OR FLUIDS (K.A.R. 82-3-123a)

Commingling ID # C O Q2 1002

Operator Information:

License #: 33476
Name: FIML Natural Resources, LLC
Address: 41017th Street, Suite 900
City/State/Zip: Denver, CO. 80202
Contact Person: Cassie Parks
Phone #: 303-893-5090

Well Information:

API #: 15 - 163--23214-00 -01
Lease Name: Hertel Well #: 2
Spot: - NW - SE - SW Sec. 17 Twp. 8 S. R. 18 East West
County: Rooks
Feet from North / South Line of Section: 990
Feet from East / West Line of Section: 1650

1. Name and upper and lower limit of each production interval to be commingled:
Formation: Lansing (Perfs): 3280-3282' & 3338-3340'
Formation: Arbuckle (Perfs): 3448-3463'
Formation: _____ (Perfs): _____
Formation: _____ (Perfs): _____
Formation: _____ (Perfs): _____

2. Estimated amount of fluid production to be commingled from each interval:
Formation: Lansing BOPD: 25 MCFPD: _____ BWPD: 30
Formation: Arbuckle BOPD: 5 MCFPD: _____ BWPD: 2
Formation: _____ BOPD: _____ MCFPD: _____ BWPD: _____
Formation: _____ BOPD: _____ MCFPD: _____ BWPD: _____
Formation: _____ BOPD: _____ MCFPD: _____ BWPD: _____

3. Plat map showing the location of the subject well, all other wells on the subject lease, and all wells on offsetting leases within a 1/2 mile radius of the subject well, and for each well the names and addresses of the lessee of record or operator.

4. Signed certificate showing service of the application and affidavit of publication as required in K.A.R. 82-3-135a.

For Commingling of PRODUCTION ONLY, include the following:

- 5. Wireline log of subject well. w/ACO1
- 6. Complete Form ACO-1 (Well Completion form) for the subject well.

For Commingling of FLUIDS ONLY, include the following:

- _____ 5. Well construction diagram of subject well.
- _____ 6. Any available water chemistry data demonstrating the compatibility of the fluids to be commingled.

State of Colorado)
)
County of Denver)

ss:

VERIFICATION: I hereby certify that to the best of my current information, knowledge and personal belief, this request for commingling is true and proper and I have no information or knowledge, which is inconsistent with the information supplied in this application.

Signature: Cassie Parks
Printed Name: Cassie Parks
Title: Regulatory Specialist

Subscribed & sworn to before me this 8 day of February, 20 10
Notary Public: Elaine Winick
My Commission Expires: 5/5/2013

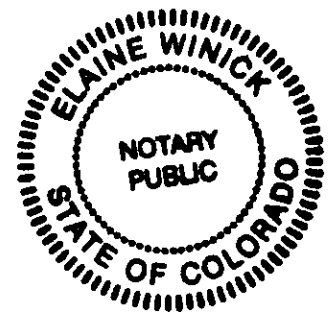

KCC Office Use Only
 Denied Approved
KCC Date Received: _____ 15-Day Periods Ends: _____
Approved By: _____ Date: _____

Protests may be filed by any party having a valid interest in the application. Protests must be in writing and comply with K.A.R. 82-3-135b and must be filed within 15 days of publication of the notice of application.

**KANSAS CORPORATION COMMISSION
OIL & GAS CONSERVATION DIVISION
WELL COMPLETION FORM
WELL HISTORY - DESCRIPTION OF WELL & LEASE**

Form ACO-1
September 1999
Form Must Be Typed

Operator: License # 33476
Name: FIML Natural Resources, LLC
Address: 410 17th Street Ste. 900
City/State/Zip: Denver, CO. 80202
Purchaser: NCRA
Operator Contact Person: Cassandra Parks
Phone: (303) 893-5090
Contractor: Name: Murfin Drilling Company
License: 30606
Wellsite Geologist: _____

Designate Type of Completion:
____ New Well Re-Entry ____ Workover
____ Oil ____ SWD ____ SLOW ____ Temp. Abd.
____ Gas ____ ENHR ____ SIGW
____ Dry ____ Other (Core, WSW, Expl., Cathodic, etc)

If Workover/Re-entry: Old Well Info as follows:
Operator: Edwin C. Schuett

Well Name: Hertel #2
Original Comp. Date: 03/08/1993 Original Total Depth: 3643
____ Deepening ____ Re-perf. ____ Conv. to Enhr./SWD
____ Plug Back ____ Plug Back Total Depth
 Commingled Docket No. TBD
____ Dual Completion Docket No. _____
____ Other (SWD or Enhr.?) Docket No. _____

<u>11/23/2009</u>	<u>12/14/2009</u>
Spud Date or Recompletion Date	Date Reached TD Completion Date or Recompletion Date

API No. 15 - 163-23214-0000
County: Rooks
____ NW ____ SE ____ SW Sec. 17 Twp. 8 S. R. 18 East West
990 feet from (S) / N (circle one) Line of Section
1650 feet from E (W) (circle one) Line of Section

Footages Calculated from Nearest Outside Section Corner:
(circle one) NE SE NW (SW)
Lease Name: Hertel Well #: 2
Field Name: Sweet
Producing Formation: Lansing and Arbuckle
Elevation: Ground: _____ Kelly Bushing: 2010'
Total Depth: 3463' Plug Back Total Depth: 3463'
Amount of Surface Pipe Set and Cemented at _____ Feet
Multiple Stage Cementing Collar Used? Yes No
If yes, show depth set _____ Feet
If Alternate II completion, cement circulated from _____
feet depth to _____ w/ _____ sx cmt.

Drilling Fluid Management Plan
(Data must be collected from the Reserve Pit)
Chloride content _____ ppm Fluid volume _____ bbls
Dewatering method used _____
Location of fluid disposal if hauled offsite: _____
Operator Name: _____
Lease Name: _____ License No.: _____
Quarter _____ Sec. _____ Twp. _____ S. R. _____ East West
County: _____ Docket No.: _____

INSTRUCTIONS: An original and two copies of this form shall be filed with the Kansas Corporation Commission, 130 S. Market - Room 2078, Wichita, Kansas 67202, within 120 days of the spud date, recompletion, workover or conversion of a well. Rule 82-3-130, 82-3-106 and 82-3-107 apply. Information of side two of this form will be held confidential for a period of 12 months if requested in writing and submitted with the form (see rule 82-3-107 for confidentiality in excess of 12 months). One copy of all wireline logs and geologist well report shall be attached with this form. ALL CEMENTING TICKETS MUST BE ATTACHED. Submit CP-4 form with all plugged wells. Submit CP-111 form with all temporarily abandoned wells.

All requirements of the statutes, rules and regulations promulgated to regulate the oil and gas industry have been fully complied with and the statements herein are complete and correct to the best of my knowledge.

Signature: [Signature]
Title: Regulatory Specialist Date: 02/02/2010
Subscribed and sworn to before me this 2nd day of February,
20 10.
Notary Public: [Signature]
Date Commission Expires: 7-1-2010

KCC Office Use ONLY

____ Letter of Confidentiality Received
If Denied, Yes Date: _____
____ Wireline Log Received
____ Geologist Report Received
____ UIC Distribution

RECEIVED
FEB 11 2010

KCC WICHITA

Operator Name: FIML Natural Resources, LLC Lease Name: Hertel Well #: 2
 Sec. 17 Twp. 8 S. R. 18 East West County: Rooks

INSTRUCTIONS: Show important tops and base of formations penetrated. Detail all cores. Report all final copies of drill stems tests giving interval tested, time tool open and closed, flowing and shut-in pressures, whether shut-in pressure reached static level, hydrostatic pressures, bottom hole temperature, fluid recovery, and flow rates if gas to surface test, along with final chart(s). Attach extra sheet if more space is needed. Attach copy of all Electric Wireline Logs surveyed. Attach final geological well site report.

Drill Stem Tests Taken <input type="checkbox"/> Yes <input type="checkbox"/> No <i>(Attach Additional Sheets)</i> Samples Sent to Geological Survey <input type="checkbox"/> Yes <input type="checkbox"/> No Cores Taken <input type="checkbox"/> Yes <input type="checkbox"/> No Electric Log Run <input type="checkbox"/> Yes <input type="checkbox"/> No <i>(Submit Copy)</i> List All E. Logs Run:	<input type="checkbox"/> Log Formation (Top), Depth and Datum <input type="checkbox"/> Sample Name Top Datum
--	---

CASING RECORD <input type="checkbox"/> New <input type="checkbox"/> Used							
Report all strings set-conductor, surface, intermediate, production, etc.							
Purpose of String	Size Hole Drilled	Size Casing Set (In O.D.)	Weight Lbs. / Ft.	Setting Depth	Type of Cement	# Sacks Used	Type and Percent Additives

ADDITIONAL CEMENTING / SQUEEZE RECORD				
Purpose:	Depth Top Bottom	Type of Cement	#Sacks Used	Type and Percent Additives
<input type="checkbox"/> Perforate <input type="checkbox"/> Protect Casing <input type="checkbox"/> Plug Back TD <input type="checkbox"/> Plug Off Zone				

Shots Per Foot	PERFORATION RECORD - Bridge Plugs Set/Type Specify Footage of Each Interval Perforated	Acid, Fracture, Shot, Cement Squeeze Record <i>(Amount and Kind of Material Used)</i>	Depth
4	3280-3282'	Acidized with 500 gal 15% MCA	3280-82'
4	3338-3340'	Acidized with 500 gal 15% MCA	3338-40'
	3280-3282' & 3338-3340'	Acidized with 1500 gal 28% N-E	
	3448-3463' (existing)	Acidized with 3000 gal 28% INS	
			3448-63'

TUBING RECORD	Size <u>2-3/8"</u> Set At <u>3459'</u>	Packer At	Liner Run <input type="checkbox"/> Yes <input type="checkbox"/> No
---------------	--	-----------	--

Date of First, Resumerd Production, SWD or Enhr. <u>12/19/2009</u>	Producing Method <input type="checkbox"/> Flowing <input checked="" type="checkbox"/> Pumping <input type="checkbox"/> Gas Lift <input type="checkbox"/> Other (Explain)
---	--

Estimated Production Per 24 Hours	Oil Bbls. <u>17</u>	Gas Mcf	Water Bbls. <u>18</u>	Gas-Oil Ratio	Gravity
-----------------------------------	------------------------	---------	--------------------------	---------------	---------

Disposition of Gas <input type="checkbox"/> Vented <input type="checkbox"/> Sold <input type="checkbox"/> Used on Lease <i>(If vented, Submit ACO-18.)</i>	METHOD OF COMPLETION <input type="checkbox"/> Open Hole <input type="checkbox"/> Perf. <input type="checkbox"/> Dually Comp. <input checked="" type="checkbox"/> Commingled <input type="checkbox"/> Other (Specify)	Production Interval Application for commingling is attached
---	--	---

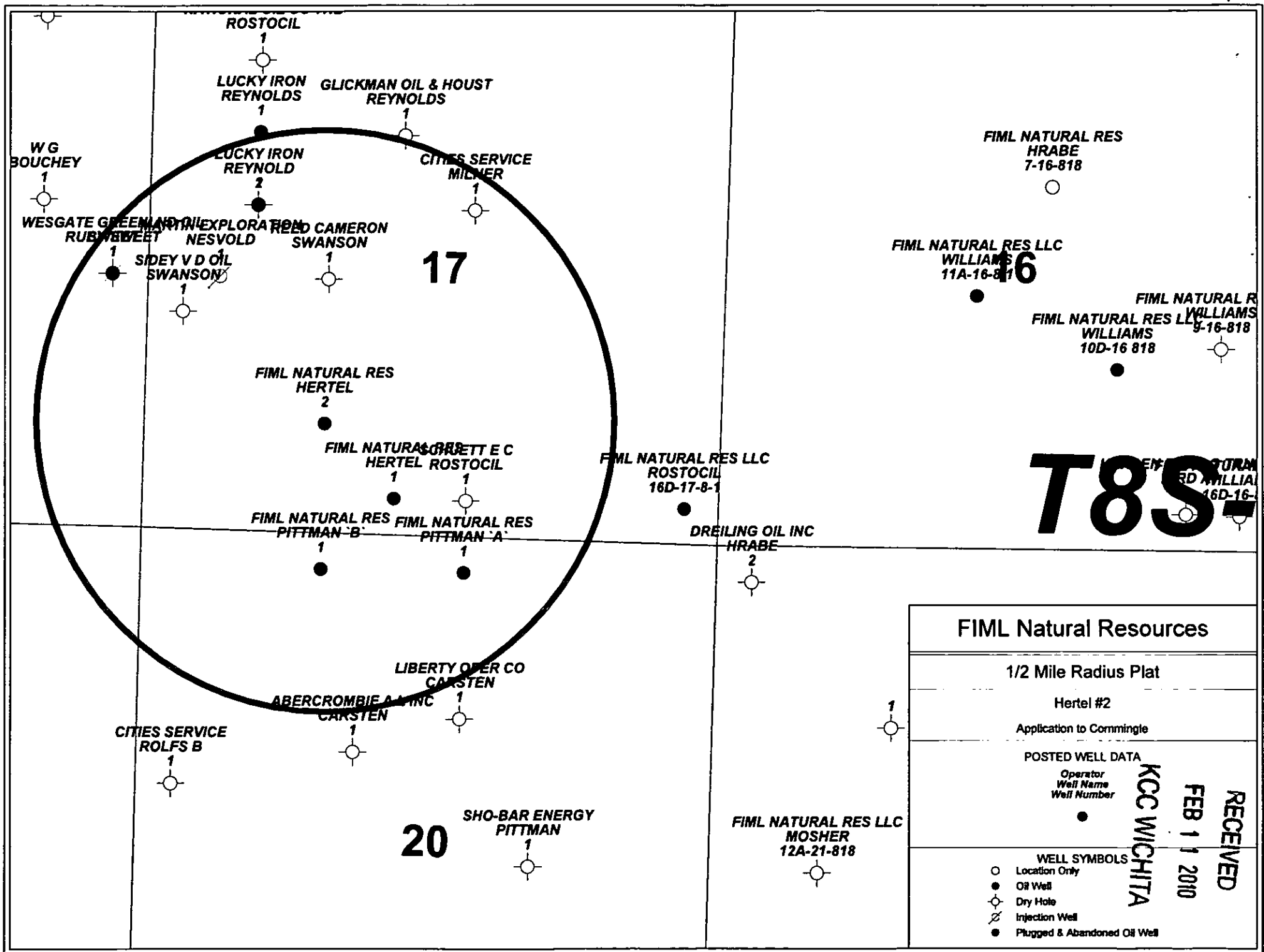

FIML Natural Resources	
1/2 Mile Radius Plat	
Hertel #2	
Application to Commingle	
POSTED WELL DATA	KCC WICHITA FEB 11 2010 RECEIVED
Operator Well Name Well Number	
<ul style="list-style-type: none"> ○ Location Only ● Oil Well ⊕ Dry Hole ⊗ Injection Well ● Plugged & Abandoned Oil Well 	

**Offset Operators/Lessee of Record and Unleased Mineral Owners Within a ½ Mile
Radius of the Hertel #2**

The undersigned hereby certifies that she/he is a duly authorized agent for the applicant, and that a true and correct copy of the ACO-16 was mailed to the following parties:

Lucky Iron-Operator
Attn: Gene Smith
P.O. Box 8
Plainville, KS 67663

High Plains Energy Partners, LLC
1560 Broadway, Suite 2100
Denver, CO 80202

Samuel Gary, Jr. & Associates
1560 Broadway, Suite 2100
Denver, CO 80202

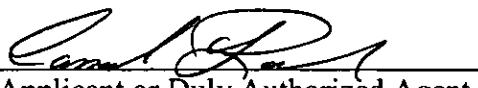
Cassandra Parks, Regulatory Specialist
Applicant or Duly Authorized Agent

Subscribed and sworn before me this 9th of February 2010

Notary Public

My commission expires: 7-1-2010

RECEIVED
FEB 11 2010
KCC WICHITA

AFFIDAVIT

STATE OF KANSAS \
- SS.
County of Sedgwick /

Mark Fletchall, of lawful age, being first duly sworn, depose and saith: That he is Record Clerk of The Wichita Eagle, a daily newspaper published in the City of Wichita, County of Sedgwick, State of Kansas, and having a general paid circulation on a daily basis in said County, which said newspaper has been continuously and uninterruptedly published in said County for more than one year prior to the first publication of the notice hereinafter mentioned, and which said newspaper has been entered as second class mail matter at the United States Post Office in Wichita, Kansas, and which said newspaper is not a trade, religious or fraternal publication and that a notice of a true copy is hereto attached was published in the regular and entire Morning issue of said The Wichita Eagle for 1 issues - weeks, that the first publication of said notice was

made as aforesaid on the 6th of

January A.D. 2010, with subsequent publications being made on the following dates:

And affiant further says that he has personal knowledge of the statements above set forth and that they are true.

Mark Fletchall

Subscribed and sworn to before me this

6th day of January, 2010



Linda D. Toon

Notary Public Sedgwick County, Kansas

Printer's Fee : \$80.00

LEGAL PUBLICATION

Published in the Wichita Eagle
January 6, 2010 (3009109)
BEFORE THE STATE CORPORATION COMMISSION OF THE STATE OF KANSAS
NOTICE OF FILING APPLICATION
Re: FIML Natural Resources, LLC- Application for a permit to commingle production in the Lansing and Arbuckle zones of the Hertel #2 well, located in Rooks County, Kansas.
To: All Oil and Gas Producers, Unleased Mineral Interest Owners, Landowners, and all persons whosever concerned.
You, and each of you, are hereby notified that FIML Natural Resources, LLC has filed an application to commingle production from the Lansing and Arbuckle formations in the Hertel #2 well located in the NW/SE/ SW Sec 17, 900' FSL, 1650' FWL, T-8S, R-18W, Rooks County, Kansas.
Any persons who object to or protest this application shall be required to file their objections or protests with the Conservation Division of the State Corporation Commission of the State of Kansas within fifteen (15) days from the date of this publication. These protests shall be filed pursuant to Commission regulations and must state specific reasons why the grant of the application may cause waste, violate correlative rights or pollute the natural resources of the State of Kansas.
All persons interested or concerned shall take notice of the foregoing and shall govern themselves accordingly.
FIML Natural Resources, LLC
410 17th Street, Ste. 900
Denver, CO 80202
Phone: 303-893-5090

RECEIVED
FEB 11 2010
KCC WICHITA

AFFIDAVIT OF PUBLICATION

STATE OF KANSAS, ROOKS COUNTY: ss:

ROBERT L. HAMILTON, being first duly sworn, deposes and says: That he is the publisher of the STOCKTON SENTINEL, a weekly newspaper printed in the State of Kansas, and published in and of general circulation in Rooks County, Kansas, with a general paid circulation on a weekly basis in Rooks County, Kansas, and that said newspaper is not a trade, religious or fraternal publication.

PUBLIC NOTICE
BEFORE THE STATE CORPORATION COMMISSION OF THE STATE OF KANSAS NOTICE OF FILING APPLICATION

Re: FIML Natural Resources, LLC-Application for a permit to commingle production in the Lansing and Arbuckle zones of the Hertel #2 well, located in Rooks County, Kansas.

To: All Oil and Gas Producers, Unleased Mineral Interest Owners, Landowners, and all persons whosoever concerned.

You, and each of you, are hereby notified that FIML Natural Resources, LLC has filed an application to commingle production from the Lansing and Arbuckle formations in the Hertel #2 well located in the NW/SE/SW Sec 17, 900' FSL, 1650' FWL, T-8S, R-18W, Rooks County, Kansas.

Any persons who object to or protest this application shall be required to file their objections or protests with the Conservation Division of the State Corporation Commission of the State of Kansas within fifteen (15) days from the date of this publication. These protests shall be filed pursuant to Commission regulations and must state specific reasons why the grant of the application may cause waste, violate correlative rights or pollute the natural resources of the state of Kansas.

All persons interested or concerned shall take notice of the foregoing and shall govern themselves accordingly.

FIML Natural Resources, LLC
410 17th Street, Ste 900
Denver, CO 80202
Phone: 303-893-5090

(First published in the Stockton Sentinel January 28, 2010, 1)

Said newspaper is a weekly published at least weekly 50 times a year; and has been admitted at the post office of Stockton, Kansas, in said County as second class matter.

That the attached notice is a true copy thereof and was published in the regular and entire issue of said newspaper one consecutive week(s), the first publication thereof being made as aforesaid on the 28th day of January, 20 10, with subsequent publication being made on the following dates:

_____, 20____, _____, 20____
_____, 20____, _____, 20____
_____, 20____, _____, 20____

Robert L. Hamilton

Subscribed and sworn to before me this 28th day of January, 20 10

Debra K. Dix
Clerk of the District Court/Notary Public

My Commission Expires: 11-5-13

Printer's Fees: \$ 30¹⁵

Additional Copies: \$ _____

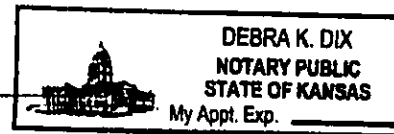

RECEIVED
FEB 11 2010
KCC WICHITA