

API NUMBER 15-101-20,178-00-00

LEASE NAME Shanline

WELL NUMBER 1

1980 Ft. from S Section Line

660 Ft. from E Section Line

SEC. 4 TWP. 16 RGE. 18 (E) or (W)

COUNTY Lane

Date Well Completed 6-2-76

Plugging Commenced 1-30-96

Plugging Completed 1-30-96

TYPE OR PRINT
 NOTICE: Fill out completely
 and return to Cons. Div.
 office within 30 days.

LEASE OPERATOR A. L. Abercrombie, Inc.

ADDRESS Rt. #1 Box 56 Great Bend, Ks. 67530

PHONE#(316) 793-8186 OPERATORS LICENSE NO. 5393

Character of Well Oil

(Oil, Gas, D&A, SWD, Input, Water Supply Well)

The plugging proposal was approved on 12-8-95 (date)

by David P. Williams (KCC District Agent's Name).

Is ACO-1 filed? Yes If not, is well log attached? _____

Producing Formation Fort Scott Depth to Top 4302' Bottom 4310' T.O. 4415'

Show depth and thickness of all water, oil and gas formations.

OIL, GAS OR WATER RECORDS

CASING RECORD

Formation	Content	From	To	Size	Put In	Pulled out
Fort Scott	Oil	4286'	4312'	8 5/8"	237'	NA
				4 1/2"	4414'	

Describe in detail the manner in which the well was plugged, indicating where the mud fluid was placed and the method or methods used in introducing it into the hole. If concrete other plug were used, state the character of same and depth placed, from feet to feet at each set
Well was perforated at 1250'. Mix 150 sacks 65/35 Poz, 8% gel & 300 lbs. hulls & pump down 4 1/2". Mix 150 sacks 65/35 Poz, 8% gel. & pump down 8 5/8 - did not go on vacuum
Mix 40 sacks 65/35 Poz, 8% gel. & fill 4 1/2 to surface - held. KCC Rep. Kevin Scrube was on location and approved of procedure.

Name of Plugging Contractor A. L. Abercrombie, Inc. License No. 5393

Address Rt. #1, Box 56 Great Bend, Ks. 67530

NAME OF PARTY RESPONSIBLE FOR PLUGGING FEES: A. L. Abercrombie, Inc.

STATE OF Kansas COUNTY OF Barton, ss.

B. E. Sowles (Employee of Operator) or (Operator) of above-described well, being first duly sworn on oath, says: That I have knowledge of the facts statements, and matters herein contained and the log of the above-described well as filed that the same are true and correct, so help me God.



(Signature) B. E. Sowles

(Address) Rt. #1 Box 56, Great Bend, Ks. 67530

SUBSCRIBED AND SWORN TO before me this 31st day of January, 19 96

Susan M. Urban
 Notary Public

My Commission Expires: 7-29-96

USE ONLY ONE SIDE OF EACH FORM

KANSAS DRILLERS LOG

API No. 15 — 101 — 20,178 -00-00
 County Number

S. 4 T. 16S R. 28 W

Loc. C NE SE

County Lane

Operator Abercrombie Drilling, Inc.
 Address 801 Union Center, Wichita, Kansas 67202

Well No. #1 Lease Name SHANLINE

Postage Location 1980' feet from 241 (S) line 660' feet from (E) (W) line

Principal Contractor Abercrombie Drilling, Inc. Geologist Benny Singleton

Spud Date May 22, 1976 Total Depth 4400' P.B.Y.D.

Date Completed June 2, 1976 Oil Purchaser Unknown

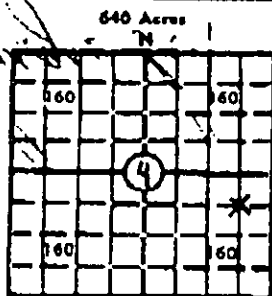

Locate well correctly

Elev.: Gr. 2579'

DP 2584' KB 2587'

CASING RECORD

Report of all strings set — surface, intermediate, production, etc.

Purpose of string	Size hole drilled	Size casing set (in O.D.)	Weight lbs/ft.	Setting depth	Type cement	Sacks	Type and percent additives
Surface	12 1/2"	8 5/8"		237'	Common	160	2% gel, 3% ca. cl.
Production csg.		4 1/2"		4415'	50/50 Posmix	50	2% gel, 8# gil.
					Common	200	10% salt, fric. reducer

LINER RECORD

PERFORATION RECORD

Top, ft.	Bottom, ft.	Sacks cement	Shots per ft.	Size & type	Depth interval

TUBING RECORD

Size	Setting depth	Packer set at

ACID, FRACTURE, SHOT, CEMENT SQUEEZE RECORD

Amount and kind of material used	Depth interval treated

INITIAL PRODUCTION

Date of first production	Producing method (flowing, pumping, gas lift, etc.)				
RATE OF PRODUCTION PER 24 HOURS	Oil	Gas	Water	Gas-oil ratio	
	bbls.		MCF	bbls.	CFPB
Disposition of gas (vented, used on lease or sold)			Producing interval(s)		
			4302-4310		

INSTRUCTIONS: As provided in KCC Rule 82-2-125, within 90 days after completion of a well, one completed copy of this Drillers Log shall be transmitted to the State Geological Survey of Kansas, 4130 Monroe Street, Wichita, Kansas 67209. Copies of this form are available from the Conservation Division, State Corporation Commission, 3830 So. Meridian (P.O. Box 17027), Wichita, Kansas 66217. Phone AC 316-522-2106. If confidential custody is desired, please note Rule 82-2-125. Drillers Logs will be on an open file in the Oil and Gas Division, State Geological Survey of Kansas, Lawrence, Kansas 66044.

RECEIVED
 STATE CORPORATION COMMISSION
 DEL. 7 1976

15-101-20178-00-00

Operator: Abercrombie Drilling, Inc. DESIGNATE TYPE OF COMP.: OIL, GAS, DRY HOLE, SWDW, ETC.:

Well No. #1 Lease Name SHANLINE OIL

S 4 T 16S R 28 E W

WELL LOG

Show all important zones of porosity and contents thereof; cored intervals, and all drill-stem tests, including depth interval tested, cushion used, time tool open, flowing and shut-in pressures, and recoveries.

SHOW GEOLOGICAL MARKERS, LOGS RUN, OR OTHER DESCRIPTIVE INFORMATION.

FORMATION DESCRIPTION, CONTENTS, ETC.	TOP	BOTTOM	NAME	DEPTH
Surface Sand & Shale	0	237	ELECTRIC LOG	TOPS:
Shale & Sand	237	1400		
Red bed shale	1400	1990	Anhydrite	1996'
Shale & Sand	1990	2520	B/Anhydrite	2030'
Lime & Shale	2520	3105	Heebnar	3746'
Shale & Lime	3105	3278	Toronto	3766'
Lime	3278	3500	Lansing	3783'
Lime & Shale	3500	3790	Stark Shale	4032'
Lime	3790	4085	B/KC	4105'
Lime & Shale	4085	4165	Marmaton	4127'
Lime	4165	4400	Fort Scott	4286'
Rotary Total Depth		4400	Cherokee	4312'
			Cherokee Sd.	4362'
			Mississippian	4386'
			RTD	4400'
			ELTD	4416'

DST #1 (3760'-3790') 30", 45", 60", 45" Strong blow. 1466' salt water, IFP 59-239#; IBHP 1152#; FFP 273-496#; FBHP 1117#. Temp. 109°

DST #2 (3911'-3976') 30", 45", 60", 45" Strong blow - Rec. 1280' SW with few spots oil. IFP 85-271#; IBHP 2104#; FFP 299-531#; FBHP 1186#. Temp. 111°

DST #3 (3983'-4055') 30", 45", 60", 45" Strong blow. Rec. 60' GIP, 150' G & SOC wtry. mud, 300' GCMW w/scum oil, 390' GCSW. IFP 111-256#; IBHP 1117#; FFP 282-436#; FBHP 1065#. Temp. 120°

DST #4 (4271'-4300') 30", 45", 60", 45" Strong blow. GTS. 90". Rec. 330' oil, 240' G & OCM. IFP 85-136#; IBHP 1204#; FFP 145-256#; FBHP 1178#. Temp. 122°

DST #5 (4030'-4050') Straddle Packers - 30", 45", 60", 60". Rec. 330' GIP, 15' oil, 175' GC muddy wtr. w/show oil, 240' GCW w/scum oil, 180' wtr. IFP 25-128#; IBHP 1083#; FFP 166-299#; FBHP 1048#; Running Prod. casing to 4416'.

USE ADDITIONAL SHEETS, IF NECESSARY, TO COMPLETE WELL RECORD.

RECEIVED CORPORATION COMMISSION
 DEL
 1995

Date Received

Jerry A. Langrehr Signature
 Exec. Vice President Title

June 8 1976 Date