

CONFIDENTIAL

KANSAS CORPORATION COMMISSION
OIL & GAS CONSERVATION DIVISION

WELL COMPLETION FORM
WELL HISTORY - DESCRIPTION OF WELL & LEASE

ORIGINAL

3/8/12
Form ACO-1
June 2009
Form Must Be Typed
Form must be Signed
All blanks must be Filled

OPERATOR: License # 32638
Name: Nadel and Gussman, LLC
Address 1: 15 E. 5th St
Address 2: Suite 3200
City: Tulsa State: OK Zip: 74103 +
Contact Person: Kim Tackett
Phone: (918) 582-9900 ext 222
CONTRACTOR: License # 34600
Name: Horizon Energy Services, LLC
Wellsite Geologist: Steve Tilley
Purchaser: Coffeyville Resources

Designate Type of Completion:
 New Well Re-Entry Workover
 Oil WSW SWD SLOW
 Gas D&A ENHR SIGW
 OG GSW Temp. Abd.
 CM (Coal Bed Methane)
 Cathodic Other (Core, Expl., etc.): HZ Oil

If Workover/Re-entry: Old Well Info as follows:
Operator: _____
Well Name: _____

Original Comp. Date: _____ Original Total Depth: _____
 Deepening Re-perf. Conv. to ENHR Conv. to SWD
 Conv. to GSW
 Plug Back: _____ Plug Back Total Depth
 Commingled Permit #: _____
 Dual Completion Permit #: _____
 SWD Permit #: _____
 ENHR Permit #: _____
 GSW Permit #: _____

11-17-2011 12-15-2011 2-8-2012
Spud Date or Date Reached TD Completion Date or
Recompletion Date Recompletion Date

API No. 15 - 019-27111-01-00
Spot Description: _____
NE NW NW Sec. 7 Twp. 33 S. R. 9 East West
265 Feet from North / South Line of Section
1,200 Feet from East / West Line of Section
Footages Calculated from Nearest Outside Section Corner:
 NE NW SE SW
County: Chautauqua
Lease Name: Fulsom Ranch Well #: 1A-7-33-9H
Field Name: Unnamed
Producing Formation: Mississippi Lime
Elevation: Ground: 1088 Kelly Bushing: 1098
Total Depth: 5502 Plug Back Total Depth: 5483
Amount of Surface Pipe Set and Cemented at: 148 Feet
Multiple Stage Cementing Collar Used? Yes No
If yes, show depth set: 604 Feet
If Alternate II completion, cement circulated from: 604
feet depth to: surface w/ 70 sx extended light & 70 sx "A" sx cmt.

Drilling Fluid Management Plan
(Data must be collected from the Reserve Pit)
Chloride content: 3000 ppm Fluid volume: 15,000 bbls
Dewatering method used: evaporation
Location of fluid disposal if hauled offsite:
Operator Name: _____
Lease Name: _____ License #: _____
Quarter _____ Sec. _____ Twp. _____ S. R. _____ East West
County: _____ Permit #: _____

CONFIDENTIAL RECEIVED
MAR 08 2012 MAR 16 2012
KCC KCC WICHITA

INSTRUCTIONS: An original and two copies of this form shall be filed with the Kansas Corporation Commission, 130 S. Market - Room 2078, Wichita, Kansas 67202, within 120 days of the spud date, recompletion, workover or conversion of a well. Rule 82-3-130, 82-3-106 and 82-3-107 apply. Information of side two of this form will be held confidential for a period of 12 months if requested in writing and submitted with the form (see rule 82-3-107 for confidentiality in excess of 12 months). One copy of all wireline logs and geologist well report shall be attached with this form. ALL CEMENTING TICKETS MUST BE ATTACHED. Submit CP-4 form with all plugged wells. Submit CP-111 form with all temporarily abandoned wells.

AFFIDAVIT

I am the affiant and I hereby certify that all requirements of the statutes, rules and regulations promulgated to regulate the oil and gas industry have been fully complied with and the statements herein are complete and correct to the best of my knowledge.

Signature: [Signature]
Title: Regional Production Manager Date: 2-23-2012

KCC Office Use ONLY

Letter of Confidentiality Received
Date: 3/8/12 - 3/8/14
 Confidential Release Date: _____
 Wireline Log Received
 Geologist Report Received
 UIC Distribution
ALT I II III Approved by: [Signature] Date: 3-20-12

Nemaha Oil & Gas Llc
Fulsom 1A-7-33-9H

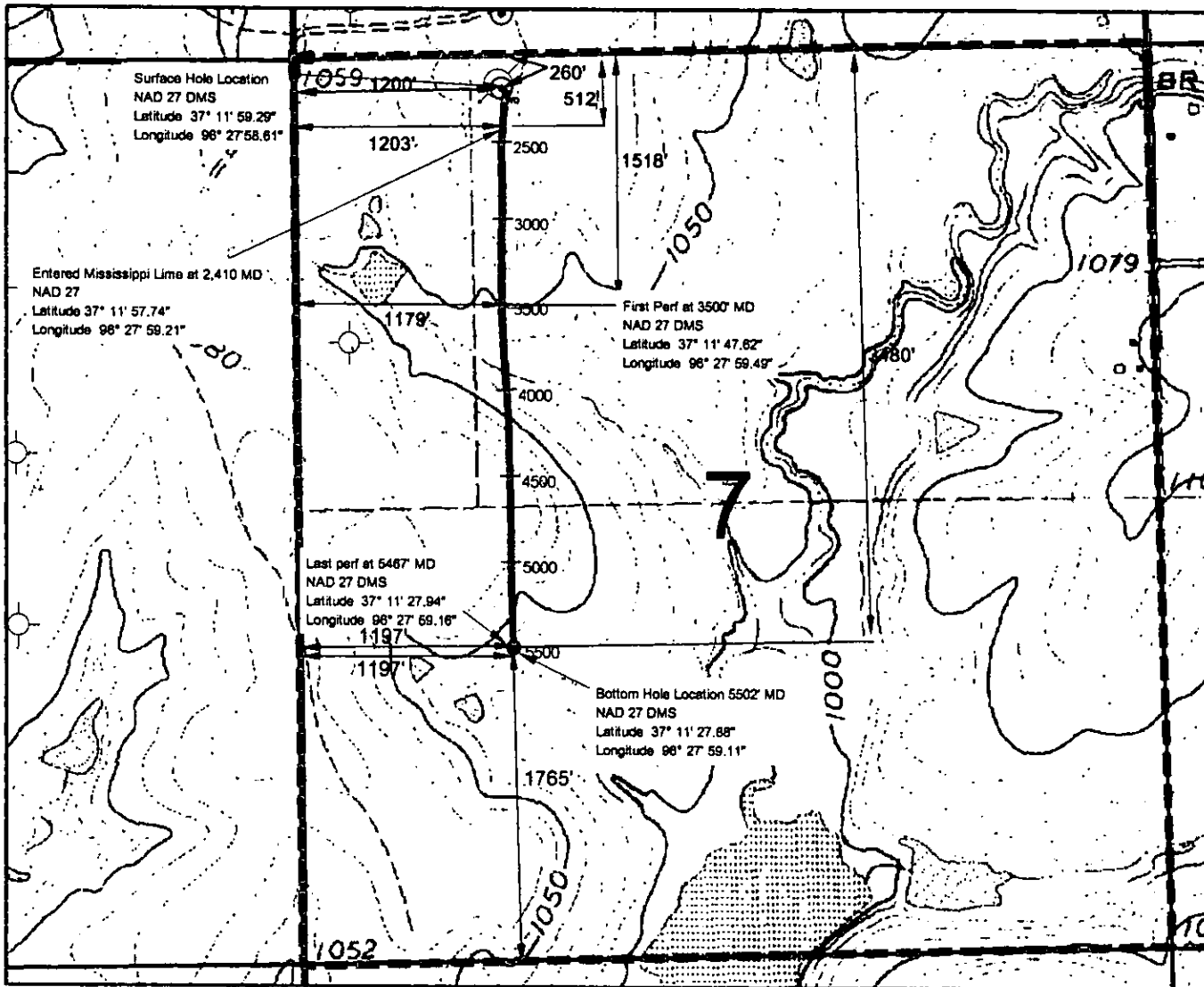

Surface Hole location
260 ft FNL; 1200 ft FWL
sec 7, T33S R9E
Chautauqua County Kansas
NAD 27
Latitude- North 37° 11' 59.2944"
Longitude- West 96° 27' 58.611"
State Plane- (Kansas South)
Northing- 2592330
Easting- 200585

Bottom hole location
1765 ft FSL; 1197' FWL
sec 7, T33S R9E
Chautauqua County Kansas
NAD 27
Latitude North 37° 11' 27.8674"
Longitude West 96° 27'
59.1114"
State Plane-Kansas South
Northing 2592305
Easting 197255

CONFIDENTIAL
MAR 08 2012
KCC

RECEIVED
MAR 16 2012
KCC WICHITA



MAR 08 2014

 Nadel & Gussman Energy, LLC
 Fulsom Ranch 1A-7-33 9H
 Sec 7 - 33S - 9E
 Chautauqua Co. KS

 Survey Calculation Program
 M.W.D. OPERATOR: S.Eisenman/B. Slater/B. Wagon
 DIRECTIONAL DRILLERS: Billy/Monte B./James

 Magnetic Declination: 6.03
 Job #: DR 11-12-162
 Vertical Section 180.43

Minimum Curvature Calculation

Survey No.	Depth	INC	AZM	TVD	N-S	E-W	Vertical Section	DLS/100
Tie	0	0.00	0.00	0.00	0.00	0.00	0.00	0.00
1	380	1.4	126.1	379.96	-2.74	3.75	2.71	0.37
2	696	1.4	123.2	695.87	-7.12	10.10	7.05	0.02
3	1012	1.0	141.5	1011.80	-11.40	15.05	11.28	0.17
4	1373	0.8	113.1	1372.76	-14.85	19.33	14.70	0.13
5	1688	1.0	127.9	1687.72	-17.40	23.52	17.22	0.10
6	1808	1.0	124.9	1807.70	-18.64	25.20	18.45	0.04
7	1850	1.6	156.3	1849.69	-19.39	25.74	19.20	2.17
8	1877	3.9	173.4	1876.66	-20.65	26.00	20.45	8.95
9	1908	7.2	179.3	1907.51	-23.64	26.14	23.44	10.79
10	1940	10.6	183.8	1939.12	-28.58	25.97	28.39	10.84
11	1971	13.6	184.1	1969.43	-35.06	25.52	34.87	9.68
12	2003	16.6	183.7	2000.32	-43.38	24.96	43.19	9.38
13	2034	19.6	185.6	2029.78	-52.97	24.16	52.79	9.86
14	2065	22.1	187.3	2058.75	-63.94	22.91	63.76	8.30
15	2097	23.9	187.4	2088.20	-76.34	21.32	76.17	5.63
16	2129	26.0	186.2	2117.21	-89.74	19.72	89.59	6.75
17	2160	28.3	185.6	2144.80	-103.81	18.27	103.67	7.47
18	2192	30.4	186.0	2172.69	-119.41	16.68	119.28	6.59
19	2223	32.4	186.9	2199.15	-135.46	14.87	135.34	6.63
20	2255	34.3	186.8	2225.88	-152.93	12.77	152.82	5.94
21	2287	36.7	185.7	2251.93	-171.40	10.75	171.31	7.76
22	2318	39.2	185.4	2276.37	-190.37	8.91	190.30	8.09
23	2349	41.9	184.8	2299.92	-210.44	7.12	210.38	8.80
24	2381	44.2	185.5	2323.31	-232.20	5.16	232.15	7.34
25	2412	44.7	185.2	2345.43	-253.81	3.13	253.78	1.75
26	2444	44.9	185.4	2368.14	-276.26	1.05	276.25	0.76
27	2475	45.2	184.2	2390.04	-298.12	-0.78	298.12	2.91
28	2507	47.7	183.3	2412.09	-321.26	-2.30	321.27	8.07
29	2538	50.9	181.7	2432.30	-344.74	-3.31	344.75	11.04
30	2592	56.0	180.0	2464.45	-388.10	-3.94	388.12	9.78
31	2623	55.7	179.8	2481.85	-413.75	-3.89	413.77	1.11
32	2655	57.8	179.8	2499.40	-440.51	-3.80	440.53	6.34
33	2686	59.4	179.3	2515.55	-466.97	-3.59	466.98	5.34

 RECEIVED
 MAR 16 2014
 KCC WICHIT.

Nadel & Gussman Energy, LLC
 Fulsom Ranch 1A-7-33 9H
 Sec 7 - 33S - 9E
 Chautauqua Co. KS

Survey Calculation Program
 M.W.D. OPERATOR: S.Eisenman/B. Slater/B. Whorton
 DIRECTIONAL DRILLERS: Billy/Monte B./James

Magnetic Declination: 6.03
 Job #: DR 11-12-162
 Vertical Section 180.43

Minimum Curvature Calculation

No.	Survey Depth	INC	AZM	TVD	N-S	E-W	Vertical Section	DLS/100
34	2714	60.4	179.2	2529.59	-491.19	-3.27	491.20	3.58
35	2746	62.2	179.2	2544.96	-519.26	-2.88	519.26	5.63
36	2777	63.1	180.0	2559.20	-546.79	-2.69	546.80	3.70
37	2809	66.0	181.1	2572.95	-575.68	-2.97	575.69	9.58
38	2841	69.4	181.3	2585.09	-605.28	-3.59	605.29	10.64
39	2872	72.5	181.0	2595.21	-634.57	-4.18	634.58	10.04
40	2904	75.7	181.5	2603.97	-665.33	-4.85	665.35	10.11
41	2935	79.3	181.8	2610.68	-695.58	-5.72	695.60	11.65
42	2967	83.1	181.5	2615.58	-727.19	-6.63	727.21	11.91
43	2998	87.0	182.1	2618.25	-758.05	-7.60	758.08	12.76
44	3030	91.3	181.6	2618.73	-790.02	-8.63	790.06	13.53
45	3061	95.1	181.6	2616.99	-820.95	-9.50	821.00	12.26
46	3093	95.5	181.3	2614.04	-852.81	-10.31	852.86	1.56
47	3124	95.7	181.3	2611.01	-883.65	-11.01	883.71	0.65
48	3155	95.7	181.9	2607.94	-914.49	-11.87	914.55	1.93
49	3187	96.2	181.6	2604.62	-946.30	-12.84	946.37	1.82
50	3218	96.2	181.8	2601.27	-977.10	-13.75	977.18	0.64
51	3250	96.2	182.1	2597.81	-1008.90	-14.84	1008.98	0.93
52	3282	96.3	181.9	2594.33	-1040.69	-15.95	1040.78	0.70
53	3313	96.4	181.8	2590.90	-1071.48	-16.94	1071.58	0.45
54	3345	96.3	182.0	2587.36	-1103.27	-17.99	1103.37	0.70
55	3376	96.1	181.3	2584.01	-1134.07	-18.88	1134.18	2.34
56	3407	96.3	181.5	2580.67	-1164.88	-19.63	1165.00	0.91
57	3439	96.0	180.6	2577.24	-1196.69	-20.22	1196.81	2.95
58	3471	94.2	181.0	2574.39	-1228.56	-20.66	1228.68	5.76
59	3502	92.7	180.5	2572.53	-1259.50	-21.07	1259.63	5.10
60	3533	92.9	180.4	2571.01	-1290.46	-21.31	1290.59	0.72
61	3564	92.9	178.4	2569.45	-1321.42	-20.99	1321.54	6.44
62	3596	92.9	178.4	2567.83	-1353.37	-20.09	1353.48	0.00
63	3628	91.1	178.1	2566.71	-1385.33	-19.12	1385.44	5.70
64	3659	89.5	178.1	2566.55	-1416.31	-18.09	1416.41	5.16
65	3691	89.6	178.0	2566.80	-1448.29	-17.00	1448.38	0.44
66	3722	90.0	177.7	2566.91	-1479.27	-15.84	1479.35	1.44

RECEIVED
 MAR 16 2012

Nadel & Gussman Energy, LLC
 Fulsom Ranch 1A-7-33 9H
 Sec 7 - 33S - 9E
 Chautauqua Co. KS

Survey Calculation Program
 M.W.D. OPERATOR: S.Eisenman/B. Slate/KCC
 DIRECTIONAL DRILLERS: Billy/Monte B./James

Magnetic Declination: 6.03
 Job #: DR 11-12-162
 Vertical Section 180.43

Minimum Curvature Calculation

No.	Survey Depth	INC	AZM	TVD	N-S	E-W	Vertical Section	DLS/100
67	3754	89.8	178.2	2566.96	-1511.25	-14.69	1511.32	1.68
68	3785	90.8	178.3	2566.80	-1542.24	-13.75	1542.30	3.24
69	3817	90.8	177.9	2566.35	-1574.22	-12.69	1574.27	1.25
70	3849	91.1	178.3	2565.82	-1606.19	-11.63	1606.24	1.56
71	3880	91.1	177.4	2565.23	-1637.17	-10.46	1637.20	2.90
72	3912	90.9	177.6	2564.67	-1669.13	-9.07	1669.15	0.88
73	3944	91.3	177.4	2564.05	-1701.09	-7.67	1701.10	1.40
74	3975	91.5	177.0	2563.30	-1732.05	-6.16	1732.05	1.44
75	4007	91.9	176.5	2562.35	-1763.98	-4.34	1763.96	2.00
76	4038	92.5	176.2	2561.16	-1794.90	-2.37	1794.86	2.16
77	4070	91.6	177.1	2560.01	-1826.82	-0.50	1826.77	3.98
78	4102	89.7	178.4	2559.65	-1858.79	0.75	1858.73	7.19
79	4133	89.5	178.2	2559.87	-1889.78	1.67	1889.71	0.91
80	4165	89.5	178.1	2560.15	-1921.76	2.71	1921.68	0.31
81	4196	90.3	180.1	2560.20	-1952.75	3.19	1952.67	6.95
82	4228	90.8	179.6	2559.89	-1984.75	3.28	1984.67	2.21
83	4259	90.8	180.1	2559.46	-2015.75	3.36	2015.67	1.61
84	4291	91.4	179.2	2558.85	-2047.74	3.55	2047.66	3.38
85	4323	91.7	179.1	2557.98	-2079.73	4.03	2079.64	0.99
86	4354	92.0	180.0	2556.98	-2110.71	4.27	2110.62	3.06
87	4386	90.8	180.2	2556.20	-2142.70	4.21	2142.61	3.80
88	4418	90.4	180.3	2555.86	-2174.70	4.07	2174.60	1.29
89	4449	90.6	180.1	2555.59	-2205.69	3.97	2205.60	0.91
90	4481	90.8	180.6	2555.20	-2237.69	3.77	2237.60	1.68
91	4512	91.2	180.1	2554.66	-2268.69	3.58	2268.60	2.07
92	4544	91.2	179.8	2553.99	-2300.68	3.61	2300.59	0.94
93	4575	91.5	179.7	2553.26	-2331.67	3.74	2331.58	1.02
94	4607	91.2	180.5	2552.51	-2363.66	3.69	2363.57	2.67
95	4639	91.8	180.1	2551.67	-2395.65	3.52	2395.56	2.25
96	4670	92.4	180.2	2550.53	-2426.63	3.44	2426.53	1.96
97	4702	93.0	180.0	2549.02	-2458.59	3.38	2458.50	1.98
98	4734	93.4	180.1	2547.24	-2490.54	3.36	2490.45	1.29
99	4765	93.1	180.7	2545.48	-2521.49	3.14	2521.40	2.16
100	4797	93.7	179.9	2543.58	-2553.43	2.97	2553.34	3.12

RECEIVED

MAR 16 2014

KCC WICHI



Survey Calculation Program

Nadel & Gussman Energy, LLC
 Fulsom Ranch 1A-7-33 9H
 Sec 7 - 33S - 9E
 Chautauqua Co. KS

M.W.D. OPERATOR: S.Eisenman/B. Slater/B. Whorton
 DIRECTIONAL DRILLERS: Billy/Monte B./James

Magnetic Declination: 6.03
 Job #: DR 11-12-162
 Vertical Section 180.43

Minimum Curvature Calculation

No.	Survey Depth	INC	AZM	TVD	N-S	E-W	Vertical Section	DLS/100
101	4828	93.9	180.3	2541.53	-2584.37	2.92	2584.27	1.44
102	4860	93.8	180.7	2539.38	-2616.29	2.64	2616.20	1.29
103	4891	93.1	181.0	2537.51	-2647.23	2.18	2647.14	2.46
104	4923	93.4	180.8	2535.70	-2679.18	1.68	2679.09	1.13
105	4955	93.5	180.7	2533.77	-2711.12	1.26	2711.03	0.44
106	4986	93.9	180.7	2531.77	-2742.05	0.88	2741.97	1.29
107	5018	94.2	180.6	2529.51	-2773.97	0.52	2773.89	0.99
108	5049	94.3	180.4	2527.22	-2804.88	0.25	2804.80	0.72
109	5081	94.7	180.1	2524.71	-2836.78	0.11	2836.70	1.56
110	5113	95.0	179.9	2522.00	-2868.67	0.11	2868.59	1.13
111	5145	95.3	179.7	2519.13	-2900.54	0.22	2900.46	1.13
112	5176	95.5	179.9	2516.21	-2931.40	0.33	2931.32	0.91
113	5208	95.2	179.8	2513.23	-2963.26	0.42	2963.17	0.99
114	5239	95.8	179.5	2510.26	-2994.12	0.60	2994.03	2.16
115	5271	96.2	179.6	2506.91	-3025.94	0.85	3025.85	1.29
116	5302	96.6	179.4	2503.46	-3056.75	1.12	3056.65	1.44
117	5334	97.1	179.4	2499.64	-3088.52	1.46	3088.42	1.56
118	5365	97.4	179.6	2495.73	-3119.27	1.72	3119.17	1.16
119	5397	98.2	179.4	2491.38	-3150.97	2.00	3150.87	2.58
120	5428	98.5	179.8	2486.88	-3181.64	2.21	3181.53	1.60
121	5460	99.2	178.9	2481.96	-3213.26	2.57	3213.15	3.54
PTB	5502	99.2	178.9	2475.24	-3254.71	3.37	3254.59	0.00

 ####
 ####
 ####
 ####
 ####
 ####
 ####
 ####
 ####
 ####
 ####

CONFIDENTIAL

MAR 11 2012

KCC

RECEIVED

MAR 16 2012

KCC WICHITA