

STATE CORPORATION COMMISSION OF KANSAS
OIL & GAS CONSERVATION DIVISION
WELL COMPLETION OR RECOMPLETION FORM
ACO-1 WELL HISTORY
DESCRIPTION OF WELL AND LEASE

5

API NO. 15-101-21,461-00-00
County Lane
N/2 NW SE 21 17S 27 East
..... Sec..... Twp..... Rge..... X West

Operator: License # 5144
Name Mull Drilling Company, Inc.
Address P.O. Box 2758
City/State/Zip Wichita, Ks. 67201

2310
1980 Ft North from Southeast Corner of Section
..... Ft West from Southeast Corner of Section
(Note: Locate well in section plat below)

Purchaser.....

Lease Name Hank. 'E' Well #. 2
Field Name LS Northeast

Operator Contact Person Paul Gunzelman
Phone 316-264-6366

Producing Formation.....
Elevation: Ground 2676 2681 KB.....

Contractor: License # 5422
Name Abercrombie Drilling, Inc.

Wellsite Geologist Paul Gunzelman
Phone (316) 264-6366

Designate Type of Completion
X New Well Re-Entry Workover
Oil SWD Temp Abd
Gas Inj Delayed Comp.
X Dry Other (Core, Water Supply etc.)

If OWNED: old well info as follows:
Operator.....
Well Name.....
Comp. Date..... Old Total Depth.....

WELL HISTORY
Drilling Method:
X Mud Rotary Air Rotary Cable
3-11-88 3-18-88 3-18-88
Spud Date Date Reached TD Completion Date
4625
Total Depth PBDT
Amount of Surface Pipe Set and Cemented at 370.57 feet
Multiple Stage Cementing Collar Used? Yes No
If yes, show depth set..... feet
If alternate 2 completion, cement circulated from..... feet depth to..... w/..... SX cmt
Cement Company Name.....
Invoice #.....

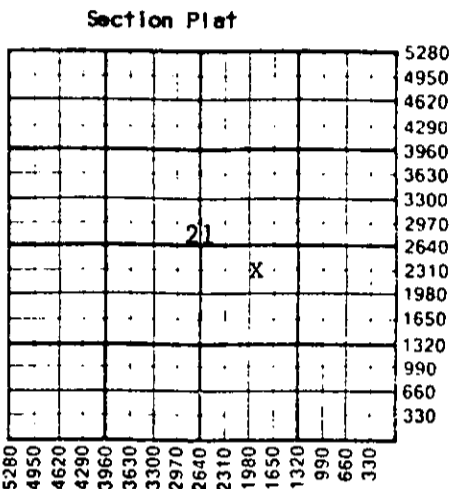

WATER SUPPLY INFORMATION
Disposition of Produced Water: Disposal
Docket # NA Repressuring

Questions on this portion of the ACO-1 call:
Water Resources Board (913) 296-3717
Source of Water:
Division of Water Resources Permit #.....
Groundwater 1400 Ft North from Southeast Corner
(Well) 1400 Ft West from Southeast Corner of
Sec 21 Twp 17S Rge 27 East XX West
XX Surface Water..... Ft North from Southeast Corner
(Stream, pond etc)..... Ft West from Southeast Corner
Sec Twp Rge East West
X Other (explain) Pond.....
(purchased from city, R.W.D. #)

INSTRUCTIONS: This form be completed in triplicate and filed with the Kansas Corporation Commission, 200 Colorado Derby Building, Wichita, Kansas 67202, within 120 days of the spud date of any well. Rule 82-3-130, 82-3-107 and 82-3-106 apply.
Information on side two of this form will be held confidential for a period of 12 months if requested in writing and submitted with the form. See rule 82-3-107 for confidentiality in excess of 12 months.
One copy of all wireline logs and drillers time log shall be attached with this form. Submit CP-4 form with all plugged wells. Submit CP-111 form with all temporarily abandoned wells.

All requirements of the statutes, rules and regulations promulgated to regulate the oil and gas industry have been fully complied with and the statements herein are complete and correct to the best of my knowledge.

Signature Paul M. Gunzelman

Title Geologist Kansas Division Date 4/11/88
PATRICIA L. UNGLEICH
NOTARY PUBLIC
STATE OF KANSAS
Subscribed and sworn to before me this 11th day of April 1988
Notary Public Patricia L. Ungleich
Date Commission Expires March 27, 1991

K.C.C. OFFICE USE ONLY
Letter of Confidentiality Attached
Wireline Log Received
Drillers Time Log Received
Distribution
KCC SWD/Rep NGPA
KGS 1988 Plug Other
(Specify)
CONSERVATION DIVISION
Wichita, Kansas
4-13-88

Section 17 Rge 27

SIDE TWO

Operator Name Mull Drilling Company, Inc. Lease Name Hank 'E' Well # 2

Sec. 21 Twp. 17S Rge. 27 East West County Lane

WELL LOG

INSTRUCTIONS: Show important tops and base of formations penetrated. Detail all cores. Report all drill stem tests giving interval tested, time tool open and closed, flowing and shut-in pressures, whether shut-in pressure reached static level, hydrostatic pressures, bottom hole temperature, fluid recovery, and flow rates if gas to surface during test. Attach extra sheet if more space is needed. Attach copy of log.

Drill Stem Tests Taken Yes No
 Samples Sent to Geological Survey Yes No
 Cores Taken Yes No

Formation Description
 Log Sample

No drill stem tests

0 - 375 Surface
 375-2054 Sand/shale
 2054-4625 Shale/lime
 4625 TD

Name	Top	Bottom
T/Anhydrite	2075	+ 606
B/Anhydrite	2106	+ 575
Heebner	3937	-1256
Lansing	3978	-1297
Stark Sh	4239	-1558
BKC	4310	-1629
Marmaton	4341	-1660
Ft Scott	4485	-1804
Cherokee	4508	-1827
Mississippian	4587	-1906
LTD	4626	-1945

CASING RECORD <input checked="" type="checkbox"/> New <input type="checkbox"/> Used							
Report all strings set-conductor, surface, intermediate, production, etc.							
Purpose of String	Size Hole Drilled	Size Casing Set (in O.D.)	Weight Lbs/Ft.	Setting Depth	Type of Cement	#Sacks Used	Type and Percent Additives
Surface	12 1/4	8 5/8	24	370:57	60-40 pps.	190	2% gal, 3% cc
PERFORATION RECORD				Acid, Fracture, Shot, Cement Squeeze Record			
Shots Per Foot	Specify Footage of Each Interval Perforated			(Amount and Kind of Material Used)		Depth	
TUBING RECORD				Size	Set At	Packer at	Liner Run <input type="checkbox"/> Yes <input type="checkbox"/> No
Date of First Production	Producing Method <input type="checkbox"/> Flowing <input type="checkbox"/> Pumping <input type="checkbox"/> Gas Lift <input type="checkbox"/> Other (explain).....						
Estimated Production Per 24 Hours	Oil	Gas	Water	Gas-Oil Ratio		Gravity	
	Bbls	MCF	Bbls	CFPB			

METHOD OF COMPLETION

Production Interval

Disposition of gas: Vented Open Hole Perforation
 Sold Other (Specify) Dry..... P&A.....
 Used on Lease Dually Completed
 Commingled

913-483-2627, Russell, Kansas
 Phone 316-793-5861, Great Bend, Kansas

15-101-21461-00-00

Phone Plainville 913-434-2812
 Phone Ness City 913-798-3843

ALLIED CEMENTING CO., INC.

N^o 1421

Home Office P. O. Box 31

Russell, Kansas 67865

"New"

Date	Sec.	Twp.	Range	Called Out	On Location	Job Start	Finish
3-18-88	21	17	27	2:30 P.M.	5:45 P.M.	7:30 P.M.	10:15 P.M.
Lease	Well No.	Location		County	State		
Hank E'	#2	Joe Hank Rd #496-5 ^{N W} #4		Lane	Kansas		

Contractor	Abercrombie Drilling Co. Inc.
Type Job	Rotary Plug
Hole Size	7 7/8
	T.D. 4675'
Csg.	Depth
Tbg. Size	Depth
Drill Pipe	4 1/2 X H
	Depth 2100'
Tool	Depth
Cement Left in Csg.	Shoe Joint
Press Max.	Minimum
Meas Line	Displace
Perf.	

Owner	Same
To Allied Cementing Co., Inc. You are hereby requested to rent cementing equipment and furnish cementer and helper to assist owner or contractor to do work as listed.	
Charge To	Mull Drilling Company, Inc.
Street	221 N. Main Suite 300
City	Wichita
State	Ks 67202
The above was done to satisfaction and supervision of owner agent or contractor	
Purchase Order No.	
X	Anthony Mart

"New City"

EQUIPMENT

No.	Cementor	Helper
# 158	J.D.	Dianna
No.	Cementor	Helper
# 68	Kelly	
Bulktrk	Driver	
# 68		

CEMENT		
Amount Ordered	205 60/40 Poz 67 gel	
Consisting of		
Common	123	5.00 615.00
Poz. Mix	82	2.10 172.20
Gel.	12	6.75 81.00
Chloride		
Quickset		
		Sales Tax
Handling	205	1.75 153.75
Mileage	30	195.30
		Sub Total
		Total 1217.25

DEPTH of Job		
Reference:	Description	Amount
30	Pump Truck chg.	450.00
1	Mileage	30.00
1	wooden plug	20.00
	Sub Total	
	Tax	
	Total	500.00

Remarks: 1st Plug at 2100' W 50 sk
 2nd Plug at 1350' W 80 sk
 3rd Plug at 400' W 50 sk
 4th Plug at 40' ft W 10 sk
 15 sk in Rathole
 Thank You!

Floating Equipment	
Total	\$ 1717.25
Less Disc	343.45
Net 30	
Days	\$ 1373.80

RECEIVED
 STATE CORPORATION COMMISSION

APR 13 1988

CONSERVATION DIVISION
 Wichita, Kansas

15-101-21461-00-00



P. O. Box 1524 - Gonzales, Texas 78629
512/672-9524 Texas Watts 1-800-221-5069

Well Drilling Co. Date 3-18
Well HANKS Depth 4625
Location #2 Degrees 10
By Days



P. O. Box 1524 - Gonzales, Texas 78629
512/672-9524 Texas Watts 1-800-221-5069

Well Dig Co. Date 3-12-88
Well HANKS Depth 1903
Location (E) #2 Degrees 14
By EUP



P. O. Box 1524 - Gonzales, Texas 78629
512/672-9524 Texas Watts 1-800-221-5069

Well Dig Co. Date 3/11/88
Well E-2 Depth 375
Location HANKS Degrees 12
By Dig

RECEIVED
STATE COMMISSION

APR 13 1988

CONSERVATION DIVISION
Wichita, Kansas