

plugged 10-13-87

SIDE ONE

STATE CORPORATION COMMISSION OF KANSAS  
OIL & GAS CONSERVATION DIVISION  
WELL COMPLETION OR RECOMPLETION FORM  
ACO-1 WELL HISTORY  
DESCRIPTION OF WELL AND LEASE

API NO. 15-101-21,426-00-00  
County Lane  
SE SW NE Sec. 7 Twp 17S Rge 27 East X West

Operator: License # 5181  
Name Donald C. Slawson  
Address 104 S. Broadway  
200 Douglas Bldg.  
City/State/Zip Wichita, KS 67202

3010 Ft North from Southeast Corner of Section  
1690 Ft West from Southeast Corner of Section  
(Note: Locate well in section plat below)

Purchaser

Lease Name Hanks "R" Well # 2

Operator Contact Person William R. Horigan  
Phone (316) 263-3201

Field Name

Producing Formation

Elevation: Ground 2718' KB 2724'

Contractor: License # 5657  
Name Slawson Drilling Company

Wellsite Geologist Rich Robba  
Phone

Designate Type of Completion  
X New Well Re-Entry Workover  
Oil Gas SWD Inj Temp Abd Delayed Comp.  
X Dry Other (Core, Water Supply etc.)

If OWD: old well info as follows:  
Operator  
Well Name  
Comp. Date Old Total Depth

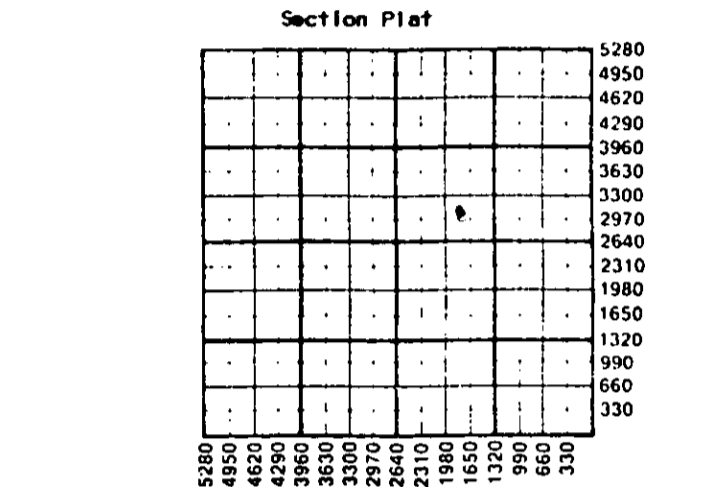

WATER SUPPLY INFORMATION  
Disposition of Produced Water: Disposal  
Docket # Repressuring

WELL HISTORY

Drilling Method:  
X Mud Rotary Air Rotary Cable  
10-6-87 10-13-87 10-13-87  
Spud Date Date Reached TD Completion Date  
4680'  
Total Depth PBTD

Questions on this portion of the ACO-1 call:  
Water Resources Board (913) 296-3717  
Source of Water:  
Division of Water Resources Permit # N/A  
Groundwater Ft North from Southeast Corner (Well) Ft West from Southeast Corner of Sec Twp Rge East West  
X Surface Water Ft North from Southeast Corner (Stream, pond etc) Ft West from Southeast Corner Sec 3 Twp 17S Rge 27 East X West  
Other (explain) (purchased from city, R.W.D. #)

Amount of Surface Pipe Set and Cemented at 242 feet  
Multiple Stage Cementing Collar Used? Yes No  
If yes, show depth set feet  
If alternate 2 completion, cement circulated from feet depth to w/SX cmt  
Cement Company Name  
Invoice #

INSTRUCTIONS: This form shall be completed in triplicate and filed with the Kansas Corporation Commission, 200 Colorado Derby Building, Wichita, Kansas 67202, within 120 days of the spud date of any well. Rule 82-3-130, 82-3-107 and 82-3-106 apply. Information on side two of this form will be held confidential for a period of 12 months if requested in writing and submitted with the form. See rule 82-3-107 for confidentiality in excess of 12 months. One copy of all wireline logs and drillers time log shall be attached with this form. Submit CP-4 form with all plugged wells. Submit CP-111 form with all temporarily abandoned wells.

All requirements of the statutes, rules and regulations promulgated to regulate the oil and gas industry have been fully complied with and the statements herein are complete and correct to the best of my knowledge.

Signature William R. Horigan  
Title Kansas Operations Manager Date 11-12-87

Subscribed and sworn to before me this 12th day of November 1987  
Notary Public Jacqueline J. Scheck  
Date Commission Expires July 28 1990

K.C.C. OFFICE USE ONLY  
Letter of Confidentiality Attached  
Wireline Log Received  
Drillers Timelog Received  
Distribution  
KCC SWD/Rep NGPA  
KGS Plug Other (Specify)

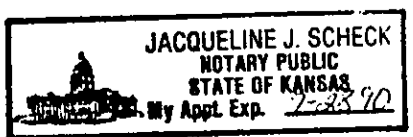

15-101-21426-00-00

**CONFIDENTIAL**

SIDE TWO

Operator Name Donald C. Slawson Lease Name Hanks R Well # 2

Sec. 7 Twp. 17S Rge. 27  East  West County Lane

RELEASED

MAR 0 7 1990

WELL LOG

FROM CONFIDENTIAL

INSTRUCTIONS: Show important tops and base of formations penetrated. Detail all cores. Report all drill stem tests giving interval tested, time tool open and closed, flowing and shut-in pressures, whether shut-in pressure reached static level, hydrostatic pressures, bottom hole temperature, fluid recovery, and flow rates if gas to surface during test. Attach extra sheet if more space is needed. Attach copy of log.

Drill Stem Tests Taken  Yes  No  
 Samples Sent to Geological Survey  Yes  No  
 Cores Taken  Yes  No

Formation Description  
 Log  Sample

DST #1: 4223-4250 (180')  
 30-20-20-20 Rec. 10' Mud. IFF: 20-26,  
 FFP: 26-32, ISIP: 753, FSIP: 635,  
 HP: 2031-2030 Temp. 105°.

Name	Top	Bottom
ANHY	2126	(+598)
B/ANHY	2159	(+565)
HEEB	3966	(-1242)
TOR	3988	(-1264)
LANS	4009	(-1285)
MUN CR	4160	(-1436)
STK	4259	(-1535)
BKC	4332	(-1608)
MARM	4356	(-1632)
PAW	4436	(-1712)
FS	4514	(-1790)
L/CHER	4538	(-1814)
MISS	4619	(-1895)
LTD	4679	(-1955)

CASING RECORD <input type="checkbox"/> New <input checked="" type="checkbox"/> Used Report all strings set-conductor, surface, intermediate, production, etc.							
Purpose of String	Size Hole Drilled	Size Casing Set (In O.D.)	Weight Lbs/Ft.	Setting Depth	Type of Cement	#Sacks Used	Type and Percent Additives
Surface	12-1/4"	8-5/8"	25#	242'	60/40 POP	180	2% G, 3% CC
PERFORATION RECORD				Acid, Fracture, Shot, Cement Squeeze Record			
Shots Per Foot	Specify Footage of Each Interval Perforated			(Amount and Kind of Material Used)		Depth	
TUBING RECORD				Liner Run <input type="checkbox"/> Yes <input type="checkbox"/> No			
Date of First Production		Producing Method					
		<input type="checkbox"/> Flowing <input type="checkbox"/> Pumping <input type="checkbox"/> Gas Lift <input type="checkbox"/> Other (explain).....					
Estimated Production Per 24 Hours	Oil	Gas	Water	Gas-Oil Ratio	Gravity		
	Bbls	MCF	Bbls	CFPB			

METHOD OF COMPLETION

Production Interval

Disposition of gas:  Vented  Open Hole  Perforation  
 Sold  Other (Specify) .....  
 Used on Lease  Dually Completed .....  
 Commingled .....