

15-101-20148-00-00

1975 5-19-75

FORM CP-4

STATE OF KANSAS
STATE CORPORATION COMMISSION
CONSERVATION DIVISION
P. O. BOX 17027
WICHITA, KANSAS 67217

WELL PLUGGING RECORD

Lane _____ County, Sec. 25 Twp. 18S Rge. X 28 (W)

Location as "NE/CNW/SW" or footage from lines C NE SW
Lease Owner A.L. Abercrombie, Inc.

Lease Name SEIFRIED Well No. 3

Office Address 801 Union Center, Wichita, Ks 67202

Character of Well (completed as Oil, Gas or Dry Hole) Dry Hole

Date well completed May 13 1975

Application for plugging filed (verbal) May 13 1975

Application for plugging approved (verbal) May 13 1975

Plugging commenced May 13 1975

Plugging completed May 14 1975

Reason for abandonment of well or producing formation No commercial quantities of

oil or gas encountered.

If a producing well is abandoned, date of last production 19

Was permission obtained from the Conservation Division or its agents before plugging was commenced? Yes (verbally)

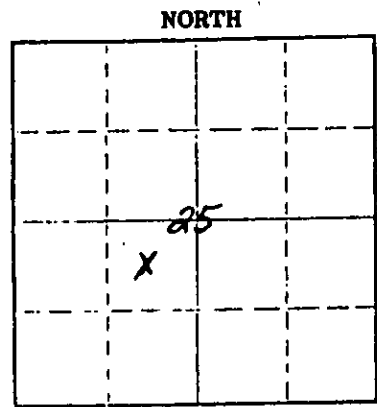

Locate well correctly on above Section Plat

Name of Conservation Agent who supervised plugging of this well Gilbert Balthazor - Palco, Kansas

Producing formation _____ Depth to top _____ Bottom _____ Total Depth of Well 4265'

Show depth and thickness of all water, oil and gas formations.

OIL, GAS OR WATER RECORDS				CASING RECORD		
FORMATION	CONTENT	FROM	TO	SIZE	PUT IN	PULLED OUT
				8-5/8"	235.47	None

Describe in detail the manner in which the well was plugged, indicating where the mud fluid was placed and the method or methods used in introducing it into the hole. If cement or other plugs were used, state the character of same and depth placed, from _____ feet to _____ feet for each plug set.

1st Plug Set @ 850' with 70 sacks cement
2nd Plug Set @ 230' with 20 sacks cement
3rd Plug Set @ 40' with 10 sacks cement

(If additional description is necessary, use BACK of this sheet)
Name of Plugging Contractor Abercrombie Drilling, Inc.
Address 801 Union Center, Wichita, Kansas 67202

STATE OF KANSAS COUNTY OF SEDGWICK, ss.
Jerry A. Langrehr, Exec. V.P. (employee of owner) or (owner or operator) of the above-described well, being first duly sworn on oath, says: That I have knowledge of the facts, statements, and matters herein contained and the log of the above-described well as filed and that the same are true and correct. So help me God.

(Signature) Jerry A. Langrehr
801 Union Center, Wichita, Ks. 67202
(Address)

SUBSCRIBED AND SWORN to before me this 16th day of May 19 75

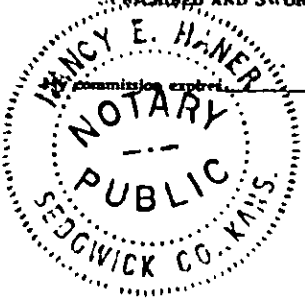

April 8, 1978

Nancy E. Haner
Nancy E. Haner Notary Public.

KANSAS DRILLERS LOG

API No. 15 — 101 — 20,148 - 00-00
 County Number

S. 25 T. 18S R. 28 K
W

Loc. - C NE SW

County Lane

Operator

A.L. Abercrombie, Inc.

Address

801 Union Center, Wichita, Kansas 67202

Well No.

3

Lease Name

SEIFRIED

Footage Location

1980 feet from (N) (S) line

1980 feet from (E) (W) line

Principal Contractor

Abercrombie Drilling, Inc.

Geologist

Orlin R. Phelps

Spud Date

May 6, 1975

Total Depth

4265'

P.B.T.D.

Date Completed

May 14, 1975

Oil Purchaser

None - Dry Hole

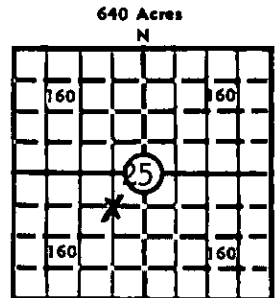

Elev.: Gr. 2646

DF 2649' KB 2651'

CASING RECORD

Report of all strings set — surface, intermediate, production, etc.

Purpose of string	Size hole drilled	Size casing set (in O.D.)	Weight lbs/ft.	Setting depth	Type cement	Sacks	Type and percent additives
Surface	12 1/4"	8-5/8"		235.47'	Sunset	165	None

LINER RECORD

PERFORATION RECORD

Top, ft.	Bottom, ft.	Sacks cement	Shots per ft.	Size & type	Depth interval

TUBING RECORD

Size	Setting depth	Packer set at

ACID, FRACTURE, SHOT, CEMENT SQUEEZE RECORD

Amount and kind of material used	Depth interval treated

INITIAL PRODUCTION

Date of first production		Producing method (flowing, pumping, gas lift, etc.)			
RATE OF PRODUCTION PER 24 HOURS		Oil	Gas	Water	Gas-oil ratio
		bbls.	MCF	bbls.	CFPB
Disposition of gas (vented, used on lease or sold)				Producing interval (s)	

INSTRUCTIONS: As provided in KCC Rule 82-2-125, within 90 days after completion of a well, one completed copy of this Drillers Log shall be transmitted to the State Geological Survey of Kansas, 4150 Monroe Street, Wichita, Kansas 67209. Copies of this form are available from the Conservation Division, State Corporation Commission, 3830 So. Meridian (P.O. Box 17027), Wichita, Kansas 66217. Phone AC 316-522-2206. If confidential custody is desired, please note Rule 82-2-125. Drillers Logs will be on open file in the Oil and Gas Division, State Geological Survey of Kansas, Lawrence, Kansas 66044.

Operator
A.L. Abercrombie, Inc.

DESIGNATE TYPE OF COMP.: OIL, GAS,
DRY HOLE, SWDW, ETC.:

Well No. 3 Lease Name SEIFRIED

Dry Hole

S 25 T 18S R 28 E W

WELL LOG

Show all important zones of porosity and contents thereof; cored intervals, and all drill-stem tests, including depth interval tested, cushion used, time tool open, flowing and shut-in pressures, and recoveries.

SHOW GEOLOGICAL MARKERS, LOGS RUN, OR OTHER DESCRIPTIVE INFORMATION.

FORMATION DESCRIPTION, CONTENTS, ETC.	TOP	BOTTOM	NAME	DEPTH	
Surface Dirt & Sand	0	180	ELECTRIC LOG TOPS:		
Shale	180	365			
Shale & Sand	365	1867		Anhydrite	2013
Shale	1867	2614		Heebner	3872
Shale & Lime	2614	2995		Toronto	3890
Shale	2995	3392		Lansing	3911
Shale & Lime	3392	3810		ELTD	4267
Lime	3810	4265			
Rotary Total Depth		4265			
<p>DST #1 (4157-4167) 30", 45", 60", 45" (180' Zone) Recovered 155' Muddy water with oil spots. FP's 0-71#; IBHP 1148#; FBHP 1148#. BHT 130°.</p> <p>DST #2 (4237-4265) 30", 45", 60", 45" Recovered 210' SW with show of free oil. FP's 0-118#; IBHP 1113#; FBHP 1067#. BHT 130°.</p> <p>Plugged & Abandoned: May 14, 1975</p>					

USE ADDITIONAL SHEETS, IF NECESSARY, TO COMPLETE WELL RECORD.

Date Received	 Jerry A. Langrehr Executive Vice President
	Title May 16, 1975 Date