



KANSAS CORPORATION COMMISSION 1073092
OIL & GAS CONSERVATION DIVISION

Form ACO-1
June 2009

Form Must Be Typed
Form must be Signed
All blanks must be Filled

CONFIDENTIAL

WELL COMPLETION FORM

WELL HISTORY - DESCRIPTION OF WELL & LEASE

OPERATOR: License # 34192
Name: SandRidge Exploration and Production LLC
Address 1: 123 ROBERT S. KERR AVE
Address 2: _____
City: OKLAHOMA CITY State: OK Zip: 73102 + 6406
Contact Person: Tiffany Golay
Phone: (405) 429-6543
CONTRACTOR: License # 34464
Name: Lariat Services, Inc.
Wellsite Geologist: Kathy Gentry
Purchaser: NCRA

Designate Type of Completion:

- New Well Re-Entry Workover
- Oil WSW SWD SIOW
 Gas D&A ENHR SIGW
 OG GSW Temp. Abd.
 CM (Coal Bed Methane)
 Cathodic Other (Core, Expl., etc.): _____

If Workover/Re-entry: Old Well Info as follows:

Operator: _____
Well Name: _____
Original Comp. Date: _____ Original Total Depth: _____
 Deepening Re-perf. Conv. to ENHR Conv. to SWD
 Conv. to GSW
 Plug Back: _____ Plug Back Total Depth
 Commingled Permit #: _____
 Dual Completion Permit #: _____
 SWD Permit #: _____
 ENHR Permit #: _____
 GSW Permit #: _____

1/3/2012	2/2/2012	2/3/2012
Spud Date or Recompletion Date	Date Reached TD	Completion Date or Recompletion Date

API No. 15 - 15-033-21613-01-00
Spot Description: _____
NE NW NE NE Sec. 15 Twp. 31 S. R. 20 East West
200 Feet from North / South Line of Section
810 Feet from East / West Line of Section
Footages Calculated from Nearest Outside Section Corner:
 NE NW SE SW
County: Comanche
Lease Name: PTL Well #: 1-15H
Field Name: _____
Producing Formation: Mississippi
Elevation: Ground: 2036 Kelly Bushing: 2016
Total Depth: 9999 Plug Back Total Depth: _____
Amount of Surface Pipe Set and Cemented at: 880 Feet
Multiple Stage Cementing Collar Used? Yes No
If yes, show depth set: _____ Feet
If Alternate II completion, cement circulated from: _____
feet depth to: _____ w/ _____ sx cmt.

Drilling Fluid Management Plan

(Data must be collected from the Reserve Pit)

Chloride content: 13000 ppm Fluid volume: 9240 bbls
Dewatering method used: Haul Off Pit
Location of fluid disposal if hauled offsite:
Operator Name: Triple C Soil Farming
Lease Name: unknown License #: 99999
Quarter NE Sec. 29 Twp. 26 S. R. 18 East West
County: Woodward, OK Permit #: 19424- OCC

AFFIDAVIT

I am the affiant and I hereby certify that all requirements of the statutes, rules and regulations promulgated to regulate the oil and gas industry have been fully complied with and the statements herein are complete and correct to the best of my knowledge.

Submitted Electronically

KCC Office Use ONLY

- Letter of Confidentiality Received
Date: 04/18/2012
 Confidential Release Date: _____
 Wireline Log Received
 Geologist Report Received
 UIC Distribution
ALT I II III Approved by: NAOMI JAMES Date: 04/19/2012

SandRidge Energy

Comanche County (KS27S)

Sec 15-T31S-R20W - GRID

PTL 1-15H

Wellbore #1

Survey: MWD Surveys

Standard Survey Report

01 February, 2012

Wolverine Directional, LLC

Survey Report

Company: SandRidge Energy	Local Co-ordinate Reference: Well PTL 1-15H	
Project: Comanche County (KS27S)	TVD Reference: WELL @ 0.0ft (Original Well Elev)	
Site: Sec 15-T31S-R20W - GRID	MD Reference: WELL @ 0.0ft (Original Well Elev)	
Well: PTL 1-15H	North Reference: Grid	
Wellbore: Wellbore #1	Survey Calculation Method: Minimum Curvature	
Design: Wellbore #1	Database: EDM 2003.21 Single User Db	

Design Wellbore #1

Audit Notes:

Version: 1.0	Phase: ACTUAL	Tie On Depth: 0.0		
Vertical Section:	Depth From (TVD) (ft)	+N/-S (ft)	+E/-W (ft)	Direction (°)
	0.0	0.0	0.0	181.17

Survey Program Date 2012/02/01

From (ft)	To (ft)	Survey (Wellbore)	Tool Name	Description
952.0	12,075.0	MWD Surveys (Wellbore #1)	MWD	MWD - Standard

Survey

Measured Depth (ft)	Inclination (°)	Azimuth (°)	Vertical Depth (ft)	+N/-S (ft)	+E/-W (ft)	Vertical Section (ft)	Dogleg Rate (°/100ft)	Build Rate (°/100ft)	Turn Rate (°/100ft)	
0.0	0.00	0.00	0.0	0.0	0.0	0.0	0.00	0.00	0.00	
952.0	0.30	297.30	952.0	1.1	-2.2	-1.1	0.03	0.03	0.00	
First MWD Survey										
1,139.0	0.40	248.40	1,139.0	1.1	-3.3	-1.1	0.16	0.05	-26.15	
1,520.0	0.80	172.70	1,520.0	-2.0	-4.2	2.1	0.21	0.10	-19.87	
1,996.0	0.40	181.90	1,995.9	-6.9	-3.2	6.9	0.09	-0.08	-2.27	
2,472.0	0.50	177.10	2,471.9	-10.5	-2.6	10.6	0.03	0.02	3.19	
2,948.0	0.30	152.80	2,947.9	-13.7	-1.9	13.7	0.05	-0.04	-5.11	
3,424.0	0.70	151.10	3,423.9	-17.4	0.1	17.4	0.08	0.08	-0.36	
3,901.0	0.80	141.90	3,900.9	-22.5	3.5	22.5	0.03	0.02	-1.93	
3,996.0	0.70	145.40	3,995.9	-23.5	4.3	23.4	0.12	-0.11	3.68	
4,091.0	0.50	159.20	4,090.8	-24.4	4.7	24.3	0.26	-0.21	14.53	
4,155.0	0.40	146.00	4,154.8	-24.8	5.0	24.7	0.22	-0.16	-20.63	
4,186.0	0.40	151.10	4,185.8	-25.0	5.1	24.9	0.11	0.00	16.45	
4,218.0	1.90	172.40	4,217.8	-25.7	5.2	25.5	4.79	4.69	66.56	
4,250.0	4.20	182.60	4,249.8	-27.4	5.2	27.2	7.36	7.19	31.88	
4,282.0	6.10	185.80	4,281.7	-30.2	5.0	30.1	6.00	5.94	10.00	
4,313.0	8.20	183.70	4,312.4	-34.1	4.7	34.0	6.83	6.77	-6.77	
4,345.0	10.70	181.60	4,344.0	-39.3	4.4	39.2	7.89	7.81	-6.56	
4,375.0	13.40	180.90	4,373.3	-45.6	4.3	45.5	9.01	9.00	-2.33	
4,407.0	16.10	180.70	4,404.3	-53.7	4.2	53.6	8.44	8.44	-0.63	
4,439.0	18.10	180.80	4,434.8	-63.1	4.1	63.0	6.25	6.25	0.31	
4,471.0	20.00	181.00	4,465.1	-73.6	3.9	73.5	5.94	5.94	0.63	
4,502.0	22.20	181.80	4,494.0	-84.7	3.6	84.6	7.16	7.10	2.58	
4,534.0	24.20	182.00	4,523.4	-97.3	3.2	97.2	6.25	6.25	0.63	
4,566.0	26.10	182.90	4,552.4	-110.9	2.6	110.8	6.06	5.94	2.81	
4,598.0	27.90	182.90	4,580.9	-125.4	1.9	125.3	5.63	5.63	0.00	
4,630.0	30.00	182.80	4,608.9	-140.9	1.1	140.8	6.56	6.56	-0.31	
4,661.0	32.00	182.70	4,635.5	-156.8	0.4	156.8	6.45	6.45	-0.32	
4,693.0	34.50	182.10	4,662.2	-174.4	-0.4	174.3	7.88	7.81	-1.88	
4,725.0	36.20	181.40	4,688.3	-192.9	-0.9	192.8	5.46	5.31	-2.19	
4,757.0	37.80	181.50	4,713.9	-212.1	-1.4	212.1	5.00	5.00	0.31	
4,789.0	40.00	181.70	4,738.8	-232.2	-2.0	232.2	6.89	6.88	0.63	
4,820.0	41.70	181.30	4,762.2	-252.5	-2.5	252.5	5.55	5.48	-1.29	
4,852.0	44.10	181.20	4,785.7	-274.2	-3.0	274.3	7.50	7.50	-0.31	
4,884.0	45.80	182.00	4,808.3	-296.8	-3.6	296.9	5.60	5.31	2.50	
4,915.0	48.00	181.30	4,829.5	-319.5	-4.3	319.5	7.29	7.10	-2.26	
4,947.0	50.80	180.70	4,850.3	-343.8	-4.7	343.8	8.87	8.75	-1.88	
4,979.0	51.00	180.70	4,870.5	-368.6	-5.0	368.6	0.63	0.63	0.00	

Wolverine Directional, LLC

Survey Report

Company: SandRidge Energy
Project: Comanche County (KS27S)
Site: Sec 15-T31S-R20W - GRID
Well: PTL 1-15H
Wellbore: Wellbore #1
Design: Wellbore #1

Local Co-ordinate Reference: Well PTL 1-15H
TVD Reference: WELL @ 0.0ft (Original Well Elev)
MD Reference: WELL @ 0.0ft (Original Well Elev)
North Reference: Grid
Survey Calculation Method: Minimum Curvature
Database: EDM 2003.21 Single User Db

Survey

Measured Depth (ft)	Inclination (°)	Azimuth (°)	Vertical Depth (ft)	+N/-S (ft)	+E/-W (ft)	Vertical Section (ft)	Dogleg Rate (°/100ft)	Build Rate (°/100ft)	Turn Rate (°/100ft)
5,011.0	50.30	180.90	4,890.8	-393.3	-5.3	393.4	2.24	-2.19	0.63
5,042.0	50.20	180.90	4,910.6	-417.2	-5.7	417.2	0.32	-0.32	0.00
5,074.0	49.70	180.60	4,931.2	-441.7	-6.0	441.7	1.72	-1.58	-0.94
5,106.0	49.10	180.20	4,952.0	-466.0	-6.2	466.0	2.10	-1.88	-1.25
5,138.0	50.60	180.00	4,972.7	-490.4	-6.2	490.4	4.71	4.69	-0.63
5,169.0	53.30	179.70	4,991.8	-514.8	-6.2	514.8	8.74	8.71	-0.97
5,201.0	56.70	180.40	5,010.1	-541.0	-6.2	541.0	10.77	10.63	2.19
5,233.0	59.70	181.50	5,027.0	-568.2	-6.7	568.2	9.82	9.38	3.44
5,265.0	63.20	181.90	5,042.3	-596.3	-7.5	596.3	10.99	10.94	1.25
5,298.0	65.80	181.40	5,055.6	-624.3	-8.3	624.3	8.51	8.39	-1.61
5,328.0	68.80	180.80	5,068.0	-653.8	-8.9	653.8	9.53	9.38	-1.88
5,360.0	71.80	180.60	5,078.8	-683.9	-9.2	684.0	9.39	9.38	-0.63
5,392.0	75.60	180.50	5,087.7	-714.6	-9.5	714.7	11.88	11.88	-0.31
5,424.0	79.20	180.50	5,094.7	-745.8	-9.8	745.9	11.25	11.25	0.00
5,456.0	82.10	181.10	5,099.9	-777.4	-10.2	777.5	9.25	9.06	1.88
5,476.0	84.30	181.10	5,102.3	-797.3	-10.6	797.3	11.00	11.00	0.00
5,554.0	87.80	182.30	5,107.6	-875.0	-12.9	875.1	4.74	4.49	1.54
5,586.0	87.90	182.10	5,108.9	-907.0	-14.2	907.1	0.70	0.31	-0.63
5,618.0	88.80	182.10	5,109.8	-938.9	-15.3	939.1	2.81	2.81	0.00
5,650.0	89.90	182.40	5,110.1	-970.9	-16.6	971.1	3.56	3.44	0.94
5,745.0	90.10	182.50	5,110.1	-1,065.8	-20.7	1,066.0	0.24	0.21	0.11
5,841.0	90.10	182.60	5,110.0	-1,161.7	-24.9	1,162.0	0.10	0.00	0.10
5,937.0	89.80	181.90	5,110.1	-1,257.7	-28.7	1,258.0	0.79	-0.31	-0.73
6,032.0	89.60	181.60	5,110.5	-1,352.6	-31.6	1,353.0	0.38	-0.21	-0.32
6,128.0	88.70	180.60	5,112.0	-1,448.6	-33.4	1,449.0	1.40	-0.94	-1.04
6,223.0	90.10	180.40	5,113.0	-1,543.6	-34.3	1,544.0	1.49	1.47	-0.21
6,319.0	90.10	180.40	5,112.8	-1,639.6	-34.9	1,639.9	0.00	0.00	0.00
6,415.0	89.80	179.80	5,112.9	-1,735.6	-35.1	1,735.9	0.70	-0.31	-0.63
6,510.0	89.50	179.00	5,113.5	-1,830.6	-34.1	1,830.9	0.90	-0.32	-0.84
6,606.0	89.40	178.90	5,114.4	-1,926.5	-32.3	1,926.8	0.15	-0.10	-0.10
6,701.0	90.20	179.70	5,114.7	-2,021.5	-31.2	2,021.8	1.19	0.84	0.84
6,796.0	90.40	179.70	5,114.2	-2,116.5	-30.7	2,116.7	0.21	0.21	0.00
6,892.0	90.30	179.40	5,113.6	-2,212.5	-29.9	2,212.7	0.33	-0.10	-0.31
6,988.0	90.00	178.90	5,113.4	-2,308.5	-28.5	2,308.6	0.81	-0.31	-0.52
7,083.0	90.70	178.50	5,112.8	-2,403.5	-26.4	2,403.5	0.85	0.74	-0.42
7,179.0	90.20	177.90	5,112.0	-2,499.4	-23.3	2,499.4	0.81	-0.52	-0.63
7,275.0	90.20	179.20	5,111.7	-2,595.4	-20.9	2,595.3	1.35	0.00	1.35
7,370.0	90.60	180.30	5,111.0	-2,690.4	-20.5	2,690.3	1.23	0.42	1.16
7,466.0	89.40	181.30	5,111.0	-2,786.4	-21.8	2,786.3	1.63	-1.25	1.04
7,561.0	89.40	180.70	5,112.0	-2,881.4	-23.5	2,881.2	0.63	0.00	-0.63
7,657.0	89.00	181.10	5,113.4	-2,977.3	-25.0	2,977.2	0.59	-0.42	0.42
7,753.0	89.10	181.20	5,115.0	-3,073.3	-26.9	3,073.2	0.15	0.10	0.10
7,848.0	88.90	180.90	5,116.6	-3,168.3	-28.7	3,168.2	0.38	-0.21	-0.32
7,944.0	89.30	180.70	5,118.1	-3,264.3	-30.0	3,264.2	0.47	0.42	-0.21
8,040.0	89.90	181.70	5,118.8	-3,360.2	-32.0	3,360.2	1.21	0.63	1.04
8,159.0	90.20	180.70	5,118.7	-3,479.2	-34.5	3,479.2	0.88	0.25	-0.84
8,254.0	91.80	181.50	5,117.1	-3,574.2	-36.3	3,574.2	1.88	1.68	0.84
8,350.0	92.80	181.90	5,113.2	-3,670.1	-39.2	3,670.1	1.12	1.04	0.42
8,446.0	91.80	181.90	5,109.3	-3,765.9	-42.4	3,766.0	1.04	-1.04	0.00
8,541.0	91.30	181.40	5,106.8	-3,860.8	-45.1	3,861.0	0.74	-0.53	-0.53
8,637.0	90.90	181.40	5,104.9	-3,956.8	-47.4	3,956.9	0.42	-0.42	0.00
8,733.0	90.60	182.80	5,103.7	-4,052.7	-51.0	4,052.9	1.49	-0.31	1.46
8,829.0	89.10	183.40	5,103.9	-4,148.6	-56.2	4,148.9	1.68	-1.56	0.63
8,925.0	89.40	183.80	5,105.2	-4,244.4	-62.2	4,244.8	0.52	0.31	0.42

Wolverine Directional, LLC
Survey Report

Company: SandRidge Energy
Project: Comanche County (KS27S)
Site: Sec 15-T31S-R20W - GRID
Well: PTL 1-15H
Wellbore: Wellbore #1
Desgn: Wellbore #1

Local Co-ordinate Reference: Well PTL 1-15H
TVD Reference: WELL @ 0.0ft (Original Well Elev)
MD Reference: WELL @ 0.0ft (Original Well Elev)
North Reference: Grid
Survey Calculation Method: Minimum Curvature
Database: EDM 2003.21 Single User Db

Survey

Measured Depth (ft)	Inclination (°)	Azimuth (°)	Vertical Depth (ft)	+N-S (ft)	+E-W (ft)	Vertical Section (ft)	Dogleg Rate (°/100ft)	Build Rate (°/100ft)	Turn Rate (°/100ft)
9,020.0	87.00	182.80	5,108.2	-4,339.2	-67.6	4,339.6	2.74	-2.53	-1.05
9,116.0	87.30	182.10	5,112.9	-4,435.0	-71.7	4,435.5	0.79	0.31	-0.73
9,212.0	88.00	182.30	5,116.9	-4,530.8	-75.4	4,531.4	0.76	0.73	0.21
9,308.0	88.60	181.90	5,119.7	-4,626.7	-78.9	4,627.4	0.75	0.63	-0.42
9,404.0	88.80	182.20	5,121.9	-4,722.6	-82.4	4,723.3	0.38	0.21	0.31
9,499.0	89.30	181.80	5,123.5	-4,817.5	-85.7	4,818.3	0.67	0.53	-0.42
9,595.0	88.90	181.20	5,125.0	-4,913.5	-88.2	4,914.3	0.75	-0.42	-0.63
9,691.0	90.00	180.00	5,125.9	-5,009.5	-89.2	5,010.3	1.70	1.15	-1.25
9,786.0	90.00	179.90	5,125.9	-5,104.5	-89.1	5,105.2	0.11	0.00	-0.11
9,882.0	91.20	179.50	5,124.9	-5,200.5	-88.6	5,201.2	1.32	1.25	-0.42
9,978.0	91.40	180.00	5,122.7	-5,296.5	-88.2	5,297.1	0.56	0.21	0.52
10,073.0	91.60	180.70	5,120.2	-5,391.4	-88.8	5,392.1	0.77	0.21	0.74
10,169.0	90.30	181.40	5,118.6	-5,487.4	-90.5	5,488.1	1.54	-1.35	0.73
10,265.0	87.30	181.60	5,120.7	-5,583.3	-93.1	5,584.1	3.13	-3.13	0.21
10,360.0	88.40	180.60	5,124.2	-5,678.2	-94.9	5,679.0	1.56	1.16	-1.05
10,456.0	89.60	181.80	5,125.9	-5,774.2	-96.9	5,775.0	1.77	1.25	1.25
10,550.0	90.40	181.80	5,125.9	-5,868.1	-99.8	5,869.0	0.85	0.85	0.00
10,645.0	91.80	181.10	5,124.2	-5,963.1	-102.2	5,963.9	1.46	1.26	-0.74
10,741.0	92.70	181.10	5,120.6	-6,059.0	-104.1	6,059.9	1.15	1.15	0.00
10,836.0	92.00	180.60	5,116.7	-6,153.9	-105.5	6,154.8	0.91	-0.74	-0.53
10,931.0	90.90	181.50	5,114.3	-6,248.9	-107.2	6,249.8	1.50	-1.16	0.95
11,027.0	90.00	182.60	5,113.6	-6,344.8	-110.7	6,345.7	1.48	-0.94	1.15
11,123.0	90.20	181.90	5,113.4	-6,440.7	-114.4	6,441.7	0.76	0.21	-0.73
11,218.0	88.70	181.40	5,114.3	-6,535.7	-117.2	6,536.7	1.66	-1.58	-0.53
11,314.0	89.10	182.00	5,118.2	-6,631.6	-120.0	6,632.7	0.75	0.42	0.63
11,410.0	90.00	181.30	5,116.9	-6,727.6	-122.8	6,728.7	1.19	0.94	-0.73
11,506.0	91.50	181.70	5,115.7	-6,823.5	-125.3	6,824.7	1.62	1.56	0.42
11,603.0	92.30	182.20	5,112.5	-6,920.4	-128.6	6,921.6	0.97	0.82	0.52
11,699.0	89.70	183.40	5,110.8	-7,016.3	-133.3	7,017.5	2.98	-2.71	1.25
11,795.0	88.80	181.80	5,112.0	-7,112.2	-137.7	7,113.5	1.82	-0.94	-1.58
11,891.0	90.80	186.00	5,112.4	-7,207.9	-144.3	7,209.4	4.75	2.08	4.27
11,988.0	90.70	186.00	5,111.1	-7,304.4	-154.5	7,306.0	0.10	-0.10	0.00
12,026.0	90.70	185.50	5,110.6	-7,342.2	-158.3	7,343.9	1.32	0.00	-1.32
Last MWD Survey									
12,074.8	90.70	185.50	5,110.0	-7,390.8	-163.0	7,392.6	0.00	0.00	0.00
PTL 1-15H PBHL									
12,075.0	90.70	185.50	5,110.0	-7,391.0	-163.0	7,392.7	0.00	0.00	0.00
Proj to TD									

Survey Annotations

Measured Depth (ft)	Vertical Depth (ft)	Local Coordinates		Comment
		+N-S (ft)	+E-W (ft)	
952.0	952.0	1.1	-2.2	First MWD Survey
12,026.0	5,110.6	-7,342.2	-158.3	Last MWD Survey
12,075.0	5,110.0	-7,391.0	-163.0	Proj to TD

Checked By: _____ Approved By: _____ Date: _____

American Measurement Services

A Limited Liability Company
Ames, Oklahoma

Station Number: KS03R0020
Producer: SANDRIDGE ENERGY
Lease: PTL 1-15H
Sample Pressure: 92.0
Sample Temperature: 75.0
Cylinder Number: 295
Analysis By: AMS
Date Sampled: 3/6/2012
Analysis Run Date: 3/7/2012

Gas Components	Mole Percent	GPM
Methane	79.431	
Ethane	4.666	1.2403
Propane	2.035	0.5573
IButane	0.337	0.1098
NButane	0.655	0.2053
IPentan	0.206	0.0748
NPentan	0.194	0.0700
C6 +	0.373	0.1619
Nitrogen	11.586	
CO2	0.516	
	100.00%	2.4194

BTU @ 14.65 @ 60 F - Real

Dry 1002.8
Wet 985.2

Gasoline Content

Propane And Heavier 1.1791
Butane And Heavier 0.6218
Pentane And Heavier 0.3067

Specific Gravity - Real 0.6826
Z = 0.9976

H2S Field Test: 0 PPM

Field Remarks:

Analysis Based Upon GPA 2145, 2172, And 2261

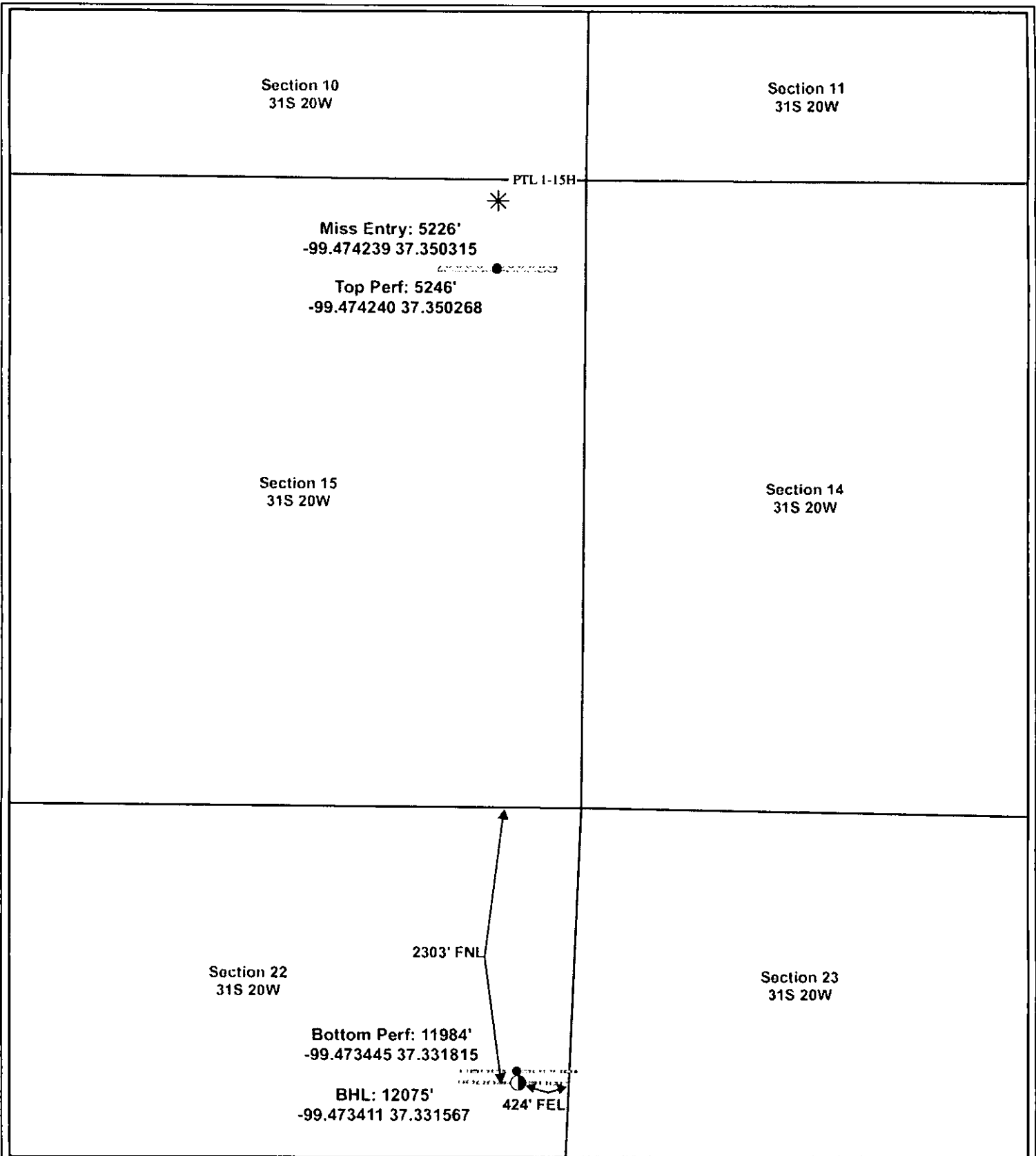

<p>Actual BH Location Lat/Long</p> <p>* SandRidge Wells</p> <p>--- Perf</p> <p>□ Sections</p>	<p>Actual Bottom-Hole Location of PTL 1-15H Comanche County, Kansas T&R: 31S 20W Section: 22, 424' FEL & 2303' FNL Long/Lat: -99.473411 37.331567</p> <p>1 in = 1,042 ft</p>	Draftsman: Aaron Birk	Draft Date: 4/17/2012
		Drawing Name/Number: Addendum_PTL_1-15H.mxd	
		Coordinate System: NAD 1927 State Plane Kansas South FIPS: 1502	