

KANSAS CORPORATION COMMISSION  
OIL & GAS CONSERVATION DIVISION

Form ACO-4  
Form must be typed  
March 2009

APPLICATION FOR COMMINGLING OF  
PRODUCTION (K.A.R. 82-3-123) OR FLUIDS (K.A.R. 82-3-123a)

Commingling ID # CO 021202

OPERATOR: License # 4767  
Name: Ritchie Exploration, Inc.  
Address 1: P.O. Box 783188  
Address 2: \_\_\_\_\_  
City: Wichita State: KS Zip: 67278 + 3188  
Contact Person: John Niernberger  
Phone: (316) 691-9500

API No. 15 - 109-20862 - 00 - 00  
Spot Description: 94' S & 7' E  
NW SW SE \_\_\_\_\_ Sec. 36 Twp. 13 S. R. 32  East  West  
896 Feet from  North /  South Line of Section  
2,303 Feet from  East /  West Line of Section  
County: Logan  
Lease Name: Stucky 36D Well #: 1

1. Name and upper and lower limit of each production interval to be commingled:
- |                           |                                   |
|---------------------------|-----------------------------------|
| Formation: <u>Johnson</u> | (Perfs): <u>4470.5' - 4474.5'</u> |
| Formation: <u>LKC</u>     | (Perfs): <u>4074.3' - 4078.3'</u> |
| Formation: _____          | (Perfs): _____                    |
| Formation: _____          | (Perfs): _____                    |
| Formation: _____          | (Perfs): _____                    |

2. Estimated amount of fluid production to be commingled from each interval:
- |                           |                   |              |                   |
|---------------------------|-------------------|--------------|-------------------|
| Formation: <u>Johnson</u> | BOPD: <u>1.54</u> | MCFPD: _____ | BWPD: <u>8.70</u> |
| Formation: <u>LKC</u>     | BOPD: <u>.94</u>  | MCFPD: _____ | BWPD: <u>5.33</u> |
| Formation: _____          | BOPD: _____       | MCFPD: _____ | BWPD: _____       |
| Formation: _____          | BOPD: _____       | MCFPD: _____ | BWPD: _____       |
| Formation: _____          | BOPD: _____       | MCFPD: _____ | BWPD: _____       |

3. Plat map showing the location of the subject well, all other wells on the subject lease, and all wells on offsetting leases within a 1/2 mile radius of the subject well, and for each well the names and addresses of the lessee of record or operator.
4. Signed certificate showing service of the application and affidavit of publication as required in K.A.R. 82-3-135a.

For Commingling of PRODUCTION ONLY, include the following:

5. Wireline log of subject well. Previously Filed with ACO-1:  Yes  No
6. Complete Form ACO-1 (Well Completion form) for the subject well.

For Commingling of FLUIDS ONLY, include the following:

7. Well construction diagram of subject well.
8. Any available water chemistry data demonstrating the compatibility of the fluids to be commingled.

AFFIDAVIT: I am the affiant and hereby certify that to the best of my current information, knowledge and personal belief, this request for commingling is true and proper and I have no information or knowledge, which is inconsistent with the information supplied in this application.

Signature: [Signature]  
Printed Name: John Niernberger  
Title: Production Manager

RECEIVED  
FEB 03 2012  
KCC WICHITA

**KCC Office Use Only**

Denied  Approved

15-Day Periods Ends: 1/24/2012

Approved By: \_\_\_\_\_ Date: \_\_\_\_\_

Protests may be filed by any party having a valid interest in the application. Protests must be in writing and comply with K.A.R. 82-3-135b and must be filed within 15 days of publication of the notice of application.

R 32 W

R 31 W

T  
13  
S

T  
14  
S

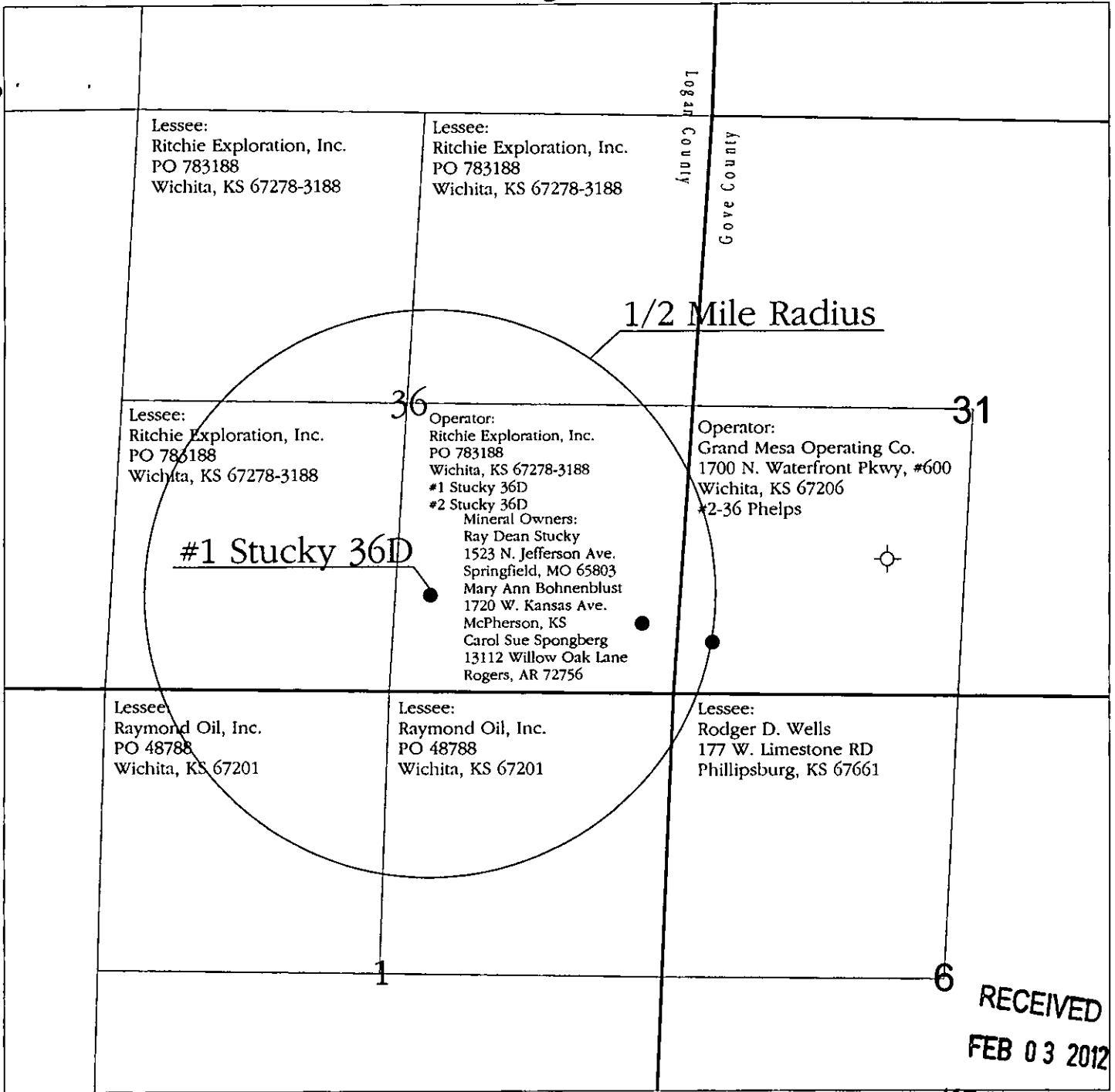

RECEIVED  
FEB 03 2012

KCC WICHITA

**Legend**

- Oil Well
- / Abandoned Oil Well
- Dry and Abandoned Well



**RITCHIE**  
EXPLORATION, INC.  
Wichita, Kansas

Application for  
Commingling of  
Production or Fluids

**Applicant Well: #1 Stucky 36D**  
 Offsetting Leases within 1/2 Mile of Applicant Well  
 All Wells on Offsetting Leases  
 Operator or Lessee of Record for Offsetting Leases

Logan / Gove County, Kansas

Prepared By: Justin Clegg	Scale: 1 : 16,500	Date: January 19, 2010
------------------------------	----------------------	---------------------------

**AFFIDAVIT**

STATE OF KANSAS        )  
                                  - SS.  
County of Sedgwick        )

John Niernberger, of lawful age, being first duly sworn, deposeth and saith: That he is Production Manager of Ritchie Exploration, County of Sedgwick, State of Kansas, and that notice was given to all lessee of record or operator within ½ mile radius of the Stucky 36D #1 well located in the County of Logan (see attached plat map). This notice included a letter and a copy of the Commingle Application (ACO-4). All notices were mailed on December 28, 2011.

made as aforesaid on the 7<sup>th</sup> of  
February A.D. 2012

\_\_\_\_\_  
And affiant further says that he has personal knowledge of the statements above set forth and that they are true.

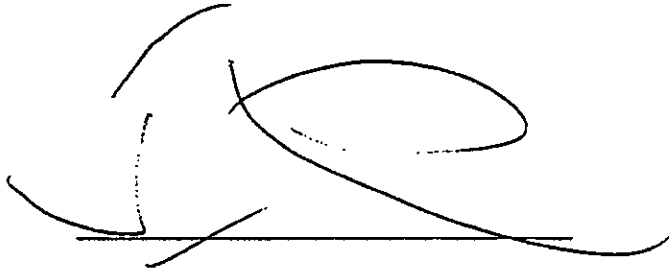

Subscribed and sworn to before me this

7<sup>th</sup> day of February 2012

RECEIVED  
FEB 07 2012  
KCC WICHITA

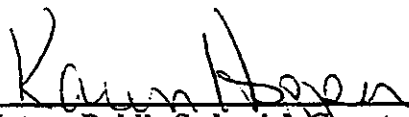
  
\_\_\_\_\_  
Notary Public Sedgwick County, Kansas

**KAREN HOPPER**  
**NOTARY PUBLIC-STATE OF KANSAS**  
MY APPT. EXPIRES 3-8-15

**APPLICATION FOR COMMINGLING OF PRODUCTION OR FLUIDS**

**Operator, Lessee or Unleased Mineral Owner  
Within a ½ mile Radius of Ritchie Exploration, Inc.'s**

**#1 Stucky 36D  
896' FSL & 2303' FEL  
Section 36-13S-32W  
Logan Co., KS**

*Logan Co., KS*

**Township 13 South, Range 32 West**

Sec. 36:	N/2	Ritchie Exploration, Inc.	Lessee
	SW/4	Ritchie Exploration, Inc.	Lessee
	SE/4	Ritchie Exploration, Inc.	Operator: #1 Stucky 36D
		Ray Dean Stucky 1523 N. Jefferson Ave. Springfield, MO 65803	Mineral Owner
		Mary Ann Bohnenblust 1720 W. Kansas Ave. McPherson, KS	Mineral Owner
		Carol Sue Spongberg 13112 Willow Oak Lane Rogers, AR 72756	Mineral Owner

**Township 14 South, Range 32 West**

Sec. 1:	NW/4	Raymond Oil, Inc. P.O. Box 48788 Wichita, KS 67201	Lessee
	NE/4	Rodger D. Wells 177 W. Limestone RD Phillipsburg, KS 67661	Lessee

RECEIVED  
FEB 03 2012  
KCC WICHITA

*Gove Co., KS*

**Township 13 South, Range 31 West**

**Sec. 31:      SW/4            Grand Mesa Operating Company            Operator: #1-31 Phelps  
   1700 N. Waterfront Pkwy, #600  
   Wichita, KS 67206**

**Township 14 South, Range 31 West**

**Sec. 6:        NW/4            Rodger D. Wells                                Lessee  
   177 W. Limestone RD  
   Phillipsburg, KS 67661**

RECEIVED  
FEB 03 2012  
KCC WICHITA

**AFFIDAVIT**

STATE OF KANSAS \  
- SS.  
County of Sedgwick /

Mark Fletchall, of lawful age, being first duly sworn, deposeth and saith: That he is Record Clerk of The Wichita Eagle, a daily newspaper published in the City of Wichita, County of Sedgwick, State of Kansas, and having a general paid circulation on a daily basis in said County, which said newspaper has been continuously and uninterruptedly published in said County for more than one year prior to the first publication of the notice hereinafter mentioned, and which said newspaper has been entered as second class mail matter at the United States Post Office in Wichita, Kansas, and which said newspaper is not a trade, religious or fraternal publication and that a notice of a true copy is hereto attached and published in the regular and entire Morning issue of said The Wichita Eagle for 1 issues, that the first publication of said notice was

made as aforesaid on the 7th of

December A.D. 2011, with

subsequent publications being made on the following dates:

And affiant further says that he has personal knowledge of the statements above set forth and that they are true.

*Mark Fletchall*

Subscribed and sworn to before me this

7th day of December, 2011

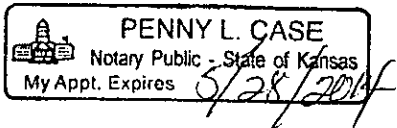

*Penny L. Case*  
Notary Public Sedgwick County, Kansas

Printer's Fee : \$91.60

**LEGAL PUBLICATION**  
PUBLISHED IN THE WICHITA EAGLE  
DECEMBER 7, 2011 (3157779)  
**LEGAL NOTICE**  
You, and each of you, are hereby notified that Ritchie Exploration, Inc. has filed an application to commence the commingling of production from the Lansing-Kansas City and Johnson sources of supply for the #1 Stucky 36D well located approx. NW SW SE of Section 36-13S-32W, Logan County, Kansas.  
Any persons who object to or protest this application shall be required to file their objections or protests with the Conservation Division of the State Corporation Commission of the State of Kansas within fifteen (15) days from the date of the publication. These protests shall be filed pursuant to Commission regulations and must state specific reasons why the grant of the application may cause waste, violate correlative rights or pollute the natural resources of the state of Kansas.  
If no protests are received, this application may be granted through a summary proceeding. If valid protests are received, this matter will be set for hearing.  
All persons interested or concerned shall take notice of the foregoing and shall govern themselves accordingly.  
RITCHIE EXPLORATION, INC.  
P.O. Box 783188  
Wichita, KS 67278-3188  
(316) 691-9900

RECEIVED  
FEB 03 2012  
KCC WICHITA

# Proof of Publication

## Affidavit of Publication

State of Kansas,  
LOGAN COUNTY, ss:

Barbara Glover

being first duly sworn, deposes and says, that

she

is the editor of **THE OAKLEY GRAPHIC**, a weekly newspaper printed in the State of Kansas, and published in and of general circulation in Logan County, Kansas, with a general paid circulation on a weekly and that said newspaper is not a trade, religious, or fraternal publication.

Said newspaper is a weekly, published at least weekly 50 times a year; has been so published continuously and uninterruptedly in said county and state for a period of more than five years prior to the first publication of said notice; and has been admitted at the post office of Oakley in said county as second class matter.

That the attached notice is a true copy thereof and was published in the regular and entire issue of said newspaper for 1 consecutive weeks the first publication thereof being made as aforesaid on the 11 day of January, 2012 with subsequent publications being made on the following dates:

- 1st Publication was made on the 11 day of Jan., 2012
- 2nd Publication was made on the \_\_\_\_\_ day of \_\_\_\_\_, 20 \_\_\_\_\_
- 3rd Publication was made on the \_\_\_\_\_ day of \_\_\_\_\_, 20 \_\_\_\_\_
- 4th Publication was made on the \_\_\_\_\_ day of \_\_\_\_\_, 20 \_\_\_\_\_
- 5th Publication was made on the \_\_\_\_\_ day of \_\_\_\_\_, 20 \_\_\_\_\_
- 6th Publication was made on the \_\_\_\_\_ day of \_\_\_\_\_, 20 \_\_\_\_\_

Publication fee \$ 43.20  
 Affidavit, Notary's Fees \$ \_\_\_\_\_  
 Additional Copies @ \_\_\_\_\_ \$ \_\_\_\_\_  
 Total Publication Fee \$ 43.20

(Signed) [Signature]

Witness my hand this 26 day of January, 2012

SUBSCRIBED and SWORN to before me this 26 day of January, 2012.

[Signature]  
(Notary Public)

My commission expires 2-7-2014

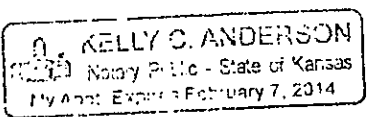

## Legal Notice

Published in the Oakley Graphic Jan. 11, 2012

### LEGAL NOTICE

You, and each of you, are hereby notified that Ritchie Exploration, Inc. has filed an application to commence the commingling of production from the Lansing-Kansas City and Johnson sources of supply for the #1 Stucky 36D well located approx. NW SW SE of Section 36-13S-32W, Logan County, Kansas.

Any persons who object to or protest this application shall be required to file their objections or protests with the Conservation Division of the State Corporation Commission of the State of Kansas within fifteen (15) days from the date of the publication. These protests shall be filed pursuant to Commission regulations and must state specific reasons why the grant of the application may cause waste, violate correlative rights or pollute the natural resources of the state of Kansas.

If no protests are received, this application may be granted through a summary proceeding. If valid protests are received, this matter will be set for hearing.

All persons interested or concerned shall take notice of the foregoing and shall govern themselves accordingly.

RITCHIE EXPLORATION, INC.  
P.O. Box 783188  
Wichita, KS 67278-3188  
(316) 691-9500

RECEIVED  
FEB 03 2012

KCC WICHITA

February 8, 2012

John Niernberger  
Ritchie Exploration, Inc.  
P.O. Box 783188  
Wichita, KS 67278-3188

RE: Approved Commingling CO021202  
Stucky 36D #1, Sec.36-T13S-R32W, Logan County  
API No. 15-109-20862-00-00

Dear Mr. Niernberger:

Your Application for Commingling (ACO-4) for the above described well has been reviewed and approved by the Kansas Corporation Commission (KCC) per K.A.R. 82-3-123. Notice was examined and found to be proper per K.A.R. 82-3-135a. No protest had been filed within the 15-day protest period. This application, which was received by the KCC on February 3, 2012, concerns approval to simultaneously produce from the following sources of supply through the same tubing string in the same wellbore:

Source of Supply	Estimated Current Production			Perf Depth
	BOPD	MCFPD	BWPD	
Johnson	1.54	0	8.70	4470.5-4474.5
LKC	0.94	0	5.33	4074.3-4078.3
Total Estimated Current Production	2.48	0.0	14.03	

Based upon the depth of the Johnson formation perforations, total oil production shall not exceed 200 BOPD and total gas production shall not exceed 50% of the absolute open flow (AOF).

Commingling ID number CO021202 has been assigned to this approved application. Use this number for well completion reports (ACO-1) and other correspondence that may concern this approved commingling.

Sincerely,

A handwritten signature in black ink, appearing to read "Rick Hestermann".

Rick Hestermann  
Production Department