

PLAT AND CERTIFICATION OF ACREAGE ATTRIBUTABLE TO AN OIL WELL

State Corporation Commission, Conservation Division
200 Colorado Derby Bldg. Wichita, Kansas 67202

OPERATOR American Energies Corporation

LOCATION OF WELL:

LEASE Hiltabidle

330 feet from the South line

WELL NUMBER 'C' #1

1650 feet from the East line

FIELD Chaff South

Of the SW/4 of Sec 28 T. 16S R. 21W

COUNTY Ness

*NUMBER OF ACRES
ATTRIBUTABLE TO WELL 40 Acres

DESCRIPTION OF ACREAGE:

C SE SW SW Sec. 28-16S-21W

PLAT

(Show location of Well and outline attributable acreage)
(Show footage to nearest lease or unit boundary line)

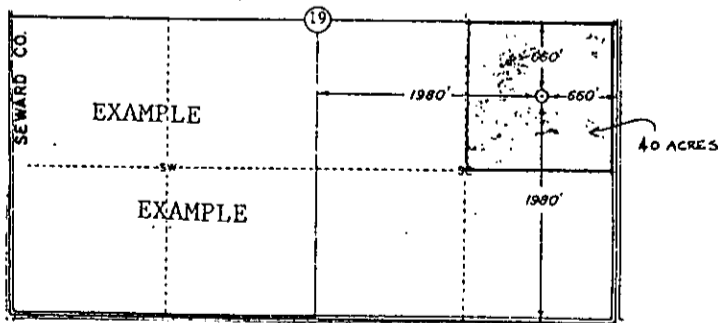
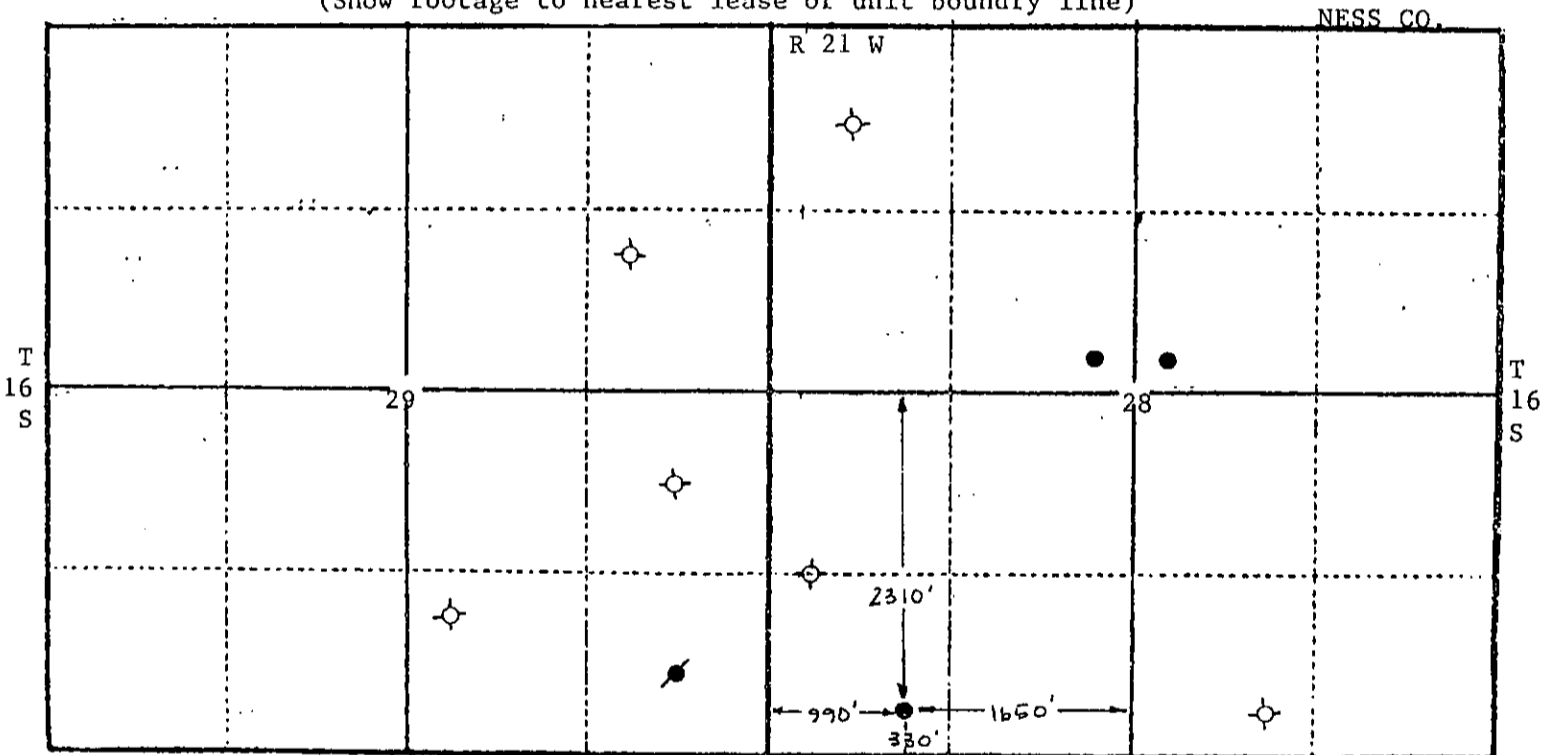

The undersigned hereby certifies that he is Vice-President for American Energies Corporation, a duly authorized agent, that all information shown hereon is true and correct to the best of his knowledge and belief, and that all acreage claimed as attributable to the well named herein is held by production from that well.

2-11-88

Suscribed and sworn to before me on this _____ day of _____, 19____.

Alan L. DeGood
Notary Public

My Commission expires _____