

15-101-20109-0000

STATE OF KANSAS
STATE CORPORATION COMMISSION

Form CP-4

WELL PLUGGING RECORD

Give All Information Completely
Make Required Affidavit
Mail or Deliver Report to:
Conservation Division
State Corporation Commission
P. O. Box 17027
Wichita, Kansas 67217

Lane _____ County, Sec. 20 Twp. 19S Rge. 28W (E) (W)

Location as "NE/CNWSW" or footage from lines _____ C NW SW
Lease Owner Donald C. Slawson
Lease Name Hineman 'P' Well No. 1
Office Address 408 120 Building, Wichita, Kansas 67202
Character of Well (completed as Oil, Gas or Dry Hole) Dry Hole
Date well completed July 8, 1974
Application for plugging filed July 8, 1974
Application for plugging approved July 8, 1974
Plugging commenced July 8, 1974
Plugging completed July 8, 1974
Reason for abandonment of well or producing formation Dry Hole

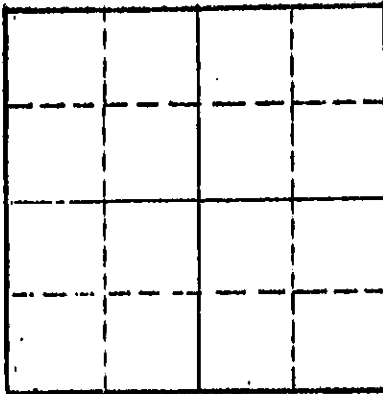

Locate well correctly on above
Section Plat

If a producing well is abandoned, date of last production _____ 19____
Was permission obtained from the Conservation Division or its agents before plugging was commenced? Yes

Name of Conservation Agent who supervised plugging of this well Leo Massey, Hays, Ks.
Producing formation _____ Depth to top _____ Bottom _____ Total Depth of Well 4706 Feet
Show depth and thickness of all water, oil and gas formations.

OIL, GAS OR WATER RECORDS

CASING RECORD

FORMATION	CONTENT	FROM	TO	SIZE	PUT IN	PULLED OUT
Surface Casing	258'			8 5/8"		

Describe in detail the manner in which the well was plugged, indicating where the mud fluid was placed and the method or methods used in introducing it into the hole. If cement or other plugs were used, state the character of same and depth placed, from _____ feet to _____ feet for each plug set.

1st plug set @ 900' w/70 sx
2nd plug set @ 240' w/20 sx
3rd plug set @ 40' w/10 sx

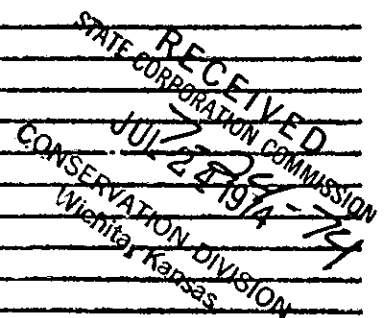

(If additional description is necessary, use BACK of this sheet)
Name of Plugging Contractor Slawson Drilling Company, Inc.
Address 408 120 Building, Wichita, Kansas 67202

STATE OF Kansas COUNTY OF Sedgwick
James C. Remsberg (employee of owner) or (broker/agent) of the above-described well, being first duly sworn on oath, says: That I have knowledge of the facts, statements, and matters herein contained and the log of the above-described well as filed and that the same are true and correct. So help me God.

(Signature) James C. Remsberg
Petroleum Engineer

Subscribed and Sworn to before me this 19th day of July 1974

My commission expires _____
Dolores B. Coady
STATE NOTARY PUBLIC
SEDGWICK COUNTY, KANSAS
Comm. exp. 7/1/75

Dolores B. Coady
Notary Public.

State Geological Survey
KANSAS DRILLERS LOG

IMPORTANT
Kans. Geo. Survey request
samples on this well.

API No. 15 — 101 — 20,109-0000
County Number

S. 20 T. 19 R. 28 E. W
Loc. C NW SW
County Lane

Operator
Donald C. Slawson

Address 408 One Twenty Building Wichita, Kansas 67202

Well No. #1 Lease Name Hineman "P"

Footage Location
feet from (N) (S) line feet from (E) (W) line

Principal Contractor Slawson Drilling Company, Inc. Geologist George Mueller

Spud Date June 27, 1974 Total Depth 4706' P.B.T.D.

Date Completed July 8, 1974 Oil Purchaser N/A

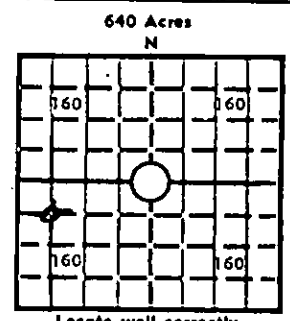

Elev.: Gr. 2786
DF 2788 KB 2791

CASING RECORD

Report of all strings set — surface, intermediate, production, etc.

Purpose of string	Size hole drilled	Size casing set (in O.D.)	Weight lbs/ft.	Setting depth	Type cement	Sacks	Type and percent additives
Surface	12 1/2"	8 5/8		258'	60/40 Poz	70sx	

LINER RECORD

PERFORATION RECORD

Top, ft.	Bottom, ft.	Sacks cement	Shots per ft.	Size & type	Depth interval

TUBING RECORD

Size	Setting depth	Packer set at

ACID, FRACTURE, SHOT, CEMENT SQUEEZE RECORD

Amount and kind of material used	Depth interval treated

INITIAL PRODUCTION

Date of first production		Producing method (flowing, pumping, gas lift, etc.)			
RATE OF PRODUCTION PER 24 HOURS		Oil	Gas	Water	Gas-oil ratio
		bbls.	MCF	bbls.	CFPB
Disposition of gas (vented, used on lease or sold)			Producing interval(s)		

INSTRUCTIONS: As provided in KCC Rule 82-2-125, within 90 days after completion of a well, one completed copy of this Drillers Log shall be transmitted to the State Geological Survey of Kansas, 4150 Monroe Street, Wichita, Kansas 67209. Copies of this form are available from the Conservation Division, State Corporation Commission, 3830 So. Meridian (P.O. Box 17027), Wichita, Kansas 66217. Phone AC 316-522-2206. If confidential custody is desired, please note Rule 82-2-125. Drillers Logs will be on open file in the Oil and Gas Division, State Geological Survey of Kansas, Lawrence, Kansas 66044.

COMPANY:

Donald C. Slawson
408 120 Building
Wichita, Kansas 67202

20-19-28W
State Geological Survey
WICHITA BRANCH

LEASE:

Hineman 'P' #1
C NW SW Sec. 20-19-28W
Lane County, Kansas

15-101-20,109

TOTAL DEPTH:

4706 feet

COMMENCED:

June 27, 1974

COMPLETED:

July 8; 1974

CONTRACTOR:

Slawson Drilling Company, Inc.

CASING:

Set 8 5/8" @ 258 feet w/170 sx

0-260	Surface Hole
260-1060	Shale & Shells
1060-2129	Shale & Shells
2129-2158	Anhydrite
2158-2215	Shale & Shells
2215-4015	Lime & Shale
4015-4550	Lime
4550-4595	Lime & Shale
4595-4676	Lime
4676-4706	Miss
4706	RTD



Operator **Donald C. Slawson** DESIGNATE TYPE OF COMP.: OIL, GAS, DRY HOLE, SWDW, ETC.: **Dry Hole**

Well No. **1** Lease Name **Hineman 'P'**

S **20** T **19S** R **28W** E W

WELL LOG

Show all important zones of porosity and contents thereof; cored intervals, and all drill-stem tests, including depth interval tested, cushion used, time tool open, flowing and shut-in pressures, and recoveries.

SHOW GEOLOGICAL MARKERS, LOGS RUN, OR OTHER DESCRIPTIVE INFORMATION.

FORMATION DESCRIPTION, CONTENTS, ETC.	TOP	BOTTOM	NAME	DEPTH
			<u>LOG TOPS</u>	
Surface Hole	0	260		
Shale & Shells	260	1060	ANH 2133 (+658)	
"	1060	2129	B/ANH 2159 (+632)	
Anhydrite	2129	2158	HEEB 3975 -1184	
Shale & Shells	2158	2215	LANS 4018 -1227	
Lime & Shale	2215	4015	STARK SH 4298 (-1507)	
Lime	4015	4550	B/KC 4381 (-1590)	
Lime & Shale	4550	4595	U/C 4543 (-1572)	
Lime	4595	4676	L/C 4575 (-1784)	
Miss	4676	4706	Basal Sd 4626 (-1835)	
RTD	4706		Miss 4658 (-1867)	
			LTD 4706	

DST #1 4193 4238, 30-45-45-60, rec 1724' MSW
 SOCTO, IFP 91-345#, IBHP 1271#, FFP 353-635#,
 FBHP 1253#: DST #2 4245-76, 30-30-30-30, rec
 20' M, IFP 9-18#, IBHP 905#, FFP 18-18#, FBHP 831#
 DST #3 4297-4321, 30-45-45-60, rec 2350' sulfur water,
 SBTO, IFP 109-634E, IBHP 1112#, FFP 652-923#, FBHP 1131#
 DST #4 4342-4366-30-30-30-30, wk bl, dtd 7", rec 20' M,
 IBHP 91#, FBHP 55#, IFP 18-18#, FFP 18-55#

USE ADDITIONAL SHEETS, IF NECESSARY, TO COMPLETE WELL RECORD.

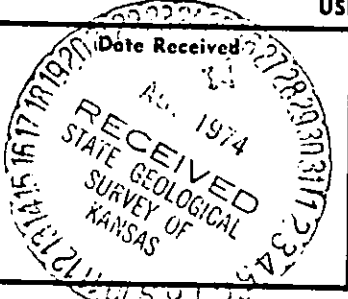

James C. Remsberg
 James C. Remsberg
 Petroleum Engineer

July 19, 1974

Title

Date