



CONFIDENTIAL

OIL & GAS CONSERVATION DIVISION
WELL COMPLETION FORM

WELL HISTORY - DESCRIPTION OF WELL & LEASE

OPERATOR: License # 34192
Name: SandRidge Exploration and Production LLC
Address 1: 123 ROBERT S. KERR AVE
Address 2:
City: OKLAHOMA CITY State: OK Zip: 73102 + 6406
Contact Person: Tiffany Golay
Phone: (405) 429-5500
CONTRACTOR: License # 34464
Name: Lariat Services, Inc.
Wellsite Geologist: Kathy Gentry
Purchaser:

Designate Type of Completion:
[ ] New Well [ ] Re-Entry [ ] Workover
[ ] Oil [ ] WSW [ ] SWD [ ] SIOW
[ ] Gas [ ] D&A [ ] ENHR [ ] SIGW
[ ] OG [ ] GSW [ ] Temp. Abd.
[ ] CM (Coal Bed Methane)
[ ] Cathodic [ ] Other (Core, Expl., etc.): LH

If Workover/Re-entry: Old Well Info as follows:
Operator:

Well Name:

Original Comp. Date: Original Total Depth:
[ ] Deepening [ ] Re-perf. [ ] Conv. to ENHR [ ] Conv. to SWD
[ ] Conv. to GSW
[ ] Plug Back: Plug Back Total Depth
[ ] Commingled Permit #:
[ ] Dual Completion Permit #:
[ ] SWD Permit #:
[ ] ENHR Permit #:
[ ] GSW Permit #:

3/16/2012 4/12/2012 4/12/2012
Spud Date or Date Reached TD Completion Date or
Recompletion Date Recompletion Date

API No. 15 - 15-033-21629-01-00

Spot Description:
N2 N2 NW NW Sec. 20 Twp. 31 S. R. 19 [ ] East [ ] West
165 Feet from [ ] North / [ ] South Line of Section
660 Feet from [ ] East / [ ] West Line of Section

Footages Calculated from Nearest Outside Section Corner:
[ ] NE [ ] NW [ ] SE [ ] SW

County: Comanche
Lease Name: Ruby Well #: 1-20H

Field Name:
Producing Formation: none

Elevation: Ground: 2175 Kelly Bushing: 2155

Total Depth: 1010 Plug Back Total Depth:

Amount of Surface Pipe Set and Cemented at: 260 Feet

Multiple Stage Cementing Collar Used? [ ] Yes [ ] No

If yes, show depth set: Feet

If Alternate II completion, cement circulated from:
feet depth to: w/ sx cmt.

Drilling Fluid Management Plan

(Data must be collected from the Reserva Pit)

Chloride content: 15700 ppm Fluid volume: 1080 bbls

Dewatering method used: Hauled to Disposal

Location of fluid disposal if hauled offsite:

Operator Name: Native American Water Services LLC

Lease Name: German 2 SWD License #: 34025

Quarter NE Sec. 28 Twp. 29 S. R. 22 [ ] East [ ] West

County: Harper, KS Permit #: 222660

AFFIDAVIT

I am the affiant and I hereby certify that all requirements of the statutes, rules and regulations promulgated to regulate the oil and gas industry have been fully complied with and the statements herein are complete and correct to the best of my knowledge.

Submitted Electronically

KCC Office Use ONLY

[ ] Letter of Confidentiality Received
Date: 05/01/2012
[ ] Confidential Release Date:
[ ] Wireline Log Received
[ ] Geologist Report Received
[ ] UIC Distribution
ALT [ ] I [ ] II [ ] III Approved by: NAOMI JAMES Date: 05/02/2012

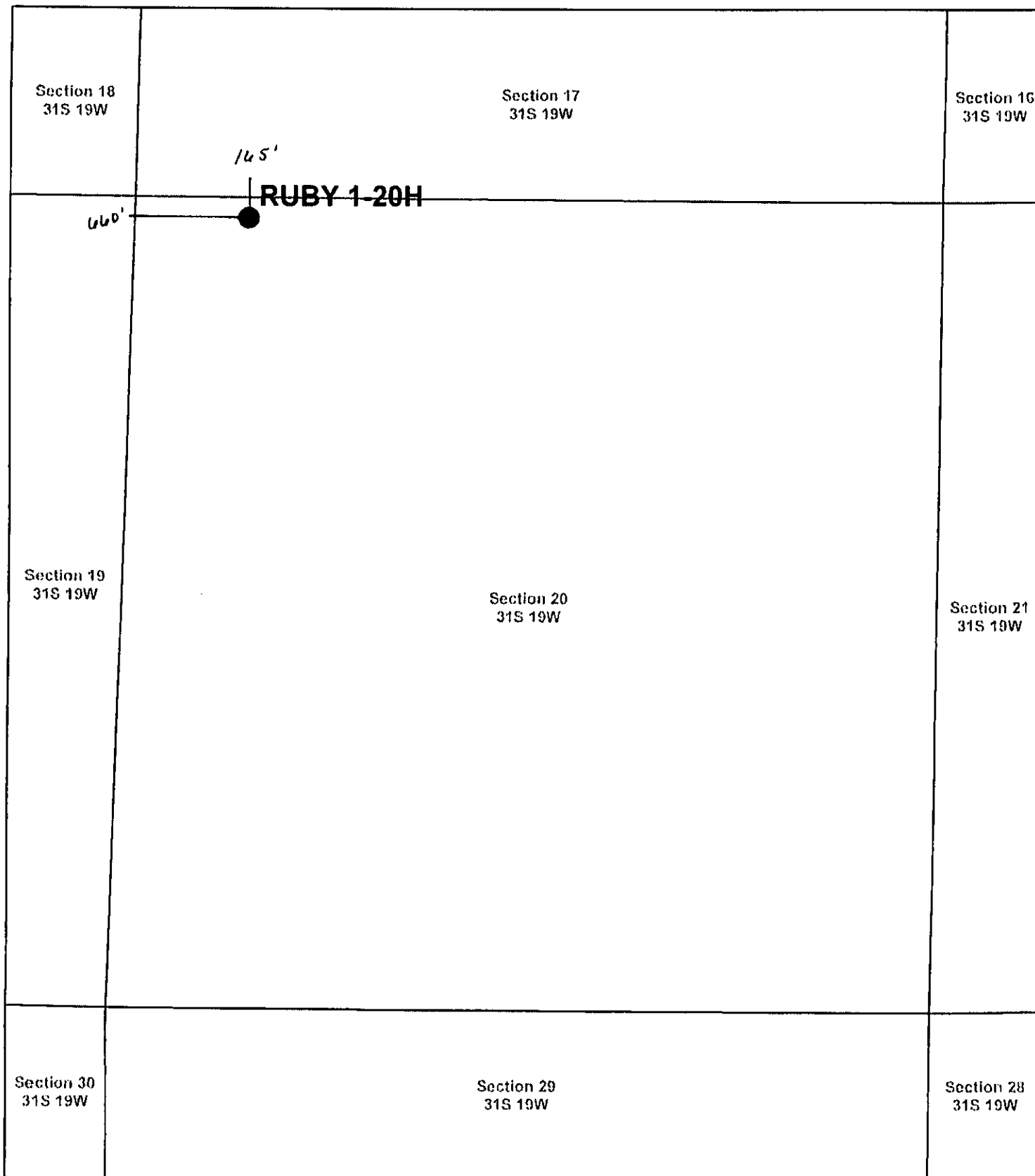

<p>● SHL</p> <p>* SandRidge Wells</p> <p>Perf</p> <p>□ Sections</p>	<p>Surface-Hole Location of Ruby 1-20H Comanche County, Kansas T&amp;R: 31S 19W Section: 20, Long/Lat: -99.416088 37.337513 1 in = 833 ft</p>		Draftsman: Aaron Birk	Draft Date: 5/1/2012
			Drawing Name/Number: Addendum_Ruby_1-20H.mxd	
			Coordinate System: NAD 1927 State Plane Kansas South FIPS: 1502	



123 Robert S. Kerr Ave.  
Oklahoma City, OK 73102

**Survey**  
**RUBY 1-20H**

Step #1 - Create a Deviation Survey Step  
#2 - Attach the survey "Description" to the Wellbore - Deviation Survey

**Wellbores - Step #2**

Actual Deviation Survey	Wellbore Name Original Hole
-------------------------	--------------------------------

**Deviation Surveys - Step #1**

Description	Date 3/30/2012	VS Dir (°)	Comment
-------------	-------------------	------------	---------

**Tie-In Data**

Azimuth North Type	Convergence (°)	Declination (°)	MD Tie In (ftKB)	Azimuth Tie In (°)	Inclination Tie In (°)	TVD Tie In (ftKB)	NS Tie In (ft)	EW Tie In (ft)
--------------------	-----------------	-----------------	------------------	--------------------	------------------------	-------------------	----------------	----------------

**Survey Data**

MD (ftKB)	Incl (°)	Azm (°)	Survey Company	Method	TVD (ftKB)	VS (ft)	NS (ft)	EW (ft)	DLS (°/100ft)
252	0.4		SandRidge Energy	Magn SS					
655	1.4		SandRidge Energy	Magn SS					
970	0.8		SandRidge Energy	Magn SS					