

FOR KCC USE:

FORM C-1 7/91

EFFECTIVE DATE: 3-19-95

State of Kansas

FORM MUST BE TYPED

DISTRICT # 4

NOTICE OF INTENTION TO DRILL

FORM MUST BE SIGNED

SGA? Yes No

Must be approved by the K.C.C. five (5) days prior to commencing well.

ALL BLANKS MUST BE FILLED

Expected Spud Date March 21 1995
month day year

Spot 140' East
NW NE SW Sec 2 Twp 16 S Rg 28 X West

OPERATOR: License # 6039
Name: L. D. DRILLING, INC.
Address: R.R. 1 BOX 183 B
City/State/Zip: GREAT BEND, KANSAS 67530
Contact Person: L. D. Davis
Phone: (316) 793-3051

2310 feet from South/North line of Section
1790 feet from East/West line of Section
IS SECTION X REGULAR IRREGULAR?

CONTRACTOR: License #: 6039
Name: L. D. DRILLING, INC.

(NOTE: Locate well on the Section Plat on Reverse Side)

County: LANE

Lease Name: MARVIN ROBERTS Well #: 1

Field Name:

Is this a Prorated/Spaced Field? yes X no

Target Formation(s): Mississippian

Nearest lease or unit boundary: 330'

Ground Surface Elevation: 2984' feet MSL

Water well within one-quarter mile: yes X no

Public water supply well within one mile: yes X no

Depth to bottom of fresh water: 740' 180'

Depth to bottom of usable water: 1280'

Surface Pipe by Alternate: 1 X 2

Length of Surface Pipe Planned to be set: 245'

Length of Conductor pipe required: none

Projected Total Depth: 4600'

Formation at Total Depth: Mississippian

Water Source for Drilling Operations:

well X farm pond other

Well Drilled For: Well Class: Type Equipment:
Oil Enh Rec Infield Mud Rotary
Gas Storage Pool Ext Air Rotary
OAWO Disposal Wildcat Cable
Seismic # of Holes Other
Other
If OAWO: old well information as follows:
Operator:
Well Name:
Comp. Date: Old Total Depth

Directional, Deviated or Horizontal wellbore? yes X no
If yes, true vertical depth:
Bottom Hole Location:

Will Cores Be Taken? yes X no
If yes, proposed zone:

AFFIDAVIT

The undersigned hereby affirms that the drilling, completion and eventual plugging of this well will comply with K.S.A. 55-101, et. seq.

It is agreed that the following minimum requirements will be met:

- 1. Notify the appropriate district office prior to spudding of well;
2. A copy of the approved notice of intent to drill shall be posted on each drilling rig;
3. The minimum amount of surface pipe as specified below shall be set by circulating cement to the top; in all cases surface pipe shall be set through all unconsolidated materials plus a minimum of 20 feet into the underlying formation;
4. If the well is dry hole, an agreement between the operator and the district office on plug length and placement is necessary prior to plugging;
5. The appropriate district office will be notified before well is either plugged or production casing is cemented in;
6. IF AN ALTERNATE IS COMPLETION, PRODUCTION PIPE SHALL BE CEMENTED FROM BELOW ANY USABLE WATER TO SURFACE WITHIN 120 DAYS OF SPUD DATE. IN ALL CASES, NOTIFY DISTRICT OFFICE PRIOR TO ANY CEMENTING.

I hereby certify that the statements made herein are true and to the best of my knowledge and belief.

Date: 3-14-95 Signature of Operator or Agent: L. D. Davis Title: President

FOR KCC USE:
API # 15- 701-216990000
Conductor pipe required NONE feet
Minimum surface pipe required 200 feet per Alt. X2
Approved by: DPW 3-14-95
This authorization expires: 9-14-95
(THIS authorization void if drilling not started within 6 months of effective date.)
Spud date: Agent:

REMEMBER TO:

- File Drill Pit Application (form COP-1) with Intent to Drill;
- File Completion Form ACD-1 within 120 days of spud date;
- File acreage attribution plat according to field proration orders;
- Notify appropriate district office 48 hours prior to workover or re-entry;
- Submit plugging report (CP-4) after plugging is completed;
- Obtain written approval before disposing or injecting salt water.

Mail to: KCC - Conservation Division, 130 S. Market - Room 2078, Wichita, Kansas 67202.

RECEIVED
KANSAS CORPORATION COMMISSION

MAR 14 1995

CONSERVATION DIVISION
WICHITA, KS

Handwritten notes and initials on the right margin.

**IN ALL CASES PLOT THE INTENDED WELL ON THE PLAT BELOW**

**PLAT OF ACREAGE ATTRIBUTABLE TO A WELL IN A PRORATED OR SPACED FIELD**

If the intended well is in a prorated or spaced field, please fully complete this side of the form. If the intended well is in a prorated or spaced field complete the plat below showing that the well will be properly located in relationship to other wells producing from the common source of supply. Please show all the wells within 1 mile of the boundaries of the proposed acreage attribution unit for gas wells and within 1/2 mile of the boundaries of the proposed acreage attribution unit for oil wells.

API NO. 15- \_\_\_\_\_  
 OPERATOR \_\_\_\_\_  
 LEASE \_\_\_\_\_  
 WELL NUMBER \_\_\_\_\_  
 FIELD \_\_\_\_\_

LOCATION OF WELL: COUNTY \_\_\_\_\_ LANE \_\_\_\_\_  
 2310 feet from south/north line of section  
 1790 feet from east/west line of section  
 SECTION 2 TWP \_\_\_\_\_ 16S RG \_\_\_\_\_ 28W

NUMBER OF ACRES ATTRIBUTABLE TO WELL 10  
 OTR/OTR/OTR OF ACREAGE NW - NE - SW

IS SECTION X REGULAR or \_\_\_\_\_ IRREGULAR  
IF SECTION IS IRREGULAR, LOCATE WELL FROM NEAREST CORNER BOUNDARY.

Section corner used: \_\_\_\_\_ NE \_\_\_\_\_ NW \_\_\_\_\_ SE \_\_\_\_\_ SW  
PLAT

(Show location of the well and shade attributable acreage for prorated or spaced wells.)  
 (Show footage to the nearest lease or unit boundary line.)

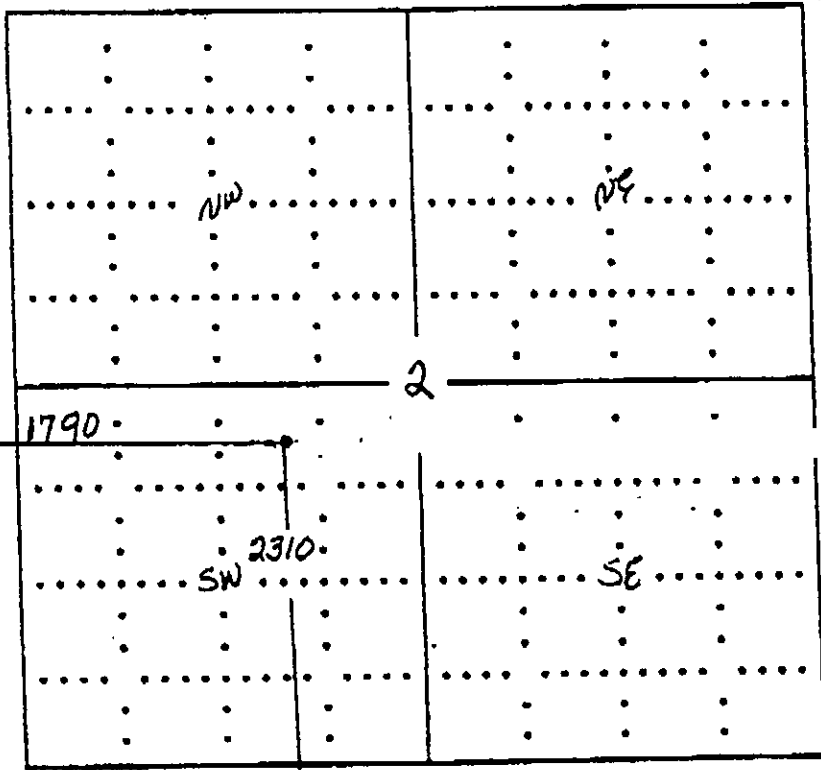

**RECEIVED**  
 KANSAS CORPORATION COMMISSION

MAR 14 1995

CONSERVATION DIVISION  
 WICHITA, KS

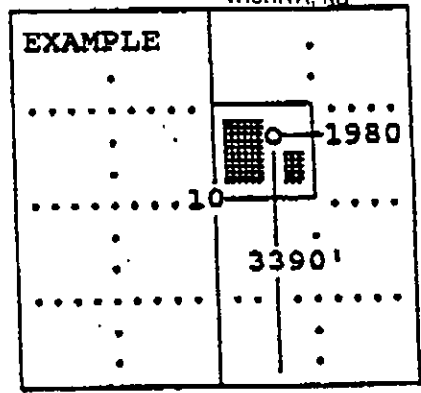

SEWARD CO.

In plotting the proposed location of the well, you must show:

- 1) The manner in which you are using the depicted plat by identifying section lines, i.e. 1 section, 1 section with 8 surrounding sections, 4 sections, etc.;
- 2) the distance of the proposed drilling location from the section's south/north or east/west; and
- 3) the distance to the nearest lease or unit boundary line.