

EFFECTIVE DATE: 4-9-96

DISTRICT # 1

SEA7... Yes... No

State of Kansas

NOTICE OF INTENTION TO DRILL

Must be approved by the K.C.C. five (5) days prior to commencing well

Expected Spud Date April 10 1996 \* Spot Approx. SE NE SW Sec 16 Twp 18 S Rg 27W East West

OPERATOR: License # 4767 Name: Ritchie Exploration, Inc. Address: 125 N. Market, Suite 1000 City/State/Zip: Wichita, KS 67202 Contact Person: Lisa Thimmesch Phone: (316) 267-4375

CONTRACTOR: License # 5420 Name: White & Ellis Drilling

Well Drilled For: Well Class: Type Equipment: X Oil Enh Rec Infield Mud Rotary Gas Storage Pool Ext Air Rotary OWD Disposal Wildcat Cable Seismic: # of Holes Other If OWD: old well information as follows: Operator: Well Name: Comp. Date: Old Total Depth

\* 1560 feet from South/North line of Section \* 2268 feet from East/West line of Section IS SECTION REGULAR X IRREGULAR (NOTE: Locate well on the Section Plat on Reverse Side) County: Lane Lease Name: Lena Speer Well #: 1 Field Name: Wildcat Is this a Prorated/Spaced Field? yes X no Target Formation(s): L/KC Nearest lease or unit boundary: 362 WAS 230 Ground Surface Elevation: 2694 feet MSL Water well within one-quarter mile: yes X no Public water supply well within one mile: yes X no Depth to bottom of fresh water: 200 Depth to bottom of usable water: 1000 Surface Pipe by Alternate: 1 X 2 Length of Surface Pipe Planned to be set: 200 320 Length of Conductor pipe required: none Projected Total Depth: 468.0 Formation at Total Depth: Miss Water Source for Drilling Operations: well farm pond X other

Directional, Deviated or Horizontal wellbore? yes X no If yes, true vertical depth: Bottom Hole Location:

AFFIDAVIT

The undersigned hereby affirms that the drilling, completion and eventual plugging of this well will comply with K.S.A. 55-101, et. seq.

It is agreed that the following minimum requirements will be met:

- 1. Notify the appropriate district office prior to spudding of well;
2. A copy of the approved notice of intent to drill shall be posted on each drilling rig;
3. The minimum amount of surface pipe as specified below shall be set by circulating cement to the top; in all cases surface pipe shall be set through all unconsolidated materials plus a minimum of 20 feet into the underlying formation;
4. If the well is dry hole, an agreement between the operator and the district office on plug length and placement is necessary prior to plugging;
5. The appropriate district office will be notified before well is either plugged or production casing is cemented in;
6. IF AN ALTERNATE II COMPLETION, PRODUCTION PIPE SHALL BE CEMENTED FROM BELOW ANY USABLE WATER TO SURFACE WITHIN 120 DAYS OF SPUD DATE. IN ALL CASES, NOTIFY DISTRICT OFFICE PRIOR TO ANY CEMENTING.

I hereby certify that the statements made herein are true and to the best of my knowledge and belief.

Date: 4-3-96 Signature of Operator or Agent: Title: Geologist

FOR KCC USE: API # 15- 101-217180000 Conductor pipe required NONE feet Minimum surface pipe required 220 feet per Alt. X (2) Approved by: JK 4-4-96 This authorization expires: 10-4-96 (This authorization void if drilling not started within 6 months of effective date.) Spud date: Agent:

REMEMBER TO:

- File Drill Pit Application (form CDP-1) with Intent to Drill;
- File Completion Form ACO-1 within 120 days of spud date;
- File acreage attribution plat according to field proration orders;
- Notify appropriate district office 48 hours prior to workover or re-entry;
- Submit plugging report (CP-4) after plugging is completed;
- Obtain written approval before disposing or injecting salt water.

Mail to: Conservation Division, 200 Colorado Derby Building, 202 W. First St., Wichita, Kansas 67202-1286.

MAILED

APR 04 1996 04-04-1996

16 18 27W

FOR KCC USE:

FORM C-1 7/91

FORM MUST BE TYPED

EFFECTIVE DATE: 4-9-96

FORM MUST BE SIGNED

DISTRICT # 1

State of Kansas  
NOTICE OF INTENTION TO DRILL

ALL BLANKS MUST BE FILLED

SEA? Yes No

Must be approved by the K.C.C. five (5) days prior to commencing well

Expected Spud Date April 10 96  
month day year

Spot SE NE SW Sec 16 Twp 18 S Rg 27W East West

OPERATOR: License # 4767  
Name: Ritchie Exploration, Inc.  
Address: 125 N. Market, Suite 1000  
City/State/Zip: Wichita, KS 67202  
Contact Person: Lisa Thimmesch  
Phone: (316) 267-4375

1650 560 feet from South North line of Section  
2970 2568 feet from East West line of Section  
IS SECTION X REGULAR IRREGULAR?

CONTRACTOR: License #: 5420  
Name: White & Ellis Drilling

(NOTE: Locate well on the Section Plat on Reverse Side)  
County: Lane  
Lease Name: Lena Speer Well #: 1  
Field Name: Wildcat  
Is this a Prorated/Spaced Field? yes X no  
Target Formation(s): L/KC  
Nearest lease or unit boundary: 330  
Ground Surface Elevation: 2694 est feet MSL  
Water well within one-quarter mile: yes X no  
Public water supply well within one mile: yes X no  
Depth to bottom of fresh water: 200  
Depth to bottom of usable water: 1000  
Surface Pipe by Alternate: 1 X 2  
Length of Surface Pipe Planned to be set: 200 280  
Length of Conductor pipe required: none  
Projected Total Depth: 4580  
Formation at Total Depth: Miss  
Water Source for Drilling Operations:  
well farm pond X other  
DWR Permit #:   
Will Cores Be Taken?: yes X no  
If yes, proposed zone:   
CORRECTION 4-12-96

Well Drilled For: Well Class: Type Equipment:  
X Oil Enh Rec Infield Mud Rotary  
Gas Storage Pool Ext. Air Rotary  
OWWO Disposal Wildcat Cable  
Seismic: # of Holes Other  
If OWWO: old well information as follows:  
Operator:  
Well Name:  
Comp. Date: Old Total Depth

Directional, Deviated or Horizontal wellbore? yes X no  
If yes, true vertical depth:  
Bottom Hole Location:

AFFIDAVIT

The undersigned hereby affirms that the drilling, completion and eventual plugging of this well will comply with K.S.A. 55-101, et. seq.

It is agreed that the following minimum requirements will be met:

- 1. Notify the appropriate district office prior to spudding of well;
- 2. A copy of the approved notice of intent to drill shall be posted on each drilling rig;
- 3. The minimum amount of surface pipe as specified below shall be set by circulating cement to the top; in all cases surface pipe shall be set through all unconsolidated materials plus a minimum of 20 feet into the underlying formation;
- 4. If the well is dry hole, an agreement between the operator and the district office on plug length and placement is necessary prior to plugging;
- 5. The appropriate district office will be notified before well is either plugged or production casing is cemented in;
- 6. IF AN ALTERNATE II COMPLETION, PRODUCTION PIPE SHALL BE CEMENTED FROM BELOW ANY USABLE WATER TO SURFACE WITHIN 120 DAYS OF SPUD DATE. IN ALL CASES, NOTIFY DISTRICT OFFICE PRIOR TO ANY CEMENTING.

I hereby certify that the statements made herein are true and to the best of my knowledge and belief.

Date: 4-3-96 Signature of Operator or Agent: Rocky Milford Title: Geologist

FOR KCC USE:  
API # 15- 101-217180000  
Conductor pipe required NONE feet  
Minimum surface pipe required 220 feet per Alt. X 2  
Approved by: JK 4-4-96  
This authorization expires: 10-4-96  
(This authorization void if drilling not started within 6 months of effective date.)  
Spud date: Agent:

REMEMBER TO:

- File Drill Pit Application (form CDP-1) with Intent to Drill;
- File Completion Form ACO-1 within 120 days of spud date;
- File acreage attribution plat according to field proration orders;
- Notify appropriate district office 48 hours prior to workover or re-entry;
- Submit plugging report (CP-4) after plugging is completed;
- Obtain written approval before disposing or injecting salt water.

Mail to: Conservation Division, 200 Colorado Derby Building, 202 W. First St., Wichita, Kansas 67202-1286.

16  
18  
270

IN ALL CASES PLOT THE INTENDED WELL ON THE PLAT BELOW

PLAT OF ACREAGE ATTRIBUTABLE TO A WELL IN A PRORATED OR SPACED FIELD

If the intended well is in a prorated or spaced field, please fully complete this side of the form. If the intended well is in a prorated or spaced field complete the plat below showing that the well will be properly located in relationship to other wells producing from the common source of supply. Please show all the wells within 1 mile of the boundaries of the proposed acreage attribution unit for gas wells and within 1/2 mile of the boundaries of the proposed acreage attribution unit for oil wells.

API NO. 15- \_\_\_\_\_  
 OPERATOR \_\_\_\_\_ LOCATION OF WELL: COUNTY \_\_\_\_\_  
 LEASE \_\_\_\_\_ feet from south/north line of section  
 WELL NUMBER \_\_\_\_\_ feet from east/west line of section  
 FIELD \_\_\_\_\_ SECTION \_\_\_\_\_ TWP \_\_\_\_\_ RG \_\_\_\_\_

NUMBER OF ACRES ATTRIBUTABLE TO WELL \_\_\_\_\_ IS SECTION \_\_\_\_\_ REGULAR or \_\_\_\_\_ IRREGULAR  
 QTR/QTR/QTR OF ACREAGE \_\_\_\_\_ IF SECTION IS IRREGULAR, LOCATE WELL FROM NEAREST  
 CORNER BOUNDARY.

Section corner used: \_\_\_\_\_ NE \_\_\_\_\_ NW \_\_\_\_\_ SE \_\_\_\_\_ SW

**PLAT**

(Show location of the well and shade attributable acreage for prorated or spaced wells.)  
 (Show footage to the nearest lease or unit boundary line.)

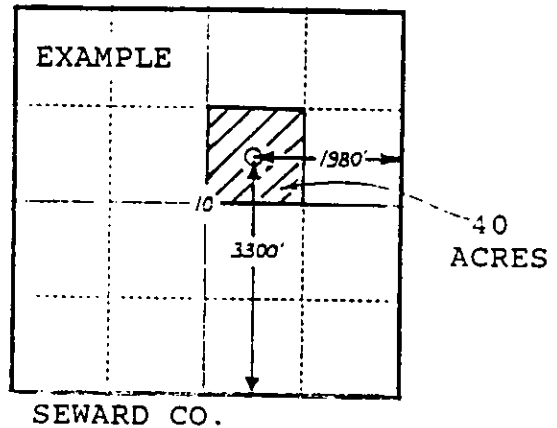
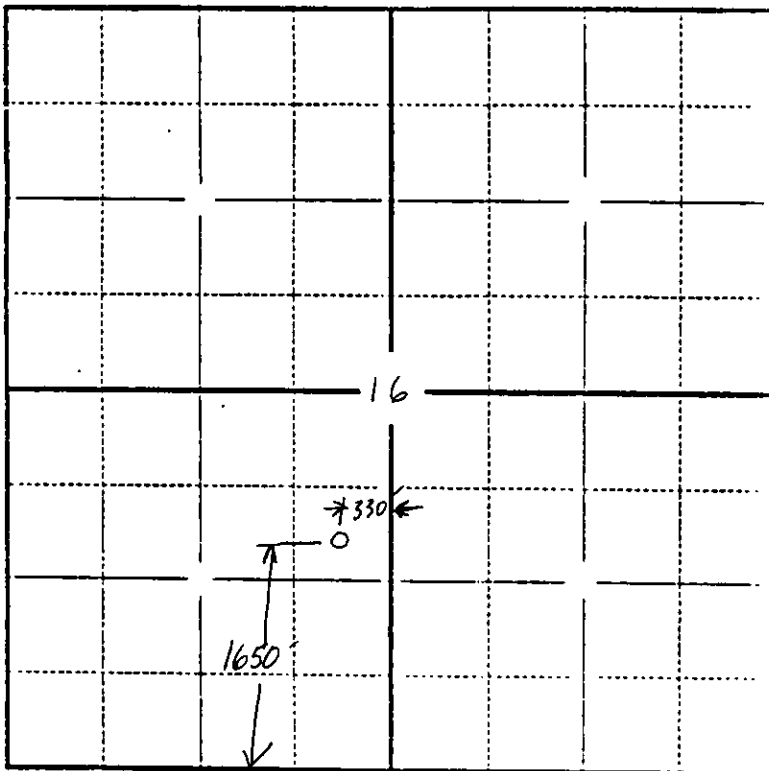

In plotting the proposed location of the well, you must show:

- 1) The manner in which you are using the depicted plat by identifying section lines, i.e. 1 section, 1 section with 8 surrounding sections, 4 sections, etc.;
- 2) the distance of the proposed drilling location from the section's south/north and east/west lines; and
- 3) the distance to the nearest lease or unit boundary line.