

FOR KCC USE:

FORM C-1 7/91

EFFECTIVE DATE: 12-17-94

State of Kansas

FORM MUST BE TYPED

FORM MUST BE SIGNED

ALL BLANKS MUST BE FILLED

DISTRICT #

NOTICE OF INTENTION TO DRILL

SGA? Yes No

Must be approved by the K.C.C. five (5) days prior to commencing well

Expected Spud Date 12 - 19 - 94
month day year

Spot NW - NE - NW Sec .8 Twp 17S S, Rg 27 East West

OPERATOR: License # 5123
Name: Pickrell Drilling Company, Inc.
Address: 110 N. Market, Suite 205
City/State/Zip: Wichita, Kansas 67202
Contact Person: Kent G. Crisler
Phone: 316-262-8427

4950 feet from South / North line of Section
3630 feet from East / West line of Section
IS SECTION REGULAR IRREGULAR?

CONTRACTOR: License #: 5123
Name: Company Tools

(NOTE: Locate well on the Section Plat on Reverse Side)
County: Lane

Lease Name: Johnson, "J1" Well #: 1
Field Name: Pendennis SW

Well Drilled For: Well Class: Type Equipment:
 Oil Enh Rec Infield Mud Rotary
 Gas Storage Pool Ext Air Rotary
 OMO Disposal Wildcat Cable
 Seismic; # of Holes Other

Is this a Prorated/Spaced Field? yes no

Target Formation(s): L/KC + Marm + Cherokee

Nearest lease or unit boundary: 330'

Ground Surface Elevation: 2705' feet MSL

Water well within one-quarter mile: yes no

Public water supply well within one mile: yes no

Depth to bottom of fresh water: 200' 210'

Depth to bottom of usable water: 200' 1300'

Surface Pipe by Alternate: 1 2

Length of Surface Pipe Planned to be set: (250' +) 230'

Length of Conductor pipe required: None

Projected Total Depth: 4600'

Formation at Total Depth: Mississippian

Water Source for Drilling Operations:

well farm pond other

DWR Permit #: _____

Will Cores Be Taken? yes no

If yes, proposed zone: _____

If OMO: old well information as follows:
Operator: _____
Well Name: _____
Comp. Date: _____ Old Total Depth _____

Directional, Deviated or Horizontal wellbore? yes no

If yes, true vertical depth: _____

Bottom Hole Location: _____

AFFIDAVIT

The undersigned hereby affirms that the drilling, completion and eventual plugging of this well will comply with K.S.A. 55-101, et. seq.

It is agreed that the following minimum requirements will be met:

- 1. Notify the appropriate district office prior to spudding of well;
- 2. A copy of the approved notice of intent to drill shall be posted on each drilling rig;
- 3. The minimum amount of surface pipe as specified below shall be set by circulating cement to the top; in all cases surface pipe shall be set through all unconsolidated materials plus a minimum of 20 feet into the underlying formation;
- 4. If the well is dry hole, an agreement between the operator and the district office on plug length and placement is necessary prior to plugging;
- 5. The appropriate district office will be notified before well is either plugged or production casing is cemented in;
- 6. IF AN ALTERNATE II COMPLETION, PRODUCTION PIPE SHALL BE CEMENTED FROM BELOW ANY USABLE WATER TO SURFACE WITHIN 120 DAYS OF SPUD DATE. IN ALL CASES, NOTIFY DISTRICT OFFICE PRIOR TO ANY CEMENTING.

I hereby certify that the statements made herein are true and to the best of my knowledge and belief.

Date: 12-05-94 Signature of Operator or Agent: Kent Crisler Title: Geologist

FOR KCC USE:
API # 15- 101-21692-00-00
Conductor pipe required 7100 feet
Minimum surface pipe required 230' feet per Alt.
Approved by: CB 12/12/94
This authorization expires: 6/12/95
(This authorization void if drilling not started within 6 months of effective date.)
Spud date: _____ Agent: _____

REMEMBER TO:

- File Drill Pit Application (form CDP-1) with Intent to Drill;
- File Completion Form ACO-1 within 120 days of spud date;
- File acreage attribution plat according to field proration orders;
- Notify appropriate district office 48 hours prior to workover or re-entry;
- Submit plugging report (CP-4) after plugging is completed;
- Obtain written approval before disposing or injecting salt water.

Mail to: Conservation Division, 200 Colorado Derby Building, 202 W. First St., Wichita, Kansas 67202-1286.

STATE RECEIVED
CORPORATION DIVISION
DEC 27 1994
CONSERVATION DIVISION
WICHITA, KANSAS

8-17-27

IN ALL CASES PLOT THE INTENDED WELL ON THE PLAT BELOW

PLAT OF ACREAGE ATTRIBUTABLE TO A WELL IN A PRORATED OR SPACED FIELD

If the intended well is in a prorated or spaced field, please fully complete this side of the form. If the intended well is in a prorated or spaced field complete the plat below showing that the well will be properly located in relationship to other wells producing from the common source of supply. Please show all the wells within 1 mile of the boundaries of the proposed acreage attribution unit for gas wells and within 1/2 mile of the boundaries of the proposed acreage attribution unit for oil wells.

API NO. 15- _____
 OPERATOR Pickrell Drilling Co. Inc.
 LEASE Johnson "JJ"
 WELL NUMBER 1
 FIELD Pendennis SW

LOCATION OF WELL: COUNTY Lane
4950 feet from south north line of section
3630 feet from east west line of section
 SECTION 8 TWP 17S RG 27W

NUMBER OF ACRES ATTRIBUTABLE TO WELL 40
 QTR/QTR/QTR OF ACREAGE _____

IS SECTION X REGULAR or _____ IRREGULAR
 IF SECTION IS IRREGULAR, LOCATE WELL FROM NEAREST CORNER BOUNDARY.

Section corner used: _____ NE _____ NW X SE _____ SW

PLAT

(Show location of the well and shade attributable acreage for prorated or spaced wells.)
 (Show footage to the nearest lease or unit boundary line.)

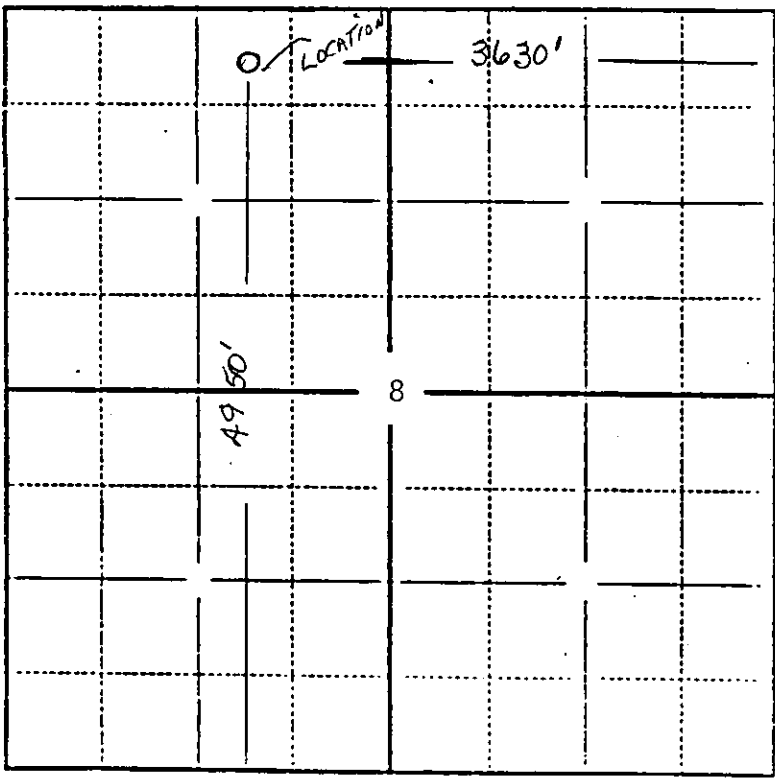

ONE SECTION

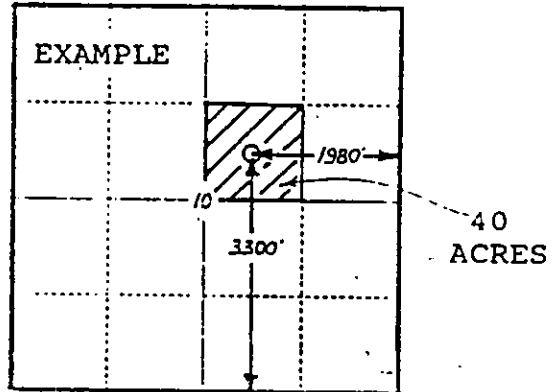

SEWARD CO.

In plotting the proposed location of the well, you must show:

- 1) The manner in which you are using the depicted plat by identifying section lines, i.e. 1 section, 1 section with 8 surrounding sections, 4 sections, etc.;
- 2) the distance of the proposed drilling location from the section's south/north and east/west lines; and
- 3) the distance to the nearest lease or unit boundary line.