

EFFECTIVE DATE: 2-17-91

FORM MUST BE TYPED  
FORM C-1 4/90

State of Kansas  
NOTICE OF INTENTION TO DRILL

P.U.

FORM MUST BE SIGNED  
ALL BLANKS MUST BE FILLED

Must be approved by the K.C.C. five (5) days prior to commencing well

Expected Spud Date 7 month 17 day 91 year Apr. W/2 W/2 NE. Sec 7 Twp 17 S, Rg 30 X East West ✓

OPERATOR: License # 5151  
Name: Gear Petroleum Co., Inc.  
Address: 125 N. Market, Suite 1075  
City/State/Zip: Wichita, KS 67202-1710  
Contact Person: Jim Thatcher  
Phone: (316) 265-3351

3810 feet from South line of Section  
2280 feet from East line of Section  
(Note: Locate well on Section Plat on Reverse Side)

CONTRACTOR: License # 5418  
Name: Allen Drilling Co.

County: Lane  
Lease Name: Bonnie Well #: 1  
Field Name: UNNAMED  
Is this a Prorated Field? yes X. no  
Target Formation(s): MISSISSIPPI  
Nearest lease or unit boundary: 330  
Ground Surface Elevation: 2889 feet MSL ✓  
Domestic well within 330 feet: X yes no  
Municipal well within one mile: yes X. no  
Depth to bottom of fresh water: 180  
Depth to bottom of usable water: 1540  
Surface Pipe by Alternate: 1 X. 2  
Length of Surface Pipe Planned to be set: 360  
Length of Conductor pipe required: 0  
Projected Total Depth: 4600  
Formation at Total Depth: Mississippi  
Water Source for Drilling Operations:  
well farm pond X. other  
DWR Permit #: \_\_\_\_\_  
Will Cores Be Taken?: yes X. no  
If yes, proposed zone: \_\_\_\_\_

Well Drilled For: Well Class: Type Equipment:  
X Oil no Inj no Infield X Mud Rotary ✓  
no Gas no Storage no Pool Ext. no Air Rotary ✓  
no OWMO no Disposal X Wildcat no Cable  
no Seismic; no # of Holes

If OWMO: old well information as follows:  
Operator: \_\_\_\_\_  
Well Name: \_\_\_\_\_  
Comp. Date: \_\_\_\_\_ Old Total Depth \_\_\_\_\_

Directional, Deviated or Horizontal wellbore? no yes X. no  
If yes, total depth location: \_\_\_\_\_

AFFIDAVIT

The undersigned hereby affirms that the drilling, completion and eventual plugging of this well will comply with K.S.A. 55-101, et. seq.

It is agreed that the following minimum requirements will be met:

- 1. The appropriate district office shall be notified before setting surface pipe;
- 2. The minimum amount of surface pipe as specified above shall be set by circulating cement to the top; in all cases surface pipe shall be set through all unconsolidated materials plus a minimum of 20 feet into the underlying formation;
- 3. If the well is dry, a plugging proposal shall be submitted to the district office. An agreement between the operator and the district office on plug length and placement is necessary prior to plugging;
- 4. The appropriate district office will be notified before well is either plugged or production casing is cemented in;
- 5. If an Alternate II completion, production pipe shall be cemented from below any usable water to surface within 120 days of spud date. In all cases, notify district office prior to any cementing.

I hereby certify that the statements made herein are true and to the best of my knowledge and belief.

Date: 7/11/91 Signature of Operator or Agent: [Signature] Title: Mgr. Drilling & Prod.

FOR KCC USE:  
API # 15- 101-21 594-00-00  
Conductor pipe required None feet  
Minimum surface pipe required 200 feet per Alt. • ②  
Approved by: [Signature]  
EFFECTIVE DATE: 1-17-91  
This authorization expires: 1-12-92  
(This authorization void if drilling not started within 6 months of effective date.)  
Spud date: \_\_\_\_\_ Agent: \_\_\_\_\_

LAND CONSERVATION COMMISSION  
JUL 11 1991  
CONSERVATION DIVISION  
Wichita, Kansas

2-17-300

REMEMBER TO:

- File Drill Pit Application (form CDP-1) with Intent to Drill;
- File Completion Form ACO-1 within 120 days of spud date;
- File acreage attribution plat according to field proration orders;
- Notify appropriate district office 48 hours prior to workover or re-entry;
- Submit plugging report (CP-4) after plugging is completed;
- Obtain written approval before disposing or injecting salt water.

**PLAT OF ACREAGE ATTRIBUTABLE TO A WELL**

State Corporation Commission, Conservation Division  
200 Colorado Derby Bldg. Wichita, Kansas 67202

OPERATOR <u>Gear Petroleum Co., Inc.</u>	LOCATION OF WELL:
LEASE <u>Bonnie</u>	<u>3810</u> feet north of SE corner
WELL NUMBER <u>1</u>	<u>2280</u> feet west of SE corner
FIELD <u>wildcat</u>	<u>NE</u> Sec. <u>7</u> T <u>17S</u> R <u>30</u> <del>E/W</del>
	COUNTY <u>Lane</u>
NO. OF ACRES ATTRIBUTABLE TO WELL <u>40</u>	IS SECTION <u>X</u> REGULAR <u>   </u> IRREGULAR?
	IF IRREGULAR, LOCATE WELL FROM NEAREST
DESCRIPTION OF ACREAGE <u>N/2 SW NE</u>	CORNER BOUNDARY.
<u>S/2 NW NE</u>	

NOTE: If plat depicted is insufficient for your circumstances, you may attach your own scaled or surveyed plat.

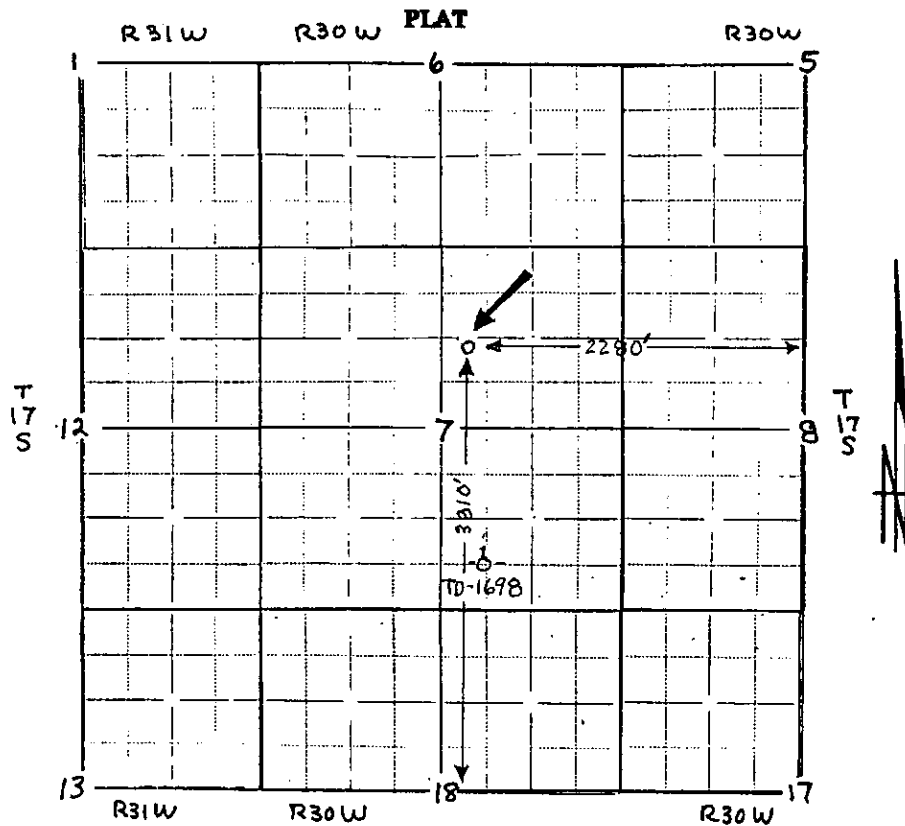

In plotting the proposed location of the well, you must show:

- 1) The manner in which you are using the depicted plat by identifying section lines, i.e. 1 section, 1 section with 8 surrounding partial sections, 4 sections, 16 sections, etc.;
- 2) the well's location relative to the location of other wells producing from the same common source of supply in adjoining drilling units, pursuant to K.A.R. 82-3-108, 82-3-207, 82-3-312, or special orders of the Commission;
- 3) the distance of the proposed drilling location from the section's east and south lines; and
- 4) the distance to the nearest lease or unit boundary line.

I hereby certify that the statements made herein are true and to the best of my knowledge and belief.

Signature of Operator or Agent *[Signature]*

Date 7/11/91 Title MAN DRILLING OPER