

FOR KCC USE:

EFFECTIVE DATE: 3-19-97  
DISTRICT #  
SEAT Yes  No

State of Kansas  
NOTICE OF INTENTION TO DRILL

FORM C-1 7/91  
FORM MUST BE TYPED  
FORM MUST BE SIGNED  
ALL BLANKS MUST BE FILLED

Must be approved by the K.C.C. five (5) days prior to commencing well

Expected Spud Date April 1, 1997 200's & 80' W. OF C. SE Sec 13. Twp 17S. Rg 30. East  
month day year Spot

OPERATOR: License # 5046  
Name: Raymond Oil Company, Inc.  
Address: P. O. Box 48788  
City/State/Zip: Wichita, Kansas 67201-8788  
Contact Person: Wm. S. Raymond  
Phone: 316-267-4214

CONTRACTOR: License #: 30606  
Name: Murfin Drilling Company, Inc.

Well Drilled For: Well Class: Type Equipment:  
Oil Enh Rec Infield Mud Rotary  
Gas Storage Pool Ext. Air Rotary  
OUWO Disposal Wildcat Cable  
Seismic: # of Holes Other  
If OUWO: old well information as follows:  
Operator:  
Well Name:  
Comp. Date: Old Total Depth

1120' feet from South line of Section  
1400' feet from East line of Section  
IS SECTION  REGULAR  IRREGULAR?  
(NOTE: Locate well on the Section Plat on Reverse Side)  
County: Lane  
Lease Name: Grusing Well #: 1  
Field Name: Wildcat  
Is this a Prorated/Spaced Field? yes  no  
Target Formation(s): Lansing Kansas City/Marmaton  
Nearest lease or unit boundary: 1120'  
Ground Surface Elevation: 2837' feet MSL  
Water well within one-quarter mile: yes  no  
Public water supply well within one mile: yes  no  
Depth to bottom of fresh water: 180'  
Depth to bottom of usable water: 1200'  
Surface Pipe by Alternate: 1  2  
Length of Surface Pipe Planned to be set: 250'  
Length of Conductor pipe required: None  
Projected Total Depth: 4600'  
Formation at Total Depth: Mississippian  
Water Source for Drilling Operations:  
... well ... farm pond ... other   
DWR Permit #: Contractor to file permit  
Will Cores Be Taken?: yes  no  
If yes, proposed zone:

Directional, Deviated or Horizontal wellbore? yes  no  
If yes, true vertical depth:  
Bottom Hole Location:

AFFIDAVIT

The undersigned hereby affirms that the drilling, completion and eventual plugging of this well will comply with K.S.A. 55-101, et. seq.  
It is agreed that the following minimum requirements will be met:

1. Notify the appropriate district office prior to spudding of well;
2. A copy of the approved notice of intent to drill shall be posted on each drilling rig;
3. The minimum amount of surface pipe as specified below shall be set by circulating cement to the top; in all cases surface pipe shall be set through all unconsolidated materials plus a minimum of 20 feet into the underlying formation;
4. If the well is dry hole, an agreement between the operator and the district office on plug length and placement is necessary prior to plugging;
5. The appropriate district office will be notified before well is either plugged or production casing is cemented in;
6. IF AN ALTERNATE II COMPLETION, PRODUCTION PIPE SHALL BE CEMENTED FROM BELOW ANY USABLE WATER TO SURFACE WITHIN 120 DAYS OF SPUD DATE. IN ALL CASES, NOTIFY DISTRICT OFFICE PRIOR TO ANY CEMENTING.

I hereby certify that the statements made herein are true and to the best of my knowledge and belief.  
Date: 3-13-97 Signature of Operator or Agent: Wm. S. Raymond Title: President

FOR KCC USE:  
API # 15- 101-217360000  
Conductor pipe required NONE feet  
Minimum surface pipe required 200' feet per Alt. X(2)  
Approved by: 3-14-97  
This authorization expires: 9-14-97  
(This authorization void if drilling not started within 6 months of effective date.)  
Spud date: Agent:

REMEMBER TO:

- File Drill Pit Application (form CDP-1) with Intent to Drill;
- File Completion Form ACO-1 within 120 days of spud date;
- File acreage attribution plat according to field proration orders;
- Notify appropriate district office 48 hours prior to workover or re-entry;
- Submit plugging report (CP-4) after plugging is completed;
- Obtain written approval before disposing or injecting salt water.

Mail to: Conservation Division, 200 Colorado Derby Building, 202 W. First St., Wichita, Kansas 67202-1286.

13  
17  
3000

IN ALL CASES PLOT THE INTENDED WELL ON THE PLAT BELOW

PLAT OF ACREAGE ATTRIBUTABLE TO A WELL IN A PRORATED OR SPACED FIELD

If the intended well is in a prorated or spaced field, please fully complete this side of the form. If the intended well is in a prorated or spaced field complete the plat below showing that the well will be properly located in relationship to other wells producing from the common source of supply. Please show all the wells within 1 mile of the boundaries of the proposed acreage attribution unit for gas wells and within 1/2 mile of the boundaries of the proposed acreage attribution unit for oil wells.

API NO. 15- \_\_\_\_\_  
 OPERATOR \_\_\_\_\_  
 LEASE \_\_\_\_\_  
 WELL NUMBER \_\_\_\_\_  
 FIELD \_\_\_\_\_

LOCATION OF WELL: COUNTY \_\_\_\_\_  
 \_\_\_\_\_ feet from south/north line of section  
 \_\_\_\_\_ feet from east/west line of section  
 SECTION \_\_\_\_\_ TWP \_\_\_\_\_ RG \_\_\_\_\_

NUMBER OF ACRES ATTRIBUTABLE TO WELL \_\_\_\_\_  
 QTR/QTR/QTR OF ACREAGE \_\_\_\_\_

IS SECTION \_\_\_\_\_ REGULAR or \_\_\_\_\_ IRREGULAR  
IF SECTION IS IRREGULAR, LOCATE WELL FROM NEAREST CORNER BOUNDARY.

Section corner used: \_\_\_\_\_ NE \_\_\_\_\_ NW \_\_\_\_\_ SE \_\_\_\_\_ SW

**PLAT**

(Show location of the well and shade attributable acreage for prorated or spaced wells.)  
 (Show footage to the nearest lease or unit boundary line.)

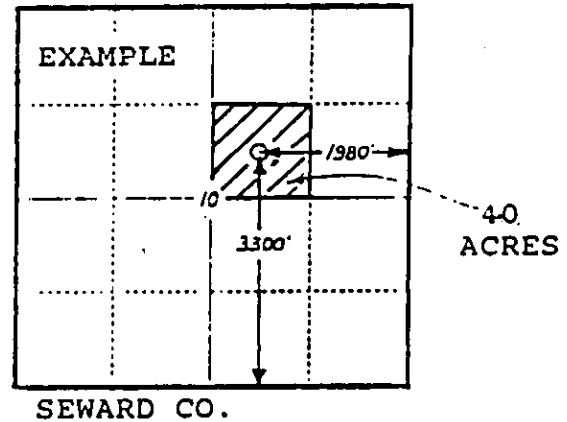
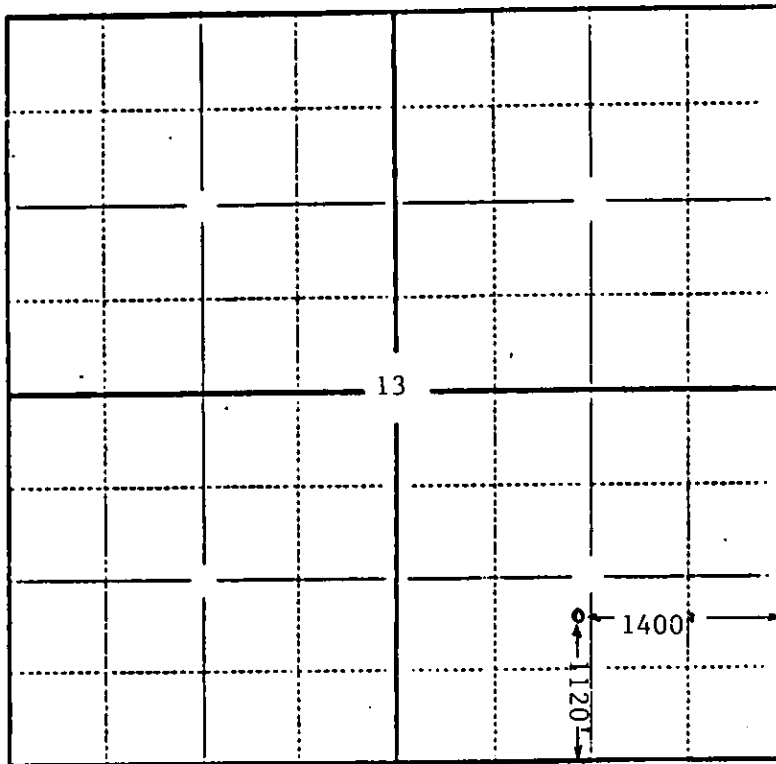

In plotting the proposed location of the well, you must show:

- 1) The manner in which you are using the depicted plat by identifying section lines, i.e. 1 section, 1 section with 8 surrounding sections, 4 sections, etc.;
- 2) the distance of the proposed drilling location from the section's south/north and east/west lines; and
- 3) the distance to the nearest lease or unit boundary line.