

STATE OF KANSAS
STATE CORPORATION COMMISSION

WELL PLUGGING RECORD

Give All Information Completely
Make Required Affidavit
Mail or Deliver Report to
Conservation Division
State Corporation Comm.
245 North Water
Wichita, KS 67202

NESS County. Sec. 20 Twp. 16S Rge. 22W NE/W
Location as "NE/CNW $\frac{1}{4}$ /SW $\frac{1}{4}$ " or footage from lines
NE NW NW
Lease Owner Sunburst Exploration Company # 5005
Lease Name Downey Well No. 1
Office Address 708 One Main Pl. Wichita, KS 67202
Character of Well (Completed as Oil, Gas or Dry Hole) DRY HOLE
Date Well completed 12-19-1982
Application for plugging filed 12-19-1982
Application for plugging approved 12-19-1982
Plugging commenced 12-19-1982
Plugging completed 12-19-1982
Reason for abandonment of well or producing formation D & A

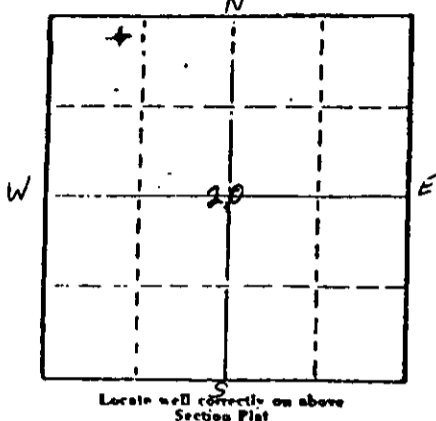

If a producing well is abandoned, date of last production 19

Was permission obtained from the Conservation Division or its agents before plugging was commenced? YES

Name of Conservation Agent who supervised plugging of this well Paul Luthi
Producing formation _____ Depth to top _____ Bottom _____ Total Depth of Well 4510'
Show depth and thickness of all water, oil and gas formations.

OIL, GAS OR WATER RECORDS

CASING RECORD

FORMATION	CONTENT	FROM	TO	SIZE	PUT IN	PULLED OUT
		0	289'	8 5/8	286'	0

Describe in detail the manner in which the well was plugged, indicating where the mud fluid was placed and the method or methods used in introducing it into the hold. If cement or other plugs were used, state the character of same and depth placed, from _____ feet to _____ feet for each plug set.

4510 T.D. 120 Sacks Posmix 3% cc 2% Gel
1st Plug at 1680' with 60 Sacks
2nd Plug at 330' with 40 Sacks
Solid Bridge at 40' with 10 Sacks
Rathole 10 Sacks Plug down 11:30 A.M. 12-19-82
Halliburton Cementing

(If additional description is necessary, use BACK of this sheet)

Name of Plugging Contractor Blue Goose Drilling Company, Inc. # 5104

STATE OF KANSAS COUNTY OF BARTON, ss.

George E. Miller, Jr. (employee of owner) or (owner or operator) of the above-described well, being first duly sworn on oath, says: That I have knowledge of the facts, statements, and matters herein contained and the log of the above-described well as filed and that the same are true and correct. So help me God.

(Signature) George E. Miller, Jr.
P.O. Box 1413 Great Bend, KS 67530
(Address)

SUBSCRIBED AND SWORN TO before me this 21st day of December, 19 82

My commission expires 12-8-83
Helen C. Standley Notary Public.

RECEIVED
STATE CORPORATION COMMISSION

HELEN C. STANDLEY
Barton County, Kansas
My Appt. Exp. 12-8-83

DEC 25 1982
12-23-1982
CONSERVATION DIVISION
Wichita, Kansas

15-135-22312-00-00

WELL LOG

DOWNEY # 1
NE NW NW Sec 20-16S-22W
Ness County, Kansas

NAME OF OPERATOR: Sunbunst Exploration Company # 5005
708 One Main Place
Wichita, KS 67202

DATE COMPLETED: December 19, 1982

TO	FROM	
0	289	Post Rock and Shale
289	1817	Shale
1776	1814	Anhydrite
1817	2180	Sand and Shale
2180	4510	Shale and Lime
4510		T.D.

STATE OF KANSAS

COUNTY OF BARTON ss

George E. Miller, Jr., President of Blue Goose Drilling Company, Inc., being first duly sworn on oath says: That I have knowledge of the facts, statements and matters herein contained and the log of the above described well as filed and the same are true and correct.

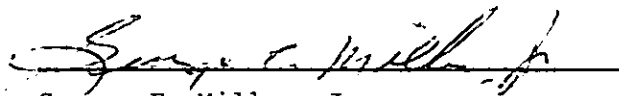
George E. Miller, Jr.

Subscribed and sworn before me this 21st Day of December 1982.

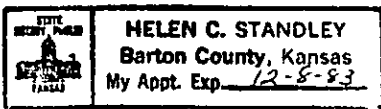

Helen C. Standley, Notary Public

My Commission Expires: 12-8-83

RECEIVED
STATE COMMISSION

DEC 25 1982
12-23-1982
CONSERVATION DIVISION
Wichita, Kansas