

STATE CORPORATION COMMISSION OF KANSAS  
OIL & GAS CONSERVATION DIVISION

WELL COMPLETION OR RECOMPLETION FORM  
ACO-1 WELL HISTORY

DESCRIPTION OF WELL AND LEASE

Operator: license # 8572  
name Reach Oil Corp., dba The Reach Group  
address 3751 East Douglas  
City/State/Zip Wichita, Kansas 67218

Operator Contact Person Jimmy W. Gowens  
Phone (316) 683-3626

Contractor: license # 6033  
name Murfin Drilling

Wellsite Geologist Paul Montoia  
Phone (913) 628-1761

PURCHASER N/A

Designate Type of Completion  
 New Well  Re-Entry  Workover

- Oil  SWD  Temp Abd
- Gas  Inj  Delayed Comp.
- Dry  Other (Core, Water Supply etc.)

If OWWO: old well info as follows:  
Operator  
Well Name  
Comp. Date Old Total Depth

WELL HISTORY

Drilling Method:  Mud Rotary  Air Rotary  Cable  
10-6-84 10-12-84 10-13-84  
Spud Date Date Reached TD Completion Date  
4190' N/A  
Total Depth PBTD  
Amount of Surface Pipe Set and Cemented at 284' @ 290' feet  
Multiple Stage Cementing Collar Used?  Yes  No  
If Yes, Show Depth Set feet  
If alternate 2 completion, cement circulated from 290' feet depth to surface w/ 280 SX cmt

API NO. 15 - 135-22,688 -00-00  
County Ness  
E 1/2 NW NW Sec 23 17 21 East West  
(location)  
4620 Ft North from Southeast Corner of Section  
4290 Ft West from Southeast Corner of Section  
(Note: locate well in section plat below)

Lease Name Ryan Well# 1  
Field Name Wildcat  
Producing Formation N/A  
Elevation: Ground 2174' KB 2179

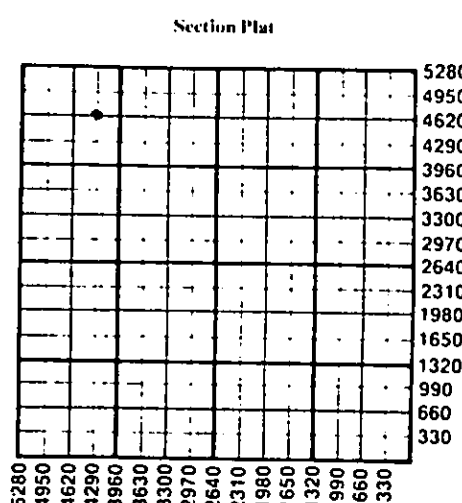

WATER SUPPLY INFORMATION

Source of Water:  
Division of Water Resources Permit #  
 Groundwater Ft North From Southeast Corner and Ft West From Southeast Corner of Sec Twp Rge East West  
 Surface Water Ft North From Southeast Corner and Ft West From Southeast Corner Sec Twp Rge East West  
 Other (explain) (purchased from city, R.W.D.#)

Disposition of Produced Water:  Disposal  Repressuring  
Docket #

INSTRUCTIONS: This form shall be completed in duplicate and filed with the Kansas Corporation Commission, 200 Colorado Derby Building, Wichita, Kansas 67202, within 90 days after completion or recompletion of any well. Rules 82-3-130 and 82-3-107 apply. Information on side two of this form will be held confidential for a period of 12 months if requested in writing and submitted with the form. See rule 82-3-107 for confidentiality in excess of 12 months. One copy of all wireline logs and drillers time log shall be attached with this form. Submit CP-4 form with all plugged wells. Submit CP-111 form with all temporarily abandoned wells.

All requirements of the statutes, rules, and regulations promulgated to regulate the oil and gas industry have been fully complied with and the statements herein are complete and correct to the best of my knowledge.

Signature [Signature]  
Title Exploration Manager  
Date 10/25/85

Subscribed and sworn to before me this 25th day of October 1985  
Notary Public Jo K. Rhone  
Date Commission Expires

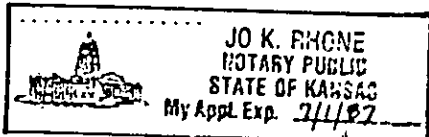

DEC 10 1985  
12-06-1984  
CONSERVATION DIVISION  
WICHITA, KANSAS

K.C.C. OFFICE USE ONLY  
F  Letter of Confidentiality Attached  
C  Wireline Log Received  
C  Drillers Timelog Received  
Distribution  
 KCC  SWD/Rep  NGPA  
 KGS  Plug  Other (Specify)

Sec 23 Twp 17N Rge 21E

Operator Name Reach Oil Corp., dba The Reach Group Lease Name Ryan Well# 1 SEC 23 TWP. 17 RGE. 21  East  West

**WELL LOG**

**INSTRUCTIONS:** Show important tops and base of formations penetrated. Detail all cores. Report all drill stem tests giving interval tested, time tool open and closed, flowing and shut-in pressures, whether shut-in pressure reached static level, hydrostatic pressures, bottom hole temperature, fluid recovery, and flow rates if gas to surface during test. Attach extra sheet if more space is needed. Attach copy of log.

Drill Stem Tests Taken  Yes  No  
 Samples Sent to Geological Survey  Yes  No  
 Cores Taken  Yes  No

Formation Description  Log  Sample

	Name	Top	Bottom
<b>DST #1:</b> 4081-98' (Cherokee "A" Sand). 30-30-45-30. Rec. 10' of mud. IHP 2124 psi., IFP 56-56 psi., ISIP 250 psi., FFP 56-56 psi., FSIP 136 psi., FHP 2048 psi. MW 9.4, VIS 42.	Anhydrite	1448'	
	Heebner	3585'	
	Toronto	3604'	
	Lansing	3624'	
	Base Kansas City	3893'	
	Pawnee	3997'	
	Base Pawnee	4061'	
	Fort Scott	4071'	
	Cherokee "A" Sand	4085'	
	Cherokee "B" Sand	4103'	
<b>DST #2:</b> 4081'-4118' (Cherokee "B" Sand). 30-60-30-60. Rec. 992' of muddy water. IHP 2067 psi., IFP 193-340 psi., ISIP 465 psi., FFP 454-465 psi., FSIP 465 psi., FHP not reported.	Cherokee "C" Sand	4128'	
	Mississippian	4168'	
<b>DST #3:</b> 4160-90' (Mississippian). 30-30-30-30. Rec. 5' of mud. IHP 2015 psi., IFP 45-45 psi., ISIP 968 psi., FFP 45-45 psi., FSIP 845 psi., FHP 1961 psi. MW 9.2, VIS 45.			

CASING RECORD <input checked="" type="checkbox"/> new <input type="checkbox"/> used							
Report all strings set - conductor, surface, intermediate, production, etc.							
Purpose of string	size hole drilled	size casing set (in O.D.)	weight lbs/ft.	setting depth	type of cement	# sacks used	type and percent additives
Surface		8-5/8"		290'	common	280	
PERFORATION RECORD				Acid, Fracture, Shot, Cement Squeeze Record			
shots per foot	specify footage of each interval perforated			(amount and kind of material used)			Depth
	N/A						
TUBING RECORD				Liner Run <input type="checkbox"/> Yes <input type="checkbox"/> No			
size	N/A	set at	packer at				
Date of First Production	Producing method <input checked="" type="checkbox"/> flowing <input type="checkbox"/> pumping <input type="checkbox"/> gas lift <input type="checkbox"/> Other (explain)						
N/A							
Estimated Production Per 24 Hours	Oil	Gas	Water	Gas-Oil Ratio	Gravity		
	Bbls	MCF	Bbls	CFPB			

Disposition of gas:  vented  sold  used on lease

METHOD OF COMPLETION:  open hole  perforation  other (specify) \_\_\_\_\_

PRODUCTION INTERVAL: \_\_\_\_\_

Dually Completed.  Commingled