

FOR KCC USE:

EFFECTIVE DATE: 12-16-91

DISTRICT # 1

SEAT Yes X No

State of Kansas

NOTICE OF INTENTION TO DRILL

Must be approved by the K.C.C. five (5) days prior to commencing well

FORM C-1 7/91

FORM MUST BE TYPED

FORM MUST BE SIGNED

ALL BLANKS MUST BE FILLED

Expected Spud Date 1 9 92 month day year

Spot C N/2- SE.- SE. Sec .5. Twp 16. S. Rg 21. East West X

OPERATOR: License # 8996 Name: Mid. Continent Resources, Inc. Address: P.O. Box 399 City/State/Zip: Garden City, KS 67846 Contact Person: Scott Corsair Phone: 913-398-2270

990 feet from South / North line of Section 660 feet from East / West line of Section IS SECTION X REGULAR IRREGULAR?

(NOTE: Locate well on the Section Plat on Reverse Side) County: Ness Lease Name: Zeller Well #: 1 Field Name: Bright NW Is this a Prorated/Spaced Field? yes X no Target Formation(s): Cherokee Nearest lease or unit boundary: 660 Ground Surface Elevation: 2350 est feet MSL Water well within one-quarter mile: yes X no Public water supply well within one mile: yes X no Depth to bottom of fresh water: 130 Depth to bottom of usable water: 790 975 Surface Pipe by Alternate: 1 X 2 Length of Surface Pipe Planned to be set: 250 Length of Conductor pipe required: NA Projected Total Depth: 4360 Formation at Total Depth: Mississippian Water Source for Drilling Operations: well X farm pond other DVR Permit #: Will Cores Be Taken?: yes X no If yes, proposed zone:

CONTRACTOR: License #: 30606 Name: Murfin Drilling Company

Well Drilled For: Well Class: Type Equipment: X Oil Enh Rec X Infield X Mud Rotary Gas Storage Pool Ext Air Rotary OWD Disposal Wildcat Cable Seismic: # of Holes Other

If OWD: old well information as follows: Operator: Well Name: Comp. Date: Old Total Depth

Directional, Deviated or Horizontal wellbore? yes X no If yes, true vertical depth: Bottom Hole Location:

AFFIDAVIT

The undersigned hereby affirms that the drilling, completion and eventual plugging of this well will comply with K.S.A. 55-101, et. seq. It is agreed that the following minimum requirements will be met:

- 1. Notify the appropriate district office prior to spudding of well;
2. A copy of the approved notice of intent to drill shall be posted on each drilling rig;
3. The minimum amount of surface pipe as specified below shall be set by circulating cement to the top; in all cases surface pipe shall be set through all unconsolidated materials plus a minimum of 20 feet into the underlying formation;
4. If the well is dry hole, an agreement between the operator and the district office on plug length and placement is necessary prior to plugging;
5. The appropriate district office will be notified before well is either plugged or production casing is cemented in;
6. IF AN ALTERNATE IS COMPLETED, PRODUCTION PIPE SHALL BE CEMENTED FROM BELOW ANY USABLE WATER TO SURFACE WITHIN 120 DAYS OF SPUD DATE. IN ALL CASES, NOTIFY DISTRICT OFFICE PRIOR TO ANY CEMENTING.

I hereby certify that the statements made herein are true and to the best of my knowledge and belief.

Date: 12-9-91 Signature of Operator or Agent: Scott Corsair Title: Agent

RECEIVED STATE COMMISSION 12-10-1991 DEC 10 1991

FOR KCC USE: API # 15- 135-23,636-00-00 Conductor pipe required None feet Minimum surface pipe required 200 feet per Alt. 2 Approved by: MHW 12-11-91 This authorization expires: 6-11-92 (This authorization void if drilling not started within 6 months of effective date.) Spud date: Agent:

REMEMBER TO:

- File Drill Pit Application (form CDP-1) with Intent to Drill;
- File Completion Form ACD-1 within 120 days of spud date;
- File acreage attribution plat according to field proration orders;
- Notify appropriate district office 48 hours prior to workover or re-entry;
- Submit plugging report (CP-4) after plugging is completed;
- Obtain written approval before disposing or injecting salt water.

Mail to: Conservation Division, 200 Colorado Derby Building, 202 W. First St., Wichita, Kansas 67202-1286.

Handwritten notes and signatures on the right margin.

**IN ALL CASES PLOT THE INTENDED WELL ON THE PLAT BELOW**

**PLAT OF ACREAGE ATTRIBUTABLE TO A WELL IN A PRORATED OR SPACED FIELD**

If the intended well is in a prorated or spaced field, please fully complete this side of the form. If the intended well is in a prorated or spaced field complete the plat below showing that the well will be properly located in relationship to other wells producing from the common source of supply. Please show all the wells within 1 mile of the boundaries of the proposed acreage attribution unit for gas wells and within 1/2 mile of the boundaries of the proposed acreage attribution unit for oil wells.

API NO. 15- \_\_\_\_\_  
 OPERATOR Mid Continent Resources, Inc.  
 LEASE Zeller  
 WELL NUMBER 1  
 FIELD Bright NW

LOCATION OF WELL: COUNTY Ness  
990 feet from south/north line of section  
660 feet from east/west line of section  
 SECTION 5 TWP 16S RG 21W

NUMBER OF ACRES ATTRIBUTABLE TO WELL 10  
 QTR/QTR/QTR OF ACREAGE \_\_\_\_\_

IS SECTION x REGULAR or \_\_\_\_\_ IRREGULAR  
**IF SECTION IS IRREGULAR, LOCATE WELL FROM NEAREST CORNER BOUNDARY.**

Section corner used: \_\_\_\_\_ NE \_\_\_\_\_ NW \_\_\_\_\_ SE \_\_\_\_\_ SW

**PLAT**

(Show location of the well and shade attributable acreage for prorated or spaced wells.)  
 (Show footage to the nearest lease or unit boundary line.)

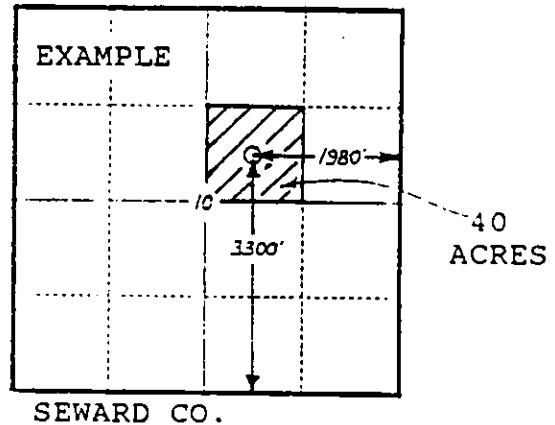
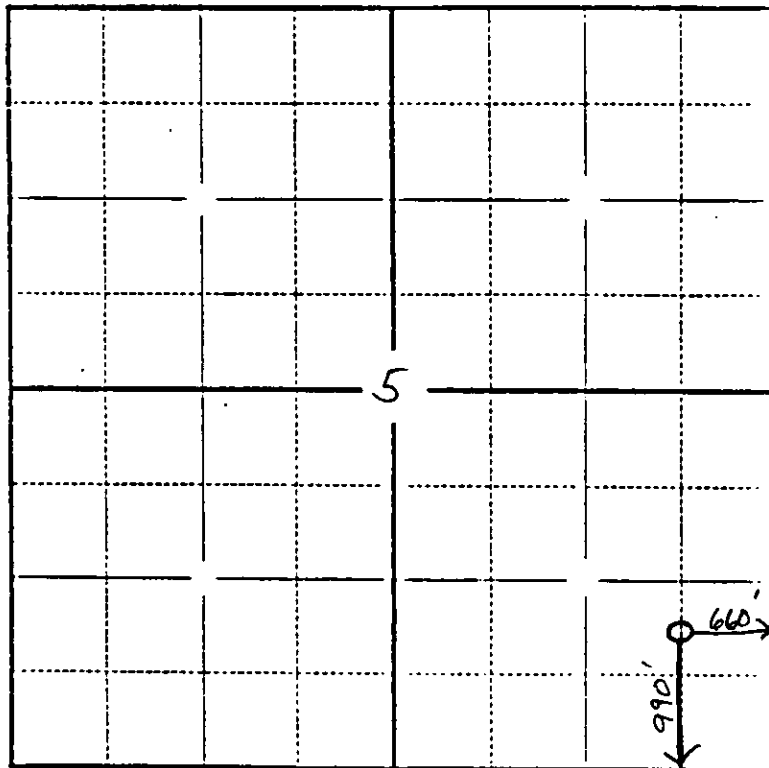

**In plotting the proposed location of the well, you must show:**

- 1) The manner in which you are using the depicted plat by identifying section lines, i.e. 1 section, 1 section with 8 surrounding sections, 4 sections, etc.;
- 2) the distance of the proposed drilling location from the section's south/north and east/west lines; and
- 3) the distance to the nearest lease or unit boundary line.