

FOR KCC USE:

FORM C-1 7/91

FORM MUST BE TYPED

EFFECTIVE DATE: 6-10-92

State of Kansas

FORM MUST BE SIGNED

DISTRICT # 1

NOTICE OF INTENTION TO DRILL

ALL BLANKS MUST BE FILLED

SEAT... Yes... No

Must be approved by the K.C.C. five (5) days prior to commencing well

Expected Spud Date month day year

Spot NE SE SW Sec 16 Twp 16 S. Rg 21W East West

OPERATOR: License # 4767
Name: Ritchie Exploration, Inc.
Address: 125 N. Market, Suite 1000
City/State/Zip: Wichita, KS 67202
Contact Person: Bob Mathiesen
Phone: (316) 267-4375

990 feet from South North line of Section
2310 feet from East / West line of Section
IS SECTION X REGULAR IRREGULAR

(NOTE: Locate well on the Section Plat on Reverse Side)
County: Ness
Lease Name: John Irvin Well #: 1
Field Name: wildcat

CONTRACTOR: License #:
Name: unknown

Is this a Prorated/Spaced Field? yes X no
Target Formation(s): Cherokee
Nearest lease or unit boundary: .330'
Ground Surface Elevation: 2350' est. feet MSL
Water well within one-quarter mile: X yes no
Public water supply well within one mile: yes X no

Well Drilled For: Well Class: Type Equipment:
X Oil ... Enh Rec ... Infield X Mud Rotary
... Gas ... Storage ... Pool Ext. ... Air Rotary
... OWD ... Disposal X Wildcat ... Cable
... Seismic; ... # of Holes ... Other

Depth to bottom of fresh water: 120'
Depth to bottom of usable water: 1000'
Surface Pipe by Alternate: 1 X 2
Length of Surface Pipe Planned to be set: 200'
Length of Conductor pipe required: none
Projected Total Depth: 4350'
Formation at Total Depth: Mississippian
Water Source for Drilling Operations:
... well farm pond X other

If OWD: old well information as follows:
Operator:
Well Name:
Comp. Date: Old Total Depth

DWR Permit #:
Will Cores Be Taken?: yes X no
If yes, proposed zone:

Directional, Deviated or Horizontal wellbore? yes X no
If yes, true vertical depth:
Bottom Hole Location:

AFFIDAVIT

The undersigned hereby affirms that the drilling, completion and eventual plugging of this well will comply with K.S.A. 55-101, et. seq.
It is agreed that the following minimum requirements will be met:

1. Notify the appropriate district office prior to spudding of well;
2. A copy of the approved notice of intent to drill shall be posted on each drilling rig;
3. The minimum amount of surface pipe as specified below shall be set by circulating cement to the top; in all cases surface pipe shall be set through all unconsolidated materials plus a minimum of 20 feet into the underlying formation;
4. If the well is dry hole, an agreement between the operator and the district office on plug length and placement is necessary prior to plugging;
5. The appropriate district office will be notified before well is either plugged or production casing is cemented in;
6. IF AN ALTERNATE II COMPLETION, PRODUCTION PIPE SHALL BE CEMENTED FROM BELOW ANY USABLE WATER TO SURFACE WITHIN 120 DAYS OF SPUD DATE. IN ALL CASES, NOTIFY DISTRICT OFFICE PRIOR TO ANY CEMENTING.

I hereby certify that the statements made herein are true and to the best of my knowledge and belief.
Date: 6-3-92 Signature of Operator or Agent: Brian M. Allen Title: Geologist

FOR KCC USE:
API # 15- 135-23684-00-00
Conductor pipe required None feet
Minimum surface pipe required 200 feet per Alt. X2
Approved by: C.B. 6-5-92

This authorization expires: 12-5-92
(This authorization void if drilling not started within 6 months of effective date.)
Spud date: _____ Agent: _____

RECEIVED
STATE COMMISSION

JUN 5 1992
06-05-1992
CONSERVATION DIVISION
Wichita, Kansas

REMEMBER TO:

- File Drill Pit Application (form CDP-1) with Intent to Drill;
- File Completion Form ACO-1 within 120 days of spud date;
- File acreage attribution plat according to field proration orders;
- Notify appropriate district office 48 hours prior to workover or re-entry;
- Submit plugging report (CP-4) after plugging is completed;
- Obtain written approval before disposing or injecting salt water.

Mail to: Conservation Division, 200 Colorado Serby Building, 202 W. First St., Wichita, Kansas 67202-1286.

16
16
21

IN ALL CASES PLOT THE INTENDED WELL ON THE PLAT BELOW

PLAT OF ACREAGE ATTRIBUTABLE TO A WELL IN A PRORATED OR SPACED FIELD

If the intended well is in a prorated or spaced field, please fully complete this side of the form. If the intended well is in a prorated or spaced field complete the plat below showing that the well will be properly located in relationship to other wells producing from the common source of supply. Please show all the wells within 1 mile of the boundaries of the proposed acreage attribution unit for gas wells and within 1/2 mile of the boundaries of the proposed acreage attribution unit for oil wells.

API NO. 15- _____
 OPERATOR Ritchie Exploration, Inc. LOCATION OF WELL: COUNTY Ness
 LEASE John Irvin _____ 990 feet from south/north line of section
 WELL NUMBER 1 _____ 2310 feet from east/west line of section
 FIELD wildcat _____ SECTION 16 TWP 16 RG 21W

NUMBER OF ACRES ATTRIBUTABLE TO WELL _____ IS SECTION _____ REGULAR or _____ IRREGULAR
 QTR/QTR/QTR OF ACREAGE NE - SE - SW **IF SECTION IS IRREGULAR, LOCATE WELL FROM NEAREST CORNER BOUNDARY.**

Section corner used: _____ NE _____ NW _____ SE _____ SW

PLAT

(Show location of the well and shade attributable acreage for prorated or spaced wells.)
 (Show footage to the nearest lease or unit boundary line.)

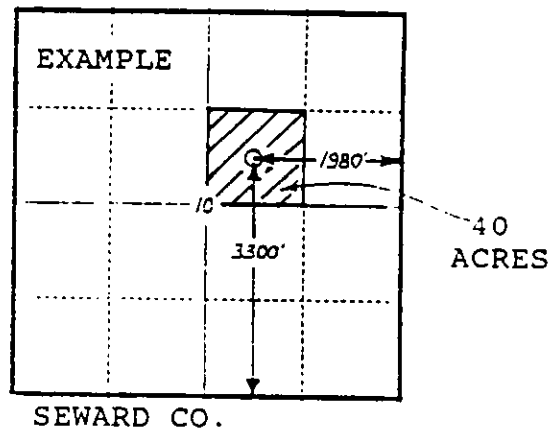
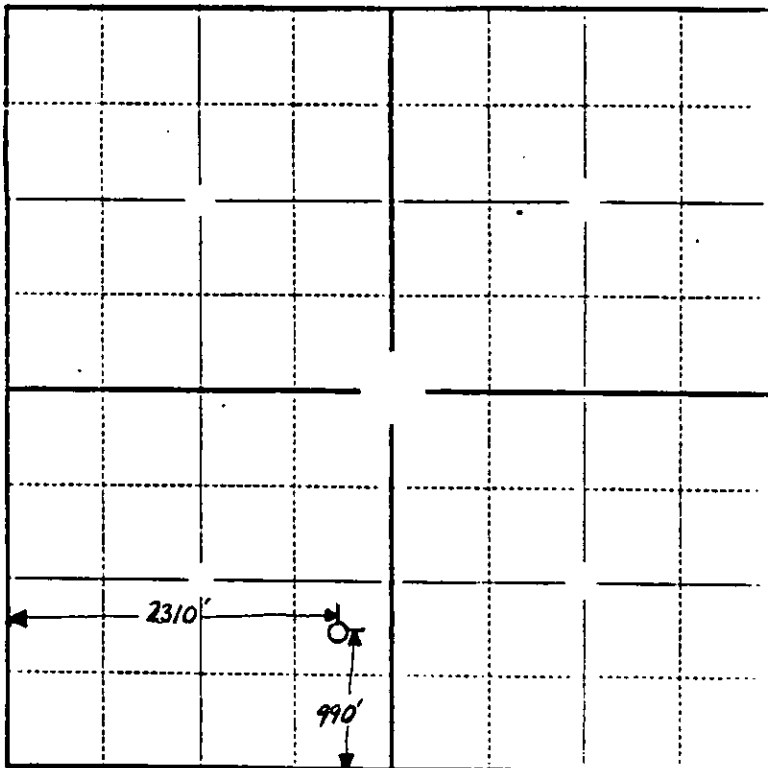

In plotting the proposed location of the well, you must show:

- 1) The manner in which you are using the depicted plat by identifying section lines, i.e. 1 section, 1 section with 8 surrounding sections, 4 sections, etc.;
- 2) the distance of the proposed drilling location from the section's south/north and east/west lines; and
- 3) the distance to the nearest lease or unit boundary line.