

EFFECTIVE DATE: 8-26-92

DISTRICT # 1

15A7... Yes, X, No

State of Kansas

NOTICE OF INTENTION TO DRILL

Must be approved by the K.C.C. five (5) days prior to commencing well

FORM MUST BE TYPED

FORM MUST BE SIGNED

ALL BLANKS MUST BE FILLED

Expected Spud Date Sept. 2 1992
month day year

Spot SE-SE-NW Sec 19 Twp 16 S, Rg 21 E X East West

OPERATOR: License # 30342 ✓
Name: SHEETS OIL CO.
Address: 1333 W. 120th #310
City/State/Zip: Denver, CO 80234
Contact Person: Rich. O'Donnell
Phone: 303/451-0175

✓ 2970... feet from South line of Section
✓ 2970... feet from East line of Section
IS SECTION X REGULAR IRREGULAR?

(NOTE: Locate well on the Section Plat on Reverse Side)

CONTRACTOR: License #: 5418 ✓
Name: Allen Drilling Company

County: Ness
Lease Name: Walker Well #: 1

Field Name: Wildcat
Is this a Prorated/Spaced Field? ... yes X no

Target Formation(s): Miss
Nearest lease or unit boundary: 330 ✓

Well Drilled For: Well Class: Type Equipment:
X Oil ✓ ... Enh Rec ... Infield .. X Mud Rotary
... Gas ... Storage X Pool Ext. ... Air Rotary
... OWMO ... Disposal ... Wildcat ... Cable
... Seismic; ... # of Holes ... Other
... Other

Ground Surface Elevation: ... feet MSL
Water well within one-quarter mile: ... yes .. X no

Public water supply well within one mile: ... yes .. X no
Depth to bottom of fresh water: 1.00

Depth to bottom of usable water: 680
Surface Pipe by Alternate: ... 1 X 2

Length of Surface Pipe Planned to be set: 28.0
Length of Conductor pipe required: N/A

Projected Total Depth: 4375
Formation at Total Depth: Miss

Water Source for Drilling Operations:
... well X farm pond ... other

If OWMO: old well information as follows:
Operator: N/A
Well Name: _____
Comp. Date: _____ Old Total Depth _____

DWR Permit #: _____
Will Cores Be Taken? ... yes X no

Directional, Deviated or Horizontal wellbore? ... yes .. X no
If yes, true vertical depth: _____

If yes, proposed zone: _____

Bottom Hole Location: _____

AFFIDAVIT

The undersigned hereby affirms that the drilling, completion and eventual plugging of this well will comply with K.S.A. 55-101, et. seq.

It is agreed that the following minimum requirements will be met:

1. Notify the appropriate district office prior to spudding of well;
2. A copy of the approved notice of intent to drill shall be posted on each drilling rig;
3. The minimum amount of surface pipe as specified below shall be set by circulating cement to the top; in all cases surface pipe shall be set through all unconsolidated materials plus a minimum of 20 feet into the underlying formation;
4. If the well is dry hole, an agreement between the operator and the district office on plug length and placement is necessary prior to plugging;
5. The appropriate district office will be notified before well is either plugged or production casing is cemented in;
6. IF AN ALTERNATE IS COMPLETED, PRODUCTION PIPE SHALL BE CEMENTED FROM BELOW ANY USABLE WATER TO SURFACE WITHIN 120 DAYS OF SPUD DATE. IN ALL CASES, NOTIFY DISTRICT OFFICE PRIOR TO ANY CEMENTING.

I hereby certify that the statements made herein are true and to the best of my knowledge and belief.

Date: 8/26/92 Signature of Operator or Agent: John A. Johnson Title: Agent

FOR ECC USE:
 API # 15- 135-23698-00-00
 Conductor pipe required None feet
 Minimum surface pipe required 200 feet per Alt. X ②
 Approved by: CB 8-26-92

This authorization expires: 2-26-93
 (This authorization void if drilling not started within 6 months of effective date.)
 Spud date: _____ Agent: _____

RECEIVED
 KANSAS CORPORATION COMMISSION
 AUG 26 1992
 08-26-1992
 CONSERVATION DIVISION
 WICHITA, KS

REMEMBER TO:

- File Drill Pit Application (form CDP-1) with Intent to Drill;
- File Completion Form ACO-1 within 120 days of spud date;
- File acreage attribution plat according to field prorotation orders;
- Notify appropriate district office 48 hours prior to workover or re-entry;
- Submit plugging report (CP-4) after plugging is completed;
- Obtain written approval before disposing or injecting salt water.

Mail to: Conservation Division, 208 Colorado Berby Building, 202 W. First St., Wichita, Kansas 67202-1286.

IN ALL CASES PLOT THE INTENDED WELL ON THE PLAT BELOW

PLAT OF ACREAGE ATTRIBUTABLE TO A WELL IN A PRORATED OR SPACED FIELD

If the intended well is in a prorated or spaced field, please fully complete this side of the form. If the intended well is in a prorated or spaced field complete the plat below showing that the well will be properly located in relationship to other wells producing from the common source of supply. Please show all the wells within 1 mile of the boundaries of the proposed acreage attribution unit for gas wells and within 1/2 mile of the boundaries of the proposed acreage attribution unit for oil wells.

API NO. 15- _____
 OPERATOR SHEETS OIL CO.
 LEASE Walker
 WELL NUMBER #1
 FIELD _____

LOCATION OF WELL: COUNTY NESS
2970 feet from south/north line of section
2970 feet from east/west line of section
 SECTION 19 TWP 16 RG 21

NUMBER OF ACRES ATTRIBUTABLE TO WELL _____
 QTR/QTR/QTR OF ACREAGE SE - SE - nw

IS SECTION X REGULAR or _____ IRREGULAR
IF SECTION IS IRREGULAR, LOCATE WELL FROM NEAREST CORNER BOUNDARY.

Section corner used: NE NW SE SW

PLAT

(Show location of the well and shade attributable acreage for prorated or spaced wells.)
 (Show footage to the nearest lease or unit boundary line.)

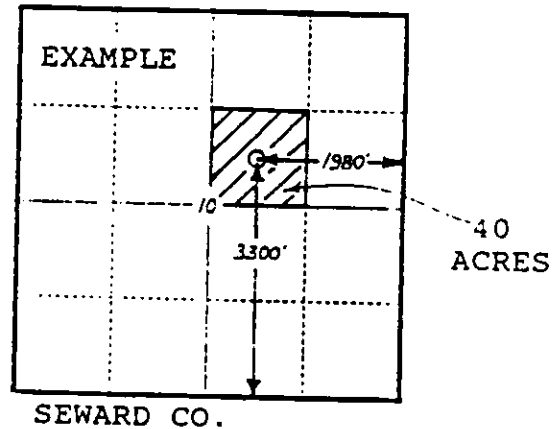
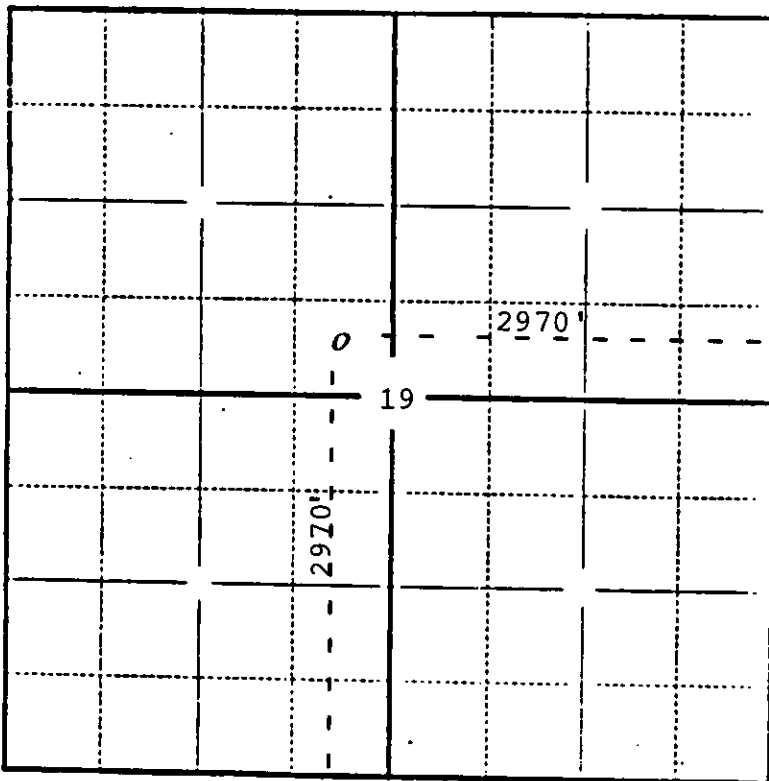

In plotting the proposed location of the well, you must show:

- 1) The manner in which you are using the depicted plat by identifying section lines, i.e. 1 section, 1 section with 8 surrounding sections, 4 sections, etc.;
- 2) the distance of the proposed drilling location from the section's south/north and east/west lines; and
- 3) the distance to the nearest lease or unit boundary line.