

XX 2nd CORRECTED

CORRECTED
Correction #2

CORRECTED

For KCC Use:
Effective Date: 8-22-2011
District # 3
SGA? Yes No

KANSAS CORPORATION COMMISSION
OIL & GAS CONSERVATION DIVISION

Form C-1
March 2010
Form must be Typed
Form must be Signed
All blanks must be Filled

NOTICE OF INTENT TO DRILL

Must be approved by KCC five (5) days prior to commencing well
Form KSONA-1, Certification of Compliance with the Kansas Surface Owner Notification Act, MUST be submitted with this form.

Expected Spud Date: September 19, 2011
month day year
OPERATOR: License# 34592
Name: Kansas Resource Exploration & Development, LLC
Address 1: 9393 W. 110th St., Suite 500
Address 2:
City: Overland Park State: KS Zip: 66210
Contact Person: Brad Kramer
Phone: (913) 669-2253
CONTRACTOR: License# 8509
Name: Evans Energy Development, Inc.

Spot Description: * NE NE SE NW * SE-SW-SW-NW
SW NE NW NW Sec. 14 Twp. 14 S. R. 22 E W
feet from N / S Line of Section
feet from E / W Line of Section
Is SECTION: Regular Irregular?

Well Drilled For: Oil Gas Enh Rec Storage Disposal Seismic Other:
Well Class: Infield Pool Ext. Wildcat Other:
Type Equipment: Mud Rotary Air Rotary Cable
of Holes: _____
 If OWWO: old well information as follows:
Operator: _____
Well Name: _____
Original Completion Date: _____ Original Total Depth: _____

County: Johnson
Lessee Name: Knabe D Well #: KR-9
Field Name: Gardner
Is this a Prorated / Spaced Field? Yes No
Target Formation(s): Cherokee Group

Nearest Lease or unit boundary line (in footage): 352
Ground Surface Elevation: 1,937 Estimated 1023 feet 1033
Water well within one-quarter mile: Yes No
Public water supply well within one mile: Yes No
Depth to bottom of fresh water: 200
Depth to bottom of usable water: 300
Surface Pipe by Alternate: I II
Length of Surface Pipe Planned to be set: 20'
Length of Conductor Pipe (if any): _____
Projected Total Depth: 900'
Formation at Total Depth: Barbeville

Directional, Deviated or Horizontal wellbore? Yes No
If Yes, true vertical depth: _____
Bottom Hole Location: _____
KCC DKT #: _____

Water Source for Drilling Operations:
 Well Farm Pond Other: _____
DWR Permit #: _____
(Note: Apply for Permit with DWR) Yes No

~~* WAS: SW-NE-NW-NW 4897 FSL; 4534 FEL; NW 352; Elev 1009~~
~~* IS: NE-NE-SE-NW 3922 FSL; 4534 FEL; NW 170; Elev 1023~~

AFFIDAVIT

The undersigned hereby affirms that the drilling, completion and eventual plugging of this well will comply with K.S.A. 55 et seq. it is agreed that the following minimum requirements will be met: ~~* WAS: 3922 FSL; 2810 FEL; NE-NE-SE-NW; Elev. 1023~~
~~* IS: 2810 FSL; 478 FEL; SE-SW-SW-NW; Elev. 1033~~
1. Notify the appropriate district office prior to spudding of well.
2. A copy of the approved notice of intent to drill shall be posted on each drilling rig;
3. The minimum amount of surface pipe as specified below shall be set by circulating cement to the top; in all cases surface pipe shall be set through all unconsolidated materials plus a minimum of 20 feet into the underlying formation.
4. If the well is dry hole, an agreement between the operator and the district office on plug length and placement is necessary prior to plugging;
5. The appropriate district office will be notified before well is either plugged or production casing is cemented in;
6. If an ALTERNATE II COMPLETION, production pipe shall be cemented from below any usable water to surface within 120 DAYS of spud date.
Or pursuant to Appendix "B" - Eastern Kansas surface casing order #133,891-C, which applies to the KCC District 3 area, alternate II cementing must be completed within 30 days of the spud date or the well shall be plugged. In all cases, NOTIFY district office prior to any cementing.

I hereby certify that the statements made herein are true and to the best of my knowledge and belief.

Date: 7-29-11 Signature of Operator or Agent: [Signature] Title: Agent KCC WICHITA

For KCC Use ONLY
API # 15 - 091-23552-00-00
Conductor pipe required None feet
Minimum surface pipe required 20 feet per ALT.
Approved by: [Signature] 8-17-2011 / [Signature] 9-2011
This authorization expires: 8-17-2012
(This authorization void if drilling not started within 12 months of approval date)
Spud date: _____ Agent: _____

- Remember to:
- File Certification of Compliance with the Kansas Surface Owner Notification Act (KSONA-1) with Intent to Drill;
 - File Drill Pit Application (form CDP-1) with Intent to Drill;
 - File Completion Form ACC-1 within 120 days of spud date;
 - File acreage attribution plat according to field proration orders;
 - Notify appropriate district office 48 hours prior to workover or re-entry, Submit plugging report (CP-4) after plugging is completed (within 60 days)
 - Obtain written approval before disposing or injecting salt water.
 - If well will not be drilled or permit has expired (See: authorized expiration date) please check the box below and return to the address below.
- Well will not be drilled or Permit Expired Date: _____
Signature of Operator or Agent: _____

Mail to: KCC - Conservation Division,
130 S. Market - Room 2078, Wichita, Kansas 67202

RECEIVED
AUG 17 2011
RECEIVED
SEP 09 2011
RECEIVED
KCC WICHITA 2 5 2012
KCC WICHITA

2ND CORRECTED

~~** CORRECTED **~~

CORRECTED

Side Two

Correction #2

For KCC Use ONLY
API # 15 - 091-23552-0000

IN ALL CASES PLOT THE INTENDED WELL ON THE PLAT BELOW

In all cases, please fully complete this side of the form. Include items 1 through 5 at the bottom of this page.

Operator: Kansas Resource Exploration & Development, LLC Location of Well: County: Johnson
Lease: Knabe D feet from N S Line of Section
Well Number: KR-9 feet from E W Line of Section
Field: Gardner Sec. 14 Twp. 14 S. R. 22 E W

Number of Acres attributable to well:
QTR/QTR/QTR/QTR of acreage: ~~SW - NE - NW - SW~~
~~* NE NE SE NW~~
**** SE - SW - SW - NW**

Is Section: Regular or Irregular
If Section is Irregular, locate well from nearest corner boundary.
Section corner used: NE NW SE SW

PLAT

Show location of the well. Show footage to the nearest lease or unit boundary line. Show the predicted locations of lease roads, tank batteries, pipelines and electrical lines, as required by the Kansas Surface Owner Notice Act (House Bill 2032).
You may attach a separate plat if desired.

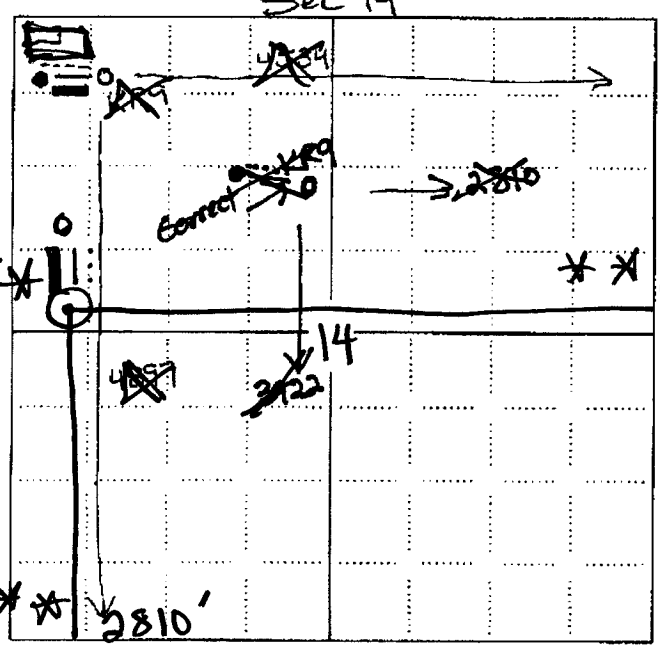

LEGEND

- Well Location
- Tank Battery Location
- Pipeline Location
- Electric Line Location
- Lease Road Location

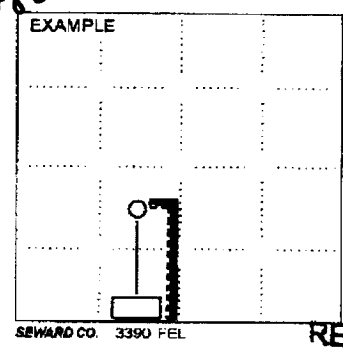

RECEIVED
SEP 09 2011

KCC WICHITA

NOTE: In all cases locate the spot of the proposed drilling location.

In plotting the proposed location of the well, you must show:

1. The manner in which you are using the depicted plat by identifying section lines, i.e. 1 section, 1 section with 8 surrounding sections, 4 sections, etc.
2. The distance of the proposed drilling location from the south / north and east / west outside section lines.
3. The distance to the nearest lease or unit boundary line (in footage).
4. If proposed location is located within a prorated or spaced field a certificate of acreage attribution plat must be attached: (CO-7 for oil wells; CG-8 for gas wells).
5. The predicted locations of lease roads, tank batteries, pipelines, and electrical lines.

RECEIVED
AUG 17 2011
KCC WICHITA

RECEIVED
JUN 25 2012
KCC WICHITA

RECEIVED
SEP 09 2011
KCC WICHITA

Correction #2
~~**CORRECTED**~~

2ND
CORRECTED

15-091-23552-000

KANSAS CORPORATION COMMISSION
OIL & GAS CONSERVATION DIVISION

CORRECTED

Form KSONA-1
July 2010
Form Must Be Typed
Form must be Signed
All blanks must be Filled

**CERTIFICATION OF COMPLIANCE WITH THE
KANSAS SURFACE OWNER NOTIFICATION ACT**

This form must be submitted with all Forms C-1 (Notice of Intent to Drill); CB-1 (Cathodic Protection Borehole Intent); T-1 (Request for Change of Operator Transfer of Injection or Surface Pit Permit); and CP-1 (Well Plugging Application). Any such form submitted without an accompanying Form KSONA-1 will be returned.

Select the corresponding form being filed: C-1 (Intent) CB-1 (Cathodic Protection Borehole Intent) T-1 (Transfer) CP-1 (Plugging Application)

OPERATOR: License # 34592
Name: Kansas Resource Exploration & Development, LLC
Address 1: 9393 W. 110th St., Suite 500
Address 2: _____
City: Overland Park State: KS Zip: 66210
Contact Person: Brad Kramer
Phone: (913) 669-2253 Fax: (913) 451-6750
Email Address: kramerbradley@yahoo.com

~~* NE NE SE NW~~ SE SW SW NW
Well Location: _____
SW NE NW NW Sec. 14 Twp. 14 S. R. 22 East West
County: Johnson
Lease Name: Knabe D Well #: KR-9

If filing a Form T-1 for multiple wells on a lease, enter the legal description of the lease below:

Surface Owner Information:

Name: Ronald & Susan Rushing
Address 1: 661 N Pine Cir.
Address 2: _____
City: Gardner State: KS Zip: 66030

When filing a Form T-1 involving multiple surface owners, attach an additional sheet listing all of the information to the left for each surface owner. Surface owner information can be found in the records of the register of deeds for the county, and in the real estate property tax records of the county treasurer.

If this form is being submitted with a Form C-1 (Intent) or CB-1 (Cathodic Protection Borehole Intent), you must supply the surface owners and the KCC with a plat showing the predicted locations of lease roads, tank batteries, pipelines, and electrical lines. The locations shown on the plat are preliminary non-binding estimates. The locations may be entered on the Form C-1 plat, Form CB-1 plat, or a separate plat may be submitted.

Select one of the following:

I certify that, pursuant to the Kansas Surface Owner Notice Act (House Bill 2032), I have provided the following to the surface owner(s) of the land upon which the subject well is or will be located: 1) a copy of the Form C-1, Form CB-1, Form T-1, or Form CP-1 that I am filing in connection with this form; 2) if the form being filed is a Form C-1 or Form CB-1, the plat(s) required by this form; and 3) my operator name, address, phone number, fax, and email address.

I have not provided this information to the surface owner(s). I acknowledge that, because I have not provided this information, the KCC will be required to send this information to the surface owner(s). To mitigate the additional cost of the KCC performing this task, I acknowledge that I am being charged a \$30.00 handling fee, payable to the KCC, which is enclosed with this form.

If choosing the second option, submit payment of the \$30.00 handling fee with this form. If the fee is not received with this form, the KSONA-1 form and the associated Form C-1, Form CB-1, Form T-1, or Form CP-1 will be returned.

I hereby certify that the statements made herein are true and correct to the best of my knowledge and belief.

Date: 7-29-11 Signature of Operator or Agent: RK Title: Agent

RECEIVED
AUG 17 2011

KCC WICHITA

Mail to: KCC - Conservation Division, 130 S. Market - Room 2078, Wichita, Kansas 67202

RECEIVED
JUN 25 2012
KCC WICHITA

RECEIVED

SEP 09 2011

KCC WICHITA

Correction #2
** CORRECTED **

2nd CORRECTED

CORRECTED

KANSAS CORPORATION COMMISSION
OIL & GAS CONSERVATION DIVISION
APPLICATION FOR SURFACE PIT

Form CDP-1
May 2010
Form must be Typed

Submit in Duplicate

Operator Name: Kansas Resource Exploration & Development, LLC		License Number: 34592	
Operator Address: 9393 W. 110th St., Suite 500 Overland Park KS 66210			
Contact Person: Brad Kramer		Phone Number: (913) 669-2253	
Lease Name & Well No.: Knabe D KR-9		Pit Location (QQQQ): NE NE SE NW SW NE NW NW SE-SW-SW-NW	
Type of Pit: <input type="checkbox"/> Emergency Pit <input type="checkbox"/> Burn Pit <input type="checkbox"/> Settling Pit <input checked="" type="checkbox"/> Drilling Pit <input type="checkbox"/> Workover Pit <input type="checkbox"/> Haul-Off Pit <small>(If WP Supply API No. or Year Drilled)</small>		Pit is: <input checked="" type="checkbox"/> Proposed <input type="checkbox"/> Existing If Existing, date constructed: 3/12 4/8/97 Pit capacity: 4750 4,534 (bbls) Johnson County	
Is the pit located in a Sensitive Ground Water Area? <input type="checkbox"/> Yes <input checked="" type="checkbox"/> No		Chloride concentration: _____ mg/l <small>(For Emergency Pits and Settling Pits only)</small>	
Is the bottom below ground level? <input checked="" type="checkbox"/> Yes <input type="checkbox"/> No		Artificial Liner? <input type="checkbox"/> Yes <input checked="" type="checkbox"/> No	
How is the pit lined if a plastic liner is not used? Native Clay			
Pit dimensions (all but working pits): Length (feet) 15 Width (feet) 10		Depth from ground level to deepest point: 5 (feet)	
<input type="checkbox"/> N/A: Steel Pits <input type="checkbox"/> No Pit			
If the pit is lined give a brief description of the liner material, thickness and installation procedure.		Describe procedures for periodic maintenance and determining liner integrity, including any special monitoring.	
Distance to nearest water well within one-mile of pit: N/A feet Depth of water well _____ feet		Depth to shallowest fresh water _____ feet Source of information: <input type="checkbox"/> measured <input type="checkbox"/> well owner <input type="checkbox"/> electric log <input checked="" type="checkbox"/> KDWR	
Emergency, Settling and Burn Pits ONLY: Producing Formation: _____ Number of producing wells on lease: _____ Barrels of fluid produced daily: _____ Does the slope from the tank battery allow all spilled fluids to flow into the pit? <input type="checkbox"/> Yes <input type="checkbox"/> No		Drilling, Workover and Haul-Off Pits ONLY: Type of material utilized in drilling/workover: Drilling Mud Number of working pits to be utilized: 2 Abandonment procedure: Air dry and backfill Drill pits must be closed within 365 days of spud date.	
I hereby certify that the above statements are true and correct to the best of my knowledge and belief.		RECEIVED AUG 17 2011 KCC WICHITA	
Date: 7-29-11		Signature of Applicant or Agent: <i>BK</i>	
KCC OFFICE USE ONLY			
Date Received: 8-17-11		Permit Number: _____ Permit Date: 8-17-11	
		<input type="checkbox"/> Liner <input type="checkbox"/> Steel Pit <input type="checkbox"/> RFAC <input type="checkbox"/> RFAS Lease Inspection: <input type="checkbox"/> Yes <input checked="" type="checkbox"/> No	
Mail to: KCC - Conservation Division, 130 S. Market - Room 2078, Wichita, Kansas 67202			

15-091-23552-00-00

RECEIVED
JUN 25 2012

KCC WICHITA