

* Range
CORRECTED



For KCC Use:
Effective Date: 02/10/2010
District # 3
SGA? Yes No

KANSAS CORPORATION COMMISSION 1034518
OIL & GAS CONSERVATION DIVISION

Form C-1
October 2007
Form must be Typed
Form must be Signed
All blanks must be Filled

NOTICE OF INTENT TO DRILL

Must be approved by KCC five (5) days prior to commencing well

Expected Spud Date: 02/14/2010
month day year

OPERATOR: License# 7160
Name: Wrestler, David L., a General Partnership
Address 1: 1776 GEORGIA RD
Address 2:
City: HUMBOLDT State: KS Zip: 66748 + 1500
Contact Person: David Wrestler
Phone: 620-473-2324

CONTRACTOR: License# 33977
Name: E K Energy LLC

Well Drilled For: Oil Gas Enh Rec Storage Disposal Seismic; # of Holes Other:
Well Class: Infield Pool Ext. Wildcat Other
Type Equipment: Mud Rotary Air Rotary Cable
 If OWWO: old well information as follows:

Operator:
Well Name:
Original Completion Date: Original Total Depth:

Directional, Deviated or Horizontal wellbore? Yes No
If Yes, true vertical depth:
Bottom Hole Location:
KCC DKT #:

* WAS: Range 18E
IS Range 19E

Spot Description: * 19
NW - SW - NW - SW Sec. 7 Twp. 24 S. R. 18
(a/a/a/a) 1,979 feet from N / S Line of Section
165 feet from E / W Line of Section

Is SECTION: Regular Irregular?
(Note: Locate well on the Section Plat on reverse side)

County: Allen
Lease Name: korte farms Well #: 8

Field Name:
Is this a Prorated / Spaced Field? Yes No

Target Formation(s): tucker
Nearest Lease or unit boundary line (in footage): 165

Ground Surface Elevation: 948 Estimated Estimated feet MSL
Water well within one-quarter mile: Yes No

Public water supply well within one mile: Yes No
Depth to bottom of fresh water: 100

Depth to bottom of usable water: 150
Surface Pipe by Alternate: I II

Length of Surface Pipe Planned to be set: 20
Length of Conductor Pipe (if any):

Projected Total Depth: 940
Formation at Total Depth: Tucker

Water Source for Drilling Operations:
 Well Farm Pond Other:

DWR Permit #: (Note: Apply for Permit with DWR)
Will Cores be taken? Yes No

If Yes, proposed zone:

AFFIDAVIT

The undersigned hereby affirms that the drilling, completion and eventual plugging of this well will comply with K.S.A. 55 et. seq.
It is agreed that the following minimum requirements will be met:

- 1. Notify the appropriate district office prior to spudding of well;
- 2. A copy of the approved notice of intent to drill shall be posted on each drilling rig;
- 3. The minimum amount of surface pipe as specified below shall be set by circulating cement to the top; in all cases surface pipe shall be set through all unconsolidated materials plus a minimum of 20 feet into the underlying formation.
- 4. If the well is dry hole, an agreement between the operator and the district office on plug length and placement is necessary prior to plugging;
- 5. The appropriate district office will be notified before well is either plugged or production casing is cemented in;
- 6. If an ALTERNATE II COMPLETION, production pipe shall be cemented from below any usable water to surface within 120 DAYS of spud date. Or pursuant to Appendix "B" - Eastern Kansas surface casing order #133,891-C, which applies to the KCC District 3 area, alternate II cementing must be completed within 30 days of the spud date or the well shall be plugged. In all cases, NOTIFY district office prior to any cementing.

Submitted Electronically

For KCC Use ONLY
API # 15-001-29976-00-00
Conductor pipe required 0 feet
Minimum surface pipe required 20 feet per ALT. I II
Approved by: Rick Hestermann 02/05/2010 / KCC-2-2012
This authorization expires: 02/05/2011
(This authorization void if drilling not started within 12 months of approval date.)
Spud date: Agent:

Remember to:
- File Drill Pit Application (form CDP-1) with Intent to Drill;
- File Completion Form ACO-1 within 120 days of spud date;
- File acreage attribution plat according to field proration orders;
- Notify appropriate district office 48 hours prior to workover or re-entry;
- Submit plugging report (CP-4) after plugging is completed (within 60 days);
- Obtain written approval before disposing or injecting salt water.
- If this permit has expired (See: authorized expiration date) please check the box below and return to the address below.
 Well Not Drilled - Permit Expired Date: Signature of Operator or Agent:

7
24
18
 E
 W



1034518

* Range
CORRECTED

IN ALL CASES PLOT THE INTENDED WELL ON THE PLAT BELOW

Plat of acreage attributable to a well in a prorated or spaced field

If the intended well is in a prorated or spaced field, please fully complete this side of the form. If the intended well is in a prorated or spaced field complete the plat below showing that the well will be properly located in relationship to other wells producing from the common source of supply. Please show all the wells and within 1 mile of the boundaries of the proposed acreage attribution unit for gas wells and within 1/2 mile of the boundaries of the proposed acreage attribution unit for oil wells.

API No. 15 - 15-001-29976-00-00

Operator: Wrestler, David L., a General Partnership

Lease: korte farms

Well Number: 8

Field: _____

Number of Acres attributable to well: _____

QTR/QTR/QTR/QTR of acreage: NW - SW - NW - SW

Location of Well: County: Allen

1,979 feet from N / S Line of Section

165 feet from E / W Line of Section

Sec. 7 Twp. 24 S. R. 10 E W

Is Section: Regular or Irregular

If Section is Irregular, locate well from nearest corner boundary.

Section corner used: NE NW SE SW

PLAT

(Show location of the well and shade attributable acreage for prorated or spaced wells.)

(Show footage to the nearest lease or unit boundary line.)

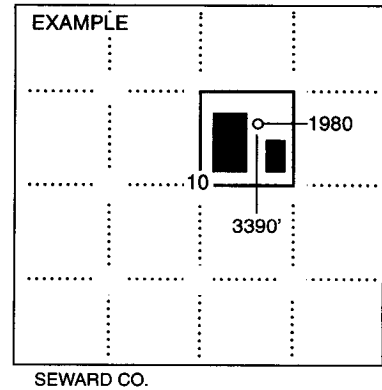
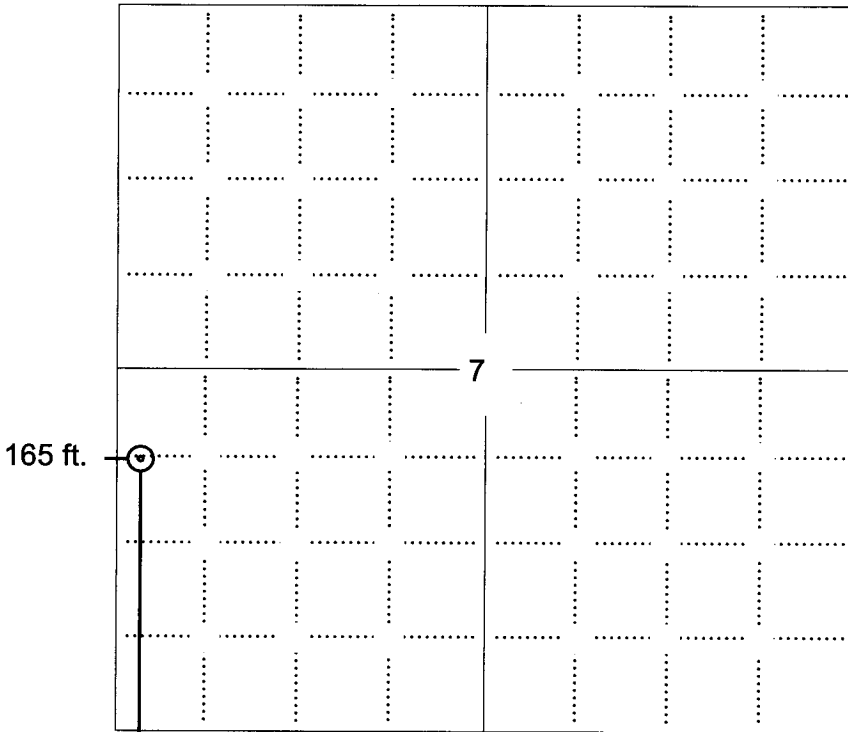

NOTE: In all cases locate the spot of the proposed drilling locaton.

1979 ft.

In plotting the proposed location of the well, you must show:

1. The manner in which you are using the depicted plat by identifying section lines, i.e. 1 section, 1 section with 8 surrounding sections, 4 sections, etc.
2. The distance of the proposed drilling location from the south / north and east / west outside section lines.
3. The distance to the nearest lease or unit boundary line (in footage).
4. If proposed location is located within a prorated or spaced field a certificate of acreage attribution plat must be attached: (CO-7 for oil wells; CG-8 for gas wells).



KANSAS CORPORATION COMMISSION 1034518
 OIL & GAS CONSERVATION DIVISION

Form CDP-1
 April 2004
 Form must be Typed

APPLICATION FOR SURFACE PIT

* *Ramse*
CORRECTED

Submit in Duplicate

Operator Name: Wrestler, David L., a General Partnership		License Number: 7160	
Operator Address: 1776 GEORGIA RD		HUMBOLDT KS 66748	
Contact Person: David Wrestler		Phone Number: 620-473-2324	
Lease Name & Well No.: korte farms 8		Pit Location (QQQQ): NW SW NW SW Sec. <u>7</u> Twp. <u>24</u> R. <u>18 19</u> <input checked="" type="checkbox"/> East <input type="checkbox"/> West <u>1,979</u> Feet from <input type="checkbox"/> North / <input checked="" type="checkbox"/> South Line of Section <u>165</u> Feet from <input type="checkbox"/> East / <input checked="" type="checkbox"/> West Line of Section Allen County	
Type of Pit: <input type="checkbox"/> Emergency Pit <input type="checkbox"/> Burn Pit <input type="checkbox"/> Settling Pit <input checked="" type="checkbox"/> Drilling Pit <input type="checkbox"/> Workover Pit <input type="checkbox"/> Haul-Off Pit <small>(If WP Supply API No. or Year Drilled)</small>		Pit is: <input checked="" type="checkbox"/> Proposed <input type="checkbox"/> Existing If Existing, date constructed: _____ Pit capacity: <u>160</u> (bbls)	
Is the pit located in a Sensitive Ground Water Area? <input checked="" type="checkbox"/> Yes <input type="checkbox"/> No		Chloride concentration: _____ mg/l <small>(For Emergency Pits and Settling Pits only)</small>	
Is the bottom below ground level? <input checked="" type="checkbox"/> Yes <input type="checkbox"/> No		Artificial Liner? <input type="checkbox"/> Yes <input checked="" type="checkbox"/> No	
		How is the pit lined if a plastic liner is not used? Clay Bottom	
Pit dimensions (all but working pits): <u>40</u> Length (feet) <u>8</u> Width (feet) <input type="checkbox"/> N/A: Steel Pits		Depth from ground level to deepest point: <u>3</u> (feet) <input type="checkbox"/> No Pit	
If the pit is lined give a brief description of the liner material, thickness and installation procedure.		Describe procedures for periodic maintenance and determining liner integrity, including any special monitoring.	
Distance to nearest water well within one-mile of pit <u>4136</u> feet Depth of water well <u>10</u> feet		Depth to shallowest fresh water <u>5</u> feet. Source of information: <input type="checkbox"/> measured <input type="checkbox"/> well owner <input type="checkbox"/> electric log <input checked="" type="checkbox"/> KDWR	
Emergency, Settling and Burn Pits ONLY: Producing Formation: _____ Number of producing wells on lease: _____ Barrels of fluid produced daily: _____ Does the slope from the tank battery allow all spilled fluids to flow into the pit? <input type="checkbox"/> Yes <input type="checkbox"/> No		Drilling, Workover and Haul-Off Pits ONLY: Type of material utilized in drilling/workover: <u>Fresh Water</u> Number of working pits to be utilized: <u>1</u> Abandonment procedure: <u>remove fluid Air Dry Backfill</u> Drill pits must be closed within 365 days of spud date.	
Submitted Electronically			

KCC OFFICE USE ONLY		Steel Pit <input type="checkbox"/>	RFAC <input checked="" type="checkbox"/>	RFAS <input type="checkbox"/>
Date Received: <u>02/04/2010</u>	Permit Number: <u>15-001-29976-00-00</u>	Permit Date: <u>02/05/2010</u>	Lease Inspection: <input checked="" type="checkbox"/> Yes <input type="checkbox"/> No	

Mail to: KCC - Conservation Division, 130 S. Market - Room 2078, Wichita, Kansas 67202



Mark Parkinson, Governor
Thomas E. Wright, Chairman
Joseph F. Harkins, Commissioner

February 05, 2010

David Wrestler
Wrestler, David L., a General Partnership
1776 GEORGIA RD
HUMBOLDT, KS 66748-1500

** Range*
CORRECTED

Re: Drilling Pit Application
korte farms 8 *
SW/4 Sec.07-24S-18E 19E
Allen County, Kansas

Dear David Wrestler:

District staff has inspected the above referenced location and has determined that the reserve pit shall be constructed **without slots**, the bottom shall be flat and reasonably level, and the free fluids must be removed. The fluids are to be removed from the reserve pit as soon as practical after drilling operations have ceased.

If production casing is set all completion fluids shall be removed from the working pits daily. NO completion fluids or non-exempt wastes shall be placed in the reserve pit.

The fluids should be taken to an authorized disposal well. Please call the District Office at (620) 432-2300 when the fluids have been removed. Please file form CDP-5 (August 2008), Exploration and Production Waste Transfer, through SOLAR within 30 days of fluid removal.

A copy of this letter should be posted in the doghouse along with the approved Intent to Drill. If you have any questions or concerns please feel free to contact the District Office at (620) 432-2300.