

EFFECTIVE DATE: 7-3-95
DISTRICT # 1
SSAT? Yes No

State of Kansas
NOTICE OF INTENTION TO DRILL

FORM MUST BE TYPED
FORM MUST BE SIGNED
ALL BLANKS MUST BE FILLED

Must be approved by the K.C.C. five (5) days prior to commencing well

Expected Spud Date July 1, 1995
month day year

Spot Approx.
S/2 NE NE Sec 24 Twp 17 S. Rg 25 East West

OPERATOR: License # 5097
Name: Martin Oil Producers, Inc.
Address: 150 N. Main, #1010
City/State/Zip: Wichita, KS 67202
Contact Person: Joe Moreland
Phone: (316) 264-0352

4275 feet from South North line of Section
630 feet from East West line of Section
IS SECTION X REGULAR IRREGULAR

CONTRACTOR: License #: 5418
Name: Allen Drilling Co.

(NOTE: Locate well on the Section Plat on Reverse Side)
County: Ness
Lease Name: Potter Well #: 3A
Field Name: Aldrich NE

Well Drilled For: Well Class: Type Equipment:
X Oil ... Enh Rec X Infield X Mud Rotary
Gas ... Storage ... Pool Ext. ... Air Rotary
OUWO ... Disposal ... Wildcat ... Cable
Seismic; ... # of Holes ... Other
Other

Is this a Prorated/Spaced Field? ... yes X no
Target Formation(s): Mississippian
Nearest lease or unit boundary: 630
Ground Surface Elevation: 2402 feet MSL

If OUWO: old well information as follows:
Operator: _____
Well Name: _____
Comp. Date: _____ Old Total Depth _____

Water well within one-quarter mile: ... yes X no
Public water supply well within one mile: ... yes X no
Depth to bottom of fresh water: 75 180
Depth to bottom of usable water: 1100 1,000

Directional, Deviated or Horizontal wellbore? ... yes X no
If yes, true vertical depth: _____
Bottom Hole Location: _____

Surface Pipe by Alternate: 1 X 320
Length of Surface Pipe Planned to be set: 0
Length of Conductor pipe required: _____
Projected Total Depth: 4500

Formation at Total Depth: Mississippian
Water Source for Drilling Operations:
... well X farm pond ... other

DWR Permit #: _____
Will Cores Be Taken?: ... yes X no
If yes, proposed zone: _____

AFFIDAVIT

RECEIVED
KANSAS CORPORATION COMMISSION
JUN 28 1995

The undersigned hereby affirms that the drilling, completion and eventual plugging of this well will comply with K.S.A. 55-101, et. seq.
It is agreed that the following minimum requirements will be met:

1. Notify the appropriate district office prior to spudding of well;
2. A copy of the approved notice of intent to drill shall be posted on each drilling rig;
3. The minimum amount of surface pipe as specified below shall be set by circulating cement to the top; in all cases surface pipe shall be set through all unconsolidated materials plus a minimum of 20 feet into the underlying formation;
4. If the well is dry hole, an agreement between the operator and the district office on plug length and placement is necessary prior to plugging;
5. The appropriate district office will be notified before well is either plugged or production casing is cemented in;
6. IF AN ALTERNATE II COMPLETION, PRODUCTION PIPE SHALL BE CEMENTED FROM BELOW ANY USABLE WATER TO SURFACE WITHIN 120 DAYS OF SPUD DATE. IN ALL CASES, NOTIFY DISTRICT OFFICE PRIOR TO ANY CEMENTING.

I hereby certify that the statements made herein are true and to the best of my knowledge and belief.
Date: 6/28/95 Signature of Operator or Agent: Joseph E. Moreland Jr. Title: Geologist

FOR KCC USE:
API # 15- 135-238930000
Conductor pipe required NONE feet
Minimum surface pipe required 200 feet per Alt. X (2)
Approved by: JK 6-28-95
This authorization expires: 12-28-95
(This authorization void if drilling not started within 6 months of effective date.)
Spud date: _____ Agent: _____

REMEMBER TO:

- File Drill Pit Application (form CDP-1) with Intent to Drill;
- File Completion Form ACO-1 within 120 days of spud date;
- File acreage attribution plat according to field proration orders;
- Notify appropriate district office 48 hours prior to workover or re-entry;
- Submit plugging report (CP-4) after plugging is completed;
- Obtain written approval before disposing or injecting salt water.

Mail to: Conservation Division, 200 Colorado Derby Building, 202 W. First St., Wichita, Kansas 67202-1286.

24
17
2500

IN ALL CASES PLOT THE INTENDED WELL ON THE PLAT BELOW
PLAT OF ACREAGE ATTRIBUTABLE TO A WELL IN A PRORATED OR SPACED FIELD

If the intended well is in a prorated or spaced field, please fully complete this side of the form. If the intended well is in a prorated or spaced field complete the plat below showing that the well will be properly located in relationship to other wells producing from the common source of supply. Please show all the wells within 1 mile of the boundaries of the proposed acreage attribution unit for gas wells and within 1/2 mile of the boundaries of the proposed acreage attribution unit for oil wells.

API NO. 15- _____
 OPERATOR Martin Oil Producers, Inc. LOCATION OF WELL: COUNTY Ness
 LEASE Potter 4275 feet from south/north line of section
 WELL NUMBER 3A 630 feet from east/west line of section
 FIELD Aldrich NE SECTION 24 TWP 17S RG 25W

NUMBER OF ACRES ATTRIBUTABLE TO WELL _____ IS SECTION X REGULAR or _____ IRREGULAR
 QTR/QTR/QTR OF ACREAGE _____ IF SECTION IS IRREGULAR, LOCATE WELL FROM NEAREST CORNER BOUNDARY.
 Section corner used: _____ NE _____ NW _____ SE _____ SW

PLAT

(Show location of the well and shade attributable acreage for prorated or spaced wells.)
 (Show footage to the nearest lease or unit boundary line.)

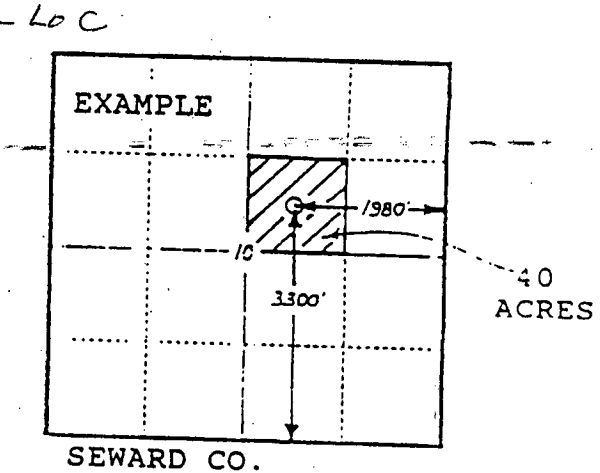
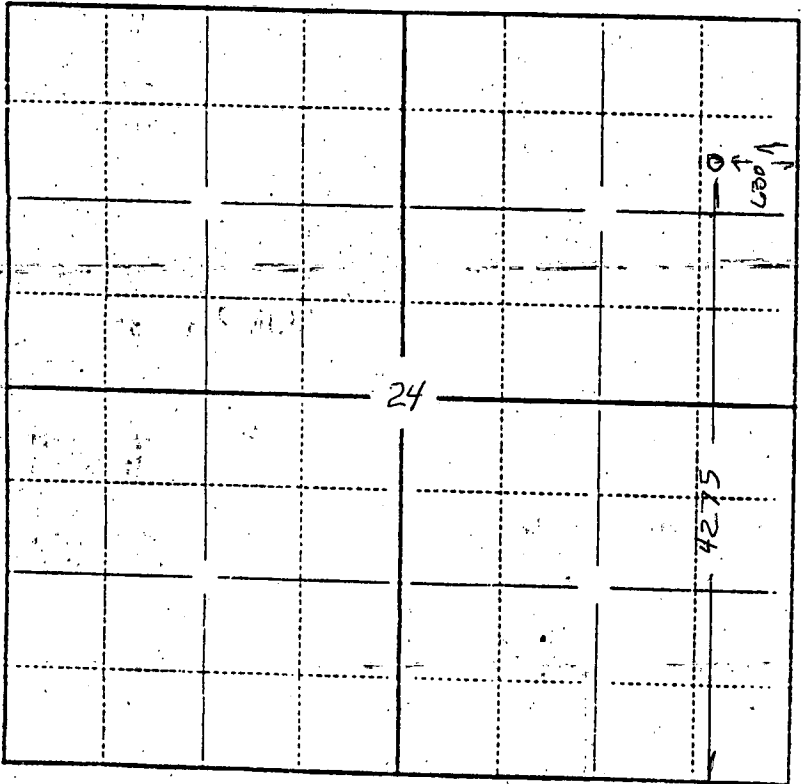

In plotting the proposed location of the well, you must show:

- 1) The manner in which you are using the depicted plat by identifying section lines, i.e. 1 section, 1 section with 8 surrounding sections, 4 sections, etc.;
- 2) the distance of the proposed drilling location from the section's south/north and east/west lines; and
- 3) the distance to the nearest lease or unit boundary line.