

TYPE

AFFIDAVIT OF COMPLETION FOI

ACO-1 WELL HISTORY

Compt. \_\_\_\_\_

SIDE ONE

(Rules 82-3-130 and 82-3-107)

This form shall be filed with the Kansas Corporation Commission, 200 Colorado Derby Building, Wichita, Kansas 67202, within ninety (90) days after the completion of a well, regardless of how the well was completed.

FOR INFORMATION REGARDING THE NUMBER OF COPIES TO BE FILED AND APPLICATIONS REQUIRING COPIES OF ACO-1 FORMS SEE PAGE TWO (2), SIDE TWO (2) OF THIS FORM.

F \_\_\_\_\_ Letter requesting confidentiality attached.

C \_\_\_\_\_ Attach ONE COPY of EACH wireline log run (i.e. electrical log, sonic log, gamma ray neutron log etc.)\*\*\*Check here if NO logs were run .

PLEASE FILL IN ALL INFORMATION. IF NOT AVAILABLE, INDICATE. IF INFORMATION LATER BECOMES AVAILABLE, SUBMIT BY LETTER.

LICENSE # 5923 EXPIRATION DATE JUNE 1985

OPERATOR American Petroleum Co., Inc. API NO. 15-135-22,567-0000

ADDRESS 400 N. Woodlawn, Suite 111 COUNTY Ness

Wichita, Kansas 67208 FIELD UNNAMED

\*\* CONTACT PERSON James Barvais PROD. FORMATION NOT APPLICABLE

PHONE 316-684-5273

PURCHASER \_\_\_\_\_ LEASE Ouenzer "A"

ADDRESS \_\_\_\_\_ WELL NO. #1

WELL LOCATION NW 1/4

DRILLING CONTRACTOR Pioneer Drilling Company, Inc. 660 Ft. from N Line and

ADDRESS 308 West Mill 990 Ft. from W Line of ~~XXX~~

Plainville, Kansas 67663 the NW (Qtr.) SEC 13 TWP 17 RGE 26 (W).

PLUGGING CONTRACTOR Pioneer Drilling Company, Inc. (John Walker) WELL PLAT \_\_\_\_\_ (Office Use Only)

ADDRESS 308 West Mill

Plainville, Kansas 67663

TOTAL DEPTH 4512' PBD \_\_\_\_\_

SPUD DATE 4-26-84 DATE COMPLETED 5-06-84

ELEV: GR 2533' DF 2536' KB 2538'

DRILLED WITH ~~(CABLE)~~ (ROTARY) ~~(AIR)~~ TOOLS.

DOCKET NO. OF DISPOSAL OR REPRESSURING WELL BEING USED TO DISPOSE OF WATER FROM THIS LEASE \_\_\_\_\_

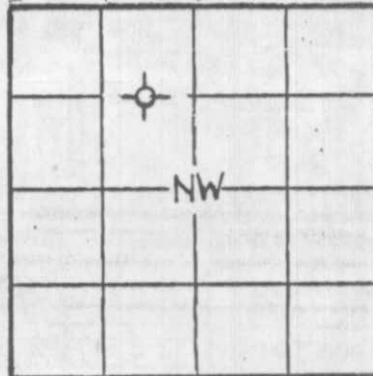

KCC   
KGS   
SWD/REP \_\_\_\_\_  
PLG. \_\_\_\_\_  
NGPA \_\_\_\_\_

Amount of surface pipe set and cemented 8 5/8" @ 329.27 Tool Used? \_\_\_\_\_

TYPE OF COMPLETION THIS AFFIDAVIT APPLIES TO: (Circle ONE) - Oil, Shut-in Gas, Gas, Dry, Disposal, Injection, Temporarily Abandoned. If OWWO, indicate type of re-completion \_\_\_\_\_. Other completion \_\_\_\_\_. NGPA filing \_\_\_\_\_.

ALL REQUIREMENTS OF THE STATUTES, RULES AND REGULATIONS PROMULGATED TO REGULATE THE OIL AND GAS INDUSTRY HAVE BEEN FULLY COMPLIED WITH.

A F F I D A V I T

JAMES T. BARVAIS, being of lawful age, hereby certifies that:

I am the Affiant, and I am familiar with the contents of the foregoing Affidavit. The statements and allegations contained therein are true and correct.

James Barvais  
(Name)

SUBSCRIBED AND SWORN TO BEFORE ME this 14th day of MAY,



Peggy Bennett  
(NOTARY PUBLIC)  
PEGGY BENNETT

\*\* The person who can be reached by phone regarding any questions concerning this information.

RECEIVED  
STATE CORPORATION COMMISSION  
MAY 21 1984  
CONSERVATION DIVISION  
Wichita, Kansas

SIDE TWO

ACO-1 WELL HISTORY XXXXX

OPERATOR American Petroleum Co. Inc. LEASE Ouenzer "A" SEC. 13 TWP. 17 RGE. 26 (W)

FILL IN WELL INFORMATION AS REQUIRED:

WELL NO. #1

Show all important zones of porosity and contents thereof; cored intervals, and all drill-stem tests, including depth interval tested, cushion used, time tool open, flowing and shut-in pressures, and recoveries.

SHOW GEOLOGICAL MARKERS, LOGS RUN, OR OTHER DESCRIPTIVE INFORMATION.

FORMATION DESCRIPTION, CONTENTS, ETC.	TOP	BOTTOM	NAME	DEPTH
Check if no Drill Stem Tests Run.				
XX Check if samples sent to Geological Survey				
sand and shale	0'	40'	ANHYDRITE	1876 ( +662)
sand and shale	40'	330'	BASE ANHYDRITE	1914 ( +624)
shales and sand	330'	1125'	HEEBNER	3824 ( -1286)
shale and sand	1125'	1898'	TORONTO	3844 ( -1306)
anhydrite	1898'	1908'	LKC	3863 ( -1325)
shale	1908'	2135'	BASE KC	4181 ( -1643)
shales	2135'	2190'	PAWNEE	4270 ( -1732)
shales	2190'	2519'	MISS.	4464 ( -1926)
shale and lime	2519'	2525'	RTD	4512 ( -1974)
shale and lime	2525'	2765'		
shale and lime	2765'	2850'		
lime and shale	2850'	2859'		
lime and shale	2859'	2993'		
lime and shale	2993'	3140'		
lime and shale	3140'	3261'		
lime and shale	3261'	3345'		
lime and shale	3345'	3432'		
lime and shale	3432'	3621'		
lime and shale	3621'	3755'		
lime and shale	3755'	3880'		
lime and shale	3880'	4006'		
lime and shale	4006'	4090'		
lime and shale	4090'	4185'		
lime and shale	4185'	4269'		
lime and shale	4269'	4331'		
lime and shale	4331'	4400'		
lime and shale	4400'	4463'		
miss	4463'	4493'		
miss	4493'	4512'		
	4512'	R.T.D.		

DST #1 (4388-4463) 30-60-30-60  
 10' DRILLING MUD WITH  
 TRACE OF OIL. IFP 39-39#  
 FFP 39-39#. ISIP 338,  
 FSIP 99#.

DST #2 (4501-4512) 90-60-30-60  
 100' WATERY MUD.  
 IFP & FFP 29#.  
 ISIP 189# & FSIP 159#

If additional space is needed use Page 2,

Report of all strings set— surface, intermediate, production, etc. CASING RECORD (New) or ~~Used~~

Purpose of string	Size hole drilled	Size casing set (in O.D.)	Weight lbs/ft.	Setting depth	Type cement	Socks	Type and percent additives
Surface Casing	12 1/4"	8 5/8"	20#	329.27'	60-40pos	190	2%gel 3%cc

LINER RECORD

PERFORATION RECORD

Top, ft.	Bottom, ft.	Socks cement	Shots per ft.	Size & type	Depth interval

Size	Setting depth	Pecker set at

ACID, FRACTURE, SHOT, CEMENT SQUEEZE RECORD

Amount and kind of material used	Depth interval treated

Date of first production	Producing method (flowing, pumping, gas lift, etc.)	Gravity
Estimated Production -I.P.	Oil bbls.	Gas MCF
Disposition of gas (vented, used on lease or sold)	Water %	Gas-oil ratio bbls. CFPB
	Perforations	