

STATE OF KANSAS
STATE CORPORATION COMMISSION
Give All Information Completely
Make Required Affidavit
Mail or Deliver Report to:
Conservation Division
State Corporation Commission
211 No. Broadway
Wichita, Kansas

WELL PLUGGING RECORD

Lane _____ County. Sec. 10 Twp. 16S Rge. 27W (E) _____ (W)
Location as "NE/CNW/SW" or footage from lines C SE NE
Lease Owner Sioux Petroleum Co.
Lease Name Mendenhall Well No. 1
Office Address 38 Robertson Road, Pueblo, Colorado
Character of Well (completed as Oil, Gas or Dry Hole) Dry Hole
Date well completed 6-25-65 19____
Application for plugging filed 6-25-65 19____
Application for plugging approved 6-25-65 19____
Plugging commenced 6-25-65 19____
Plugging completed 6-25-65 19____
Reason for abandonment of well or producing formation Dry Hole

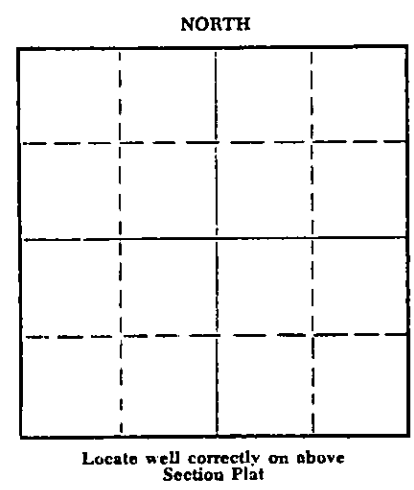

If a producing well is abandoned, date of last production _____ 19____
Was permission obtained from the Conservation Division or its agents before plugging was commenced? yes

Name of Conservation Agent who supervised plugging of this well Mr. Hollis for W. L. Nichols, Moreland, Ks.
Producing formation _____ Depth to top _____ Bottom _____ Total Depth of Well 4426 Feet
Show depth and thickness of all water, oil and gas formations.

OIL, GAS OR WATER RECORDS				CASING RECORD		
FORMATION	CONTENT	FROM	TO	SIZE	PUT IN	PULLED OUT
				8 5/8"	109'	none

Describe in detail the manner in which the well was plugged, indicating where the mud fluid was placed and the method or methods used in introducing it into the hole. If cement or other plugs were used, state the character of same and depth placed, from _____ feet to _____ feet for each plug set.

Mud to 550' Plug $\frac{1}{2}$ sk. hulls 25 sks. cement through drill pipe
Mud to 105' Plug $\frac{1}{2}$ sk. hulls 20 sks. cement
Mud to 40' Plug $\frac{1}{2}$ sk. hulls 10 sks. cement
2 sks. in rathole

RECORDED
7-1-65
CONSERVATION DIVISION
Wichita, Kansas

(If additional description is necessary, use BACK of this sheet)
Name of Plugging Contractor Leben Drilling, Inc.
Address Box 486, Great Bend, Kansas

STATE OF KANSAS, COUNTY OF BARTON, ss.
Leslie Kite (employee of owner) or (owner or operator) of the above-described well, being first duly sworn on oath, says: That I have knowledge of the facts, statements, and matters herein contained and the log of the above-described well as filed and that the same are true and correct. So help me God.

(Signature) Leslie Kite
P. O. Box 486, Great Bend, Kansas
(Address)

SUBSCRIBED AND SWORN TO before me this 29th day of June, 19 65
Wanda D. ...
My commission expires April 1, 1967
Notary Public.

15-101-30001-00-00

DRILLER'S LOG

COMPANY: Sioux Petroleum Company
 CONTRACTOR: LEBEN DRILLING, INC.
 FARM: MENDENHALL #1
 LOCATION: C SE NE Sec. 10-16S-27W
 LANE COUNTY, KANSAS
 COMMENCED: 6-15-65
 COMPLETED: 6-25-65

0	100	Post Rock & Shale
100	1100	Shells
1100	1485	Shale & Shells
1485	1675	Sand
1675	1932	Shale & Sand
1932	1968	Anhydrite
1968	2600	Shale
2600	3070	Shale & Lime
3070	3425	Lime & Shale
3425	3770	Lime
3770	3840	Lime & Shale
3840	4426	Lime
	<u>4426</u>	<u>RTD - D. & A.</u>

Set 8 5/8" used surface casing @ 109' with 125 sacks 60-40 Posmix Sunset 2% Gel

I, Leslie Kite, do hereby certify that the above and foregoing is a true and correct copy of the log of the Mendenhall #1 well, located C SE NE of Section 10, Township 16 South, Range 27 West, Lane County, Kansas, as reflected by the files of Leben Drilling, Inc.

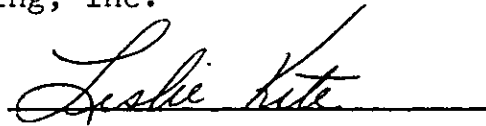

Leslie Kite

STATE OF KANSAS)
) SS
 COUNTY OF BARTON)

Subscribed and sworn to before me, a Notary Public, in and for Barton County, Kansas, this 29th day of June, 1965.

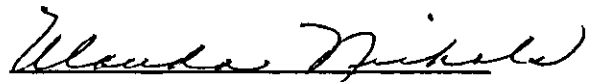

Ulanda Nichols

My Commission Expires:
 April 1, 1967

NOTARY PUBLIC
 ULANDA NICHOLS
 JUN 29 1965
 BARTON COUNTY, KANSAS