

WELL PLUGGING RECORD

Give All Information Completely  
Make Required Affidavit  
Mail or Deliver Report to:  
Conservation Division  
State Corporation Commission  
800 Biting Building  
Wichita, Kansas

OR  
FORMATION PLUGGING RECORD

Strike out upper line  
when reporting plug-  
ging off formations.

NORTH

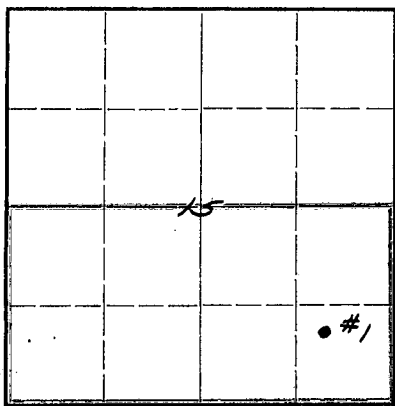

Locate well correctly on above  
Section Plat

Ness County. Sec. 15 Twp. 17S Rge. (E) 26 (W)  
Location as "NE $\frac{1}{4}$ NW $\frac{1}{4}$ SW $\frac{1}{4}$ " or footage from lines NW $\frac{1}{4}$  SE $\frac{1}{4}$  SE $\frac{1}{4}$   
Lease Owner. Skelly Oil Company  
Lease Name. J. W. Nuss Well No. 1  
Office Address. 210-11 Wolcott Building  
Character of Well (completed as Oil, Gas or Dry Hole) Dry Hole  
Date well completed. January 3 19. 45  
Application for plugging filed. January 5 19. 45  
Application for plugging approved. January 10 19. 45  
Plugging commenced. January 6 19. 45  
Plugging completed. January 28 19. 45  
Reason for abandonment of well or producing formation Dry Hole

If a producing well is abandoned, date of last production. 19.  
Was permission obtained from the Conservation Division or its agents before plugging was com-  
menced? Yes

Name of Conservation Agent who supervised plugging of this well. H. W. Kerr  
Producing formation. Depth to top. Bottom. Total Depth of Well. 4622 Feet  
Show depth and thickness of all water, oil and gas formations.

OIL, GAS OR WATER RECORDS

CASING RECORD

Formation	Content	From	To	Size	Put In	Pulled Out
Lansing Lime	Dry	3878		10-3/4" OD	1279' 0"	None
Marmeton Lime	Dry	4368'		7" OD	4490' 3"	1329' 1"
Conglomerate	Water	4425'		5 1/2" OD	4542' 7"	4498' 7"
Mississippi Lime	Sli. Sat.	4453'				

Describe in detail the manner in which the well was plugged, indicating where the mud fluid was placed and the method or methods used in introducing it into the hold. If cement or other plugs were used, state the character of same and depth placed, from feet to feet for each plug set.

75 Sacks of cement 4622' to 4447'  
16 Sacks of cement 4447' to 4382'  
Mud laden fluid 4382' to 1180'  
Wood plug and crushed rock 1180' to 1158'  
15 sacks of cement 1158' to 1128'  
Mud laden fluid 1128' to 65'  
Wood plug at 65'  
Rock and soil 65' to 40'  
23 sacks of cement 40' to 15'  
Surface soil and rock 15' to 0.

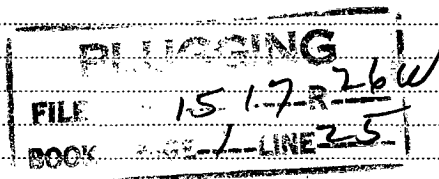

(If additional description is necessary, use BACK of this sheet)

Correspondence regarding this well should be addressed to Skelly Oil Company  
Address. Box 391, Hutchinson, Kansas

STATE OF KANSAS, COUNTY OF RENO, ss.  
H. E. Wamsley (employee of owner) or representative of the above-described well,

being first duly sworn on oath, says: That I have knowledge of the facts, statements, and matters herein contained and the log of the above-described well as filed and that the same are true and correct. So help me God.

(Signature)

Box 391, Hutchinson, Kansas

(Address)

MAR 28 1945 03-28-45

19. 45

SUBSCRIBED AND SWORN TO before me this 27th day of March

My commission expires August 4, 1945.

Notary Public.

15-135-00545-00-00

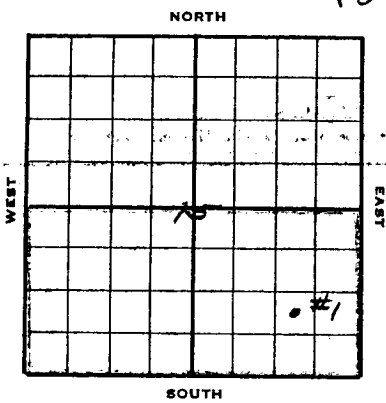

# SKELLY OIL COMPANY

## Well Record

Lease Name and No. J. W. Russ 26135 Well No. 1 Elev. 2497'  
 Lease Description 3/2 section 15-17-26,  
Ross County, Kansas  
 Location made September 24 1944 by Russell County Engineer  
 feet from North line 990 feet from East line 3/2  
990 feet from South line feet from West line of 380.15

Work com'd. Sept. 26 1944 Rig comp'd. Oct. 7 1944 Drlg. com'd. Oct. 8 1944 Drlg. comp'd. Nov. 19 1944  
 Rig Contractor Hodine Drilling Company  
 Drilling Contractor Hodine Drilling Company, Great Bend, Kansas  
 Rotary Drilling from Top to 4457' Cable Tool Drilling from 4457' to 4622'

Commenced Producing DRY HOLE 19      Initial Prod. before shot or acid      Bbls.  
 Initial Prod. after shot or acid DRY HOLE Bbls.  
 Dry Gas Well Press      Volume      Cu. ft.  
 Casing Head Gas Pressure      Volume      Cu. ft.  
 Braden Head (      Size ) Gas Pressure      Volume      Cu. ft.  
 Braden Head (      Size ) Gas Pressure      Volume      Cu. ft.

PRODUCING FORMATION DRY HOLE (Name) Top      Bottom      TOTAL DEPTH 4622'

### CASING RECORD

Size	Wt.	Thds.	Where Set	PULLED OUT			LEFT IN			KIND	Cond'n	CEMENTING	
				Jts.	Feet	In.	Jts.	Feet	In.			Sacks Used	Method Employed
10-3/4" OD 29 PE			1277'				32	1279	0	Arco	A	600	Halliburton
7" OD 22 20/10			4454'	43	1329	1	102	3161	2	R2 GF	A	175	Halliburton
5 1/2" OD			17/8R		105	4498	7	1	44	R3 J55	A		
(10-3/4" casing set 6' in cellar)													
7" casing perforated with 10 holes by Lane-bells from 4420' to 4425'													
(Used 1 - 5 1/2" Larkin Combination Guide and Float Shoe)													

Liner Set at      Length      Perforated at       
 Liner Set at      Length      Perforated at       
 Packer Set at      Size and Kind       
 Packer Set at      Size and Kind     

### SHOT OR ACID TREATMENT RECORD

	FIRST	SECOND	THIRD	FOURTH
Date	<u>November 11, 1944</u>			
Acid Used	<u>500</u> Gals.			
Shot Between	<u>4454 Ft. and 4460 Ft.</u>	<u>    </u> Ft. and <u>    </u> Ft.	<u>    </u> Ft. and <u>    </u> Ft.	<u>    </u> Ft. and <u>    </u> Ft.
Size of Shell				
Put in by (Co.)	<u>Dowell, Inc.</u>			
Length anchor				
Distance below Cas'g				
Damage to Casing or Casing Shoulder	<u>None</u>			

### SIGNIFICANT GEOLOGICAL FORMATIONS

NAME	Top	Bottom	GAS		OIL		REMARKS
			From	To	From	To	
Lansing Linc	<u>3878'</u>						
Marston Linc	<u>4368'</u>						
Conglomerate	<u>4425'</u>						
Mississippi Linc	<u>4453'</u>				<u>4453'</u>	<u>4457'</u>	<u>oil saturation</u>
					<u>4457'</u>	<u>4460'</u>	<u>tested 1 1/2 bbls. water, 2 gallons oil per in. plugged and abandoned, January 23, 1945.</u>

### CLEANING OUT RECORDS

	DATE COMMENCED	DATE COMPLETED	PROD. BEFORE	PROD. AFTER	REMARKS
1st					See Reverse for other details.
2nd					" " " " "
3rd					" " " " "
4th					" " " " "

### PLUGGING BACK AND DEEPENING RECORDS

	Date Commenced	Date Completed	No. Feet Plugged Back or Deepened	Prod. Before	Prod. After	REMARKS
1st						See Reverse for other details.
2nd						" " " " "
3rd						" " " " "
4th						" " " " "

(See Reverse for Record of Formation)

# RECORD OF FORMATIONS

FORMATION	TOP	BOTTOM	REMARKS
Surface soil and sand	0	30	
Shale and shells	30	260	
Blue shale	260	415	
Shale	415	830	
Sandy lime	830	930	
Lime and shale	930	1015	
Red bed	1015	1130	
Sand	1130	1205	
Red bed	1205	1264	
Anhydrite	1264	1277	
Red bed and shale	1277	1660	
Red bed and sand	1660	1900	
Red bed, sand & shale	1900	2020	
Shale and lime	2020	2100	
Salt and shells	2100	2250	
Shale and shells	2250	2385	
Lime	2385	2460	
Lime and shale	2460	2530	
Shale	2530	2675	
Lime	2675	2810	
Sandy lime	2810	2925	
Lime	2925	3125	
Shale and lime	3125	3225	
Lime	3225	3305	
Shale and lime	3305	3410	
Lime	3410	3798	
Shale	3798	3845	
Lime	3845	4055	
Cherty lime	4055	4061	
Lime	4061	4090	
Cherty lime	4090	4165	
Lime	4165	4215	
Lime and chert	4215	4275	
Lime and shale	4275	4320	
Shale	4320	4365	
Shale and lime	4365	4395	
Lime	4395	4415	
Shale	4415	4430	
Sand and cherty lime	4430	4440	
Sand chert conglomerate	4440	4458	
Brown porous dolomite	4458	4458	

Set and cemented 10-3/4" OD, 29#, Armac spiral weld steel casing at 1277' with 600 sacks of cement and 6 sacks of aquagel.

**TOP LANSING LIME 3878'**

**TOP MARION LIME 4368'**

**TOP CONGLOMERATE 4425' SLM**

**TOP MISSISSIPPI LIME 4453' SLM**

Slight oil saturation  
 Set and cemented 7" OD, 20#, 10v thd., Grade 7, Range 2, second-hand, R.E.W. steel casing at 4454' SLM with 175 sacks of cement and 8 sacks of aquagel. Finished cementing at 9:45 AM November 2, 1944, and while shut down waiting on cement to set, moved in and rigged up cable tools. Finished rigging up and bailed the hole dry on November 9, 1944, and 7" casing tested OK. Drilled cement plug and cleaned out to bottom and cement job tested OK. Correction: 4462' SLM rotary table equals 4457' SLM derrick floor. Tested 24 hours, 1 bbl. water, no oil, per hour.  
 Tested 1 1/2 barrels water and 2 gallons oil per hour.

On November 11th, ran 2" tubing and treated with 500 gallons of Dowell acid as follows:

**ACID TREATMENT NO. 1 - Between 4454' and 4460'**  
 Treatment put in November 11, 1944, by Dowell Acid Company, using 500 gallons acid and 17 1/2 barrels of water to flush hole:

TIME	SP	FP	REMARKS
9:05 PM	800	800	Hole filled with water, pressured up
9:20 PM	0	0	started acid in hole
9:26 PM	125	0	300 gallons acid in hole and started water flush
10:00 PM	1100	925	8 1/2 barrels water in
10:20 PM	900	850	10 1/2 barrels water in
10:30 PM	600	600	17 1/2 barrels water in and treatment complete

After acid treatment ran rods and FOB 20 hours, 145 barrels water and no oil. On November 13th FOB 4 hours, 10 barrels of water and no oil. Pulled rods and tubing and drilled deeper as follows:

Lime	4460	4500	
Lime and chert	4500	4575	
Sandy lime	4575	4622	Hole caving badly, unable to get hole to stand up. Ran 2 1/2" OD, 17#, 3rd thd., J-55, Range 2, Seamless steel casing to 4545' and cleaned out to bottom but
<b>TOTAL DEPTH</b>		<b>4622</b>	

were unable to lower 5 1/2" casing. Pumped aquagel behind casing, then circulated 500 gallons, but were still unable to loosen casing. At this point authority was granted to rip off and pull the 5 1/2" casing and plug back and test Conglomerate zone cased off by 7" OD casing.

On December 26th ripped off 5 1/2" casing at 4470' and pulled all casing above that point.

On December 29th plugged back with 75 sacks of cement from 4622' to 4415'. Let cement set until January 1, 1945, then bailed the hole dry and drilled cement plug from 4415' to 4447', and on January 3rd perforated 7" casing opposite Conglomerate from 4420' to 4425' with 10 holes by Lane-wells and hole filled 1500' with water in 5 hours and 3000' with water in 12 hours. Since none of the zones above 4420' indicated oil or gas in commercial quantities regular authority was granted on January 5th to plug the hole and abandon the location.

On January 6th started plugging and plugged the well as follows:

16 sacks of cement	4447'	to	4382'
Mud laden fluid	4382'	to	1180'
Wood plug and crushed rock	1180'	to	1158'
15 sacks of cement	1158'	to	1128'
Mud laden fluid	1128'	to	65'
Wood plug		at	65'
Rock and soil	65'	to	40'
23 sacks of cement	40'	to	15'
Surface soil and rock	15'	to	0.

Finished plugging January 28, 1945.

DEPTH	DIP	
	ANGLE OF DEFLECTION	
250'	0	0 Degrees
500'	0	"
750'	0	"
1000'	0	"
1250'	0	"
1500'	0	"
1750'	0	"
2000'	0	"
2250'	0	"
2500'	0	"
2750'	0	"
3000'	1	"
3250'	1	"
3500'	0	"
3750'	1	"
4000'	1	"
4250'	1	"

V 32  
12 11-57 10