

\*Amended

STATE CORPORATION COMMISSION OF KANSAS  
OIL & GAS CONSERVATION DIVISION  
WELL COMPLETION OR RECOMPLETION FORM  
ACO-1 WELL HISTORY  
DESCRIPTION OF WELL AND LEASE

Operator: License # 6040  
Bankoff Oil Company  
Name  
Address P. O. Box 700657  
Tulsa, OK 74136  
City/State/Zip

Purchaser

Operator Contact Person Frank Mize  
Phone (316) 262-2784

Contractor: License # 5422  
Abercrombie Drilling, Inc.  
Name

Wellsite Geologist Jerry Zorger  
Phone 316-262-2784

Designate Type of Completion  
 New Well  Re-Entry  Workover  
 Oil  SWD  Temp Abd  
 Gas  Inj  Delayed Comp.  
 Dry  Other (Core, Water Supply etc.)

If **OWWO**: old well info as follows:  
Operator  
Well Name  
Comp. Date Old Total Depth

WELL HISTORY

Drilling Method:  
 Mud Rotary  Air Rotary  Cable  
8-01-88 8-08-88 8-08-88  
Spud Date Date Reached TD Completion Date

4554'  
Total Depth PBDT  
Amount of Surface Pipe Set and Cemented at 262.95 feet  
Multiple Stage Cementing Collar Used?  Yes  No  
If yes, show depth set...feet  
If alternate 2 completion, cement circulated from...feet depth to...w/...SX cmt  
Cement Company Name  
Invoice #  
*Al II DGR*

SIDE ONE

15-135-23276-0000 1

API NO. 15-135-23,273 276-00-00  
County Ness  
NW NE/4 14 17S 24 East  
Sec. Twp. Rge.  West

4620  
1980  
Ft North from Southeast Corner of Section  
Ft West from Southeast Corner of Section  
(Note: Locate well in section plat below)

Lease Name Amstutz Well # 1

Field Name

Producing Formation

Elevation: Ground 2493  
2492' X KB 2498

Section Plat

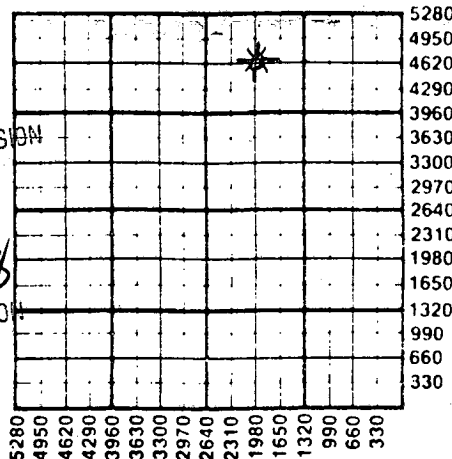

RECEIVED  
STATE CORPORATION COMMISSION  
SEP 21 1988  
09-21-1988  
CONSERVATION DIVISION  
Wichita, Kansas

WATER SUPPLY INFORMATION

Disposition of Produced Water:  Disposal  
Docket #  Repressuring

Questions on this portion of the ACO-1 call:  
Water Resources Board (913) 296-3717

Source of Water:  
Division of Water Resources Permit #  
Groundwater...Ft North from Southeast Corner  
(Well #) ...Ft West from Southeast Corner of  
Sec. Twp. Rge. East West  
 Surface Water...Ft North from Southeast Corner  
(Stream, pond etc)...Ft West from Southeast Corner  
Sec 14 Twp. 17S Rge. 24 East  West  
Other (explain)  
(purchased from city, R.W.D. #)

INSTRUCTIONS: This form shall be completed in triplicate and filed with the Kansas Corporation Commission, 200 Colorado Derby Building, Wichita, Kansas 67202, within 120 days of the spud date of any well. Rule 82-3-130, 82-3-107 and 82-3-106 apply. Information on side two of this form will be held confidential for a period of 12 months if requested in writing and submitted with the form. See rule 82-3-107 for confidentiality in excess of 12 months. One copy of all wireline logs and drillers time log shall be attached with this form. Submit CP-4 form with all plugged wells. Submit CP-111 form with all temporarily abandoned wells.

All requirements of the statutes, rules and regulations promulgated to regulate the oil and gas industry have been fully complied with and the statements herein are complete and correct to the best of my knowledge.

Signature *Frank A. [Signature]*  
Title Exploration Mgr Date 9/20/88

Subscribed and sworn to before me this 20th day of September 1988.  
Notary Public *James B. Branstetter*  
Date Commission Expires 4-13-89

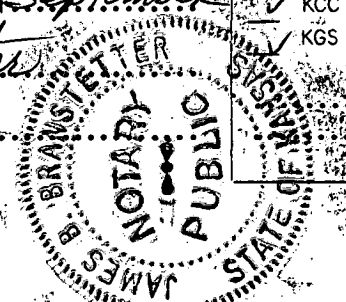

K.C.C. OFFICE USE ONLY  
F Letter of Confidentiality Attached  
C Wireline Log Received  
C Drillers Timelog Received  
Distribution  
 KCC  SWD/Rep  NGPA  
 KGS  Plug  Other  
(Specify)  
9-21-88  
Form ACO-1 (5-86)

Sec. 14, Twp. 17, Rge. 24

Operator Name Bankoff Oil Company Lease Name Amstutz Well # 1

Sec. 14 Twp. 17S Rge. 24  East  West County Ness

WELL LOG

INSTRUCTIONS: Show important tops and base of formations penetrated. Detail all cores. Report all drill stem tests giving interval tested, time tool open and closed, flowing and shut-in pressures, whether shut-in pressure reached static level, hydrostatic pressures, bottom hole temperature, fluid recovery, and flow rates if gas to surface during test. Attach extra sheet if more space is needed. Attach copy of log.

Drill Stem Tests Taken  Yes  No  
 Samples Sent to Geological Survey  Yes  No  
 Cores Taken  Yes  No

Formation Description  
 Log  Sample

DST #1: 4445-4504/10-15-0-0  
 Rec. 5'M  
 IFP 31-31#  
 Sip 33#

Name	Top	Bottom
Anhydrite	1798	+700
Heebner	3866	1368
Lansing	3908	1412
BKC	4208	1710
Marmaton	4250	1774
Pawnee	4322	1823
FtScott	4406	1908
Mississippian	4554	2056

CASING RECORD <input checked="" type="checkbox"/> New <input type="checkbox"/> Used							
Report all strings set-conductor, surface, intermediate, production, etc.							
Purpose of String	Size Hole Drilled	Size Casing Set (in O.D.)	Weight Lbs/Ft.	Setting Depth	Type of Cement	#Sacks Used	Type and Percent Additives
Surface	12 1/4"	8 5/8"	28#	262.95	60/40 posmix	165	2% gel, 3% cc
PERFORATION RECORD				Acid, Fracture, Shot, Cement Squeeze Record			
Shots Per Foot	Specify Footage of Each Interval Perforated			(Amount and Kind of Material Used)		Depth	
TUBING RECORD				Liner Run <input type="checkbox"/> Yes <input type="checkbox"/> No			
Size	Set At	Packer at					
Date of First Production		Producing Method					
		<input type="checkbox"/> Flowing <input type="checkbox"/> Pumping <input type="checkbox"/> Gas Lift <input type="checkbox"/> Other (explain).....					
Estimated Production Per 24 Hours		Oil	Gas	Water	Gas-Oil Ratio	Gravity	
		Bbls	MCF	Bbls	CFPB		

METHOD OF COMPLETION

Production Interval

Disposition of gas:  Vented  Sold  Used on Lease  Open Hole  Perforation  Other (Specify) .....  
 Dually Completed  Commingled

