

STATE OF KANSAS
STATE CORPORATION COMMISSION
CONSERVATION DIVISION
P. O. BOX 17027
WICHITA, KANSAS 67317

WELL PLUGGING RECORD

Ellis County, Sec. 18 Twp. 11 Rge. 18W (E) (W)

Location as "NE/CNW&SW2" or footage from lines NW NW NE

Lease Owner Robert R. Price

Lease Name Frisbie Well No. #1

Office Address Box 45442/Tulsa, OK 74145

Character of Well (completed as Oil, Gas or Dry Hole) Dry Hole

Date well completed 10-10 19 76

Application for plugging filed 10-10 19 76

Application for plugging approved 10-10 19 76

Plugging commenced 10-10 19 76

Plugging completed 10-10 19 76

Reason for abandonment of well or producing formation Dry Hole

If a producing well is abandoned, date of last production ----- 19

Was permission obtained from the Conservation Division or its agents before plugging was commenced? YES

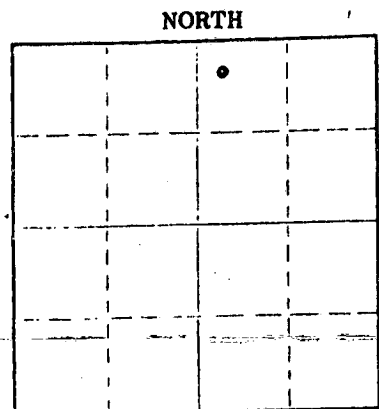

Locate well correctly on above Section Plat

Name of Conservation Agent who supervised plugging of this well Leo Massey/Hays, KS

Producing formation ----- Depth to top ----- Bottom ----- Total Depth of Well 3520'

Show depth and thickness of all water, oil and gas formations.

OIL, GAS OR WATER RECORDS

CASING RECORD

FORMATION	CONTENT	FROM	TO	SIZE	PUT IN	PULLED OUT
				8 5/8"	258'	NONE

Describe in detail the manner in which the well was plugged, indicating where the mud fluid was placed and the method or methods used in introducing it into the hole. If cement or other plugs were used, state the character of same and depth placed, from ----- feet to ----- feet for each plug set.

Plugged with 50 sacks 50/50 Pozmix & 2% Gel @ 420'
25 sacks @ 240',
10 sacks, Bridge & Plug & 1/2 sack hulls @ 140'
Job Complete @ 5:00 P.M.
By Sun Cementing.

RECEIVED
CORPORATION COMMISSION
NOV 08 1976

CONSERVATION DIVISION
Wichita, Kansas

Name of Plugging Contractor Allen Drilling Company
Address P.O. Box 1389/Great Bend, KS 67530

STATE OF Kansas COUNTY OF Barton ss.
Allen Drilling Company (employee of owner) or (owner or operator) of the above-described well, being first duly sworn on oath, says: That I have knowledge of the facts, statements, and matters herein contained and the log of the above-described well as filed and that the same are true and correct. So help me God.

(Signature) Henry J. Bishop
P.O. Box 1389/Great Bend, KS 67530
(Address)

SUBSCRIBED AND SWORN TO before me this 11th day of October, 19 76

My commission expires 11-25-79
Lavelta M. Murnahan Notary Public.

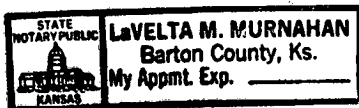

KANSAS DRILLERS LOG

S. 18 T. 11 R. 18 ^EW
 Loc. NW NW NE 100' W
 County Ellis

API No. 15 — 051 — 21,219-0000
 County Number

Operator
Robert R. Price

Address
Box 45442 Tulsa, Oklahoma 74145

Well No. #1 Lease Name Frisbie

Footage Location
330 feet from (N) line 230' feet from (W) line

Principal Contractor Allen Drilling Co. Geologist Robert Price

Spud Date 10-4-76 Total Depth 3520 P.B.T.D.

Date Completed 10-10-76 Oil Purchaser

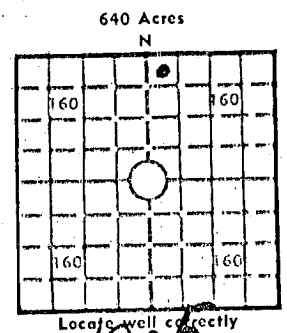

Elev.: Gr. 1908
 DF 1908 KB 1911

CASING RECORD

Report of all strings set — surface, intermediate, production, etc.

Purpose of string	Size hole drilled	Size casing set (in O.D.)	Weight lbs/ft.	Setting depth	Type cement	Sacks	Type and percent additives
<u>Surface</u>	<u>12 1/4"</u>	<u>8 5/8"</u>	<u>24#</u>	<u>258'</u>	<u>Common</u>	<u>175</u>	<u>2% Gel 3% CaCl</u>

LINER RECORD

PERFORATION RECORD

Top, ft.	Bottom, ft.	Sacks cement	Shots per ft.	Size & type	Depth interval

TUBING RECORD

Size	Setting depth	Packer set at

ACID, FRACTURE, SHOT, CEMENT SQUEEZE RECORD

Amount and kind of material used	Depth interval treated

RECEIVED
 STATE CORPORATION COMMISSION
DEC 23 1976
 CONSERVATION DIVISION
 Wichita, Kansas

INITIAL PRODUCTION

Date of first production	Producing method (flowing, pumping, gas lift, etc.)
RATE OF PRODUCTION PER 24 HOURS	Oil bbls. Gas bbls. Water MCF. Gas-oil ratio bbls. CFPB
Disposition of gas (vented, used on lease or sold)	Producing interval(s)

INSTRUCTIONS: As provided in KCC Rule 82-2-125, within 90 days after completion of a well, one completed copy of this Drillers Log shall be transmitted to the State Geological Survey of Kansas, 4150 Monroe Street, Wichita, Kansas 67209. Copies of this form are available from the Conservation Division, State Corporation Commission, 3830 So. Meridian (P.O. Box 17027), Wichita, Kansas 66217. Phone AC 316-522-2206. If confidential custody is desired, please note Rule 82-2-125. Drillers Logs will be on open file in the Oil and Gas Division, State Geological Survey of Kansas, Lawrence, Kansas 66044.

Operator

Robert R. Price

DESIGNATE TYPE OF COMP.: OIL, GAS, DRY HOLE, SWPW, ETC.:

Dry Hole

Well No.

1

Lease Name

Frisbie

15-051-21219-0000

S 18 T 11 S R 18 W

WELL LOG

Show all important zones of porosity and contents thereof; cored intervals, and all drill-stem tests, including depth interval tested, cushion used, time tool open, flowing and shut-in pressures, and recoveries.

SHOW GEOLOGICAL MARKERS, LOGS RUN, OR OTHER DESCRIPTIVE INFORMATION.

FORMATION DESCRIPTION, CONTENTS, ETC.	TOP	BOTTOM	NAME	DEPTH
DST #1 3160-3220			Anhydrite	1238'
ISIP 1084"			Topeka	2905'
KSIP 1064"			Heebner	3130'
Recovered 90' W.M.			Toronto	3151'
			Lansing	3171'
			D/KC	3400'
			Conglomerate	3426'
			Arkuckle	3516'
			T.D.	3520'

USE ADDITIONAL SHEETS, IF NECESSARY, TO COMPLETE WELL RECORD.

Date Received

RECEIVED
STATE CORPORATE COMMISSION
DEC 23 1976
CONSERVATION DIVISION
Topeka, Kansas

Robert R. Price

Signature

Operator

Title

10-11-76

Date