



KANSAS CORPORATION COMMISSION 1077159
OIL & GAS CONSERVATION DIVISION

Form ACO-1
June 2009

CONFIDENTIAL

WELL COMPLETION FORM

Form Must Be Typed
Form must be Signed
All blanks must be Filled

WELL HISTORY - DESCRIPTION OF WELL & LEASE

OPERATOR: License # 34192
Name: SandRidge Exploration and Production LLC
Address 1: 123 ROBERT S. KERR AVE
Address 2: _____
City: OKLAHOMA CITY State: OK Zip: 73102 + 6406
Contact Person: Tiffany Golay
Phone: (405) 429-6543
CONTRACTOR: License # 34464
Name: Lariat Services, Inc.
Wellsite Geologist: Kathy Gentry
Purchaser: Atlas (gas) NCRA (oil)

Designate Type of Completion:

- New Well Re-Entry Workover
- Oil WSW SWD SIOW
 Gas D&A ENHR SIGW
 OG GSW Temp. Abd.
 CM (Coal Bed Methane)
 Cathodic Other (Core, Expl., etc.): _____

If Workover/Re-entry: Old Well Info as follows:

Operator: _____

Well Name: _____

Original Comp. Date: _____ Original Total Depth: _____

- Deepening Re-perf. Conv. to ENHR Conv. to SWD
 Conv. to GSW
- Plug Back: _____ Plug Back Total Depth _____
 Commingled Permit #: _____
 Dual Completion Permit #: _____
 SWD Permit #: _____
 ENHR Permit #: _____
 GSW Permit #: _____

<u>2/23/2012</u>	<u>3/21/2012</u>	<u>3/25/2012</u>
Spud Date or Recompletion Date	Date Reached TD	Completion Date or Recompletion Date

API No. 15 - 15-033-21622-01-00

Spot Description: _____

NW NE NW NW Sec. 34 Twp. 33 S. R. 17 East West
200 Feet from North / South Line of Section
810 Feet from East / West Line of Section

Footages Calculated from Nearest Outside Section Corner:

NE NW SE SW

County: Comanche

Lease Name: Sarah Well #: 1-34H

Field Name: _____

Producing Formation: Mississippi

Elevation: Ground: 1835 Kelly Bushing: 1815

Total Depth: 9752 Plug Back Total Depth: _____

Amount of Surface Pipe Set and Cemented at: 800 Feet

Multiple Stage Cementing Collar Used? Yes No

If yes, show depth set: _____ Feet

If Alternate II completion, cement circulated from: _____

feet depth to: _____ w/ _____ sx cmt.

Drilling Fluid Management Plan

(Data must be collected from the Reserve Pit)

Chloride content: 18800 ppm Fluid volume: 5320 bbls

Dewatering method used: Haul Off Pit

Location of fluid disposal if hauled offsite:

Operator Name: Triple C Soil Farming

Lease Name: unknown License #: 20122

Quarter SE Sec. 29 Twp. 26 S. R. 18 East West

County: Woodward, ok Permit #: 1220122

AFFIDAVIT

I am the affiant and I hereby certify that all requirements of the statutes, rules and regulations promulgated to regulate the oil and gas industry have been fully complied with and the statements herein are complete and correct to the best of my knowledge.

Submitted Electronically

KCC Office Use ONLY

- Letter of Confidentiality Received
Date: 06/21/2012
- Confidential Release Date: _____
- Wireline Log Received
- Geologist Report Received
- UIC Distribution
- ALT I II III Approved by: NAOMI JAMES Date: 06/22/2012

Section 28
33S 17W

Section 27
33S 17W

SARAH 1-34H



Miss Entry: 5286'
-99.160666 37.1344022

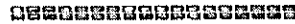

Top Perf: 5318'
-99.160660 37.134329

Section 33
33S 17W

Section 34
33S 17W

Bottom Perf: 9301'
-99.160144 37.123445



905' FWL

BHL: 9752'

-99.160071 37.122208



318' FSL

Section 4
34S 17W

Section 3
34S 17W



Actual Bottom-Hole Location of Sara 1-34H
Comanche County, Kansas
T&R: 33S 17W
Section: 34, 905' FWL & 318' FSL
Long/Lat: -99.160071 37.122208

1 in = 667 ft



● Actual BH Location

* SandRidge Wells

--- Perf

□ Sections

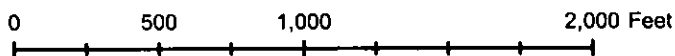

Draftsman:

Aaron Birk

Draft Date: 6/18/2012

Drawing Name/Number:

Addendum_Sarah_1-34H.mxd

Coordinate System:

NAD 1927 State Plane
Kansas South FIPS: 1502

Sandridge Energy

Sarah 1-34H - Final

Sarah 1-34H SL 200FNL, 810FWL

Comanche County, Kansas (Sandridge Energy) NAD27 / Grid

File reference with 2 files	One System MWD77 / Level Kansas SP, Southern Zone (1927) US foot
True vertical depths are referenced to Level 3 (HKT)	North Reference: Grid north
Horizontal depths are referenced to Level 3 (HKT)	Scale: True distance
Level 3 (HKT) to Mean Sea Level: 1849 feet	Depth: as in feet
Mean Sea Level to Mean Sea Level (M.S.L. Sarah 1-34H SL 200FNL, 810FWL): +1849 feet	Created by: dshamp on 3/1/2012
Coordinates are in feet referenced to Grid	

Location Information

Facility Name	Grid East (US ft)	Grid North (US ft)	Latitude	Longitude
Sarah 1-34H Bore 34-335-17W	1807276 000	171569 000	37°08'09.5347N	99°09'36.6907W
Well	Local N (ft)	Local E (ft)	Grid East (US ft)	Grid North (US ft)
Sarah 1-34H BL 200FNL, 810FWL	0 00	0 00	1807276 000	171569 000
Level 3 (HKT) to Mean Sea Level (M.S.L. Sarah 1-34H SL 200FNL, 810FWL)				1849
Mean Sea Level to Mean Sea Level (M.S.L. Sarah 1-34H SL 200FNL, 810FWL)				-1849
Level 3 (HKT) to Mean Sea Level				1849

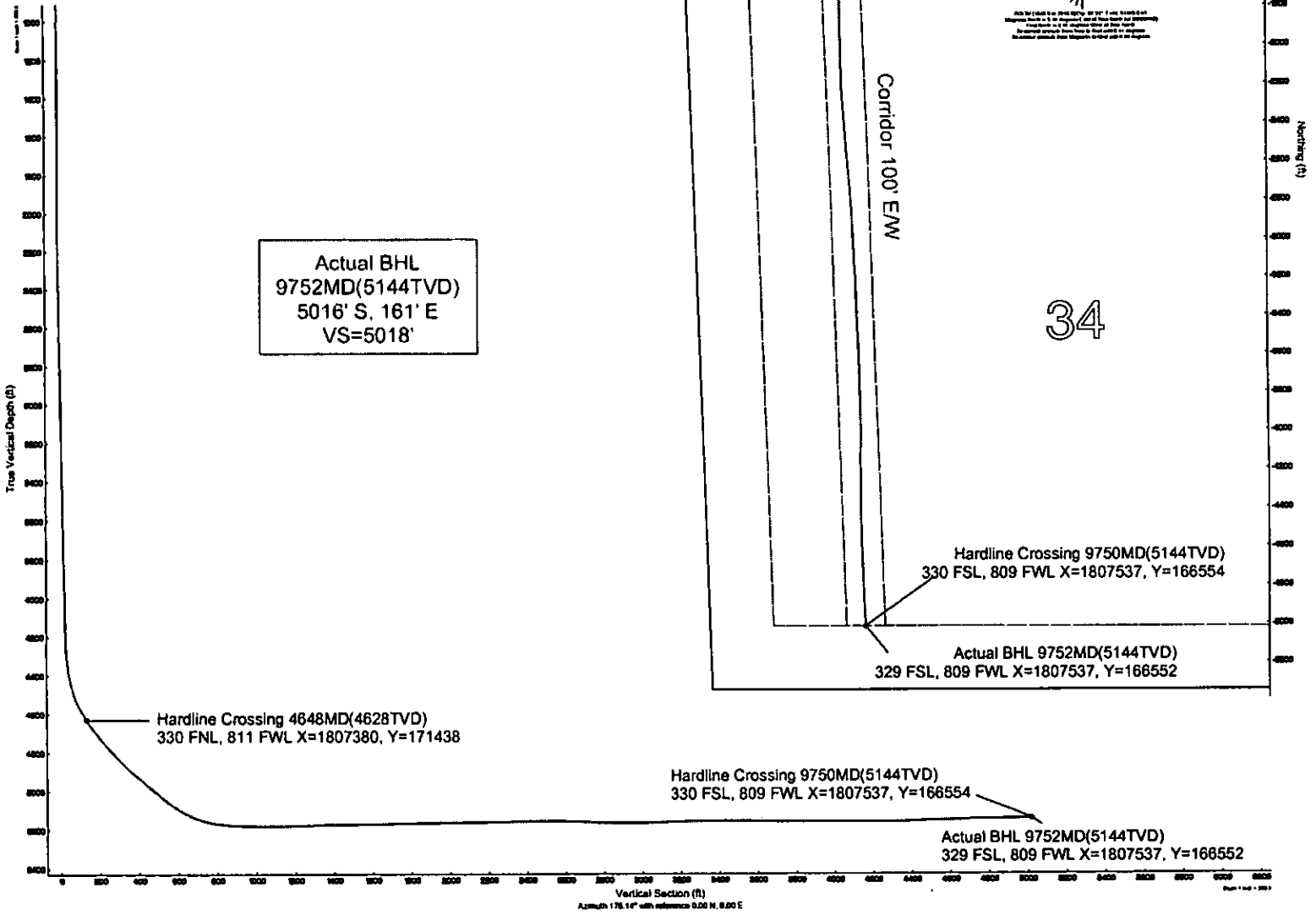

Actual BHL
9752MD(5144TVD)
5016' S, 161' E
VS=5018'

Hardline Crossing 4648MD(4628TVD)
330 FNL, 811 FWL X=1807380, Y=171438

Hardline Crossing 9750MD(5144TVD)
330 FSL, 809 FWL X=1807537, Y=166554

Actual BHL 9752MD(5144TVD)
329 FSL, 809 FWL X=1807537, Y=166552

Hardline Crossing 9750MD(5144TVD)
330 FSL, 809 FWL X=1807537, Y=166554

Actual BHL 9752MD(5144TVD)
329 FSL, 809 FWL X=1807537, Y=166552

34

Corridor 100' EW

Hardlines
330'
All-Around





Actual Wellpath Report

Sandridge Sarah 1-34H_Final Surveys.

Page 1 of 4

REFERENCE WELLPATH IDENTIFICATION

Operator	Sandridge Energy	Slot	Sarah 1-34H SL 200FNL, 810FWL
Area	Kansas	Well	Subject
Field	Comanche County, Kansas (Sandridge Energy) NAD27 / Grid	Wellbore	Sarah 1-34H AWB
Facility	Sarah 1-34H Sec.34-33S-17W		

REPORT SETUP INFORMATION

Projection System	NAD27 / Lambert Kansas SP, Southern Zone (1502), US feet		
North Reference	Grid	Software System	WellArchitect 3.0.0
Convergence at slot	0.41° West	User	Dehamard
Scale	1.00003	Report Generated	3/26/2012 at 3:59:32 PM
Wellbore last revised	02-29-2012	Database/Source file	Oklahoma City

WELLPATH LOCATION

	Local coordinates		Grid coordinates		Geographic coordinates	
	North[ft]	East[ft]	Easting[US ft]	Northing[US ft]	Latitude	Longitude
Slot Location	0.00	0.00	1807376.00	171569.00	37°08'09.534"N	99°09'38.690"W
Facility Reference Pt			1807376.00	171569.00	37°08'09.534"N	99°09'38.690"W
Field Reference Pt			1773194.47	191302.75	37°11'22.030"N	99°16'42.810"W

WELLPATH DATUM

Calculation method	Minimum curvature	Lariat 3 (RKB) to Facility Vertical Datum	18.00ft
Horizontal Reference Pt	Slot	Lariat 3 (RKB) to Mean Sea Level	1849.00ft
Vertical Reference Pt	Lariat 3 (RKB)	Lariat 3 (RKB) to Mud Line at Slot (Sarah 1-34H SL 200FNL, 810FWL)	18.00ft
MD Reference Pt	Lariat 3 (RKB)	Section Origin	N 0.00, E 0.00 ft
Field Vertical Reference	Mean Sea Level	Section Azimuth	178.14°



Actual Wellpath Report

Sandridge Sarah 1-34H_Final Surveys.

Page 2 of 4

REFERENCE WELLPATH IDENTIFICATION			
Operator	Sandridge Energy	Slot	Sarah 1-34H SL 200FNL, 810FWL
Area	Kansas	Well	Subject
Field	Comanche County, Kansas (Sandridge Energy) NAD27 / Grid	Wellbore	Sarah 1-34H AWB
Facility	Sarah 1-34H Sec.34-33S-17W		

WELLPATH DATA (108 stations) † = interpolated/extrapolated station										
MD [ft]	Inclination [°]	Azimuth [°]	TVD [ft]	Vert Sect [ft]	North [ft]	East [ft]	Grid East [US ft]	Grid North [US ft]	DLS [°/100ft]	Log Comment
0.00	0.000	0.000	0.00	0.00	0.00	0.00	1807376.00	171569.00	0.00	
18.00	0.000	0.000	18.00	0.00	0.00	0.00	1807376.00	171569.00	0.00	
279.00	0.680	0.000	278.99	-1.55	1.55	0.00	1807376.00	171570.55	0.26	
502.00	0.200	0.000	501.99	-3.26	3.26	0.00	1807376.00	171572.26	0.22	
907.00	0.390	51.250	906.98	-4.79	4.83	1.07	1807377.07	171573.83	0.08	
1189.00	0.230	46.210	1188.98	-5.75	5.82	2.23	1807378.23	171574.82	0.06	
1470.00	0.350	81.590	1469.97	-6.22	6.34	3.49	1807379.49	171575.34	0.07	
1755.00	0.470	96.170	1754.97	-6.16	6.34	5.51	1807381.51	171575.34	0.06	
2037.00	0.280	88.350	2036.96	-5.99	6.24	7.35	1807383.35	171575.24	0.07	
2321.00	0.820	146.290	2320.95	-4.27	4.57	9.17	1807385.17	171573.57	0.25	
2609.00	1.070	162.350	2608.91	0.07	0.29	11.13	1807387.13	171569.29	0.13	
2896.00	0.900	153.560	2895.87	4.70	-4.28	12.95	1807388.95	171564.72	0.08	
3183.00	0.800	152.920	3182.84	8.56	-8.08	14.86	1807390.86	171560.91	0.03	
3469.00	0.990	162.140	3468.80	12.74	-12.21	16.53	1807392.53	171556.79	0.08	
3757.00	1.050	181.430	3756.76	17.77	-17.22	17.23	1807393.23	171551.78	0.12	
4042.00	1.090	192.530	4041.71	23.00	-22.48	16.57	1807392.57	171546.52	0.07	
4190.00	1.170	195.340	4189.68	25.81	-25.31	15.87	1807391.87	171543.69	0.07	
4235.00	1.550	178.570	4234.66	26.86	-26.36	15.76	1807391.76	171542.64	1.21	
4266.00	2.920	174.010	4265.64	28.06	-27.56	15.85	1807391.85	171541.43	4.45	
4298.00	4.800	180.020	4297.57	30.22	-29.71	15.94	1807391.94	171539.29	6.00	
4330.00	6.450	186.280	4329.41	33.33	-32.84	15.74	1807391.74	171536.16	5.49	
4362.00	8.220	192.100	4361.15	37.33	-36.86	15.07	1807391.07	171532.14	5.99	
4394.00	8.990	193.090	4392.79	41.97	-41.54	14.02	1807390.02	171527.46	2.45	
4426.00	11.660	189.800	4424.27	47.55	-47.16	12.90	1807388.90	171521.84	8.54	
4458.00	14.220	188.600	4455.45	54.59	-54.23	11.76	1807387.77	171514.77	8.04	
4490.00	17.520	187.830	4486.23	63.20	-62.89	10.52	1807386.52	171506.11	10.33	
4521.00	20.860	187.240	4515.50	73.25	-72.99	9.19	1807385.19	171496.00	10.79	
4553.00	24.230	186.290	4545.05	85.38	-85.18	7.75	1807383.75	171483.82	10.59	
4585.00	27.460	185.120	4573.85	99.21	-99.05	6.37	1807382.37	171469.94	10.22	
4617.00	30.010	183.580	4601.91	114.50	-114.39	5.21	1807381.21	171454.60	8.30	
4648.00	32.112	182.512	4628.46	130.44	-130.36	4.37	1807380.37	171438.63	7.01	Hardline Crossing 4648MD(4628TVD) 330 FNL, 811 FWL
4649.00	32.180	182.480	4629.31	130.97	-130.90	4.35	1807380.35	171438.10	7.01	
4681.00	34.430	182.060	4656.05	148.49	-148.45	3.65	1807379.65	171420.54	7.07	
4713.00	35.790	181.990	4682.23	166.85	-166.84	3.00	1807379.00	171402.15	4.25	
4744.00	37.120	181.210	4707.16	185.24	-185.26	2.49	1807378.49	171383.74	4.54	
4776.00	38.740	181.130	4732.40	204.88	-204.92	2.09	1807378.09	171364.07	5.06	
4808.00	40.650	180.330	4757.02	225.30	-225.36	1.83	1807377.83	171343.64	6.18	
4840.00	41.820	179.270	4781.08	246.38	-246.45	1.91	1807377.91	171322.54	4.26	
4872.00	42.450	178.130	4804.81	267.85	-267.91	2.39	1807378.40	171301.08	3.10	
4904.00	42.780	177.390	4828.36	289.51	-289.56	3.24	1807379.24	171279.43	1.87	
4935.00	44.150	176.550	4850.86	310.83	-310.85	4.37	1807380.37	171258.14	4.80	
4968.00	45.680	177.160	4874.23	334.13	-334.12	5.65	1807381.65	171234.87	4.82	
4999.00	47.550	177.500	4895.53	356.65	-356.62	6.70	1807382.70	171212.37	6.08	
5039.00	48.910	177.770	4922.17	386.48	-386.43	7.93	1807383.93	171182.56	3.44	
5095.00	49.410	177.000	4958.79	428.84	-428.75	9.86	1807385.86	171140.24	1.37	

Actual Wellpath Report

Sandridge Sarah 1-34H_Final Surveys.

Page 3 of 4

REFERENCE WELLPATH IDENTIFICATION			
Operator	Sandridge Energy	Slot	Sarah 1-34H SL 200FNL, 810FWL
Area	Kansas	Well	Subject
Field	Comanche County, Kansas (Sandridge Energy) NAD27 / Grid	Wellbore	Sarah 1-34H AWB
Facility	Sarah 1-34H Sec.34-33S-17W		

WELLPATH DATA (108 stations)										
MD [ft]	Inclination [°]	Azimuth [°]	TVD [ft]	Vert Sect [ft]	North [ft]	East [ft]	Grid East [US ft]	Grid North [US ft]	DLS [°/100ft]	Log Comment
5158.00	49.730	176.730	4999.65	476.79	-476.63	12.48	1807388.48	171092.35	0.60	
5190.00	49.300	176.350	5020.42	501.12	-500.93	13.95	1807389.95	171068.06	1.62	
5222.00	49.370	176.050	5041.28	525.38	-525.15	15.56	1807391.56	171043.84	0.74	
5254.00	51.330	175.110	5061.69	549.99	-549.71	17.46	1807393.46	171019.27	6.53	
5286.00	54.830	176.350	5080.91	575.54	-575.22	19.36	1807395.36	170993.77	11.37	
5318.00	58.350	176.400	5098.53	602.24	-601.87	21.05	1807397.05	170967.11	11.00	
5350.00	62.010	176.340	5114.44	629.98	-629.58	22.81	1807398.81	170939.41	11.44	
5381.00	64.960	176.210	5128.28	657.71	-657.25	24.61	1807400.61	170911.73	9.52	
5413.00	68.500	176.620	5140.92	687.08	-686.59	26.45	1807402.45	170882.39	11.12	
5445.00	72.240	176.440	5151.67	717.21	-716.67	28.27	1807404.27	170852.31	11.70	
5477.00	76.280	176.000	5160.35	747.98	-747.39	30.30	1807406.30	170821.59	12.69	
5509.00	80.060	175.740	5166.91	779.27	-778.63	32.56	1807408.56	170790.35	11.84	
5541.00	82.880	177.330	5171.65	810.90	-810.21	34.47	1807410.47	170758.77	10.09	
5555.00	83.610	176.520	5173.30	824.80	-824.09	35.21	1807411.21	170744.88	7.76	
5627.00	87.440	177.760	5178.92	896.56	-895.77	38.79	1807414.79	170673.21	5.59	
5658.00	87.380	178.770	5180.32	927.53	-926.72	39.73	1807415.73	170642.25	3.26	
5690.00	89.510	180.040	5181.19	959.50	-958.71	40.06	1807416.06	170610.27	7.75	
5721.00	90.660	178.080	5181.14	990.50	-989.70	40.57	1807416.57	170579.27	7.33	
5784.00	89.260	179.810	5181.18	1053.49	-1052.69	41.73	1807417.73	170516.28	3.53	
5877.00	91.020	180.660	5180.96	1146.42	-1145.68	41.35	1807417.35	170423.29	2.10	
5971.00	91.860	180.820	5178.59	1240.29	-1239.64	40.14	1807416.14	170329.32	0.91	
6065.00	92.630	181.560	5174.91	1334.09	-1333.55	38.18	1807414.19	170235.42	1.14	
6159.00	90.000	179.660	5172.75	1427.96	-1427.51	37.19	1807413.19	170141.46	3.45	
6253.00	89.910	178.470	5172.83	1521.95	-1521.49	38.72	1807414.72	170047.47	1.27	
6347.00	91.100	178.600	5172.00	1615.94	-1615.46	41.12	1807417.12	169953.50	1.27	
6441.00	91.530	179.530	5169.84	1709.90	-1709.42	42.66	1807418.66	169859.54	1.09	
6534.00	91.570	179.420	5167.33	1802.84	-1802.38	43.51	1807419.51	169766.57	0.13	
6628.00	90.590	178.840	5165.56	1896.81	-1896.35	44.93	1807420.94	169672.60	1.21	
6722.00	90.000	178.830	5165.07	1990.80	-1990.33	46.85	1807422.85	169578.62	0.63	
6816.00	90.770	179.550	5164.44	2084.78	-2084.32	48.17	1807424.18	169484.63	1.12	
6910.00	91.790	179.010	5162.34	2178.74	-2178.28	49.36	1807425.36	169390.66	1.23	
7004.00	91.170	176.160	5159.91	2272.69	-2272.16	53.32	1807429.32	169296.78	3.10	
7099.00	91.540	176.160	5157.67	2367.61	-2366.92	59.68	1807435.68	169202.02	0.39	
7195.00	89.820	175.700	5156.53	2463.53	-2462.67	66.49	1807442.49	169106.27	1.85	
7292.00	89.350	175.250	5157.23	2560.42	-2559.36	74.14	1807450.14	169009.57	0.67	
7387.00	87.380	175.380	5159.94	2655.26	-2654.00	81.90	1807457.90	168914.93	2.08	
7482.00	88.460	175.110	5163.39	2750.08	-2748.61	89.77	1807465.77	168820.32	1.17	
7578.00	89.170	175.870	5165.37	2845.95	-2844.29	97.31	1807473.32	168724.63	1.08	
7674.00	89.180	178.280	5166.75	2941.92	-2940.15	102.21	1807478.21	168628.77	2.51	
7770.00	91.940	176.260	5165.82	3037.89	-3036.02	106.78	1807482.79	168532.90	3.56	
7865.00	92.280	176.420	5162.32	3132.78	-3130.76	112.84	1807488.85	168438.15	0.40	
7961.00	91.330	177.580	5159.30	3228.71	-3226.58	117.86	1807493.87	168342.33	1.56	
8057.00	90.740	178.240	5157.56	3324.69	-3322.50	121.36	1807497.37	168246.41	0.92	
8153.00	90.430	177.610	5156.58	3420.68	-3418.43	124.84	1807500.84	168150.48	0.73	
8249.00	89.660	177.210	5156.51	3516.67	-3514.33	129.18	1807505.18	168054.57	0.90	

Actual Wellpath Report

Sandridge Sarah 1-34H_Final Surveys.

Page 4 of 4

REFERENCE WELLPATH IDENTIFICATION			
Operator	Sandridge Energy	Slot	Sarah 1-34H SL 200FNL, 810FWL
Area	Kansas	Well	Subject
Field	Comanche County, Kansas (Sandridge Energy) NAD27 / Grid	Wellbore	Sarah 1-34H AWB
Facility	Sarah 1-34H Sec.34-33S-17W		

WELLPATH DATA (108 stations) † = interpolated/extrapolated station										
MD [ft]	Inclination [°]	Azimuth [°]	TVD [ft]	Vert Sect [ft]	North [ft]	East [ft]	Grid East [US ft]	Grid North [US ft]	DLS [°/100ft]	Log Comment
8344.00	88.360	177.710	5158.15	3611.65	-3609.22	133.39	1807509.39	167959.68	1.47	
8440.00	89.600	179.150	5159.86	3707.63	-3705.17	136.02	1807512.02	167863.73	1.98	
8536.00	89.970	178.870	5160.22	3803.62	-3801.15	137.68	1807513.68	167767.75	0.48	
8631.00	90.310	178.840	5159.98	3898.61	-3896.13	139.57	1807515.58	167672.76	0.36	
8727.00	89.010	178.220	5160.55	3994.60	-3992.10	142.04	1807518.04	167576.80	1.50	
8823.00	90.190	183.840	5161.22	4090.44	-4088.04	140.31	1807516.32	167480.85	5.98	
8918.00	88.860	178.730	5162.01	4185.26	-4182.98	138.18	1807514.19	167385.91	5.56	
9014.00	90.560	179.380	5162.50	4281.24	-4278.96	139.76	1807515.77	167289.93	1.90	
9110.00	92.000	179.850	5160.35	4377.18	-4374.93	140.41	1807516.41	167193.95	1.58	
9206.00	93.020	179.810	5156.15	4473.05	-4470.84	140.69	1807516.70	167098.05	1.06	
9301.00	91.160	176.940	5152.68	4567.97	-4565.72	143.39	1807519.39	167003.16	3.60	
9397.00	91.230	178.400	5150.68	4663.94	-4661.62	147.29	1807523.29	166907.26	1.52	
9493.00	91.230	177.960	5148.62	4759.92	-4757.55	150.34	1807526.34	166811.33	0.46	
9589.00	91.010	178.030	5146.75	4855.90	-4853.47	153.70	1807529.70	166715.40	0.24	
9685.00	90.650	176.920	5145.35	4951.88	-4949.37	157.92	1807533.93	166619.50	1.22	
9707.00	90.680	176.960	5145.10	4973.88	-4971.33	159.10	1807535.10	166597.54	0.23	
9750.00	90.680	176.960	5144.59	5016.87	-5014.27	161.38	1807537.38	166554.60	0.00	Hardline Crossing 9750MD(5144TVD) 330 FSL, 809 FWL
9752.00	90.680	176.960	5144.57	5018.87	-5016.27	161.49	1807537.49	166552.60	0.00	Actual BHL 9752MD(5144TVD) 329 FSL, 809 FWL

TARGETS									
Name	MD [ft]	TVD [ft]	North [ft]	East [ft]	Grid East [US ft]	Grid North [US ft]	Latitude	Longitude	Shape
Sarah 1-34H PBHL		5145.97	-5014.91	162.72	1807538.73	166553.96	37°07'19.962"N	99°09'36.242"W	point

WELLPATH COMPOSITION - Ref Wellbore: Sarah 1-34H AWB Ref Wellpath: AWP - Final				
Start MD [ft]	End MD [ft]	Positional Uncertainty Model	Log Name/Comment	Wellbore
18.00	9707.00	NaviTrak (Standard)	Inteq MWD	Sarah 1-34H AWB
9707.00	9752.00	Blind Drilling (std)	Projection to bit	Sarah 1-34H AWB