

CARD MUST BE TYPED

State of Kansas

CARD MUST BE SIGNED

NOTICE OF INTENTION TO DRILL

(see rules on reverse side)

Production pipe will be cemented from below usable water to surface.

Starting Date 8/3/85
month day year

API Number 15— 135-22,886-00-00
NW SE SW Sec. 15 Twp. 18 S, Rg. 25 East
990 Ft. from South Line of Section
3630 Ft. from East Line of Section

OPERATOR: License # 5190
Name Sabre Exploration, Inc.
Address 310 W. Central, #214
City/State/Zip Wichita, KS 67202
Contact Person Matt Totten
Phone 316 264-2635

(Note: Locate well on Section Plat on reverse side)

CONTRACTOR: License # 9943
Name Republic Drilling, Inc.
City/State Wichita, KS 67202

Nearest lease or unit boundary line 990 feet
County Ness

Lease Name Compton Well # 1
Ground surface elevation 2450 est. feet MSL

Well Drilled For: Well Class: Type Equipment:
 Oil SWD Infield Mud Rotary
 Gas Inj Pool Ext. Air Rotary
 OWWO Expl Wildcat Cable

Domestic well within 330 feet: yes no
Municipal well within one mile: yes no
Surface pipe by Alternate: 1 2
Depth to bottom of fresh water 100
Depth to bottom of usable water 700 800
Surface pipe planned to be set 250
Projected Total Depth 4500 feet
Formation Miss.

If OWWO: old well info as follows:

Operator
Well Name
Comp Date Old Total Depth

I certify that well will comply with K.S.A. 55-101, et seq., plus eventually plugging hole to KCC specifications.

Date 7-24-85 Signature of Operator or Agent [Signature] Title President

For KCC Use:

Conductor Pipe Required _____ feet; Minimum Surface Pipe Required _____ feet per Alt. 1 2

This Authorization Expires 1-25-86 Approved By RCH 7-25-85

Must be filed with the K.C.C. five (5) days prior to commencing well
This card void if drilling not started within six (6) months of date received by K.C.C.

Important procedures to follow:

1. Notify District office before setting surface casing.
2. Set surface casing by circulating cement to the top.
3. File completion forms ACO-1 with K.C.C. within 90 days of well completion, following instructions on ACO-1, side 1, and including copies of wireline logs.
4. Notify District office 48 hours prior to old well workover or re-entry.
5. Prior to filing Intent, prepare a proposed plugging plan in case well is D & A, then obtain approval of plan when calling district office prior to setting surface pipe.
6. Submit plugging report (CP-4) to K.C.C. after plugging is completed.
7. Obtain an approved injection docket number before disposing of salt water.
8. Notify K.C.C. within 10 days when injection commences or terminates.
9. If an alternate 2 completion, cement in the production pipe from below any usable water to surface within 120 days of spud date.

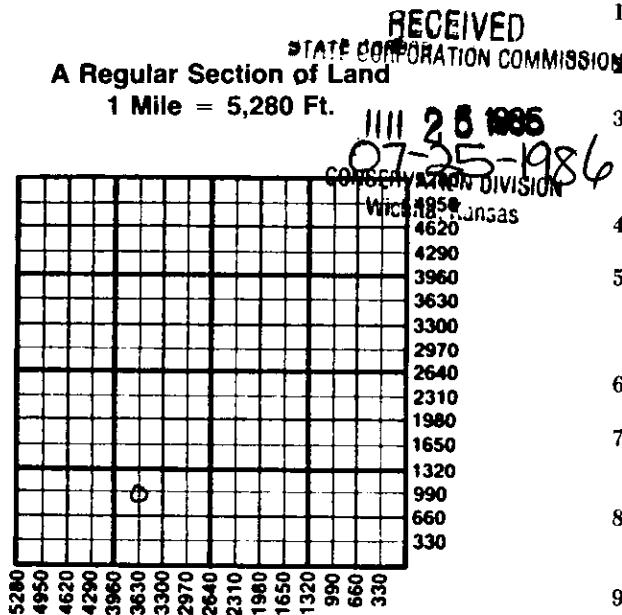

State Corporation Commission of Kansas
Conservation Division
200 Colorado Derby Building
Wichita, Kansas 67202
(316) 263-3238