

FOR KCC USE:

FORM C-1 7/91

EFFECTIVE DATE: 12-28-91

FORM MUST BE TYPED

DISTRICT # 1

State of Kansas

FORM MUST BE SIGNED

SEA7... Yes... No

NOTICE OF INTENTION TO DRILL

ALL BLANKS MUST BE FILLED

Must be approved by the K.C.C. five (5) days prior to commencing well

Expected Spud Date Dec. 26, 1991 month day year

Spot W/2, SE/4 SW. Sec. 14, Twp 17. S, Rg 21. East West

OPERATOR: License # 6875 Name: MARMIK OIL COMPANY Address: 575 Union Blvd, #205A City/State/Zip: Lakewood, CO 80228 Contact Person: Lee Shope Phone: 303/989-2250

660' feet from South / West line of Section 3630' feet from East / West line of Section IS SECTION X REGULAR IRREGULAR?

CONTRACTOR: License #: 5418 Name: ALLEN DRILLING COMPANY

(NOTE: Locate well on the Section Plat on Reverse Side) County: Ness Lease Name: CONNOR Well #: 2 Field Name: Unnamed

Well Drilled For: Well Class: Type Equipment: X Oil Enh Rec Infield X Mud Rotary Bas Storage X Pool Ext Air Rotary OWMO Disposal Wildcat Cable Seismic: # of Holes Other

Is this a Prorated/Spaced Field? yes X no Target Formation(s): Cherokee Nearest lease or unit boundary: 6.60'

If OWMO: old well information as follows: Operator: N/A Well Name: Comp. Date: Old Total Depth

Ground Surface Elevation: N/A feet MSL Water well within one-quarter mile: yes X no Public water supply well within one mile: yes X no

Directional, Deviated or Horizontal wellbore? yes X no If yes, true vertical depth: N/A Bottom Hole Location: N/A

Depth to bottom of fresh water: 100 Depth to bottom of usable water: 200 650 Surface Pipe by Alternate: 1 X 2 Length of Surface Pipe Planned to be set: 250'

AFFIDAVIT

The undersigned hereby affirms that the drilling, completion and eventual plugging of this well will comply with K.S.A. 55-101, et. seq. It is agreed that the following minimum requirements will be met:

- 1. Notify the appropriate district office prior to spudding of well; 2. A copy of the approved notice of intent to drill shall be posted on each drilling rig; 3. The minimum amount of surface pipe as specified below shall be set by circulating cement to the top; in all cases surface pipe shall be set through all unconsolidated materials plus a minimum of 20 feet into the underlying formation; 4. If the well is dry hole, an agreement between the operator and the district office on plug length and placement is necessary prior to plugging; 5. The appropriate district office will be notified before well is either plugged or production casing is cemented in; 6. IF AN ALTERNATE II COMPLETION, PRODUCTION PIPE SHALL BE CEMENTED FROM BELOW ANY USABLE WATER TO SURFACE WITHIN 120 DAYS OF SPUD DATE. IN ALL CASES, NOTIFY DISTRICT OFFICE PRIOR TO ANY CEMENTING.

I hereby certify that the statements made herein are true and to the best of my knowledge and belief. Date: 12/23/91 Signature of Operator or Agent: John A. Johnson Title: Agent

RECEIVED STATE COMMISSION DEC 23 1991 12-23-1991

FOR KCC USE: API # 15-135-23642-00-0 Conductor pipe required None feet Minimum surface pipe required 200 feet per Alt. X (2) Approved by: DA 12-23-91 This authorization expires: 5-23-92 (This authorization void if drilling not started within 6 months of effective date.) Spud date: Agent:

REMEMBER TO:

- File Drill Pit Application (form CDP-1) with Intent to Drill; - File Completion Form ACO-1 within 120 days of spud date; - File acreage attribution plat according to field proration orders; - Notify appropriate district office 48 hours prior to workover or re-entry; - Submit plugging report (CP-4) after plugging is completed; - Obtain written approval before disposing or injecting salt water.

Mail to: Conservation Division, 200 Colorado Derby Building, 202 W. First St., Wichita, Kansas 67202-1286.

14 12 21

IN ALL CASES PLOT THE INTENDED WELL ON THE PLAT BELOW.

PLAT OF ACREAGE ATTRIBUTABLE TO A WELL IN A PRORATED OR SPACED FIELD

If the intended well is in a prorated or spaced field, please fully complete this side of the form. If the intended well is in a prorated or spaced field complete the plat below showing that the well will be properly located in relationship to other wells producing from the common source of supply. Please show all the wells within 1 mile of the boundaries of the proposed acreage attribution unit for gas wells and within 1/2 mile of the boundaries of the proposed acreage attribution unit for oil wells.

API NO. 15- _____
 OPERATOR MARMIK OIL COMPANY
 LEASE CONNOR
 WELL NUMBER 2
 FIELD _____

LOCATION OF WELL: COUNTY Ness
660 feet from south/~~XXXX~~ line of section
3630 feet from east/~~XXXX~~ line of section
 SECTION 14 TWP 17 RG 21 W

NUMBER OF ACRES ATTRIBUTABLE TO WELL _____
 QTR/QTR/QTR OF ACREAGE W/2 SE/4 SW/4

IS SECTION X REGULAR or _____ IRREGULAR
IF SECTION IS IRREGULAR, LOCATE WELL FROM NEAREST CORNER BOUNDARY.

Section corner used: _____ NE _____ NW _____ SE _____ SW

PLAT

(Show location of the well and shade attributable acreage for prorated or spaced wells.)
 (Show footage to the nearest lease or unit boundary line.)

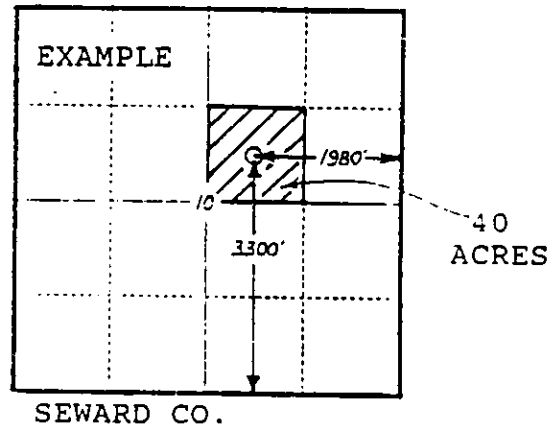
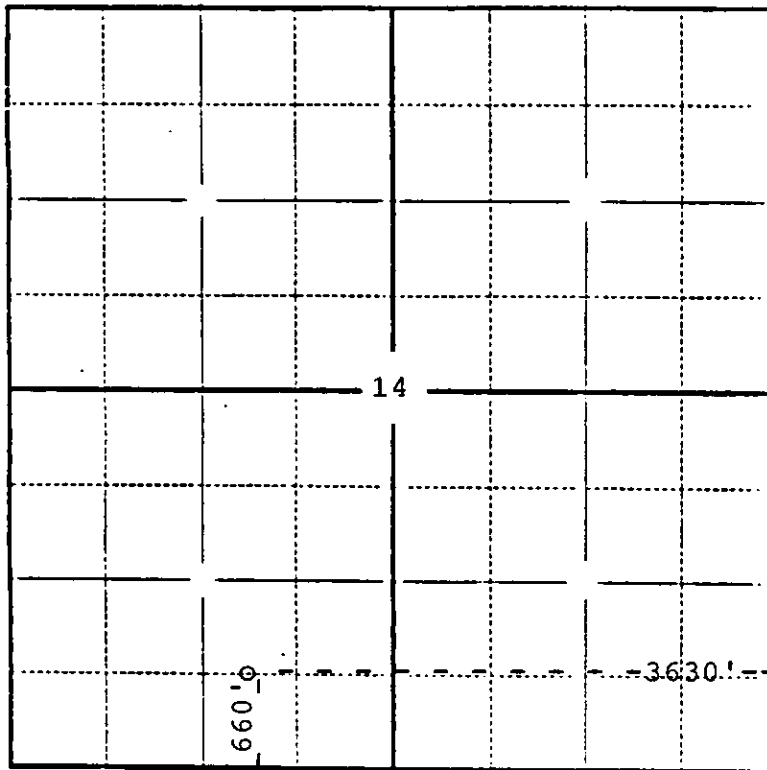

In plotting the proposed location of the well, you must show:

- 1) The manner in which you are using the depicted plat by identifying section lines, i.e. 1 section, 1 section with 8 surrounding sections, 4 sections, etc.;
- 2) the distance of the proposed drilling location from the section's south/north and east/west lines; and
- 3) the distance to the nearest lease or unit boundary line.