

CARD MUST BE TYPED

State of Kansas

CARD MUST BE SIGNED

NOTICE OF INTENTION TO DRILL

(see rules on reverse side)

Expected Spud Date..... 11 25 87
month day year

API Number 15-051-24,537-0000

OPERATOR: License # 5252
Name R P NIXON OPERATIONS
Address 207 W. 12TH
City/State/Zip HAYS, KS 67601
Contact Person DAN A. NIXON
Phone 913-628-3834C-S/2.. SW.. SE.. Sec. 3... Twp. 13.. S, Rg. 16... XX East
330 Ft. from South Line of Section
1980 Ft. from East Line of Section

(Note: Locate well on Section Plat on reverse side)

CONTRACTOR: License # 5655
Name SHIELDS DRILLING CO. INC.
City/State RUSSELL KANSASNearest lease or unit boundary line 330 feet
County ELLISLease Name OTTILIA Well # 4
Ground surface elevation NA feet MSLWell Drilled For: Well Class: Type Equipment:
 Oil Storage Infield Mud Rotary
 Gas Inj Pool Ext. Air Rotary
 OWWO Expl Wildcat CableDomestic well within 330 feet: yes no
Municipal well within one mile: yes no

Depth to bottom of fresh water 40'

Depth to bottom of usable water 600'

Surface pipe by Alternate: 1 2

Surface pipe planned to be set 200±'

Conductor pipe required NA

Projected Total Depth 3500 feet

Formation ARBUCKLE

If OWWO: old well info as follows:

Operator

Well Name

Comp Date Old Total Depth

I certify that well will comply with K.S.A. 55-101, et seq., plus eventually plugging hole to KCC specifications.

Date 11-16-87 Signature of Operator or Agent *D. Nixon* Title OWNER/OPERATOR

For KCC Use:

Conductor Pipe Required feet; Minimum Surface Pipe Required 200 feet per Alt. X(2)

This Authorization Expires 5-17-88 Approved By P.H. 11-17-87

EFFECTIVE DATE: 11-22-87

Must be filed with the K.C.C. five (5) days prior to commencing well
This card void if drilling not started within six (6) months of date received by K.C.C.

Important procedures to follow:

1. Notify District office before setting surface casing.
2. Set surface casing by circulating cement to the top.
3. File completion forms ACO-1 with K.C.C. within 120 days of well spud date, following instructions on ACO-1, side 1, and including copies of wireline logs.
Notify District office 48 hours prior to old well workover or re-entry.
Prior to filing Intent, prepare a proposed plugging plan in case well is D & A, then obtain approval of plan when calling district office prior to setting surface pipe.
6. Submit plugging report (CP-4) to K.C.C. after plugging is completed.
7. Obtain an approved injection docket number before disposing of salt water.
8. Notify K.C.C. within 10 days when injection commences or terminates.
9. If an alternate 2 completion, cement in the production pipe from below any usable water to surface within 120 days of spud date.

A Regular Section of Land
1 Mile = 5,280 Ft.

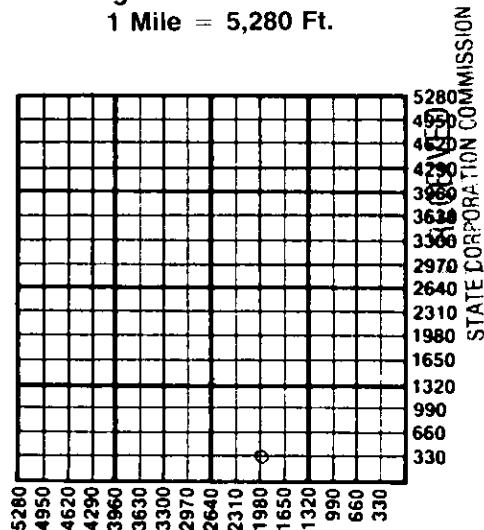

State Corporation Commission of Kansas
Conservation Division
200 Colorado Derby Building
Wichita, Kansas 67202-1212
(316) 263-3238