

EFFECTIVE DATE: 6-4-91

FORM MUST BE TYPED  
FORM C-1 4/90

State of Kansas

FORM MUST BE SIGNED  
ALL BLANKS MUST BE FILLED

NOTICE OF INTENTION TO DRILL

Must be approved by the K.C.C. five (5) days prior to commencing well

Expected Spud Date 6 12 91 NW NW NE Sec 35 Twp 16S S, Rg 22 East  West

OPERATOR: License # 5146  
Name: Rains & Williamson Oil Co., Inc.  
Address: 220 West Douglas, Suite 435  
City/State/Zip: Wichita, Kansas 67202  
Contact Person: Juanita Green  
Phone: (316) 265-9686

4950 feet from South line of Section  
2310 feet from East line of Section  
(Note: Locate well on Section Plat on Reverse Side)

CONTRACTOR: License #: 4958  
Name: Mallard JV, Inc.

County: Ness  
Lease Name: UMMEL TRUST Well #: 2  
Field Name: Brownell Trust  
Is this a Prorated Field? Cherokee Sand yes  no  
Target Formation(s): 330  
Nearest lease or unit boundary: 2397 CL feet MSL  
Ground Surface Elevation: 2397 CL feet MSL  
Domestic well within 330 feet:  yes  no  
Municipal well within one mile: 75' yes  no  
Depth to bottom of fresh water: 220 760'  
Depth to bottom of usable water: 250'  
Surface Pipe by Alternate: 1  
Length of Surface Pipe Planned to be set: 250'  
Length of Conductor pipe required: N/A  
Projected Total Depth: 4400'  
Formation at Total Depth: Mississippian  
Water Source for Drilling Operations:  
... well  farm pond ... other  
DWR Permit #: \_\_\_\_\_  
Will Cores Be Taken?:  yes  no  
If yes, proposed zone: \_\_\_\_\_

Well Drilled For: Well Class: Type Equipment:  
 Oil ... Inj  Infield  Mud Rotary  
 Gas ... Storage  Pool Ext.  Air Rotary  
 OWWO ... Disposal  Wildcat  Cable  
 Seismic; ... # of Holes

If OWWO: old well information as follows:  
Operator: \_\_\_\_\_  
Well Name: \_\_\_\_\_  
Comp. Date: \_\_\_\_\_ Old Total Depth \_\_\_\_\_

Directional, Deviated or Horizontal wellbore?  yes  no  
If yes, total depth location: \_\_\_\_\_

AFFIDAVIT

The undersigned hereby affirms that the drilling, completion and eventual plugging of this well will comply with K.S.A. 55-101, et. seq.

It is agreed that the following minimum requirements will be met:

- 1. The appropriate district office shall be notified before setting surface pipe;
- 2. The minimum amount of surface pipe as specified above shall be set by circulating cement to the top; in all cases surface pipe shall be set through all unconsolidated materials plus a minimum of 20 feet into the underlying formation;
- 3. If the well is dry, a plugging proposal shall be submitted to the district office. An agreement between the operator and the district office on plug length and placement is necessary prior to plugging;
- 4. The appropriate district office will be notified before well is either plugged or production casing is cemented in;
- 5. If an Alternate II completion, production pipe shall be cemented from below any usable water to surface within 120 days of spud date. In all cases, notify district office prior to any cementing.

I hereby certify that the statements made herein are true and to the best of my knowledge and belief.

Date: 5-29-91 Signature of Operator or Agent: Wilson Rains PRESIDENT

FOR KCC USE:

API # 15- 135-23,579-00-00  
Conductor pipe required None feet  
Minimum surface pipe required 150 feet per Alt. 2  
Approved by: MAW 5-30-91  
EFFECTIVE DATE: 6-4-91  
This authorization expires: 11-30-91  
(This authorization void if drilling not started within 6 months of effective date.)  
Spud date: \_\_\_\_\_ Agent: \_\_\_\_\_

RECEIVED  
STATE CORPORATION COMMISSION

MAY 30 1991  
5-30-1991  
CONSERVATION DIVISION  
Wichita, Kansas

REMEMBER TO:

- File Drill Pit Application (form CDP-1) with Intent to Drill;
- File Completion Form ACO-1 within 120 days of spud date;
- File acreage attribution plat according to field proration orders;
- Notify appropriate district office 48 hours prior to workover or re-entry;
- Submit plugging report (CP-4) after plugging is completed;
- Obtain written approval before disposing or injecting salt water.

35  
16  
2213

**PLAT OF ACREAGE ATTRIBUTABLE TO A WELL**

State Corporation Commission, Conservation Division  
200 Colorado Derby Bldg. Wichita, Kansas 67202

OPERATOR Rains & Williamson Oil Co., Inc. LOCATION OF WELL:  
 LEASE UMMEL TRUST 4950 feet north of SE corner  
 WELL NUMBER #2 2310 feet west of SE corner  
 FIELD Brownell Trust N/2 NE Sec. 35 T 16S R 22 X/W  
 COUNTY Ness  
 NO. OF ACRES ATTRIBUTABLE TO WELL 10 IS SECTION X REGULAR     IRREGULAR?  
 DESCRIPTION OF ACREAGE NW NW NE IF IRREGULAR, LOCATE WELL FROM NEAREST  
 CORNER BOUNDARY.

NOTE: If plat depicted is insufficient for your circumstances, you may attach your own scaled or surveyed plat.

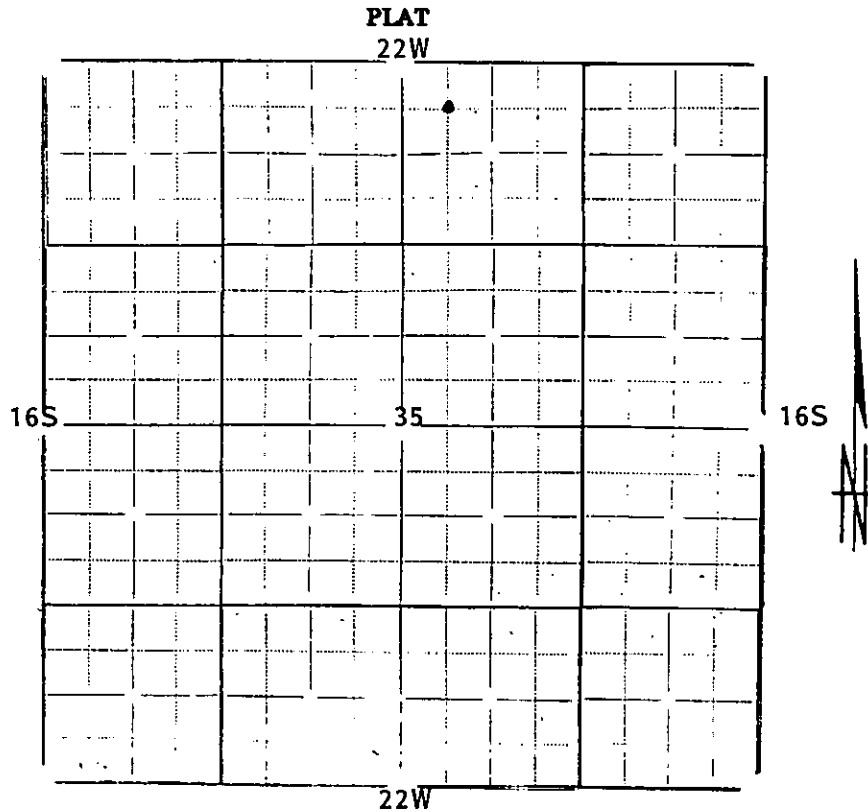

In plotting the proposed location of the well, you must show:

- 1) The manner in which you are using the depicted plat by identifying section lines, i.e. 1 section, 1 section with 8 surrounding partial sections, 4 sections, 16 sections, etc.;
- 2) the well's location relative to the location of other wells producing from the same common source of supply in adjoining drilling units, pursuant to K.A.R. 82-3-108, 82-3-207, 82-3-312, or special orders of the Commission;
- 3) the distance of the proposed drilling location from the section's east and south lines; and
- 4) the distance to the nearest lease or unit boundary line.

I hereby certify that the statements made herein are true and to the best of my knowledge and belief.

Signature of Operator or Agent *Wilson Rains*

Date 5-29-91 Title PRESIDENT