

For KCC Use: 4-19-03  
Effective Date: 4-19-03  
District # \_\_\_\_\_  
SGA?  Yes  No

KANSAS CORPORATION COMMISSION  
OIL & GAS CONSERVATION DIVISION

*Final Seal*  
**CORRECTED**

Form C-1  
December 2002  
Form must be Signed  
Form must be Signed  
All blanks must be Filled

**NOTICE OF INTENT TO DRILL**

Must be approved by KCC five (5) days prior to commencing well

Expected Spud Date April 16, 2003  
month day year

Spot E/2E/2:E/2 SE Sec. 1 Twp. 17 S. R. 24  
 East  West

\* 1400 feet from  N /  S Line of Section  
150 feet from  E /  W Line of Section

Is SECTION  Regular  Irregular?

(Note: Locate well on the Section Plat on reverse side)

County: Ness

Lease Name: Yost-Kiltzke Well #: 1

Field Name: \_\_\_\_\_

Is this a Prorated / Spaced Field?  Yes  No

Target Information(s): Mississippian

Nearest Lease or unit boundary: 330 feet (Unit)

Ground Surface Elevation: 2600 estimate 2485 feet MSL

Water well within one-quarter mile:  Yes  No

Public water supply well within one mile:  Yes  No

Depth to bottom of fresh water: 180 feet

Depth to bottom of usable water: 980 feet

Surface Pipe by Alternate:  1  2

Length of Surface Pipe Planned to be set: 200 feet

Length of Conductor Pipe required: 0- NONE

Projected Total Depth: 4600

Formation at Total Depth: Mississippian

Water Source for Drilling Operations:

Well  Farm Pond  Other \_\_\_\_\_

DWR Permit #: \_\_\_\_\_

(Note: Apply for Permit with DWR )

Will Cores be taken?  Yes  No

If Yes, proposed zone: \_\_\_\_\_

**RECEIVED**  
*04-18-2003*  
*APR 10 2003*  
**KCC WICHITA**

OPERATOR: License# 6569  
Name: Carmen Schmitt Inc.  
Address: P.O. Box 47  
City/State/Zip: Great Bend, KS 67530  
Contact Person: Carmen Schmitt  
Phone: 620-793-5100

CONTRACTOR: License# 5184  
Name: Shields Oil Producers, Inc.

Well Drilled For:  Oil  Gas  OWWO  Seismic; # of Holes \_\_\_\_\_  Other \_\_\_\_\_  
Well Class:  Enh Rec  Storage  Disposal  Other \_\_\_\_\_  
Type Equipment:  Mud Rotary  Air Rotary  Cable  Infield  Pool Ext.  Wildcat

If OWWO: old well information as follows:  
Operator: \_\_\_\_\_  
Well Name: \_\_\_\_\_  
Original Completion Date: \_\_\_\_\_ Total Depth: \_\_\_\_\_  
Directional, Deviated or Horizontal wellbore?  Yes  No  
If Yes, true vertical depth: \_\_\_\_\_  
Bottom Hole Location: \_\_\_\_\_  
KCC DKT #: \_\_\_\_\_

*\* Error in first correction \**  
*2ND CORR. 8.1.03*

**AFFIDAVIT** \* *ELEV IS 2485' WAS 2500' EST*

The undersigned hereby affirms that the drilling, completion and eventual plugging of this well will comply with K.S.A. 55 et. seq.

It is agreed that the following minimum requirements will be met:

1. Notify the appropriate district office *prior* to spudding of well;
2. A copy of the approved notice of intent to drill *shall be* posted on each drilling rig;
3. The minimum amount of surface pipe as specified below *shall be set* by circulating cement to the top; in all cases surface pipe *shall be set* through all unconsolidated materials plus a minimum of 20 feet into the underlying formation.
4. If the well is dry hole, an agreement between the operator and the district office on plug length and placement is necessary *prior to plugging*;
5. The appropriate district office will be notified before well is either plugged or production casing is cemented in;
6. If an ALTERNATE II COMPLETION, production pipe shall be cemented from below any usable water to surface within **120 days** of spud date. Or pursuant to Appendix "B" - Eastern Kansas surface casing order #133,891-C, which applies to the KCC District 3 area, alternate II cementing must be completed within 30 days of the spud date or the well shall be plugged. *In all cases, NOTIFY district office prior to any cementing.*

*\* LOCATION IS: E/2E/2E/2 SE*

I hereby certify that the statements made herein are true and to the best of my knowledge and belief.

Date: 4-9-03 Signature of Operator or Agent: Carmen Schmitt Title: Secretary

For KCC Use ONLY  
API # 15 - 135-24221-00-00  
Conductor pipe required NONE feet  
Minimum surface pipe required 200 feet per Alt. 2  
Approved by: RSP 4-14-03 RSP 7-31-03 RSP 8-1-03  
This authorization expires: 10-14-03  
(This authorization void if drilling not started within 6 months of effective date.)  
Spud date: \_\_\_\_\_ Agent: \_\_\_\_\_

**Remember to:**

- File Drill Pit Application (form CDP-1) with Intent to Drill;
- File Completion Form ACO-1 within 120 days of spud date;
- File acreage attribution plat according to field proration orders;
- Notify appropriate district office 48 hours prior to workover or re-entry;
- Submit plugging report (CP-4) after plugging is completed;
- Obtain written approval before disposing or injecting salt water.
- If this permit has expired (See: authorized expiration date) please check the box below and return to the address below.

Well Not Drilled - Permit Expired  
Signature of Operator or Agent: \_\_\_\_\_  
Date: \_\_\_\_\_

Mail to: KCC - Conservation Division, 130 S. Market - Room 2078, Wichita, Kansas 67202

1  
17  
24W

**IN ALL CASES PLOT THE INTENDED WELL ON THE PLAT BELOW**

*Plat of acreage attributable to a well in a prorated or spaced field*

*If the intended well is in a prorated or spaced field, please fully complete this side of the form. If the intended well is in a prorated or spaced field complete the plat below showing that the well will be properly located in relationship to other wells producing from the common source of supply. Please show all the wells and within 1 mile of the boundaries of the proposed acreage attribution unit for gas wells and within 1/2 mile of the boundaries of the proposed acreage attribution unit for oil wells.*

API No. 15 \_\_\_\_\_  
 Operator: Carmen Schmitt Inc.  
 Lease: Yost-Klitzke  
 Well Number: 1  
 Field: \_\_\_\_\_  
 Number of Acres attributable to well: \_\_\_\_\_  
 QTR / QTR / QTR of acreage: \_\_\_\_\_

Location of Well: County: Ness  
1400 feet from  N /  S Line of Section  
100 feet from  E /  W Line of Section  
 Sec. 1 Twp. 17 S. R. 24  East  West  
 Is Section:  Regular or  Irregular  
 If Section is Irregular, locate well from nearest corner boundary.  
 Section corner used:  NE  NW  SE  SW

**PLAT**

*(Show location of the well and shade attributable acreage for prorated or spaced wells.)  
 (Show footage to the nearest lease or unit boundary line.)*

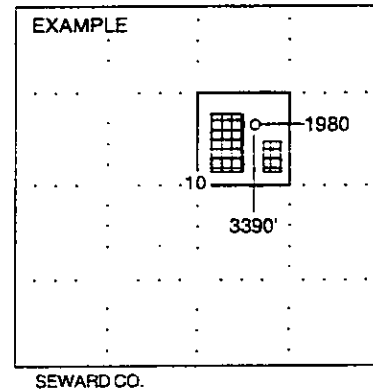
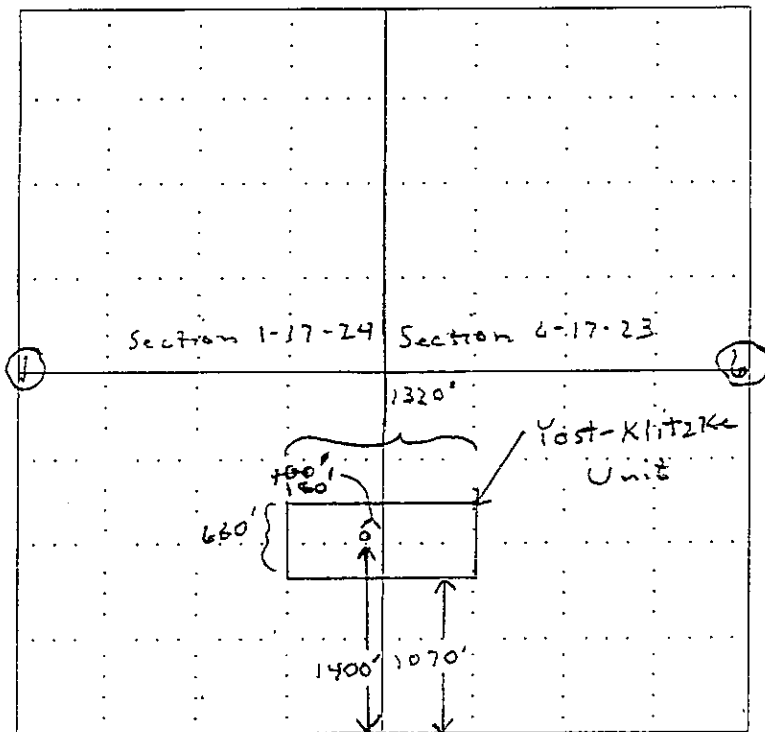

**NOTE: In all cases locate the spot of the proposed drilling location.**

**In plotting the proposed location of the well, you must show:**

1. The manner in which you are using the depicted plat by identifying section lines, i.e. 1 section, 1 section with 8 surrounding sections, 4 sections, etc.
2. The distance of the proposed drilling location from the section's south / north and east / west.
3. The distance to the nearest lease or unit boundary line.
4. If proposed location is located within a prorated or spaced field a certificate of acreage attribution plat must be attached: (C0-7 for oil wells; CG-8 for gas wells).

RECEIVED

APR 10 2003

KCC WICHITA