

FOR KCC USE:

FORM C-1 7/9

FORM MUST BE TYPE

EFFECTIVE DATE: 10-29-96

State of Kansas

DISTRICT # 1

NOTICE OF INTENTION TO DRILL

SSAT Yes No

Must be approved by the K.C.C. five (5) days prior to commencing well

ALL BLANKS MUST BE FILLED

Expected Spud Date November 02 1996
month day year

Spot SE SE SE Sec 5 Twp 19 S. Rg 24

OPERATOR: License # 5144
Name: Mull Drilling Company, Inc.
Address: P.O. Box 2758
City/State/Zip: Wichita, Kansas 67201-2758
Contact Person: Scott Hampel
Phone: (316) 264-6366 ext. 12

330 feet from South North line of Section
330 feet from East West line of Section
IS SECTION X REGULAR IRREGULAR?

CONTRACTOR: License #: 5929
Name: Duke Drilling Company

(NOTE: Locate well on the Section Plat on Reverse Side
County: Ness

Well Drilled For: Well Class: Type Equipment:

X Oil ... Enh Rec X Infield X Mud Rotary
... Gas ... Storage ... Pool Ext. ... Air Rotary
... OWD ... Disposal ... Wildcat ... Cable
... Seismic; ... # of Holes ... Other

Lease Name: Borgar Well #: 6
Field Name: McDonald

If OWD: old well information as follows:

Is this a Prorated/Spaced Field? ... yes X no
Target Formation(s): Mississippian-Warsaw

Operator:
Well Name:
Comp. Date: Old Total Depth

Nearest lease or unit boundary: 330'
Ground Surface Elevation: 2328 feet MSL

Directional, Deviated or Horizontal wellbore? ... yes X no

Water well within one-quarter mile: ... yes X no
Public water supply well within one mile: ... yes X no

If yes, true vertical depth:

Depth to bottom of fresh water: 180'
Depth to bottom of usable water: 780'

Bottom Hole Location:

Surface Pipe by Alternate: 1 X 2
Length of Surface Pipe Planned to be set: 200'

AFFIDAVIT

The undersigned hereby affirms that the drilling, completion and eventual plugging of this well will comply with K.S.A. 55-101, et. seq.

It is agreed that the following minimum requirements will be met:

- 1. Notify the appropriate district office prior to spudding of well;
2. A copy of the approved notice of intent to drill shall be posted on each drilling rig;
3. The minimum amount of surface pipe as specified below shall be set by circulating cement to the top; in all cases surface pipe shall be set through all unconsolidated materials plus a minimum of 20 feet into the underlying formation;
4. If the well is dry hole, an agreement between the operator and the district office on plug length and placement is necessary prior to plugging;
5. The appropriate district office will be notified before well is either plugged or production casing is cemented in;
6. IF AN ALTERNATE IS COMPLETED, PRODUCTION PIPE SHALL BE CEMENTED FROM BELOW ANY USABLE WATER TO SURFACE WITHIN 120 DAYS OF SPUD DATE. IN ALL CASES, NOTIFY DISTRICT OFFICE PRIOR TO ANY CEMENTING.

I hereby certify that the statements made herein are true and to the best of my knowledge and belief.

Date: 10/23/96 Signature of Operator or Agent: Scott Hampel

Title: Vice President - Engineering/Production

FOR KCC USE:
API # 15- 135-239620000
Conductor pipe required NONE feet
Minimum surface pipe required 200 feet per Alt. X 2
Approved by: JK 10-24-96
This authorization expires: 4-24-97
(This authorization void if drilling not started within 6 months of effective date.)
Spud date: Agent:

REMEMBER TO:

- File Drill Pit Application (form CDP-1) with Intent to Drill;
- File Completion Form ACD-1 within 120 days of spud date;
- File acreage attribution plat according to field proration orders;
- Notify appropriate district office 48 hours prior to workover or re-entry;
- Submit plugging report (CP-4) after plugging is completed;
- Obtain written approval before disposing or injecting salt water.

Mail to: Conservation Division, 200 Colorado Derby Building, 202 W. First St., Wichita, Kansas 67202-1286.

Handwritten marks: 5, 19, 24/30

IN ALL CASES PLOT THE INTENDED WELL ON THE PLAT BELOW

PLAT OF ACREAGE ATTRIBUTABLE TO A WELL IN A PRORATED OR SPACED FIELD

If the intended well is in a prorated or spaced field, please fully complete this side of the form. If the intended well is in a prorated or spaced field complete the plat below showing that the well will be properly located in relationship to other wells producing from the common source of supply. Please show all the wells within 1 mile of the boundaries of the proposed acreage attribution unit for gas wells and within 1/2 mile of the boundaries of the proposed acreage attribution unit for oil wells.

API NO. 15- \_\_\_\_\_  
 OPERATOR \_\_\_\_\_  
 LEASE \_\_\_\_\_  
 WELL NUMBER \_\_\_\_\_  
 FIELD \_\_\_\_\_

LOCATION OF WELL: COUNTY \_\_\_\_\_  
 \_\_\_\_\_ feet from south/north line of section  
 \_\_\_\_\_ feet from east/west line of section  
 SECTION \_\_\_\_\_ TWP \_\_\_\_\_ RG \_\_\_\_\_

NUMBER OF ACRES ATTRIBUTABLE TO WELL \_\_\_\_\_  
 QTR/QTR/QTR OF ACREAGE \_\_\_\_\_

IS SECTION \_\_\_\_\_ REGULAR or \_\_\_\_\_ IRREGULAR  
IF SECTION IS IRREGULAR, LOCATE WELL FROM NEAREST CORNER BOUNDARY.

Section corner used: \_\_\_\_\_ NE \_\_\_\_\_ NW \_\_\_\_\_ SE \_\_\_\_\_ SW

PLAT

(Show location of the well and shade attributable acreage for prorated or spaced wells.)  
 (Show footage to the nearest lease or unit boundary line.)

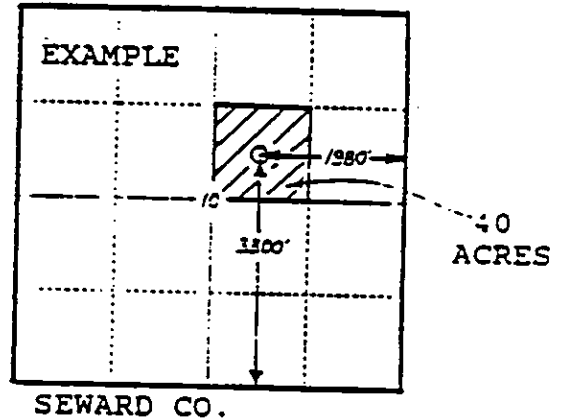
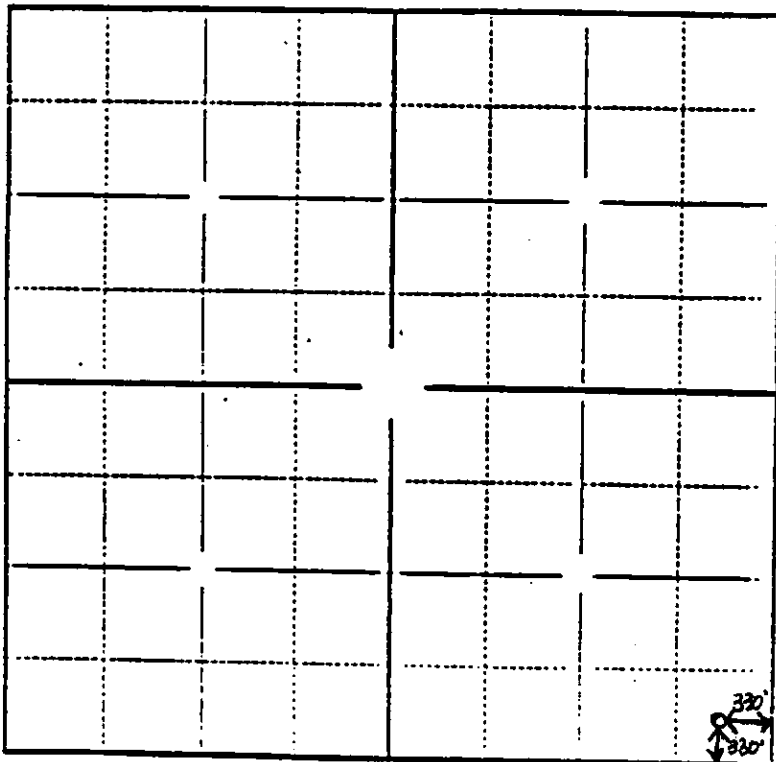

In plotting the proposed location of the well, you must show:

- 1) The manner in which you are using the depicted plat by identifying section lines, i.e. 1 section, 1 section with 8 surrounding sections, 4 sections, etc.;
- 2) the distance of the proposed drilling location from the section's south/north and east/west lines; and
- 3) the distance to the nearest lease or unit boundary line.