

ORIGINAL WAIT TIGHT HOLE

10/25/90
RELEASED
OCT 4 1991

SIDE ONE

**STATE CORPORATION COMMISSION OF KANSAS
OIL & GAS CONSERVATION DIVISION
WELL COMPLETION FORM
ACO-1 WELL HISTORY
DESCRIPTION OF WELL AND LEASE**

API NO. 15- 135-23,375 -0000

County Ness FROM CONFIDENTIAL

E/2 SE NE Sec. 23 Twp. 19S Rge. 23W East West

3300 Ft. North from Southeast Corner of Section

330 Ft. West from Southeast Corner of Section
(NOTE: Locate well in section plat below.)

Lease Name Batman Well # A-1

Field Name _____

Producing Formation N/A

Elevation: Ground 2215' KB 2224'

Total Depth 4,450' PBTD _____

Operator: License # 5214

Name: Lario Oil & Gas Company

Address 301 South Market

Wichita, Ks. 67202

City/State/Zip _____

Purchaser: N/A

Operator Contact Person: Robert Miller

Phone (316) 265-5611

Contractor: Name: Red Tiger Drilling Company

License: 5302

Wellsite Geologist: Arden Ratzlaff

Designate Type of Completion

New Well Re-Entry Workover

Oil SWD Temp. Abd.

Gas Inj Delayed Comp.

Dry Other (Core, Water Supply, etc.)

KANSAS GEOLOGICAL SURVEY
WICHITA BRANCH
OCT 30 1988

RECEIVED
STATE CORPORATION COMMISSION
OCT 25 1988

CONSERVATION DIVISION
Wichita, Kansas

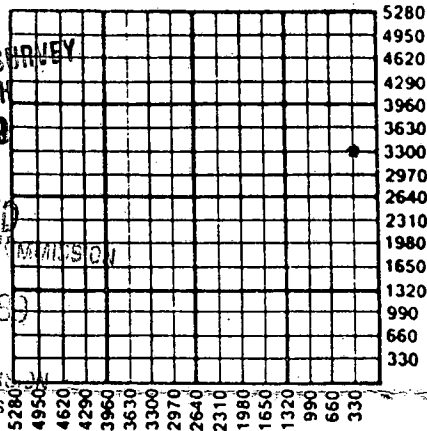

If **OWMO**: old well info as follows:

Operator: _____

Well Name: _____

Comp. Date _____ Old Total Depth _____

Drilling Method: Mud Rotary Air Rotary Cable

9/28/89 10/6/89 10/7/89

Spud Date Date Reached TD Completion Date

Amount of Surface Pipe Set and Cemented at 272 Feet

Multiple Stage Cementing Collar Used? Yes No

If yes, show depth set _____ Feet

If Alternate II completion, cement circulated from 272

feet depth to surface w/ 180 sx cmt.

INSTRUCTIONS: This form shall be completed in triplicate and filed with the Kansas Corporation Commission, 200 Colorado Derby Building, Wichita, Kansas 67202, within 120 days of the spud date of any well. Rule 82-3-130, 82-3-107 and 82-3-106 apply. Information on side two of this form will be held confidential for a period of 12 months if requested in writing and submitted with the form. See rule 82-3-107 for confidentiality in excess of 12 months. One copy of all wireline logs and drillers time log shall be attached with this form. ALL CEMENTING TICKETS MUST BE ATTACHED. Submit CP-4 form with all plugged wells. Submit CP-111 form with all temporarily abandoned wells. Any recompletion, workover or conversion of a well requires filing of ACO-2 within 120 days from commencement date of such work.

All requirements of the statutes, rules and regulations promulgated to regulate the oil and gas industry have been fully complied with and the statements herein are complete and correct to the best of my knowledge.

Signature Robert Miller

Title Robert Miller, Prod. Supervisor Date 10-13-89

Subscribed and sworn to before me this 13th day of October, 19 89.

Notary Public Penny Dörpinghaus

Date Commission Expires 9-15-91

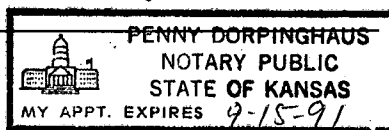

K.C.C. OFFICE USE ONLY		
<input checked="" type="checkbox"/>	Letter of Confidentiality Attached	
<input checked="" type="checkbox"/>	Wireline Log Received	
<input type="checkbox"/>	Drillers Timelog Received	
Distribution		
<input checked="" type="checkbox"/>	KCC	<input type="checkbox"/> SWD/Rep <input type="checkbox"/> NGPA
<input checked="" type="checkbox"/>	KGS	<input type="checkbox"/> Plug <input type="checkbox"/> Other (Specify)

ORIGINAL

INVOICE

HALLIBURTON SERVICES

15-135-23375-0000
A Halliburton Company

P.O. BOX 951046
DALLAS, TX 75395-1046

INVOICE NO.	DATE
835956	09/28/1989

WELL LEASE NO./PLANT NAME		WELL/PLANT LOCATION		STATE	WELL/PLANT OWNER
BATMAN A 1		NESS		KS	SAME
SERVICE LOCATION		CONTRACTOR	JOB PURPOSE		TICKET DATE
NESS CITY		RED TIGER	CEMENT SURFACE CASING		09/28/1989
ACCT. NO.	CUSTOMER AGENT	VENDOR NO.	CUSTOMER P.O. NUMBER	SHIPPED VIA	FILE NO.
496590	EDWARD KASSELMAN			COMPANY TRUCK	83365

LARIO OIL & GAS COMPANY
BOX 784
HAYS, KS 67601

DIRECT CORRESPONDENCE TO:
SUITE 600
COLORADO DERBY BUILDING
WICHITA, KS 67202-0000

<input checked="" type="checkbox"/>	<input checked="" type="checkbox"/>	<i>BOM</i>
Acct.	Expt.	File
Rec'd 09/28/1989 Prod.		

PRICE REF. NO.	DESCRIPTION	PO	SH	WV	EM	CS	QUANTITY	U/M	UNIT PRICE	AMOUNT
000-117	MILEAGE						9	MI	2.20	19.80
001-016	CEMENTING CASING						280	FT	395.00	395.00
030-503	CMTG PLUG LA-11,CP-1,CP-3, TOP						8 5/8	IN	58.00	58.00
12A	GUIDE SHOE - 8 5/8" BRD THD.						1	EA	188.00	188.00
825.217										
24A	INSERT FLOAT VALVE - 8 5/8" BRD						1	EA	171.00	171.00
815.19502										
27	FILL-UP UNIT 7" - 8 5/8"						1	EA	29.00	29.00
815.19415										
40	CENTRALIZER 8-5/8" MODEL S-4						3	EA	53.00	159.00
807.93059										
350	HALLIBURTON WELD-A						1	LB	11.00	11.00
890.10802										
504-308	STANDARD CEMENT						108	SK	5.45	588.60
506-105	POZMIX A						72	SK	2.88	207.36
506-121	HALLIBURTON-GEL 2%						3	SK	.00	N/C
509-406	ANHYDROUS CALCIUM CHLORIDE						5	SK	25.75	128.75
500-207	BULK SERVICE CHARGE						190	CFT	.95	180.50
500-306	MILEAGE CMTG MAT DEL OR RETURN						72.810	TMI	.70	50.97

INVOICE SUBTOTAL

DISCOUNT-(BID)
INVOICE BID AMOUNT

*-KANSAS STATE SALES TAX

Development Cost

INVOICE TOTAL - PLEASE PAY THIS AMOUNT

RECEIVED
STATE REFORMATION COMMISSION
OCT 25 1989
CONSERVATION DIVISION
Wichita, Kansas

2,186.98

502.98-
1,684.00

56.10

\$1,740.10

TERMS INVOICES PAYABLE NET BY THE 20TH OF THE FOLLOWING MONTH AFTER DATE OF INVOICE. UPON CUSTOMER'S DEFAULT IN PAYMENT OF CUSTOMER'S ACCOUNT BY THE LAST DAY OF THE MONTH FOLLOWING THE MONTH IN WHICH THE INVOICE IS DATED, CUSTOMER AGREES TO PAY INTEREST THEREON AFTER DEFAULT AT THE HIGHEST LAWFUL CONTRACT RATE APPLICABLE BUT NEVER TO EXCEED 18% PER ANNUM. IN THE EVENT IT BECOMES NECESSARY TO EMPLOY AN ATTORNEY TO ENFORCE COLLECTION OF SAID ACCOUNT, CUSTOMER AGREES TO PAY ALL COLLECTION COSTS AND ATTORNEY FEES IN THE AMOUNT OF 20% OF THE AMOUNT OF THE UNPAID ACCOUNT.

ORIGINAL

INVOICE



HALLIBURTON SERVICES

A Halliburton Company

15-135-23375-0000

REMIT TO: P.O. BOX 951046 DALLAS, TX 75395-1046

INVOICE NO.	DATE
836093	10/07/1989

WELL LEASE NO./PLANT NAME		WELL/PLANT LOCATION		STATE	WELL/PLANT OWNER
BATMAN A-1		NESS		KS	SAME
SERVICE LOCATION		CONTRACTOR	JOB PURPOSE		TICKET DATE
NESS CITY		RED TIGER	PLUG TO ABANDON		10/07/1989
ACCT. NO.	CUSTOMER AGENT	VENDOR NO.	CUSTOMER P.O. NUMBER	SHIPPED VIA	FILE NO.
496590	EDWARD KASSELMAN			COMPANY TRUCK	83777

LARIO OIL & GAS COMPANY
BOX 784
HAYS, KS 67601

DIRECT CORRESPONDENCE TO:
SUITE 600
COLORADO DERBY BUILDING
WICHITA, KS 67202-0000

PRICE REF. NO.	DESCRIPTION	QUANTITY	U/M	UNIT PRICE	AMOUNT
000-117	MILEAGE	9	MI	2.20	19.80
		1	UNT		
090-910	MISCELLANEOUS PUMPING JOB	1	TRK	370.00	370.00
504-308	STANDARD CEMENT	117	SK	5.45	637.65
506-105	POZMIX A	78	SK	2.88	224.64
506-121	HALLIBURTON-GEL 2%	3	SK	.00	N/C
507-277	HALLIBURTON-GEL BENTONITE	7	SK	13.00	91.00
500-207	BULK SERVICE CHARGE	195	CFT	.95	185.25
500-306	MILEAGE CMTG MAT DEL OR RETURN	79.965	TMI	.70	55.98
INVOICE SUBTOTAL					1,584.32
DISCOUNT-(BID)					237.62-
INVOICE BID AMOUNT					1,346.70
*-KANSAS STATE SALES TAX					57.25
INVOICE TOTAL - PLEASE PAY THIS AMOUNT					\$1,403.95

RECEIVED
STAT CONSERVATION COMMISSION
OCT 25 1989

CONSERVATION DIVISION
Wichita, Kansas

Plug & Abandon

Edward Kasselmann

Acct.	Expl.	PRG	CK to Pay
Rec'd OCT 13 1989			
PD	SE	SW	BS
			NT

TERMS INVOICES PAYABLE NET BY THE 20TH OF THE FOLLOWING MONTH AFTER DATE OF INVOICE UPON CUSTOMER'S DEFAULT IN PAYMENT OF CUSTOMER'S ACCOUNT BY THE LAST DAY OF THE MONTH FOLLOWING THE MONTH IN WHICH THE INVOICE IS DATED. CUSTOMER AGREES TO PAY INTEREST THEREON AFTER DEFAULT AT THE HIGHEST LAWFUL CONTRACT RATE APPLICABLE BUT NEVER TO EXCEED 18% PER ANNUM IN THE EVENT IT BECOMES NECESSARY TO EMPLOY AN ATTORNEY TO ENFORCE COLLECTION OF SAID ACCOUNT. CUSTOMER AGREES TO PAY ALL COLLECTION COSTS AND ATTORNEY FEES IN THE AMOUNT OF 25% OF THE AMOUNT OF THE UNPAID ACCOUNT.

15-135-23375-0000

LARIO OIL & GAS COMPANY



301 SOUTH MARKET STREET
WICHITA, KANSAS 67202
(316) 265-5611

September 22, 1989

Kansas State Board of Agriculture
Division of Water Resources
109 SW 9th Street, Suite 202
Topeka, KS 66612-1283

RE: Water Supply Source
For Drilling Well
Batman A #1
NE NE Section 23-19S-23W
Ness County, Kansas

Gentlemen:

Lario Oil & Gas Company obtained a permit to drill a water well to supply water for the drilling of the Batman well. On September 19, 1989, the water well was found to be dry. Lario plans to haul water for the drilling operation.

If you need additional information, please contact me at the letterhead address or phone.

Sincerely,



Robert Miller
Production Supervisor

RM:pd
xc: Dave Williams, KCC

RECEIVED
STATE CORPORATION COMMISSION

SEP 25 1989

CONSERVATION DIVISION
Wichita, Kansas

Submit To:

CHIEF ENGINEER-DIRECTOR
Division of Water Resources
Kansas State Board of Agriculture
109 SW Ninth Street
Topeka, KS 66612-1283

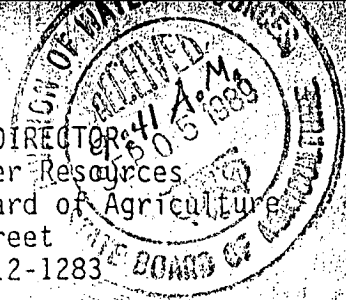

APPLICATION FOR
TEMPORARY PERMIT

Accl.	Exp.	File	OK to Pay
Rec'd SEP 2 1 1989			
PD	SP	WV	SM

STATE OF KANSAS

TO USE GROUNDWATER
 TO USE SURFACE WATER
(check one)

A STATUTORY FILING FEE OF \$100.00 MUST ACCOMPANY THIS APPLICATION
(Make check payable to the Division of Water Resources.)

K-135-23375-0000

(1) APPLICANT

NAME Rosenkrantz - Bemis
STREET 0
RURAL ROUTE Box 713
CITY Great Bend, Mo. 67537
(state) (zip)
TELEPHONE NO. 316-793-5512
(area code)

(2) LOCATION OF POINT OF DIVERSION

Sec. 23, Twp. 19, Rng. 23, (W),
17-ess County, Kansas.

DISTANCE FROM SOUTHEAST CORNER OF SECTION:

330 FT. NORTH FROM SOUTHEAST CORNER

330 FT. WEST FROM SOUTHEAST CORNER

(3) WATER USE DATA

PROPOSED MAX. PUMPING RATE (gpm) 100
AMOUNT REQUESTED (gallons) 1/2 million
(not to exceed one million gallons)
DEPTH OF WELL (feet) 60-80, or
NAME OF STREAM _____

(4) OWNER OF LAND UPON WHICH POINT OF DIVERSION IS LOCATED:

Bob Pratt - Pittmore, Mo.
IF OTHER THAN APPLICANT, SUBMIT STATEMENT
SHOWING OWNER'S PERMISSION TO INSTALL
DIVERSION WORKS HAS BEEN OBTAINED.
OK: GAS LEASE

(5) WATER IS TO BE USED FOR:

driving oil well
(briefly describe proposed use)
Radio oil + Gas

(6) LOCATION OF PLACE OF USE:

E 1/2 SE 1/4

(7) PERIOD OF USE (6 months max.)

Sept. 6 - 89
(commencing - date)
Oct 6 - 89
(ending date)

(8) LOCATION OF THE PROPOSED POINT OF DIVERSION SHALL BE INDICATED ON THE DIAGRAM BELOW. USE THE CENTER SECTION

IF SURFACE WATER, INDICATE ON THE DIAGRAM THE COURSE OF THE STREAM, AND ITS NAME.

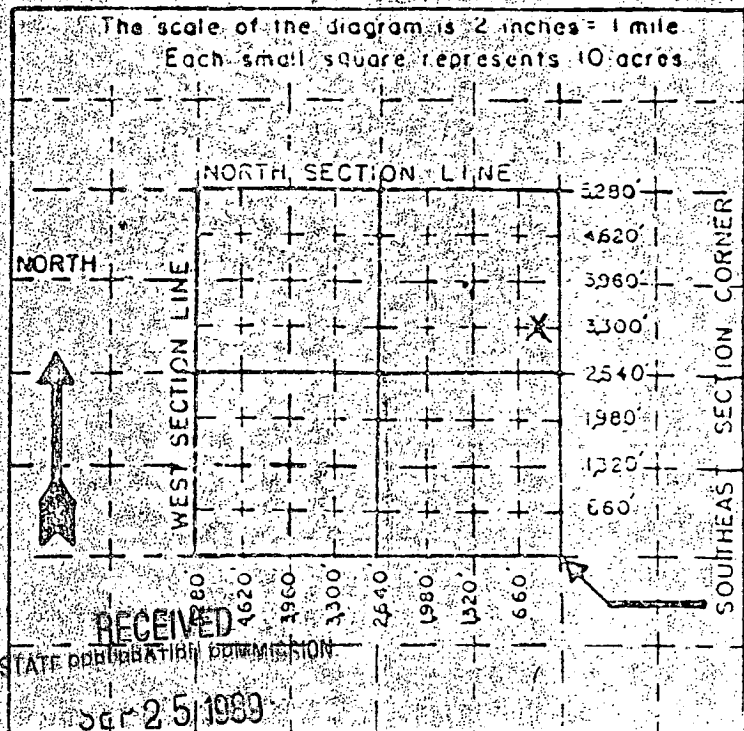

CONSERVATION DIVISION
Wichita, Kansas

Revised 5-12-89

WR
9/6/89

(9) FOR GROUNDWATER USE, LIST BELOW ALL WELLS WITHIN 1/2 MILE OF THE PROPOSED WELL, AND PLOT LOCATIONS UPON THE DIAGRAM ON REVERSE SIDE. IF ADDITIONAL SPACE IS NEEDED, ATTACH SHEET.

15-135-23375-0000

OTHER WELLS -

Well A OWNER(S): no wells
ADDRESS :

Well B OWNER(S):
ADDRESS :

(10) FOR SURFACE WATER USE, LIST BELOW THE NAMES AND ADDRESSES OF ALL LANDOWNERS FROM A POINT 1/2 MILE UPSTREAM TO A POINT 1/2 MILE DOWNSTREAM OF THE TRACT OF LAND UPON WHICH THE POINT OF DIVERSION IS LOCATED. IF ADDITIONAL SPACE IS NEEDED, ATTACH SHEET.

TRACT A OWNER(S):
ADDRESS :

TRACT B OWNER(S):
ADDRESS :

(11) THE APPLICANT STATES THAT THE INFORMATION SET HEREON IS TRUE AND ACCURATE TO THE BEST OF HIS/HER KNOWLEDGE.

SIGNATURE OF APPLICANT or Judith Dodson AUTHORIZED REPRESENTATIVE Aug 31-89 DATE
TITLE Sec

DO NOT WRITE BELOW THIS LINE

CONDITIONS OF APPROVAL

THE APPLICANT SHALL MAINTAIN RECORDS FROM WHICH THE QUANTITY OF WATER ACTUALLY DIVERTED MAY BE READILY DETERMINED.

THE USE OF WATER HEREIN AUTHORIZED SHALL NOT IMPAIR ANY USE UNDER EXISTING WATER RIGHTS NOR PREJUDICIAALLY AND UNREASONABLY AFFECT THE PUBLIC INTEREST.

The point of diversion authorized by the approval of this application for temporary permit is more particularly described as being located near the center of the East Half of the Southeast Quarter of the Northeast Quarter (E 1/2 SE 1/4 NE 1/4) of Section 23, Township 19 South, Range 23 West, Ness County, Kansas.

APPLICATION APPROVED

PERMIT NUMBER 789-388

DATE ISSUED Sept 6, 1989

EXPIRATION DATE Oct 6, 1989

Guy Ellis Hydrologist
FOR David L. Pope, P.E. by W.K. Zibank
Chief Engineer
Division of Water Resources
Kansas State Board of Agriculture
Hydrologist

RECEIVED
STATE CORPORATION COMMISSION

SEP 25 1989

CONSERVATION DIVISION
Wichita, Kansas